

Benchmark: C.B. 2 - Set chiseled \square on concrete slopewall North end between S.N. 054-0063 and S.N. 054-0064 at Sta. 283+85, 10 ft. left, Elev. 595.82.

Existing Structure: S.N. 054-0063 (Northbound) and S.N. 054-0064 (Southbound) built in 1974 as F.A.I. Route 55, Section 54-5B Station 282+39.33. The superstructure consists of three spans continuous steel 48" Plate Girders with reinforced concrete deck. The substructure consists of open stub abutments supported on concrete piles and solid piers supported on concrete piles. The structure length is 316'-6" back to back of abutments and 42'-0" out to out of deck with a 22° R.F. skew. Existing deck to be removed and replaced.

Traffic to be maintained using Stage Construction.

No Salvage.

STATION 282+39.33
RE-BUILT 20__ BY
STATE OF ILLINOIS
LOADING HS20-44 & ALT.
STRUCTURE NO. 054-0063

STATION 282+39.33
RE-BUILT 20__ BY
STATE OF ILLINOIS
LOADING HS20-44 & ALT.
STRUCTURE NO. 054-0064

NAME PLATE N.B. STRUCTURE
See Std. 515001

NAME PLATE S.B. STRUCTURE
See Std. 515001

SEISMIC DATA

Seismic Performance Category (SPC) = A
Bedrock Acceleration Coefficient(A) = 0.046 g
Site Coefficient (S) = 1

DESIGN STRESSES

FIELD UNITS (NEW CONST.)	FIELD UNITS (EXIST. CONST.)
f'c = 3,500 psi	f'c = 3,500 psi
fy = 60,000 psi (Reinforcement)	fy = 40,000 psi (Reinforcement)
fy = 36,000 psi (Steel)	fy = 36,000 psi (Steel)

DESIGN SPECIFICATIONS (NEW CONST.)

2002 AASHTO Standard Specifications for Highway Bridges 17th Edition
1995 FHWA Retrofitting Manual

LOADING HS 20-44 & ALT.

Allow 25#/sq. ft. for future wearing surface.

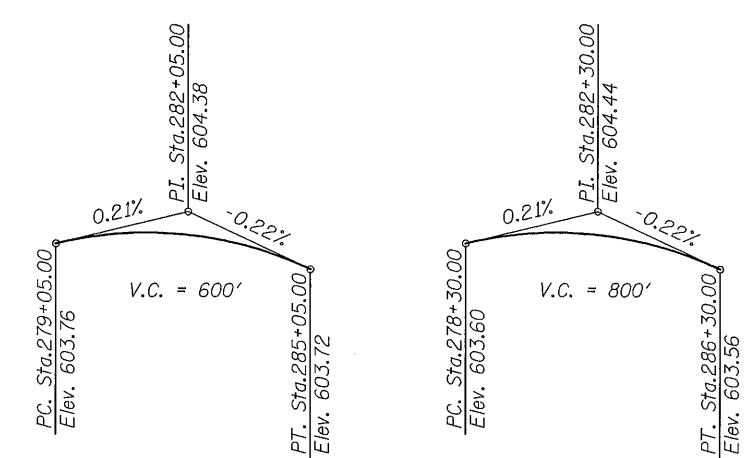
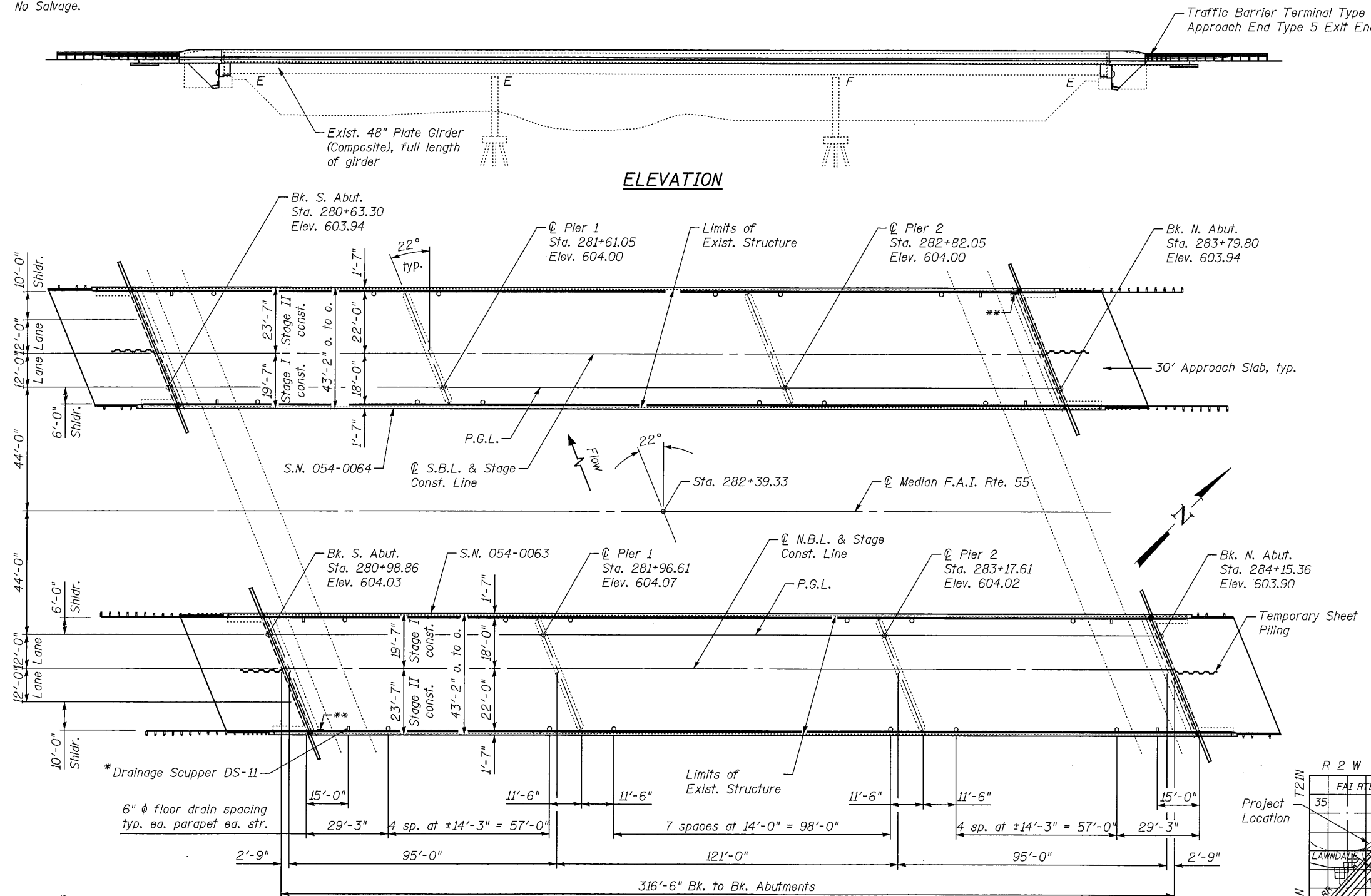

PROPOSED PROFILE
N.B. S.N. 054-0063
Along median edge of pavement

PROPOSED PROFILE
S.B. S.N. 054-0064
Along median edge of pavement

The profile grade depicts the final elevations after grinding. Up to 1/4" will be ground off the bridge deck and approach slab.

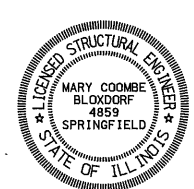

Mary Coombe Bloxdorf
ILLINOIS STRUCTURAL NO. 4859
EXPIRES 11/30/14
DATE: 3/13/13

GENERAL PLAN & ELEVATION
F.A.I. RTE. 55 OVER KICKAPOO CREEK
SECTION D6 LOGAN CO BR 2011-1
LOGAN COUNTY
STATION 282+39.33
STRUCTURE NO. 054-0063 (N.B.)
STRUCTURE NO. 054-0064 (S.B.)

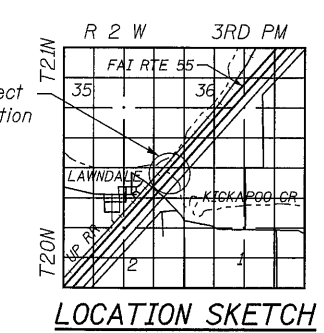

*Typical each corner
** Name Plate & Relocated existing Name Plate. The existing nameplate shall be cleaned and relocated next to the new name plate. Cost included with Name Plates.

PLAN

STATE OF ILLINOIS
DEPARTMENT OF TRANSPORTATION

FILE NAME = ...0540063-0064-72e11-001-gpo.dgn	USER NAME = J.M.L.	DESIGNED - RKM	REVISIONS -	STATE OF ILLINOIS DEPARTMENT OF TRANSPORTATION	SHEET NO. 1 OF 38 SHEETS
		CHECKED - MCB	REVISIONS -		
		DRAWN - CFC	REVISIONS -		
		CHECKED - RKM	REVISIONS -		
CB PROJECT NO 10007-3	PLOT SCALE = 42x8.000000 1/8" / IN.				
	PLOT DATE = 3/12/2013				
					ILLINOIS FED. AID PROJECT

CB Coombe-Bloxdorf P.C.
-CIVIL ENGINEERS-
-STRUCTURAL ENGINEERS-
-LAND SURVEYORS-
Design Firm License No. 184-002703

F.A.I. RTE.	SECTION	COUNTY	TOTAL SHEETS	SHEET NO.
55	D6 LOGAN CO BR 2011-1	LOGAN	429	286
				CONTRACT NO. 72E11