

**WEST CURB LINE**

Location	Station	Offset	Theoretical Grade Elevations	Theoretical Grade Elevations Adjusted For Grinding
S. End S. Approach	28067.33	-18.00	603.88	603.90
A	28077.33	-18.00	603.89	603.91
B	28087.33	-18.00	603.90	603.92
N. End S. Approach	28097.33	-18.00	603.91	603.93

**WEST EDGE OF PAVEMENT & PROFILE GRADE LINE**

Location	Station	Offset	Theoretical Grade Elevations	Theoretical Grade Elevations Adjusted For Grinding
S. End S. Approach	28069.76	-12.00	604.01	604.03
A	28079.76	-12.00	604.02	604.04
B	28089.76	-12.00	604.02	604.04
N. End S. Approach	28099.76	-12.00	604.03	604.05

**⊘ ROADWAY & STAGE CONSTRUCTION LINE**

Location	Station	Offset	Theoretical Grade Elevations	Theoretical Grade Elevations Adjusted For Grinding
S. End S. Approach	28074.61	0.00	604.20	604.22
A	28084.61	0.00	604.21	604.23
B	28094.61	0.00	604.22	604.24
N. End S. Approach	28104.61	0.00	604.22	604.24

**EAST EDGE OF PAVEMENT**

Location	Station	Offset	Theoretical Grade Elevations	Theoretical Grade Elevations Adjusted For Grinding
S. End S. Approach	28079.46	12.00	604.02	604.04
A	28089.46	12.00	604.02	604.04
B	28099.46	12.00	604.03	604.05
N. End S. Approach	28109.45	12.00	604.04	604.06

**EAST CURB LINE**

Location	Station	Offset	Theoretical Grade Elevations	Theoretical Grade Elevations Adjusted For Grinding
S. End S. Approach	28083.49	22.00	603.81	603.83
A	28093.49	22.00	603.82	603.84
B	28103.49	22.00	603.83	603.85
N. End S. Approach	28113.49	22.00	603.83	603.85

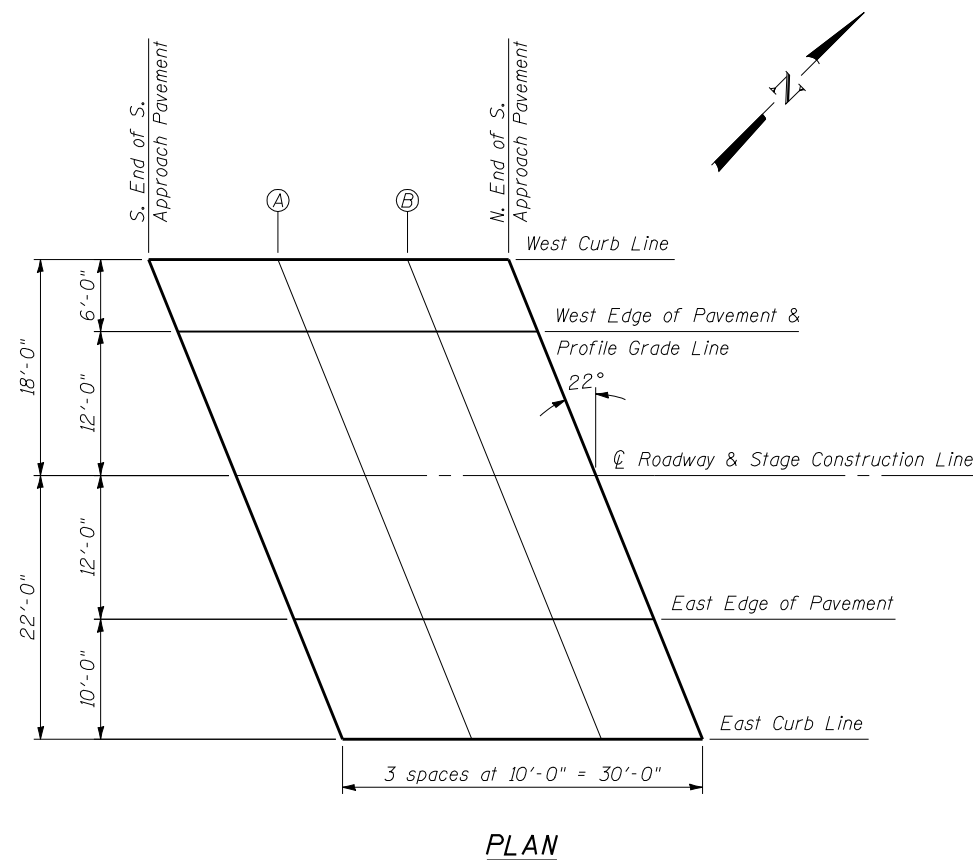

**PLAN**

E-AS1

7-1-10

FILE NAME =	USER NAME = .MML.	DESIGNED - RKM	REVISED -
...\\0540063-0064-72e11-015-slab-elevations-s-approach-nb.dgn		CHECKED - MCB	REVISED -
	PLOT SCALE = 16:0.000000 '1' / IN.	DRAWN - CFC	REVISED -
CB PROJECT NO 10007-3	PLOT DATE = 3/18/2013	CHECKED - RKM	REVISED -

**STATE OF ILLINOIS  
DEPARTMENT OF TRANSPORTATION**

**TOP OF APPROACH SLAB ELEVATIONS (S. APPROACH, N.B. STRUCTURE)  
STRUCTURE NO. 054-0063 (N.B.)**

SHEET NO. 15 OF 38 SHEETS

**CB** Coombe-Bloxdorf P.C.  
- CIVIL ENGINEERS -  
- STRUCTURAL ENGINEERS -  
- LAND SURVEYORS -  
Design Firm License No. 184-002703

F.A.I. RTE.	SECTION	COUNTY	TOTAL SHEETS	SHEET NO.
55	D6 LOGAN CO BR 2011-1	LOGAN	429	300
				CONTRACT NO. 72E11
ILLINOIS FED. AID PROJECT				