

Notes:  
 See sheet 20 of 39 for Sections C-C & D-D and View E-E.  
 $a_4(E)$  and  $a_5(E)$  bar spacings measured along Local Tangent.  
 The joint opening shall be determined per Article 520.04 except that on jointless structures, the distance described as the bridge length between the nearest fixed bearings each way from the joint shall be taken as half the bridge length plus the approach slab length. The minimum dimension shall be  $1\frac{1}{2}$ " for installation purposes.

\*\* Cost included with Concrete Superstructure.

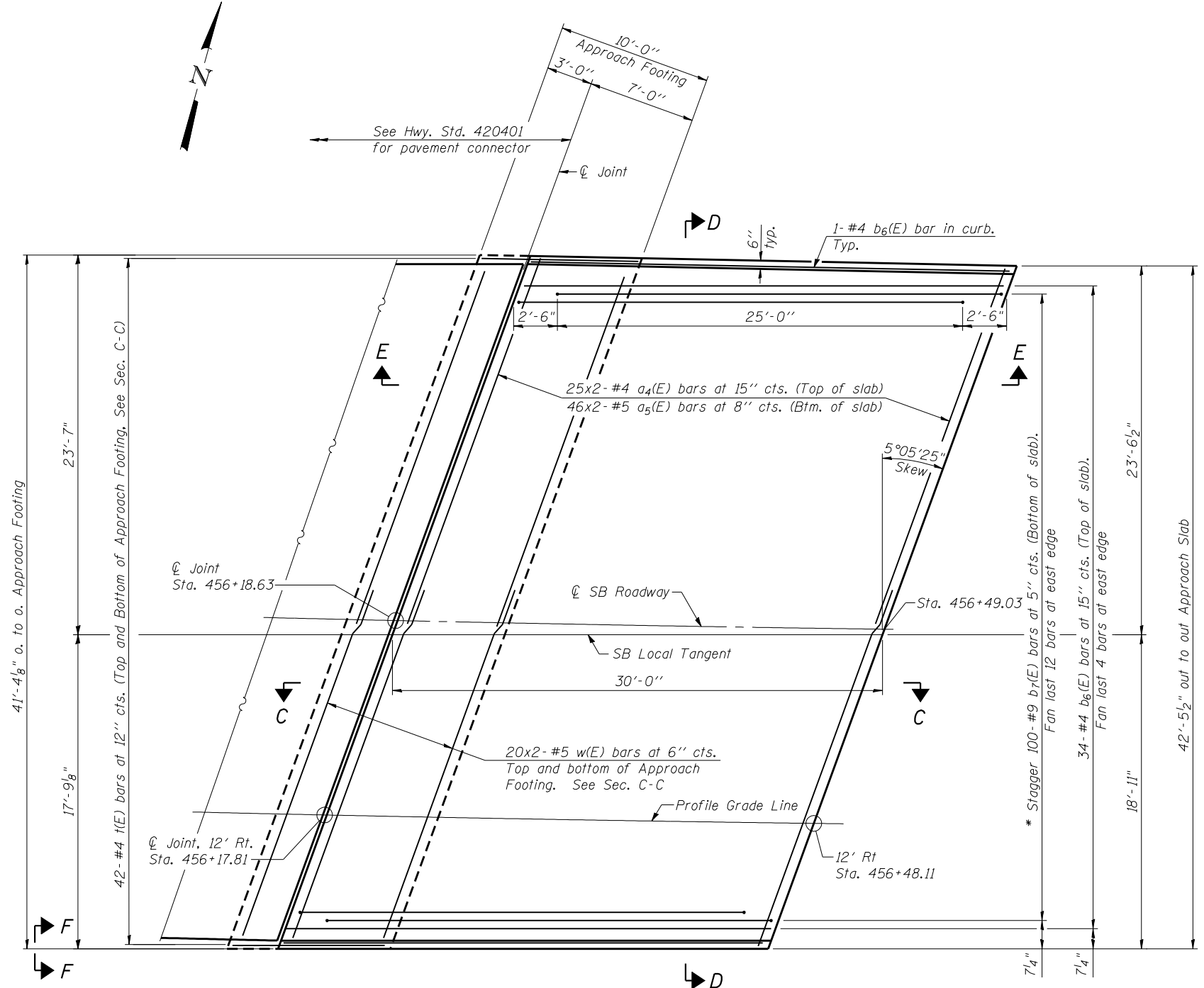

\* Tilt #9 b<sub>7</sub>(E) bars as required to maintain clearance.

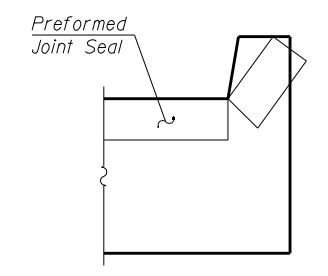
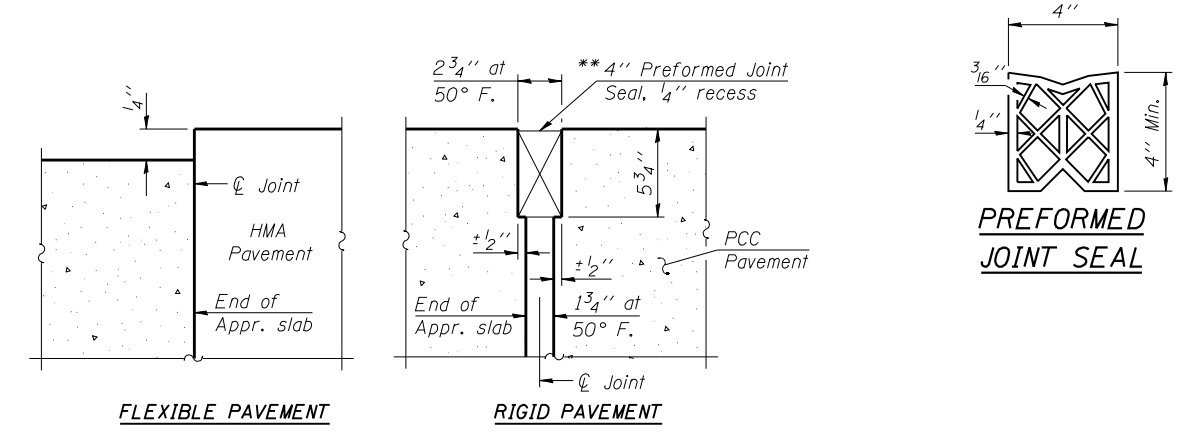

Angle Preformed Joint Seal at 45° at curbs when req'd for drainage.

MIN. BAR LAP

#4 bars 2'-4"

#5 bars 2'-7"

|                                            |                                   |                   |           |
|--------------------------------------------|-----------------------------------|-------------------|-----------|
| FILE NAME =                                | USER NAME = .MML                  | DESIGNED - GJB    | REVISED - |
| ...\\0540065-0066-72e11-018-s-appr-slab-sb | details.dgn                       | CHECKED - MCB/RKM | REVISED - |
| CB PROJECT NO. 10065-1                     | PLOT SCALE = 0:2.000000 '1' / IN. | DRAWN - CFC/MML   | REVISED - |
|                                            | PLOT DATE = 3/18/2013             | CHECKED - MCB/GJB | REVISED - |

STATE OF ILLINOIS  
 DEPARTMENT OF TRANSPORTATION

BRIDGE SOUTH APPROACH SLAB DETAILS (SOUTH BOUND STRUCTURE)  
 STRUCTURE NO. 054-0065 (N.B.) & 054-0066 (S.B.)

SHEET NO. 18 OF 39 SHEETS

**CB** Coombe-Bloxdorf P.C.  
 - CIVIL ENGINEERS -  
 - STRUCTURAL ENGINEERS -  
 - LAND SURVEYORS -  
 Design Firm License No. 184-002703

| F.A.I. RTE. | SECTION               | COUNTY | TOTAL SHEETS       | SHEET NO. |
|-------------|-----------------------|--------|--------------------|-----------|
| 55          | D6 LOGAN CO BR 2011-1 | LOGAN  | 429                | 341       |
|             |                       |        | CONTRACT NO. 72E11 |           |

ILLINOIS FED. AID PROJECT