

Hatched area indicates removal.

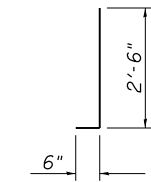

Bar d(E)

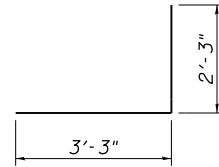

Bar d1(E)

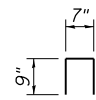

Bar d2(E)

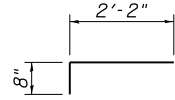

Bar x(E)

BILL OF MATERIAL

PER ABUTMENT

BAR	NUMBER OF BARS		TOTAL	SIZE	LENGTH	SHAPE
	STAGE I	STAGE II				
a (E)	10		10	#5	22'-8"	—
a1(E)		10	10	#5	18'-8"	—
d (E)	3	3	6	#5	3'-0"	J
d1(E)	3	3	6	#5	5'-6"	J
d2(E)	2	2	4	#4	2'-1"	□
h (E)	4		4	#6	21'-8"	—
h1(E)		4	4	#6	17'-8"	—
x (E)	23	19	42	#5	2'-10"	—
REINFORCEMENT BARS (EPOXY COATED)					POUND	850
CONCRETE REMOVAL					CU YD	6.0
CONCRETE SUPERSTRUCTURE					CU YD	6.0

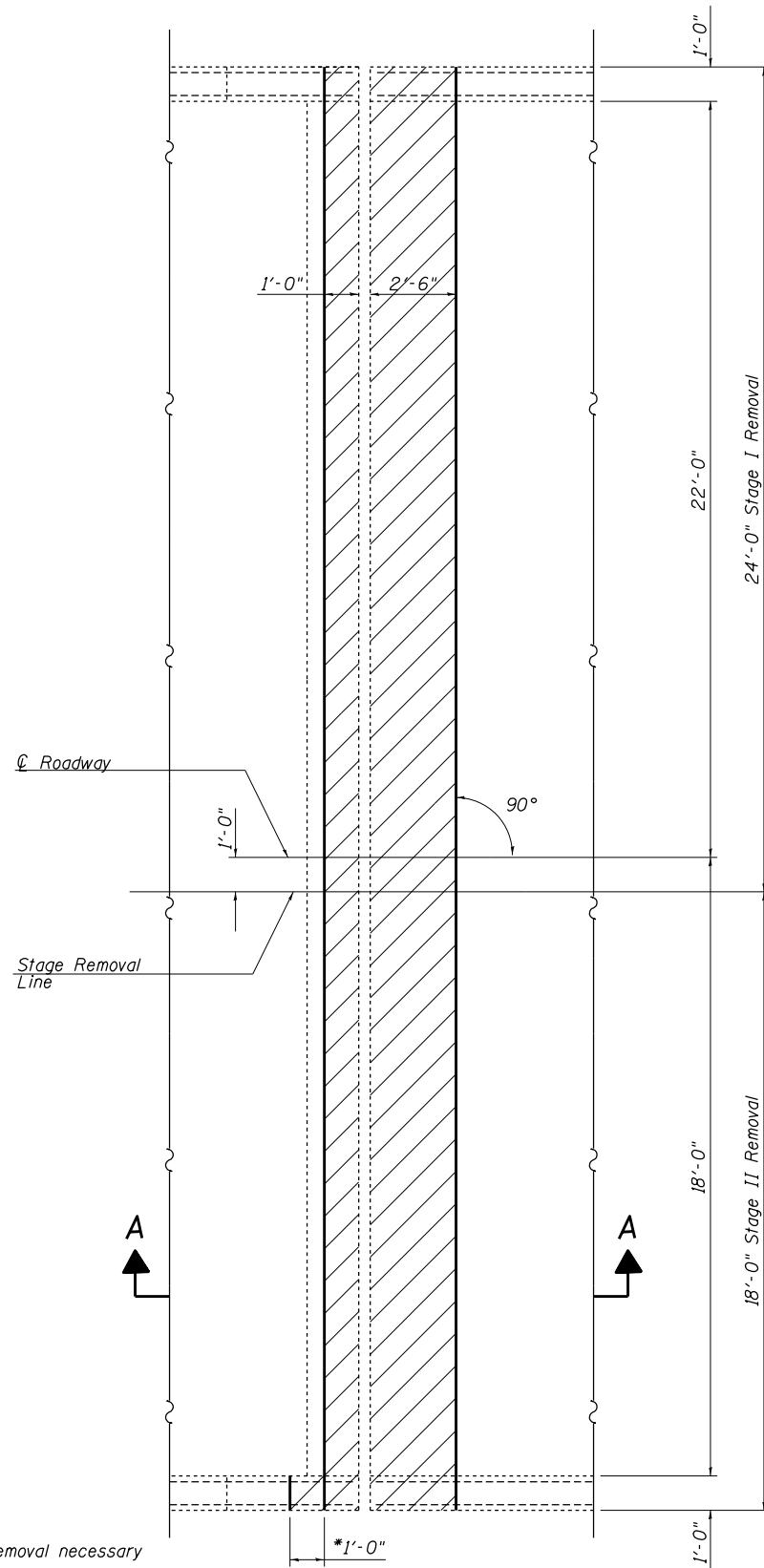

*Additional removal necessary at the northeast corner to accommodate the nameplate.

EXISTING PARTIAL PLAN
(South Abutment shown; North Abutment similar)

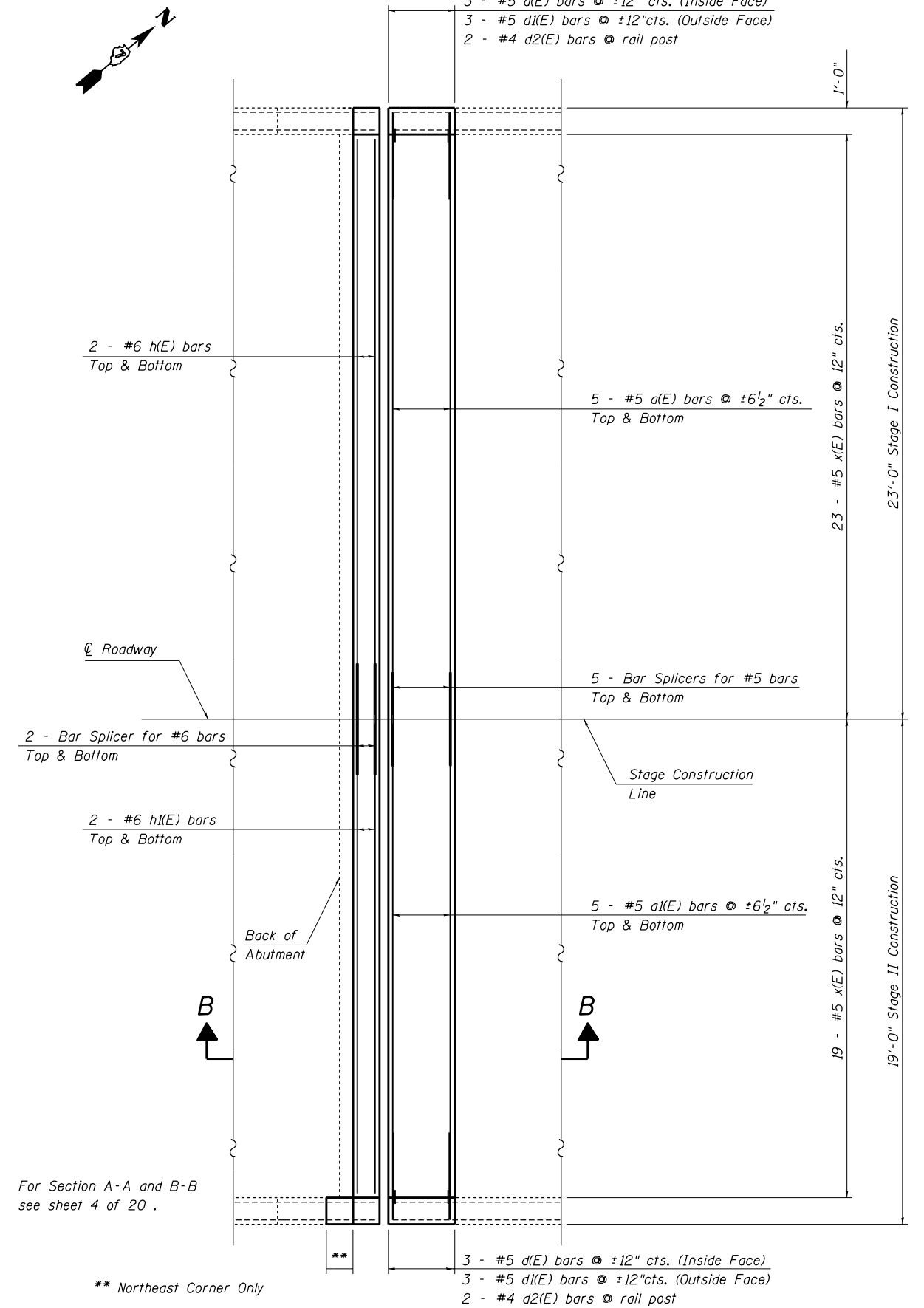

** Northeast Corner Only

For Section A-A and B-B see sheet 4 of 20.

PROPOSED PARTIAL PLAN
(South Abutment shown; North Abutment similar)

FILE NAME =	USER NAME = teasleyck	DESIGNED - KLB	REVISED -
ci:\pw\work\p\idot\teasleyck\d0181558\0774450-sht-brdetail1-0250068.dgn		DRAWN - KLB	REVISED -
	PLOT SCALE = 40.0000' / in.	CHECKED - MEA	REVISED -
	PLOT DATE = 10/18/2012	DATE - 05/31/12	REVISED -

STATE OF ILLINOIS
DEPARTMENT OF TRANSPORTATION

EXPANSION JOINT REPLACEMENT DETAILS
SN. 025-0068 (SB)

SCALE: SHEET NO. 3 OF 22 SHEETS STA. TO STA.

F.A.I. R.T.E.	SECTION	COUNTY	TOTAL SHEETS	SHEET NO.
57	.	**	84	59
CONTRACT NO. 74450			ILLINOIS FED. AID PROJECT	

(25-6-1)RS-8 & (13-1)RS-2
EFFINGHAM & CLAY COUNTIES