

# BILL OF MATERIAL

PER ABUTMENT

BAR	NUMBER OF BARS		TOTAL	SIZE	LENGTH	SHAPE
	STAGE I	STAGE II				
a2(E)	10		10	#5	26'-2"	—
a3(E)		10	10	#5	21'-6"	—
d2(E)	2	2	4	#4	2'-1"	□
d3(E)	3	3	6	#5	3'-3"	┘
d4(E)	3	3	6	#5	5'-4"	┘
h2(E)	4		4	#6	25'-0"	—
h3(E)		4	4	#6	20'-4"	—
x(E)	25	21	46	#5	2'-10"	┘
REINFORCEMENT BARS (EPOXY COATED)					POUND	970
CONCRETE REMOVAL					CU YD	7.9
CONCRETE SUPERSTRUCTURE					CU YD	7.9

Note: Trim existing longitudinal reinforcement to accommodate the new joint opening (Typ.)

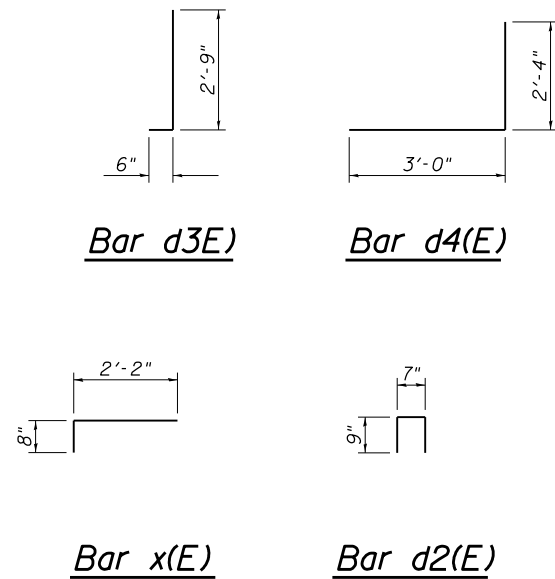

Bar d3(E)

Bar d4(E)

Bar x(E)

Bar d2(E)

Existing longitudinal and transverse deck reinforcement shall be incorporated into new construction.

Hatched area indicates removal.

\* Additional removal necessary at the northeast corner to accommodate the nameplate.

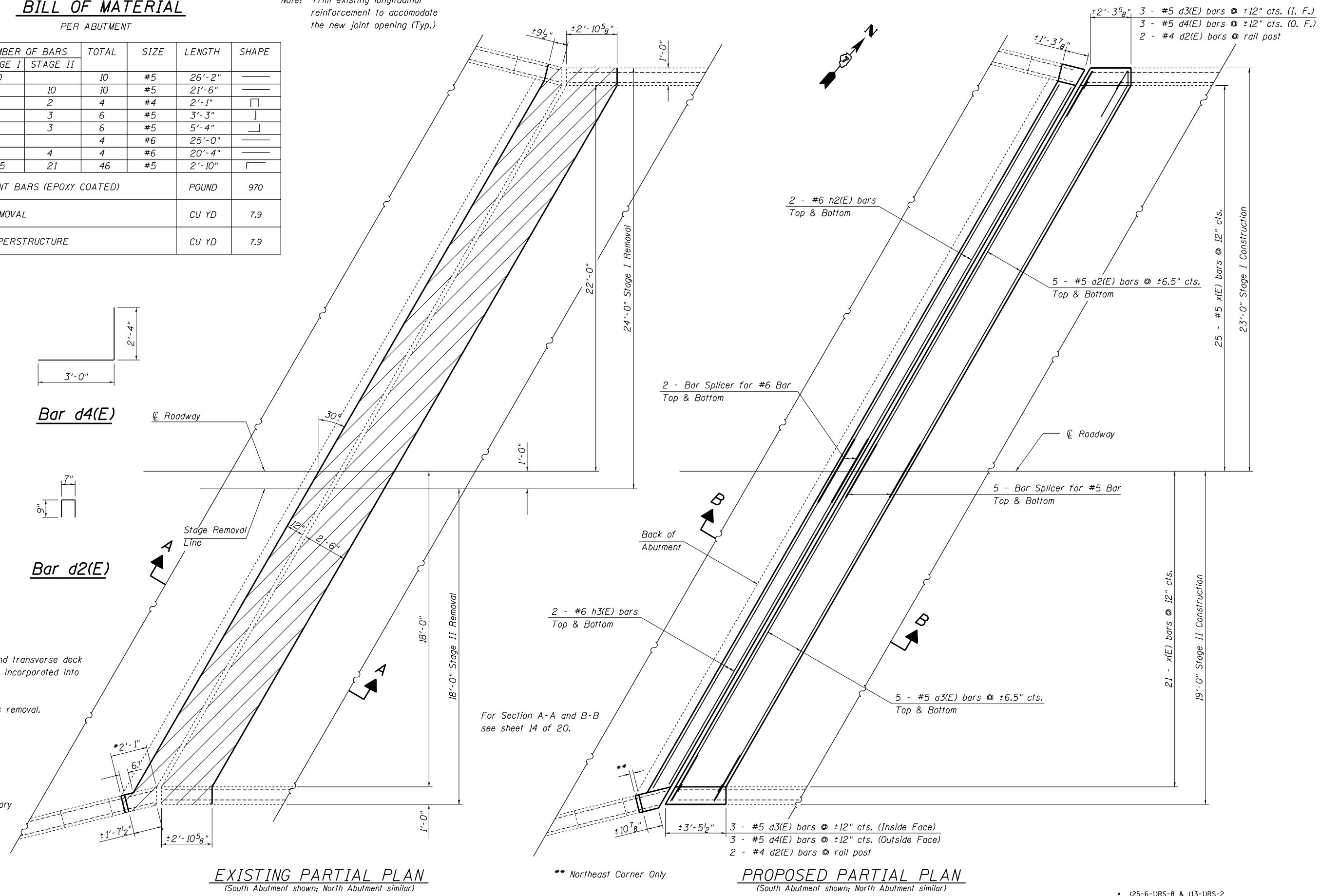

EXISTING PARTIAL PLAN  
(South Abutment shown; North Abutment similar)

\*\* Northeast Corner Only

PROPOSED PARTIAL PLAN  
(South Abutment shown; North Abutment similar)

FILE NAME =	USER NAME = teasleyck	DESIGNED - KLB	REVISED -
ei:\pwork\pwork\teasleyck\d0181558\0774450-sht-brdetails-0250070.dgn		DRAWN - KLB	REVISED -
	PLOT SCALE = 40.0000' / in.	CHECKED - MEA	REVISED -
	PLOT DATE = 10/18/2012	DATE - 05/31/12	REVISED -

STATE OF ILLINOIS  
DEPARTMENT OF TRANSPORTATION

EXPANSION JOINT REPLACEMENTS DETAILS			
SN. 025-0070 (SB)			
SCALE:	SHEET NO. 14 OF 22 SHEETS	STA.	TO STA.

F.A.I. RTE.	SECTION	COUNTY	TOTAL SHEETS	SHEET NO.
57	.	**	84	70
CONTRACT NO. 74450			ILLINOIS FED. AID PROJECT	

(25-6-1RS-8 & (13-1RS-2  
EFFINGHAM & CLAY COUNTIES