

STATE OF ILLINOIS
DEPARTMENT OF TRANSPORTATION
DIVISION OF HIGHWAYS

**PROPOSED
HIGHWAY PLANS**

FAP ROUTE 325 (IL 16)
SECTION 11-2RS-1,11RS-2,10RS-4
PROJECT NHP-0325(060)
BITUMINOUS RESURFACING
SHELBY COUNTY

C-97-116-10

F.A.P. RTE.	SECTION	COUNTY	TOTAL SHEETS	SHEET NO.
325	11-2 RS, 11RS-2, 10RS-4	SHELBY	19	1
		ILLINOIS	CONTRACT NO. 74474	

FOR INDEX OF SHEETS, SEE SHEET NO. 2

STATION EQUATIONS
STA 206+22.30 BK = STA 206+22.71 AH
STA 258+74.86 BK = STA 258+74.20 AH
STA 375+87.42 BK = STA 375+81.05 AH

ADT (2009) = 4,755

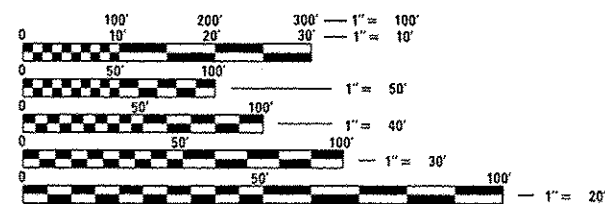
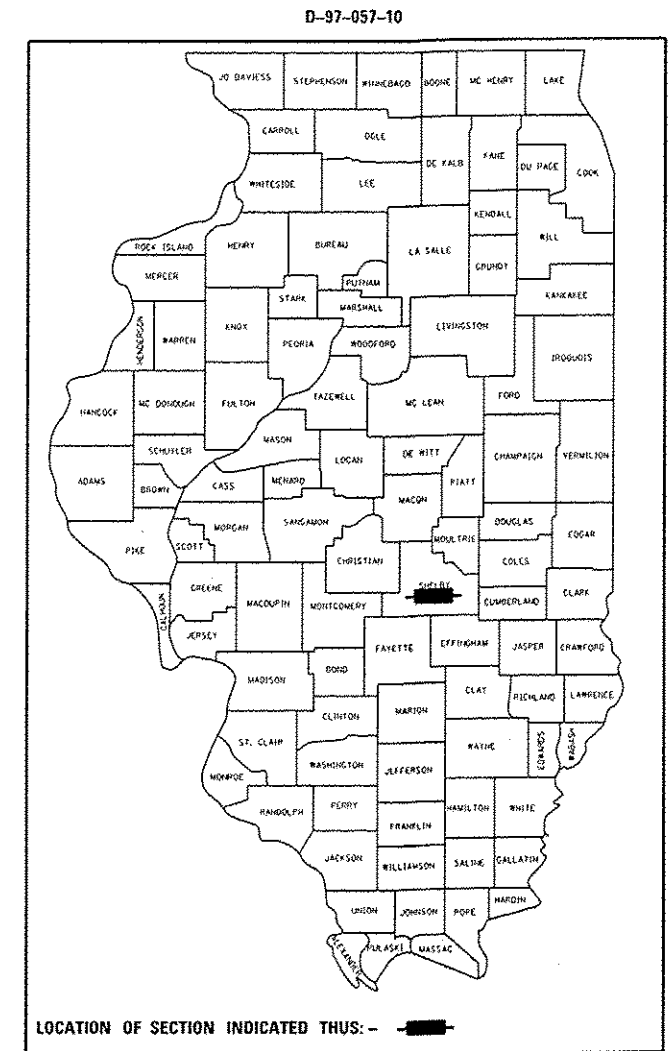

FULL SIZE PLANS HAVE BEEN PREPARED USING STANDARD ENGINEERING SCALES. REDUCED SIZED PLANS WILL NOT CONFORM TO STANDARD SCALES. IN MAKING MEASUREMENTS ON REDUCED PLANS, THE ABOVE SCALES MAY BE USED.

J.U.L.I.E.
JOINT UTILITY LOCATION INFORMATION FOR EXCAVATION
1-800-892-0123
OR 811

PROJECT ENGINEER: MARK DAUGHERTY
PROJECT MANAGER: BRIAN BIERMAN

CONTRACT NO. 74474

BRIDGE OMISSION
SN 087-0020
STA 107+54 TO
STA 110+03

PROJECT BEGINS
WASHINGTON ST.
STA 89+50

RAILROAD OMISSION
STA 92+29 TO
STA 93+05

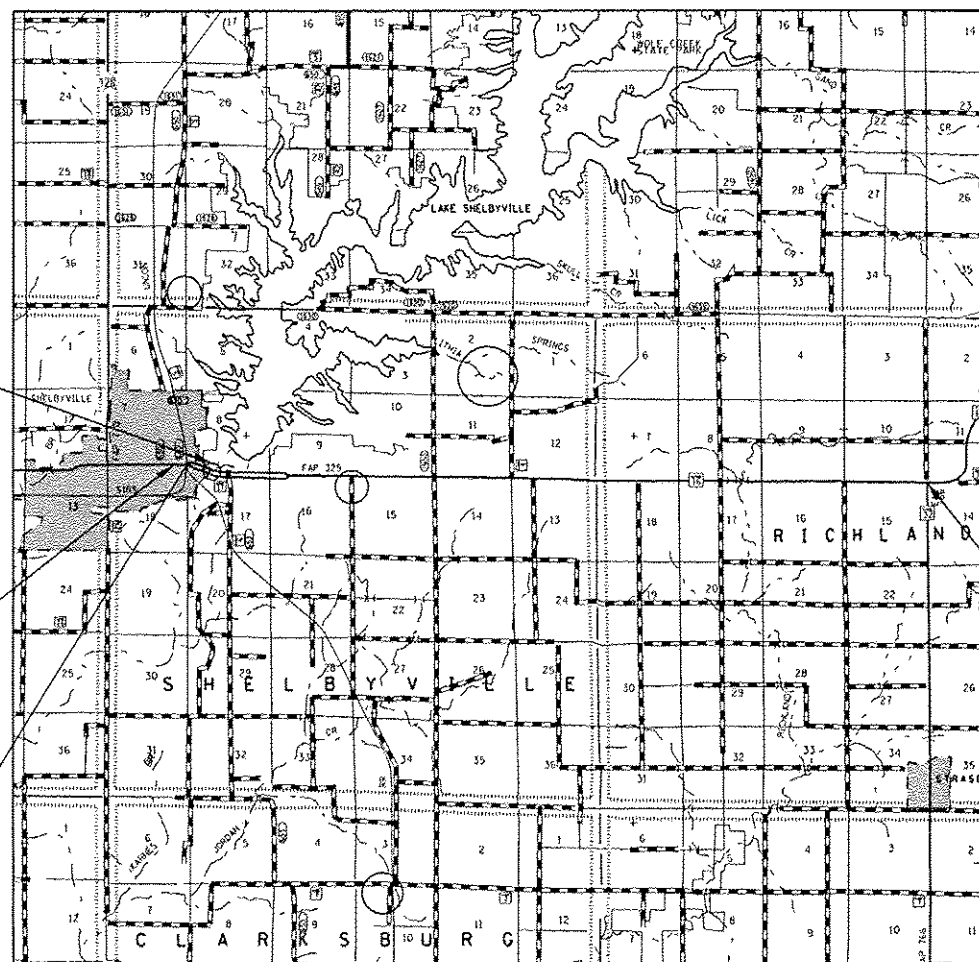

PROJECT ENDS
IL 32
STA 573+95

GROSS LENGTH = 48,452 FT. = 9.18 MILE
NET LENGTH = 48,203 FT. = 9.13 MILE

STATE OF ILLINOIS
DEPARTMENT OF TRANSPORTATION
DIVISION OF HIGHWAYS

SUBMITTED April 8 2013
Roger L. Dishell, P.E.
DEPUTY DIRECTOR OF HIGHWAYS, REGION ENGINEER

May 10 2013
John D. Baranzelli, P.E. JCB
acting ENGINEER OF DESIGN AND ENVIRONMENT

May 10 2013
Omer Osman, P.E. JCB
DIRECTOR OF HIGHWAYS, CHIEF ENGINEER

PRINTED BY THE AUTHORITY
OF THE STATE OF ILLINOIS

SUMMARY OF QUANTITIES			TOTAL QUANTITIES	CONSTRUCTION TYPE CODE		
CODE NO	ITEM	UNIT		0005 80% FED. 20% ST.		
40200800	AGGREGATE SURFACE COURSE, TYPE B	TON	12	12		
40600100	BITUMINOUS MATERIALS (PRIME COAT)	GALLON	38562	38562		
40600300	AGGREGATE (PRIME COAT)	TON	771	771		
40600635	LEVELING BINDER (MACHINE METHOD), N70	TON	8002	8002		
40600895	CONSTRUCTING TEST STRIP	EACH	2	2		
40600982	HOT-MIX ASPHALT SURFACE REMOVAL - BUTT JOINT	SO YD	171	171		
40600990	TEMPORARY RAMP	SO YD	272	272		
40603320	HOT-MIX ASPHALT SURFACE COURSE, MIX "C", N90	TON	16388	16388		
40800050	INCIDENTAL HOT-MIX ASPHALT SURFACING	TON	285	285		
44000155	HOT-MIX ASPHALT SURFACE REMOVAL, 1 1/2"	SO YD	1861	1861		
44000158	HOT-MIX ASPHALT SURFACE REMOVAL, 2 1/4"	SO YD	40625	40625		
44201785	CLASS D PATCHES, TYPE I, 12 INCH	SO YD	6	6		
44201789	CLASS D PATCHES, TYPE II, 12 INCH	SO YD	2446	2446		
44201794	CLASS D PATCHES, TYPE III, 12 INCH	SO YD	753	753		

SUMMARY OF QUANTITIES			TOTAL QUANTITIES	CONSTRUCTION TYPE CODE		
CODE NO	ITEM	UNIT		0005 80% FED. 20% ST.		
44201796	CLASS D PATCHES, TYPE IV, 12 INCH	SO YD	705	705		
44201871	CLASS D PATCHES, TYPE I, 19 INCH	SO YD	6	6		
44201875	CLASS D PATCHES, TYPE II, 19 INCH	SO YD	80	80		
44201879	CLASS D PATCHES, TYPE III, 19 INCH	SO YD	196	196		
44201881	CLASS D PATCHES, TYPE IV, 19 INCH	SO YD	867	867		
48102100	AGGREGATE WEDGE SHOULDER, TYPE B	TON	2469	2469		
64200108	SHOULDER RUMBLE STRIPS, 8 INCH	FOOT	80040	80040		
67000500	ENGINEER'S FIELD OFFICE, TYPE B	CAL MO	5	5		
67100100	MOBILIZATION	L SUM	1	1		
70100450	TRAFFIC CONTROL AND PROTECTION, STANDARD	L SUM	1	1		
	701201					
70100460	TRAFFIC CONTROL AND PROTECTION, STANDARD	L SUM	1	1		
	701306					
70102632	TRAFFIC CONTROL AND PROTECTION, STANDARD	L SUM	1	1		
	701602					

FILE NAME :	USER NAME :	DESIGNED -	REVISED -
c:\pwork\pwork\1\teasley\0330770\074474-sh-csq.dgn	teasley	DRAWN -	REVISED -
Default		CHECKED -	REVISED -
		DATE -	REVISED -

**STATE OF ILLINOIS
DEPARTMENT OF TRANSPORTATION**

SUMMARY OF QUANTITIES				
SCALE:	SHEET	OF	SHEETS	STA. TO STA.

F.A.P. RTE.	SECTION	COUNTY	TOTAL SHEETS	SHEET NO.
325	11-2 RSJ, IIRS-2, IORS-4	SHELBY	19	3
CONTRACT NO. 74474			ILLINOIS FED. AID PROJECT	

SUMMARY OF QUANTITIES			TOTAL QUANTITIES	CONSTRUCTION TYPE CODE		
CODE NO	ITEM	UNIT		0005 80% FED. 20% ST.		
70102635	TRAFFIC CONTROL AND PROTECTION, STANDARD	L SUM	1	1		
	701701					
70300100	SHORT TERM PAVEMENT MARKING	FOOT	17837	17837		
70301000	WORK ZONE PAVEMENT MARKING REMOVAL	SO FT	1982	1982		
* 78000100	THERMOPLASTIC PAVEMENT MARKING - LETTERS AND SYMBOLS	SO FT	744	744		
* 78000200	THERMOPLASTIC PAVEMENT MARKING - LINE 4"	FOOT	28099	28099		
* 78000400	THERMOPLASTIC PAVEMENT MARKING - LINE 6"	FOOT	2093	2093		
* 78000600	THERMOPLASTIC PAVEMENT MARKING - LINE 12"	FOOT	156	156		
* 78000650	THERMOPLASTIC PAVEMENT MARKING - LINE 24"	FOOT	144	144		
* 78001110	PAINT PAVEMENT MARKING - LINE 4"	FOOT	92960	92960		
* 78001140	PAINT PAVEMENT MARKING - LINE 8"	FOOT	150	150		
* 78001150	PAINT PAVEMENT MARKING - LINE 12"	FOOT	460	460		
* 78001180	PAINT PAVEMENT MARKING - LINE 24"	FOOT	60	60		
* 78100100	RAISED REFLECTIVE PAVEMENT MARKER	EACH	850	850		

SUMMARY OF QUANTITIES			TOTAL QUANTITIES	CONSTRUCTION TYPE CODE		
CODE NO	ITEM	UNIT		0005 80% FED. 20% ST.		
X4060995	TEMPORARY RAMP, SPECIAL	SO YD	344	344		
X4401198	HOT-MIX ASPHALT SURFACE REMOVAL, VARIABLE DEPTH	SO YD	149751	149751		
X7015005	CHANGEABLE MESSAGE SIGN	CAL DA	28	28		
Z0048665	RAILROAD PROTECTIVE LIABILITY INSURANCE	L SUM	1	1		
Z0049799	PROTECTING OR RESETTING SURVEY MARKERS	EACH	45	45		
Z0070202	SURVEY MARKER VAULT	EACH	32	32		

*SPECIALTY ITEM

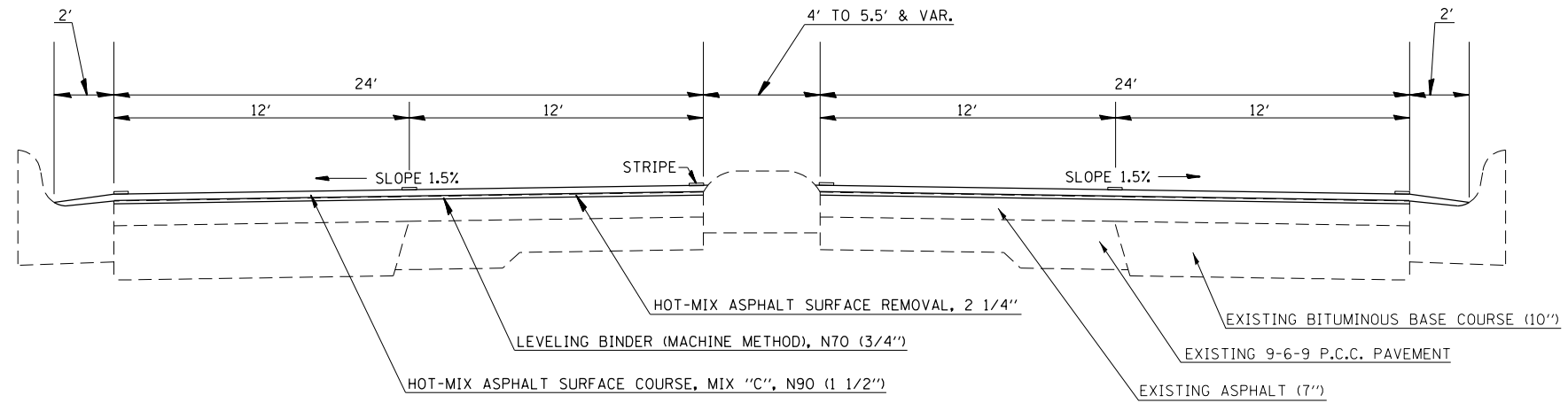

PROPOSED TYPICAL CROSS SECTION

STA 89+50 TO STA 92+81 - RASIED MEDIAN IS REPLACED WITH PAVEMENT
 RAILROAD OMISSION: STA 92+81 TO STA 92+90
 STA 92+90 TO STA 95+40

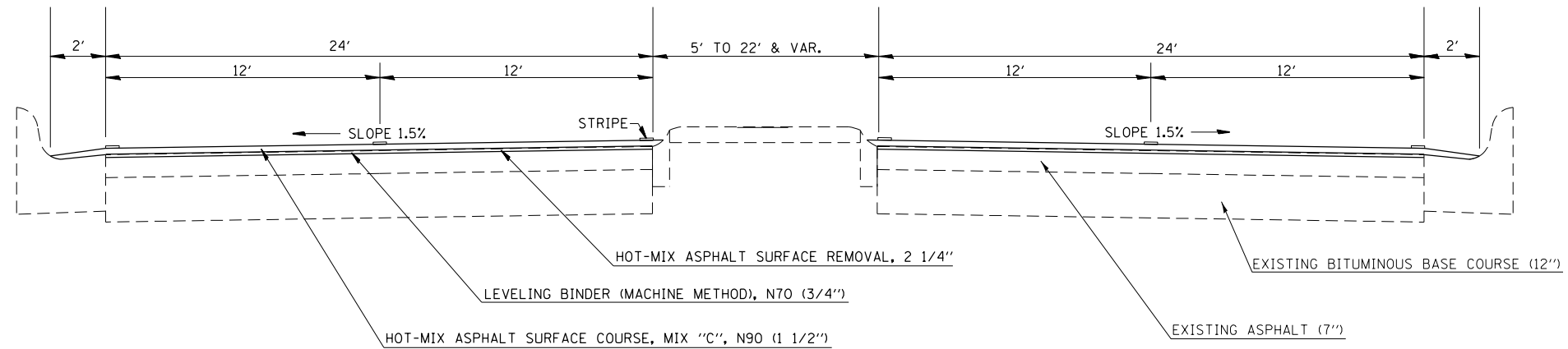

PROPOSED TYPICAL CROSS SECTION

STA 95+40 TO STA 107+54
 BRIDGE OMISSION: STA 107+54 TO STA 110+03
 STA 110+03 TO STA 144+99

FILE NAME =	USER NAME = teasleyck	DESIGNED -	REVISED -	STATE OF ILLINOIS DEPARTMENT OF TRANSPORTATION	TYPICALS			F.A.P. RTE.	SECTION	COUNTY	TOTAL SHEETS	SHEET NO.
ci:\pw\work\p\midot\teasleyck\d0338770\07	4474-sh-typicals.dgn	DRAWN -	REVISED -					325	11-2 RS1.IIRS-2.IORS-4	SHELBY	19	5
Default	PLOT SCALE = 100.0000' / in.	CHECKED -	REVISED -		SCALE: SHEET OF SHEETS STA. TO STA.			CONTRACT NO. 74474				
	PLOT DATE = 4/9/2013	DATE -	REVISED -		ILLINOIS FED. AID PROJECT							

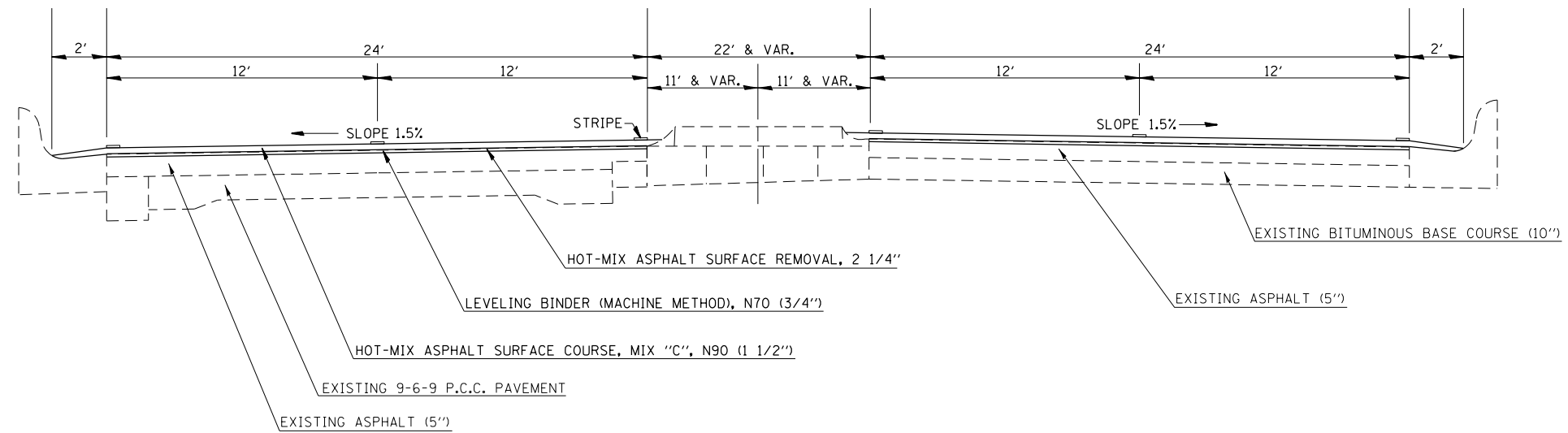

PROPOSED TYPICAL CROSS SECTION
STA 144+99 TO STA 148+99

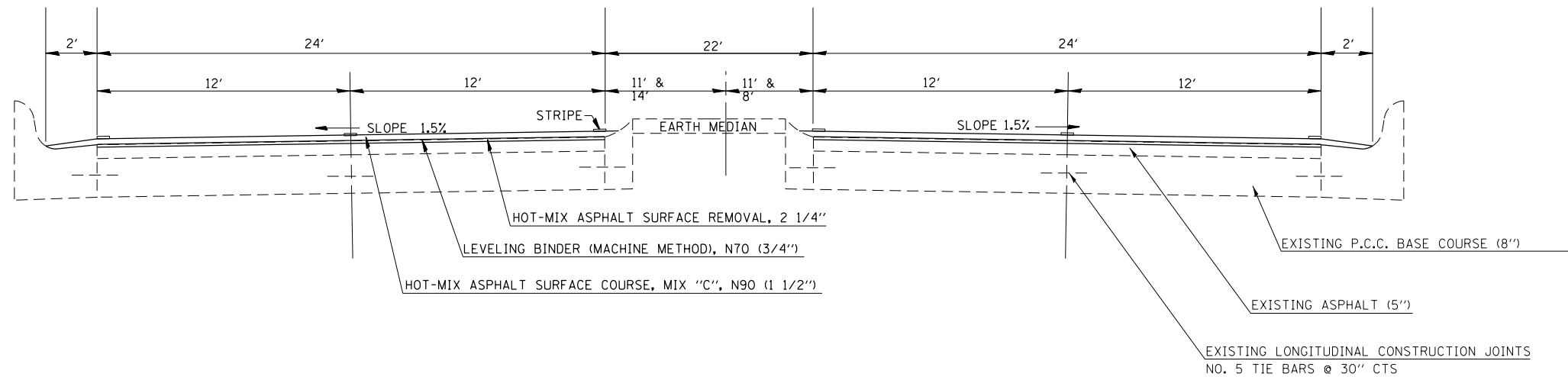

PROPOSED TYPICAL CROSS SECTION
STA 148+99 TO STA 162+64

NOTE: RT STA 150+03 TO RT STA 162+64 - CURB AND GUTTER IS REPLACED WITH AGGREGATE SHOULDER, 3' AGGREGATE WEDGE SHOULDER, TYPE B IS PROPOSED
LT STA 158+02 TO LT STA 162+64 - CURB AND GUTTER IS REPLACED WITH AGGREGATE SHOULDER, 3' AGGREGATE WEDGE SHOULDER, TYPE B IS PROPOSED

FILE NAME =	USER NAME = teasleyck	DESIGNED -	REVISED -
c:\pwwork\pwwork\teasleyck\d0338770\07	4474-sh-typicals.dgn	DRAWN -	REVISED -
Default	PLOT SCALE = 100.0000' / in.	CHECKED -	REVISED -
	PLOT DATE = 4/9/2013	DATE -	REVISED -

STATE OF ILLINOIS
DEPARTMENT OF TRANSPORTATION

SCALE:		SHEET	OF	SHEETS	STA.	TO	STA.
--------	--	-------	----	--------	------	----	------

F.A.P. RTE.	SECTION	COUNTY	TOTAL SHEETS	SHEET NO.
325	11-2 RS1.IIRS-2.IORS-4	SHELBY	19	6
CONTRACT NO. 74474			ILLINOIS FED. AID PROJECT	

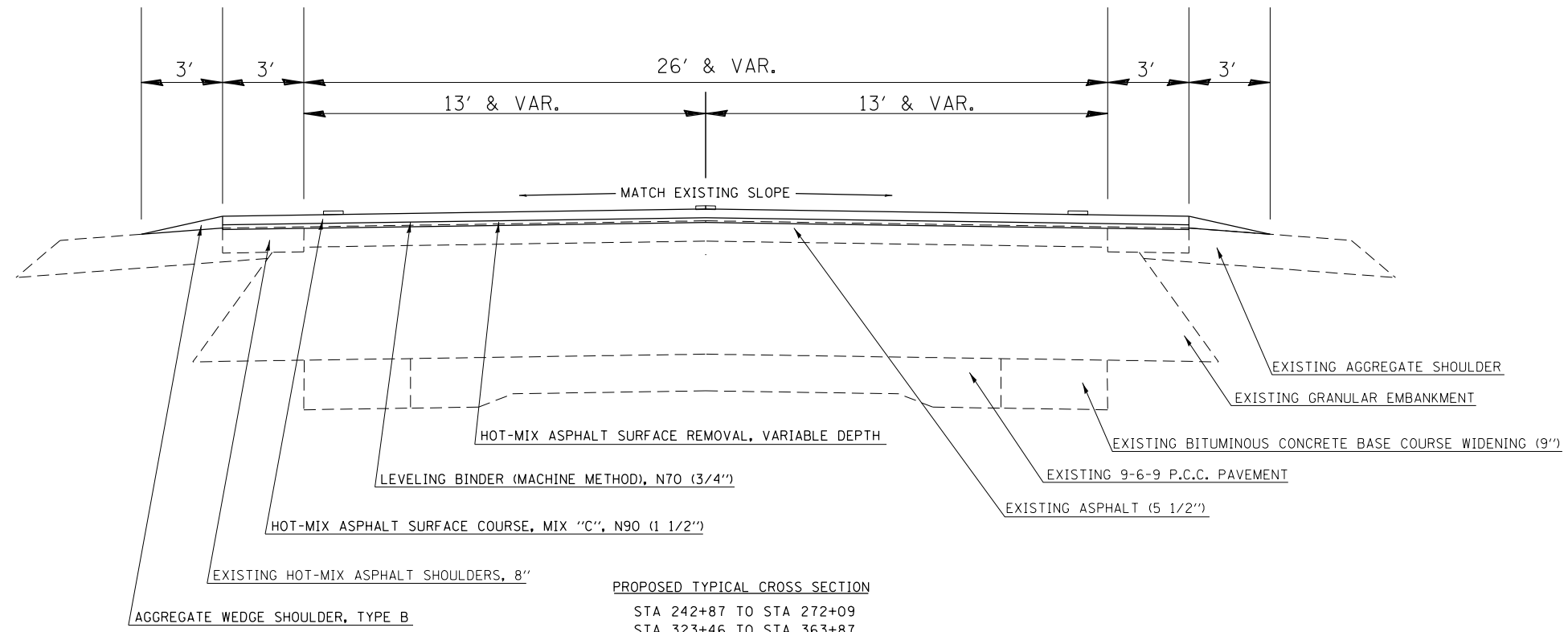

PROPOSED TYPICAL CROSS SECTION
 STA 242+87 TO STA 272+09
 STA 323+46 TO STA 363+87
 STA 510+97 TO STA 521+96

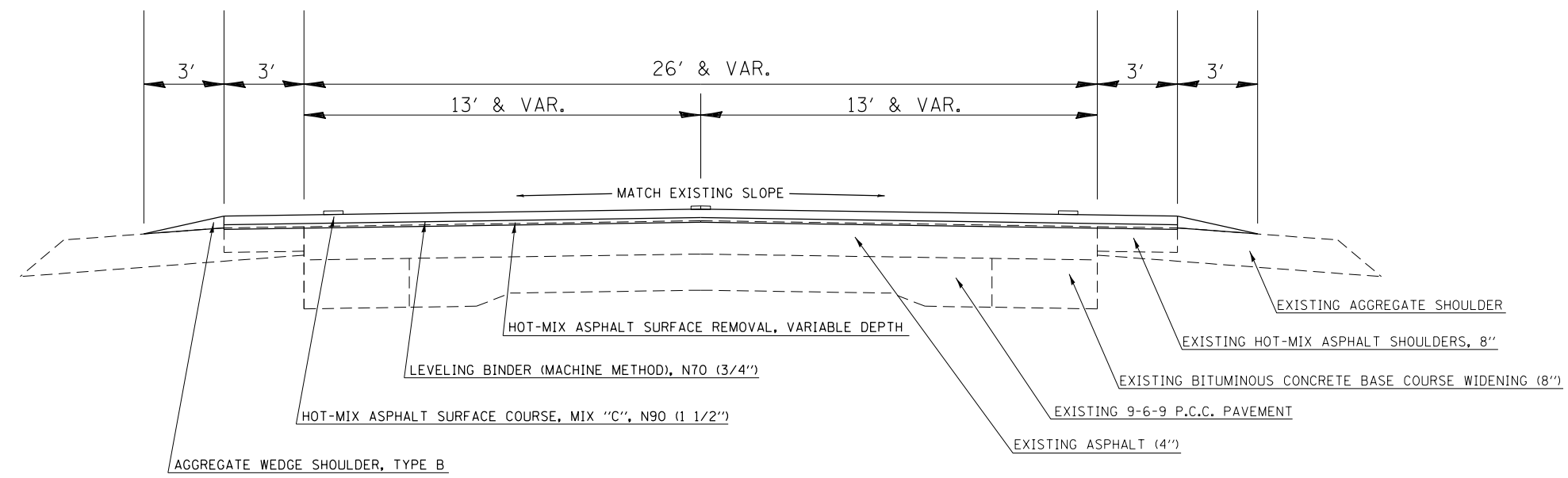

PROPOSED TYPICAL CROSS SECTION
 STA 162+64 TO STA 242+87
 STA 272+09 TO STA 323+46
 STA 363+87 TO STA 510+97
 STA 521+96 TO STA 573+95

FILE NAME =	USER NAME = teasleyck	DESIGNED -	REVISED -	STATE OF ILLINOIS DEPARTMENT OF TRANSPORTATION	TYPICALS			F.A.P. RTE.	SECTION	COUNTY	TOTAL SHEETS	SHEET NO.
c:\pwork\pwork\teasleyck\d0338770\07	4474-sh-typicals.dgn	DRAWN -	REVISED -					325	11-2 RS1.IIRS-2.IORS-4	SHELBY	19	7
Default	PLOT SCALE = 100.0000' / in.	CHECKED -	REVISED -		SCALE: SHEET OF SHEETS STA. TO STA.			CONTRACT NO. 74474				
	PLOT DATE = 4/9/2013	DATE -	REVISED -		ILLINOIS FED. AID PROJECT							

PAVEMENT SCHEDULE

STATION TO STATION	LENGTH	AVE. WIDTH	BINDER AVE. WIDTH	BITUMINOUS MATERIALS (PRIME COAT)	AGGREGATE (PRIME COAT)	TEMPORARY RAMP	HOT-MIX ASPHALT SURFACE REMOVAL - BUTT JOINT	HOT-MIX ASPHALT SURFACE REMOVAL, VARIABLE DEPTH	HOT-MIX ASPHALT SURFACE REMOVAL, 2 1/4"	HOT-MIX ASPHALT SURFACE REMOVAL, 1 1/2"	HMA SURFACE COURSE, MIX "C", N90	LEVELING BINDER (MACHINE METHOD), N70	AGGREGATE WEDGE SHOULDER, TYPE B	SHOULDER RUMBLE STRIPS, 8 INCH
IL 16	FOOT	FOOT	FOOT	GAL	TON	SQ YD	SQ YD	SQ YD	SQ YD	SQ YD	TON	TON	TON	FOOT
89+50 TO 90+18	68	50	46	73	1.5	44	-	-	348	-	32	15	-	-
90+18 TO 92+29	211	56	52	253	5.1	50	-	-	1219	-	110	51	-	-
92+29 TO 93+05	76													
RAILROAD OMISSION														
93+05 TO 100+96	791	52	48	879	17.6	46	-	-	4219	-	384	177	-	-
100+96 TO 102+27	131	58	54	163	3.3	-	-	-	786	-	71	33	-	-
102+27 TO 104+26	199	64	60	274	5.5	-	-	-	1327	-	119	56	-	-
104+26 TO 105+04	78	74	70	125	2.5	-	-	-	607	-	54	25	-	-
105+04 TO 107+54	250	52	48	278	5.6	46	-	-	1333	-	121	56	-	-
107+54 TO 110+03	249													
BRIDGE OMISSION														
110+03 TO 110+88	85	52	48	94	1.9	46.2	-	-	453	-	41	19	-	-
110+88 TO 112+31	143	58	54	178	3.6	-	-	-	858	-	77	36	-	-
112+31 TO 114+27	196	64	60	270	5.4	-	-	-	1307	-	117	55	-	-
114+27 TO 114+70	43	74	70	69	1.4	-	-	-	334	-	30	14	-	-
114+70 TO 116+41	171	52	48	190	3.8	-	-	-	912	-	83	38	-	-
116+41 TO 117+05	64	74	70	102	2.0	-	-	-	498	-	44	21	-	-
117+05 TO 119+10	205	64	60	282	5.6	-	-	-	1367	-	122	57	-	-
119+10 TO 120+85	175	58	54	218	4.4	-	-	-	1050	-	95	44	-	-
120+85 TO 121+78	93	52	48	103	2.1	-	-	-	496	-	45	21	-	-
121+78 TO 122+40	62	74	70	99	2.0	-	-	-	482	-	43	20	-	-
122+40 TO 127+58	518	52	48	576	11.5	-	-	-	2763	-	251	116	-	-
127+58 TO 128+10	52	74	70	83	1.7	-	-	-	404	-	36	17	-	-
128+10 TO 135+61	751	52	48	834	16.7	-	-	-	4005	-	364	168	-	-
135+61 TO 136+18	57	74	70	91	1.8	-	-	-	443	-	39	19	-	-
136+18 TO 138+53	235	52	48	261	5.2	-	-	-	1253	-	114	53	-	-
138+53 TO 140+03	150	57.5	53.5	185	3.7	-	-	-	892	-	81	37	-	-
140+03 TO 141+54	151	63	59	205	4.1	-	-	-	990	-	89	42	-	-
141+54 TO 142+07	53	74	70	85	1.7	-	-	-	412	-	37	17	-	-
142+07 TO 143+85	178	52	48	198	4.0	-	-	-	949	-	86	40	-	-
143+85 TO 145+45	160	57.5	53.5	197	3.9	-	-	-	951	-	86	40	-	-
145+45 TO 146+38	93	63	59	126	2.5	-	-	-	610	-	55	26	-	-
146+38 TO 146+92	54	74	70	86	1.7	-	-	-	420	-	37	18	-	-
146+92 TO 150+03	311	52	48	346	6.9	-	-	-	1659	-	151	70	-	-
150+03 TO 150+83	80	55.5	53.5	97	1.9	-	-	-	476	-	41	20	2	80
150+83 TO 151+56	73	61	59	97	1.9	-	-	-	479	-	42	20	2	73
151+56 TO 152+10	54	72	70	85	1.7	-	-	-	420	-	36	18	2	54
152+10 TO 155+09	299	65	63	425	8.5	-	-	-	2093	-	181	88	9	299
155+09 TO 156+03	94	72	70	148	3.0	-	-	-	731	-	63	31	3	94
156+30 TO 158+02	172	50	48	187	3.7	-	-	-	917	-	80	39	5	172
158+02 TO 160+00	198	48	48	211	4.2	-	-	-	1056	-	89	44	12	396
160+00 TO 162+49	249	40	40	221	4.4	-	-	-	1107	-	93	46	15	498
162+49 TO 243+68	8119	32	32	5774	115.5	-	-	28868	-	-	2425	1212	463	15009
243+68 TO 247+13	345	40.5	40.5	311	6.2	-	-	1553	-	-	130	65	20	645
247+13 TO 252+23	510	49	49	555	11.1	-	-	2777	-	-	233	117	24	794
252+23 TO 253+19	96	60	60	128	2.6	-	-	640	-	-	54	27	6	192
253+19 TO 256+06	287	46	46	293	5.9	-	-	1467	-	-	123	62	16	534
256+06 TO 375+87.42	11981.4	32	32	8520	170.4	-	-	42601	-	-	3578	1789	676	21903
375+87.42 TO 375+81.05														

PAVEMENT SCHEDULE (CONT.)

375+81.05 TO 561+01	18520	32	32	13170	263.4	-	-	65849	-	-	5531	2766	1132	36709
561+01 TO 563+73	272	38	38	230	4.6	-	-	1148	-	-	96	48	17	544
563+73 TO 566+25	252	44	44	246	4.9	-	-	1232	-	-	103	52	16	504
566+25 TO 568+27	202	52	52	233	4.7	-	-	1167	-	-	98	49	12	404
568+27 TO 573+65	538	41	41	490	9.8	-	-	2451	-	-	206	103	33	1076
573+65 TO 573+95	30	44	44	29	0.6	39	171	-	-	-	12	6	2	60
SIDEROADS:														
LT 104+61	-	-	-	18	0.4	-	-	-	-	-	179	15	-	-
LT 114+52	-	-	-	69	1.4	-	-	-	-	-	692	58	-	-
LT 141+72	-	-	-	99	2.0	-	-	-	-	-	990	83	-	-
				38562	771	272	171	149751	40625	1861	16388	8002	2469	80040

PATCHING SCHEDULE

LANE	CLASS D PATCHES, TYPE I, 12 INCH		CLASS D PATCHES, TYPE II, 12 INCH		CLASS D PATCHES, TYPE III, 12 INCH		CLASS D PATCHES, TYPE IV, 12 INCH		CLASS D PATCHES, TYPE I, 19 INCH		CLASS D PATCHES, TYPE II, 19 INCH		CLASS D PATCHES, TYPE III, 19 INCH		CLASS D PATCHES, TYPE IV, 19 INCH	
	SO YD	SO YD	SO YD	SO YD	SO YD	SO YD	SO YD	SO YD	SO YD	SO YD	SO YD	SO YD	SO YD	SO YD	SO YD	SO YD
EASTBOUND	3	1450	268	133	3	71	161	694								
WESTBOUND	3	996	485	572	3	9	35	173								
TOTALS:	6	2446	753	705	6	80	196	867								

PAVEMENT MARKING SCHEDULE

STATION TO STATION			PAINT PAVEMENT MARKING LINE 4"	THERMOPLASTIC PAVEMENT MARKING - LINE 4"	THERMOPLASTIC PAVEMENT MARKING - LINE 6"	PAINT PAVEMENT MARKING LINE 8"	PAINT PAVEMENT MARKING 12"	THERMOPLASTIC PAVEMENT MARKING - LINE 12"	PAINT PAVEMENT MARKING 24"	THERMOPLASTIC PAVEMENT MARKING - LINE 24"	THERMOPLASTIC PAVEMENT MARKING - LETTERS AND SYMBOLS	SHORT-TERM PAVEMENT MARKING	WORK ZONE PAVEMENT MARKING REMOVAL	RAISED REFLECTIVE PAVEMENT MARKER
STA.	TO	STA.	FT	FT	FT	FT	FT	FT	FT	FT	SO FT	FT	SO FT	EACH
89+95	TO	158+50	-	28099	1260	-	-	156	-	144	572	5124	569	195
158+50	TO	249+52	23688	-	-	-	140	-	-	-	-	2731	303	137
249+52	TO	254+75	1575	-	300	-	140	-	30	-	62	247	27	34
254+75	TO	554+50	60385	-	-	-	-	-	-	-	-	8993	999	375
554+50	TO	573+95	7312	-	533	150	180	-	30	-	109	743	83	111
TOTALS:			92960	28099	2093	150	460	156	60	144	744	17837	1982	850

NOTE: ALL PAVEMENT MARKING IN THE FOUR-LANE SECTION SHALL BE THERMOPLASTIC.
ALL TURN-LANE PAVEMENT MARKING SHALL BE THERMOPLASTIC.

SURVEY MARKER SCHEDULE

LOCATION	OFFSET	DESCRIPTION	PROTECTING OR RESETTING SURVEY MARKERS	SURVEY MARKER VAULT
			EACH	EACH
89+91.53	0	CIRCLE CUT IN PAVEMENT	1	1
P. C. 91+70.80	0	ALUM IDOT DISC (CL EBL)	1	1
P. O. C. 94E+00	0	ALUM IDOT DISC (CL WBL)	1	1
P. O. C. 99+00	0	ALUM IDOT DISC (CL WBL)	1	1
P. T. 105+38.45	0	ALUM IDOT DISC IN GRASS MEDIAN	1	1
P. O. T. 105+38.45	0	BRASS IDOT DISC IN GRASS MEDIAN	1	1
P. C. 105+96.49	0	BRASS IDOT DISC IN GRASS MEDIAN	1	1
P. O. C. 111+00	0	BRASS IDOT DISC IN GRASS MEDIAN	1	1
P. T. 119+87.81	0	BRASS IDOT DISC IN GRASS MEDIAN	1	1
120+15.41	9.88' RT	PINCHED PIPE IN GRASS MEDIAN	1	1
P. I. 132+99.41	0	BRASS IDOT DISC IN GRASS MEDIAN	1	1
P. O. T. 138+00	0	BRASS IDOT DISC IN GRASS MEDIAN	1	1
P. I. 145+00	0	BRASS IDOT DISC IN CONC CURB	1	1
P. O. T. 159+35.10	0	VALUT	1	-
159+67.57	30' LT	VAULT	1	-
172+86.68	25.6' LT	VAULT	1	-
P. I. 172+27.03	30' RT	IP	1	1
199+25	26.4' LT	VALUT	1	-
225+61	26.2' LT	VAULT	1	-
252+21.14	27'	VAULT	1	-
P. C. 299+44.36	0	VAULT	1	-
P. I. 302+59.21	1.3' LT	VAULT	1	-
302+61.00	0	VAULT	1	-
P. T. 305+73.65	0	VAULT	1	-
P. I. 318+89.34	0	ALUM IDOT DISC	1	1
P. I. 334+99.4	0	ALUM IDOT DISC	1	1
P. C. 350+20.80	0	ALUM IDOT DISC	1	1
P. T. 354+72.80	0	ALUM IDOT DISC	1	1
P. C. 356+92.52	0	ALUM IDOT DISC	1	1
P. T. 362+57.36	0	ALUM IDOT DISC	1	1
375+87.42 BK = 375+81.05 AH	0	ALUM IDOT DISC	1	1
P. I. 410+29.98	2' LT	ALUM IDOT DISC	1	1
SEC CORN 410+49.62	8.2' LT	VAULT	1	-
SEC CORN 436+99.73	0.2' RT	VAULT	1	-
P. I. 437+02.97	0	ALUM IDOT DISC	1	1
P. C. 456+20.07	0	MAG NAIL W/ WASHER	1	1
P. I. 462+65.51	0	ALUM DIOT DISC	1	1
P. T. 469+10.94	0	MAG NAIL W/ WASHER	1	1
SEC 503+11.64	2.5' RT	VAULT	1	-
SEC CORN/P. I. 516+40.48	1.8' RT	ALUM IDOT DISC	1	1
P. I. 89E+91.53	0	ALUM IDOT DISC	1	1
P. C. 575+36.19	0	BRASS DISC IN VAULT	1	1
P. I. 569+21.53	0	BRASS IDOT DISC IN VAULT	1	1
569+16.00	0	STEM OF BRASS DISC	1	1
P. I. 516+40.46	1.8 RT	ALUM IDOT DISC	1	1
TOTALS:			45	32

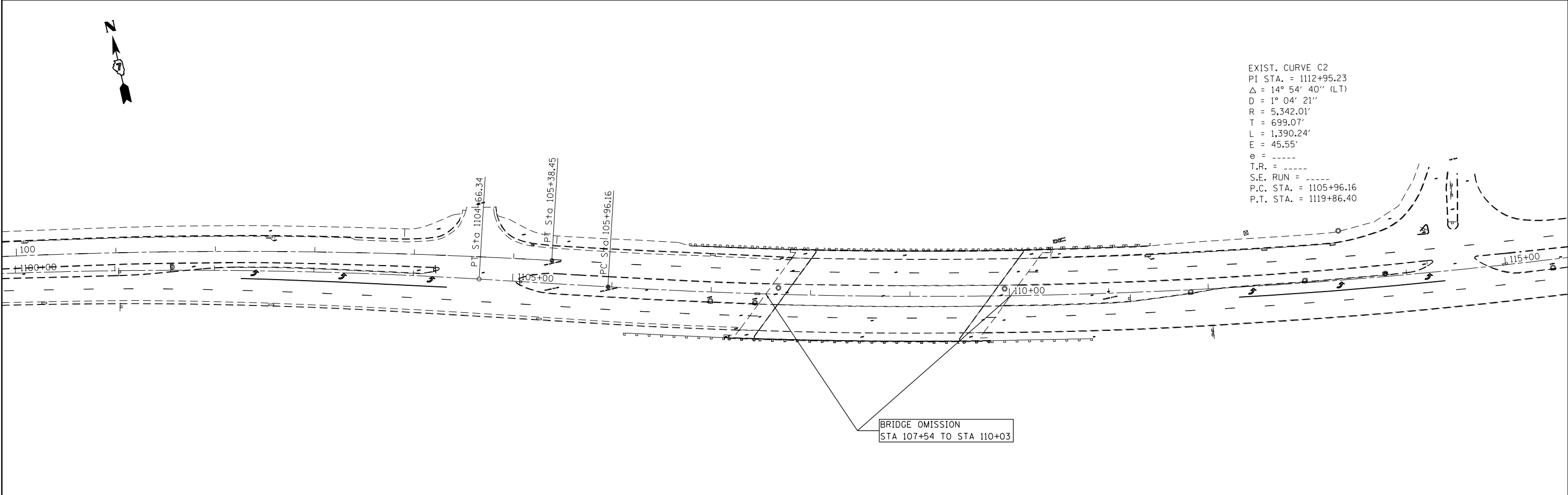
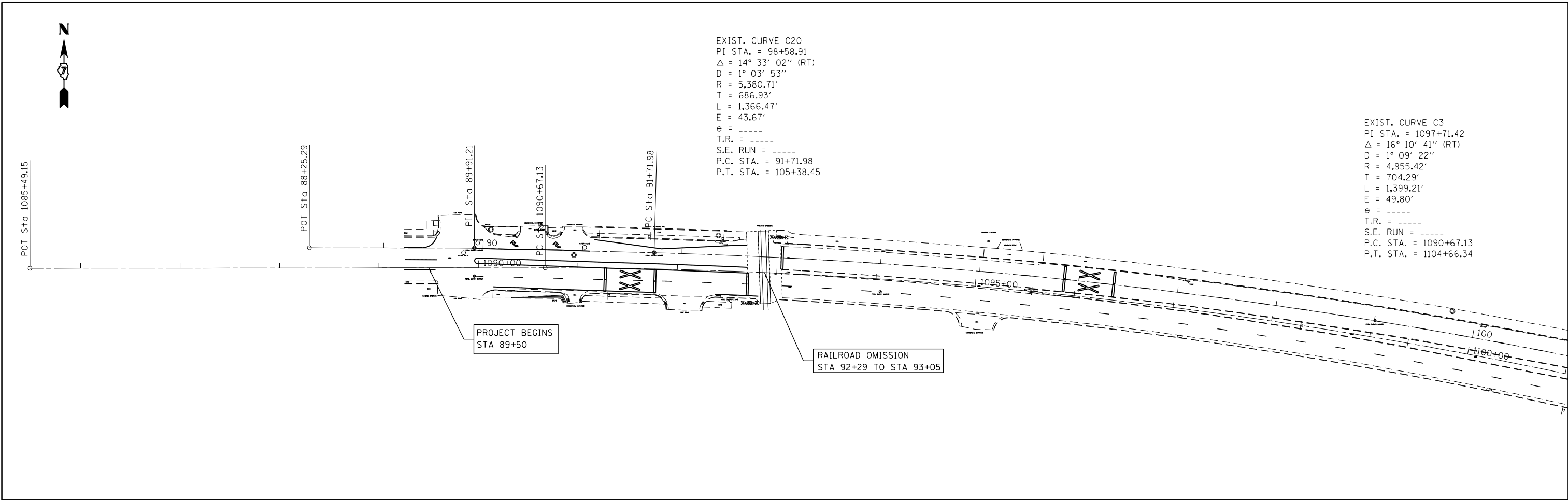

FILE NAME = c:\pw\work\p\midot\teasleyck\d0338770\07	USER NAME = teasleyck 4474-sh1-plan.dgn	DESIGNED - DRAWN -	REVISED - REVISED -	STATE OF ILLINOIS DEPARTMENT OF TRANSPORTATION	PLAN SHEET				F.A.P. RTE. 325	SECTION 11-2 RS1.IIRS-2.IORS-4	COUNTY SHELBY	TOTAL SHEETS 19	SHEET NO. 10
Default	PLOT SCALE = 100.0000' / in.	CHECKED -	REVISED -		SCALE:	SHEET	OF	SHEETS	STA.	TO	STA.	CONTRACT NO. 74474	
	PLOT DATE = 4/9/2013	DATE -	REVISED -		ILLINOIS FED. AID PROJECT								

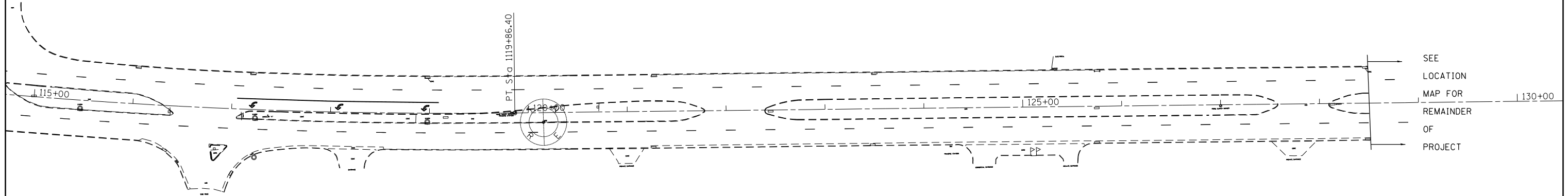

FILE NAME = c:\pw\work\p\idot\teasleyck\d0338770\07	USER NAME = teasleyck	DESIGNED -	REVISED -
	4474-sh1-plan.dgn	DRAWN -	REVISED -
	PLOT SCALE = 100.0000' / in.	CHECKED -	REVISED -
Default	PLOT DATE = 4/9/2013	DATE -	REVISED -

**STATE OF ILLINOIS
DEPARTMENT OF TRANSPORTATION**

PLAN SHEET

SCALE: SHEET OF SHEETS STA. TO STA.

F.A.P. RTE.	SECTION	COUNTY	TOTAL SHEETS	SHEET NO.
325	11-2 RS1.11RS-2.1ORS-4	SHELBY	19	11
ILLINOIS FED. AID PROJECT			CONTRACT NO. 74474	

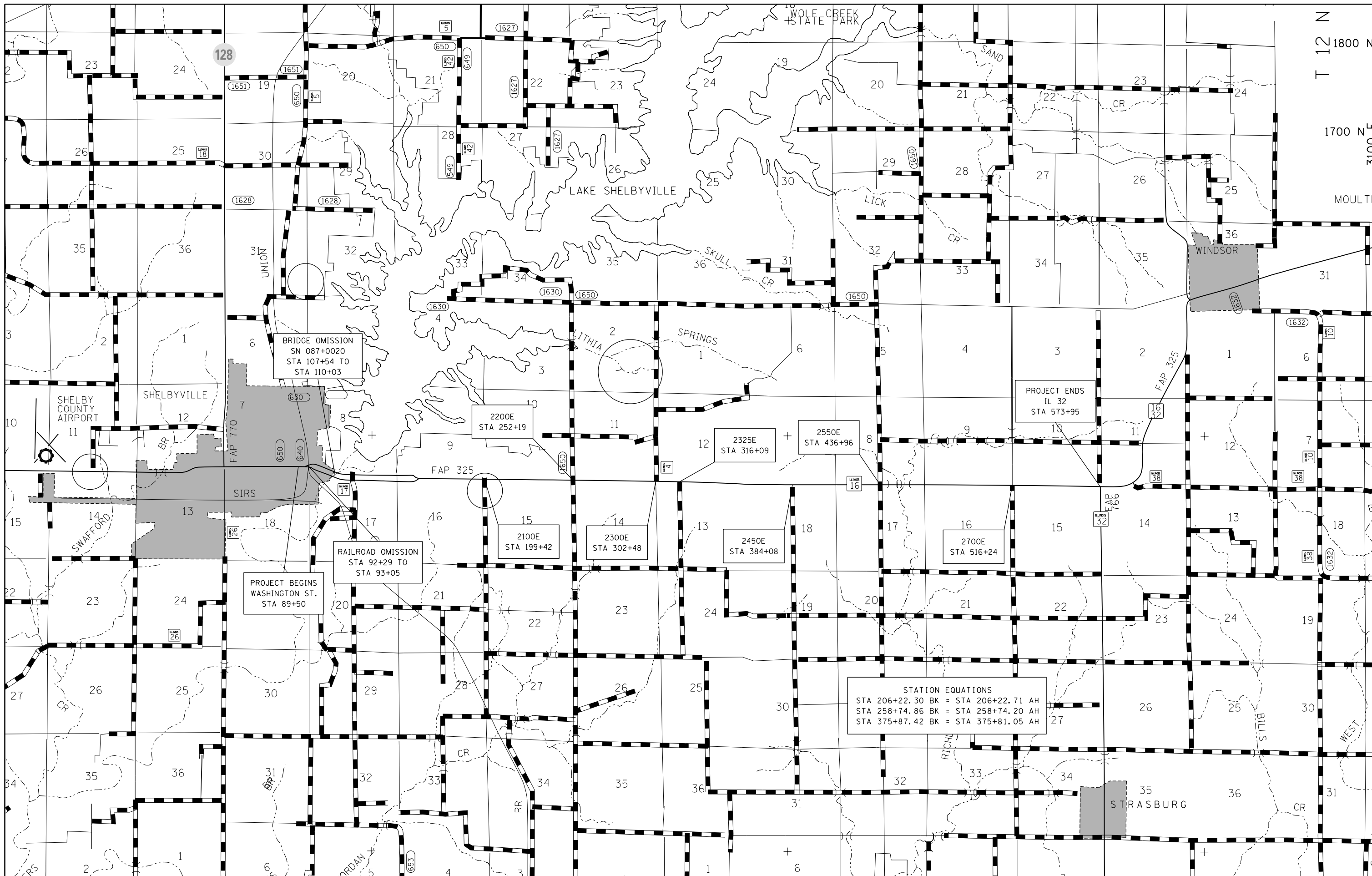

BRIDGE OMISSION
 SN 087+0020
 STA 107+54 TO
 STA 110+03

PROJECT BEGINS
 WASHINGTON ST.
 STA 89+50

RAILROAD OMISSION
 STA 92+29 TO
 STA 93+05

2200E
 STA 252+19

2325E
 STA 316+09

2550E
 STA 436+96

PROJECT ENDS
 IL 32
 STA 573+95

2100E
 STA 199+42

2300E
 STA 302+48

2450E
 STA 384+08

2700E
 STA 516+24

STATION EQUATIONS
 STA 206+22.30 BK = STA 206+22.71 AH
 STA 258+74.86 BK = STA 258+74.20 AH
 STA 375+87.42 BK = STA 375+81.05 AH

FILE NAME =	USER NAME = teasleyk	DESIGNED -	REVISED -
c:\pwwork\pwwork\teasleyk\d0338770\07	4474-shr-loc-map.dgn	DRAWN -	REVISED -
Default	PLOT SCALE = 100.0000' / in.	CHECKED -	REVISED -
	PLOT DATE = 4/9/2013	DATE -	REVISED -

STATE OF ILLINOIS
 DEPARTMENT OF TRANSPORTATION

LOCATION MAP

SCALE: SHEET OF SHEETS STA. TO STA.

F.A.P. RTE.	SECTION	COUNTY	TOTAL SHEETS	SHEET NO.
325	11-2 RS.11RS-2.10RS-4	SHELBY	19	12
CONTRACT NO. 74474			ILLINOIS FED. AID PROJECT	

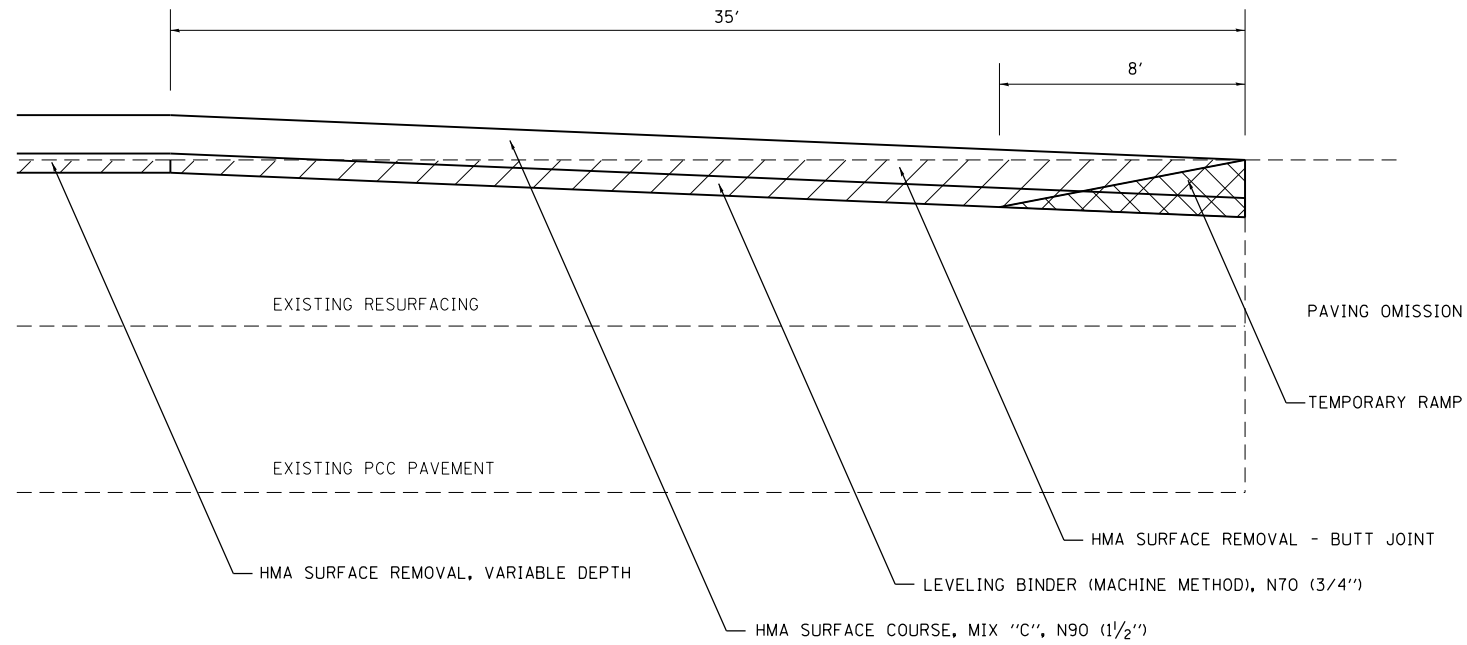

BUTT JOINT DETAIL
STA 573+60 TO STA 573+95

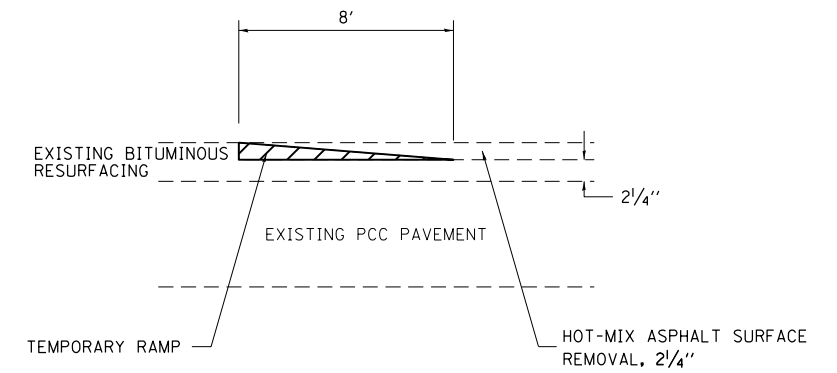

TEMPORARY RAMP DETAIL

STA 89+50 TO STA 89+58
 STA 92+21 TO STA 92+29
 STA 93+05 TO STA 93+13
 STA 107+46 TO STA 107+54
 STA 110+03 TO STA 110+11

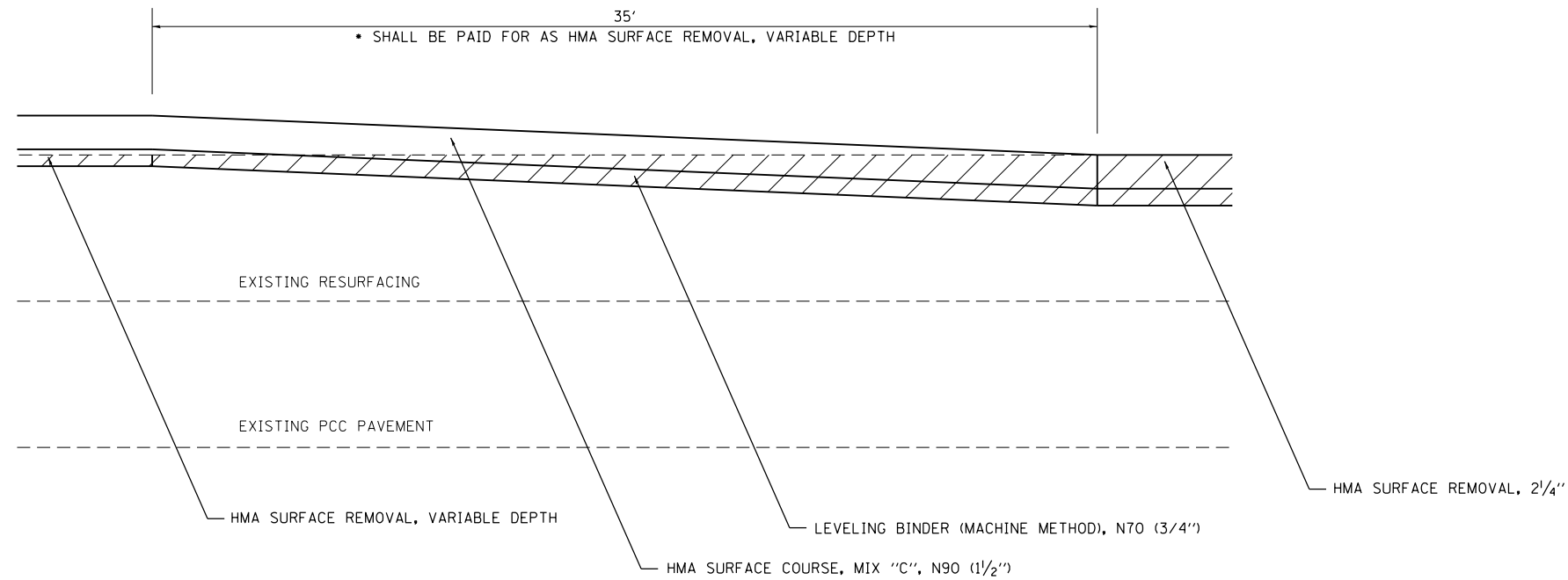

MILLING TRANSITION DETAIL
STA 162+49 TO STA 162+84

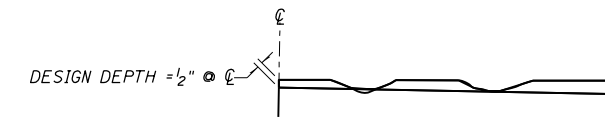

NOTES:

1. MILLING SHALL BE DONE TO ATTAIN A $\frac{3}{16}$ " SLOPE IN CROWN SECTIONS
2. EXISTING S.E. AND S.E. TRANSITIONS SHALL BE MAINTAINED UNLESS OTHERWISE SHOWN ON THE PLANS.
3. MILLING TO THE BOTTOM OF WHEEL RUTS SHALL NOT BE NECESSARY UNLESS REQUIRED TO OBTAIN SLOPE OR THE DESIGN DEPTH AT CENTERLINE.
4. THE AVERAGE DEPTH OF MILLING IS ESTIMATED TO BE $\frac{1}{2}$ " BUT MAY VARY IN ISOLATED LOCATIONS.

HOT-MIX ASPHALT SURFACE REMOVAL, VARIABLE DEPTH DETAIL

FILE NAME =	USER NAME = teasleyck	DESIGNED -	REVISED -
ci:\pw\work\p\dot\teasleyck\d0338770\074474-sh1-details.dgn		DRAWN -	REVISED -
Default	PLOT SCALE = 100.0000' / 1in.	CHECKED -	REVISED -
	PLOT DATE = 4/9/2013	DATE -	REVISED -

**STATE OF ILLINOIS
DEPARTMENT OF TRANSPORTATION**

PAVING DETAILS

SCALE: SHEET OF SHEETS STA. TO STA.

F.A.P. RTE.	SECTION	COUNTY	TOTAL SHEETS	SHEET NO.
325	11-2 RS1.IIRS-2.IORS-4	SHELBY	19	13
CONTRACT NO. 74474			ILLINOIS FED. AID PROJECT	

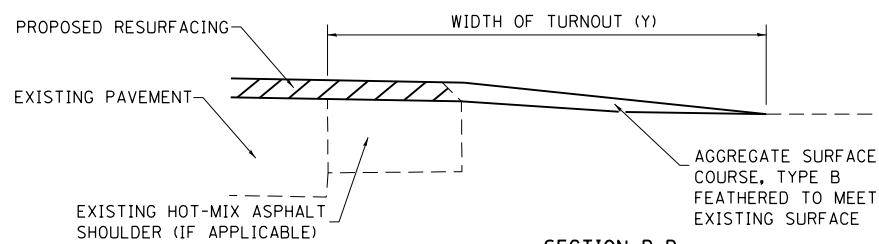
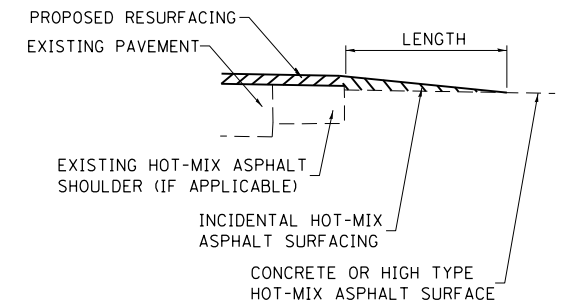
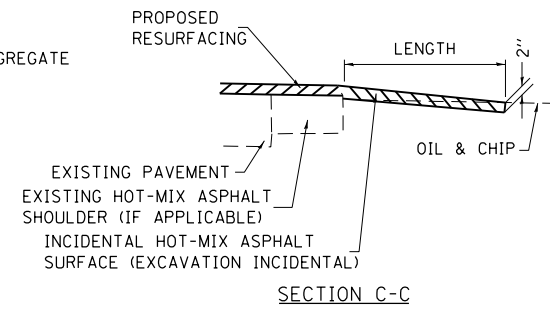
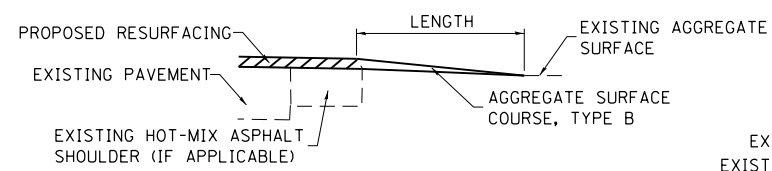
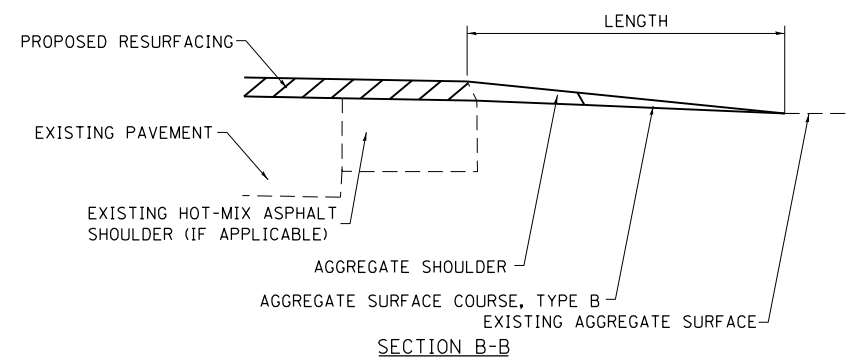
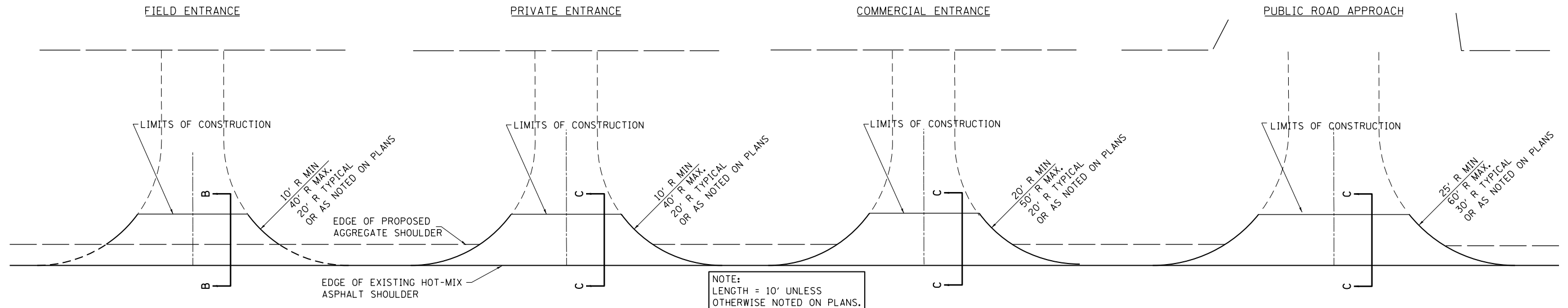

TYPICAL SECTION AT MAILBOX TURNOUT

NOTE: SEE STANDARD 406201 FOR MAILBOX TURNOUT DETAILS

NOTES

THE COST OF THE ASPHALT MATERIALS, AND AGGREGATE (PRIME COAT) FOR ENTRANCES AND PUBLIC ROADS AND APPROACHES SHALL BE INCLUDED IN THE PAY ITEM INCIDENTAL HOT-MIX ASPHALT SURFACING.

THE COST OF EXCAVATION IS INCLUDED IN THE PAY ITEM INCIDENTAL HOT-MIX ASPHALT SURFACING.

IF THERE IS NOT EXISTING HOT-MIX ASPHALT SHOULDER THEN THE ENTRANCE TAPER STARTS AT THE EDGE OF EXISTING PAVEMENT.

THE COST OF THE BITUMINOUS MATERIALS AND AGGREGATE (PRIME COAT) FOR ENTRANCES AND PUBLIC ROAD APPROACHES SHALL BE INCLUDED IN THE PAY ITEM INCIDENTAL HOT-MIX ASPHALT SURFACING.

SIDE	STATION	TYPE	INCIDENTAL HOT-MIX ASPHALT SURFACING	
			TON	TON
RT	164+01	PE	4.9	
LT	165+15	PE	1.5	
RT	168+26	PE	3.8	
RT	169+11	PE		2.1
LT	175+29	FE	2.1	
LT	186+24	FE	1.7	
RT	187+16	CE	2.7	
RT	188+66	CE	2.8	
RT	189+50	CE	3.0	
RT	193+29	CE	11.6	
LT	193+49	PE	1.3	
LT	194+35	PE	1.3	
LT	199+42	PRA	4.4	
RT	199+42	PRA	5.1	
RT	202+60	FE	2.2	
LT	207+25	PE	1.6	
LT	207+94	PE	1.5	
LT	209+16	FE	1.5	
RT	212+66	FE	2.1	
LT	218+41	PE	4.8	
LT	224+17	PE	2.5	
LT	225+89	PE	2.8	

SIDE	STATION	TYPE	INCIDENTAL HOT-MIX ASPHALT SURFACING	
			TON	TON
RT	230+73	FE	3.2	
RT	235+23	FE	1.7	
LT	242+10	FE	2.2	
LT	244+46	FE	2.8	
LT	252+19	PRA	8.3	
RT	252+19	PRA	4.7	
LT	254+59	PE	2.5	
RT	258+64	FE	1.7	
LT	259+05	FE	1.8	
RT	263+40	PE	4.1	
RT	264+77	PE	1.8	
RT	269+85	FE	2.1	
LT	269+85	FE	2.1	
RT	271+94	FE	1.3	
LT	275+30	FE	1.8	
LT	276+81	PE	2.0	
RT	277+89	MBT	3.4	
LT	277+89	PE	2.5	
RT	279+32	MBT	3.0	
LT	279+36	PE	3.7	
LT	280+48	PE	1.9	
RT	281+70	MBT	3.3	

SIDE	STATION	TYPE	INCIDENTAL HOT-MIX ASPHALT SURFACING	
			TON	TON
LT	281+76	PE	1.8	
LT	284+02	FE	2.2	
RT	284+58	FE	2.1	
RT	286+60	FE	1.9	
LT	287+81	CE	5.3	
RT	289+01	MBT	2.7	
LT	289+01	PE	2.7	
LT	291+32	CE	5.3	
LT	298+59	CE	3.2	
LT	302+48	PRA	8.1	
RT	302+27	FE	2.0	
RT	309+20	FE	1.8	
LT	311+21	FE	2.2	
LT	314+83	PE	3.9	
RT	316+09	PRA	3.9	
LT	316+60	FE	2.1	
RT	322+55	PE	2.2	
LT	322+55	MBT	2.2	
LT	325+17	FE	2.1	
RT	329+70	FE	2.9	
LT	334+50	MBT	3.5	
RT	334+50	PE	2.1	

SIDE	STATION	TYPE	INCIDENTAL HOT-MIX ASPHALT SURFACING	
			TON	TON
LT	336+35	FE	2.2	
RT	337+98	FE	2.0	
RT	343+46	FE	1.9	
RT	349+10	FE	2.0	
LT	349+46	FE	3.4	
RT	350+67	FE		2.1
LT	356+90	FE	2.5	
LT	359+09	PE	3.8	
LT	361+43	FE		2.9
LT	370+82	FE	1.9	
RT	371+40	FE	2.1	
RT	384+08	PRA	4.7	
LT	396+98	FE	2.2	
RT	397+34	FE	2.0	
LT	407+20	PE	2.0	
LT	408+59	PE	2.0	
LT	410+68	FE	1.9	
RT	410+68	FE	1.9	
RT	435+53	PE	2.1	
LT	436+96	PRA	3.5	
RT	436+96	PRA	3.7	
LT	449+26	FE	2.1	

SIDE	STATION	TYPE	INCIDENTAL HOT-MIX ASPHALT SURFACING	
			TON	TON
RT	451+76	FE	1.9	
LT	459+84	FE	2.2	
RT	461+08	FE	1.8	
RT	461+83	PE	2.9	
RT	463+18	PE	4.0	
LT	476+63	FE	2.9	
RT	482+40	PE		5.0
LT	489+84	FE	2.1	
RT	496+79	FE	2.0	
LT	503+02	FE	2.0	
LT	516+24	PRA	3.6	
RT	516+24	PRA	3.6	
LT	529+25	FE	2.0	
RT	529+25	FE	2.0	
RT	535+85	FE	2.0	
RT	548+81	FE	2.0	
LT	555+72	FE	2.2	
RT	555+72	FE	2.2	
TOTALS			285	12

FE=FIELD ENTRANCE PRA - PUBLIC ROAD APPROACH
 PE=PRIVATE ENTRANCE MBT - MAILBOX TURNOUT
 CE=COMMERCIAL ENTRANCE

FILE NAME =	USER NAME = teasleyck	DESIGNED - 08-03-99	REVISED - 03-13-07
ci:\pw\work\p\midot\teasleyck\d0338770\074474-sh-t-details.dgn		DRAWN -	REVISED -
		CHECKED -	REVISED -
		DATE -	REVISED -

**STATE OF ILLINOIS
 DEPARTMENT OF TRANSPORTATION**

**RURAL ENTRANCE SCHEDULE AND MAILBOX TURNOUT DETAILS
 WITH SHOULDERS**

SCALE: SHEET NO. OF SHEETS STA. TO STA.

F.A.P. RTE.	SECTION	COUNTY	TOTAL SHEETS	SHEET NO.
325	11-2 RS1.1IRS-2.1ORS-4	SHELBY	19	14
FED. ROAD DIST. NO. ILLINOIS FED. AID PROJECT			CONTRACT NO. 74474	

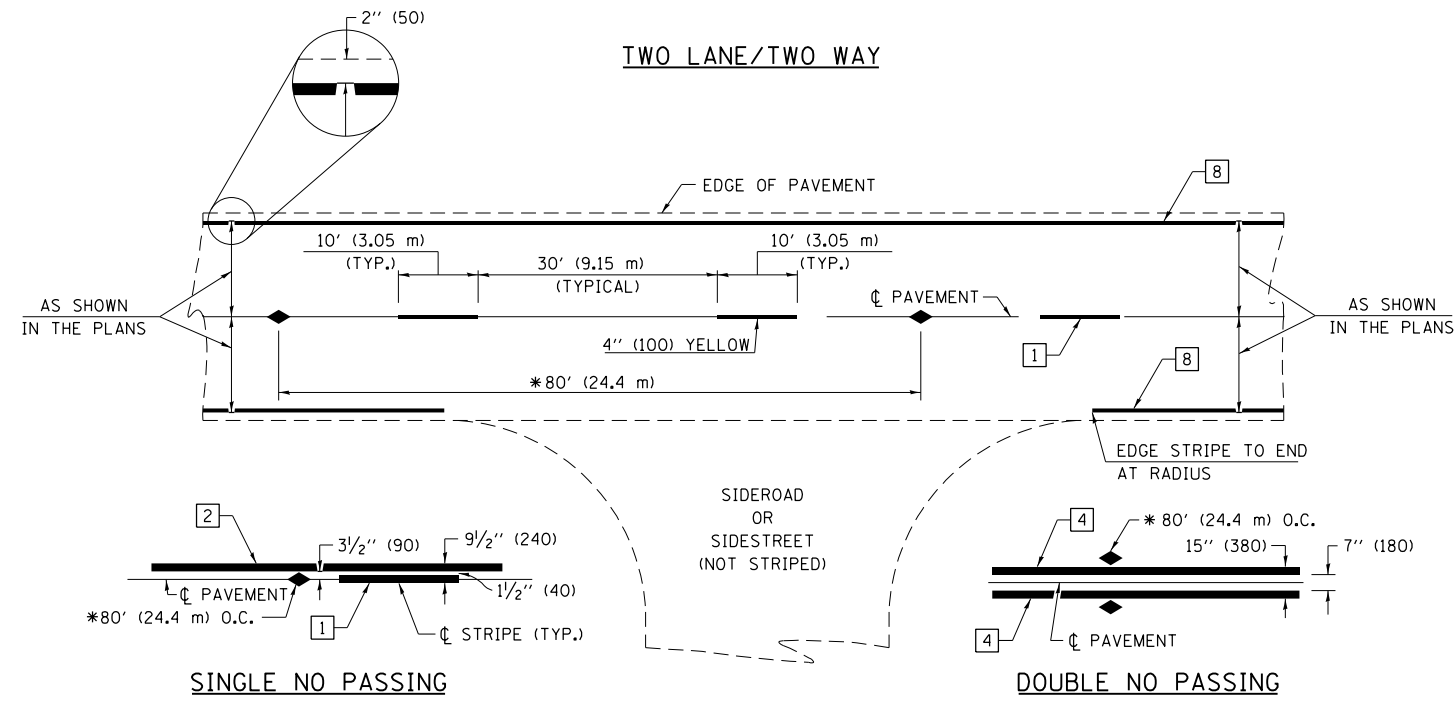

* REDUCE TO 40' (12.2 m) O.C. ON CURVES WITH POSTED OR ADVISORY SPEEDS OF 45 mph (70 km/h) OR LESS.

PAVEMENT MARKING LEGEND

- 1 4" (100) SKIP-DASH (YELLOW)
 - 2 4" (100) SOLID (YELLOW)
 - 3 12" (300) DIAGONAL (YELLOW)
 - 4 4" (100) DOUBLE YELLOW (NARROW)
 - 5 12" (300) SOLID WHITE
 - 6 RESERVED
 - 7 6" (150) SKIP-DASH (WHITE)
 - 8 4" (100) SOLID (WHITE)
 - 9 12" (300) DIAGONAL (WHITE)
 - 10 6" (150) SOLID (WHITE)
 - 11 24" (600) STOP BAR (WHITE)
 - 12 8" (200) SOLID (WHITE)
 - 13 4" (100) PARKING WHITE
-

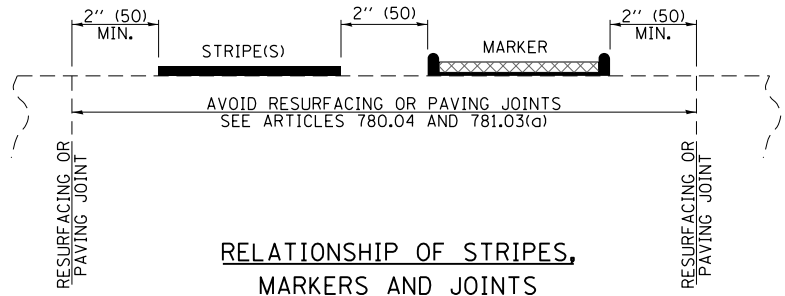

TYPICAL PAVEMENT MARKERS LEGEND

- ◆ TWO-WAY AMBER MARKER
- ▶ ONE-WAY AMBER MARKER
- ▷ ONE-WAY CRYSTAL MARKER

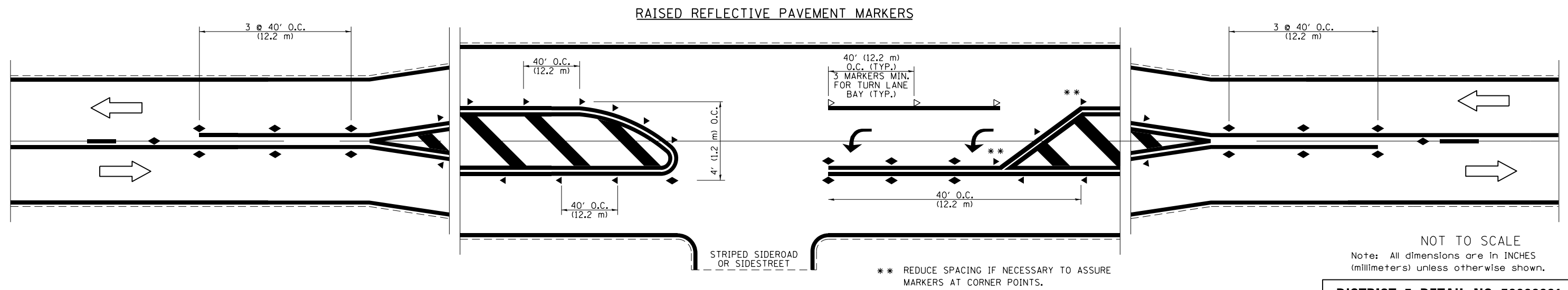

NOT TO SCALE
Note: All dimensions are in INCHES (millimeters) unless otherwise shown.

FILE NAME =	USER NAME = teasleyck	DESIGNED -	REVISED -
ci:\pw\work\p\d0338770\074474-sh1-details.dgn		DRAWN -	REVISED -
		CHECKED -	REVISED -
		DATE -	REVISED -

STATE OF ILLINOIS
DEPARTMENT OF TRANSPORTATION

PAVEMENT MARKING AND RAISED REFLECTIVE PAVEMENT MARKERS
(RURAL & URBAN APPLICATIONS)

DISTRICT 7 DETAIL NO. 78000001				
F.A.P. RTE.	SECTION	COUNTY	TOTAL SHEETS	SHEET NO.
325	11-2 RS1.1IRS-2.1ORS-4	SHELBY	19	15
			CONTRACT NO. 74474	
ILLINOIS FED. AID PROJECT				

SCALE: SHEET NO. 1 OF 4 SHEETS STA. TO STA.

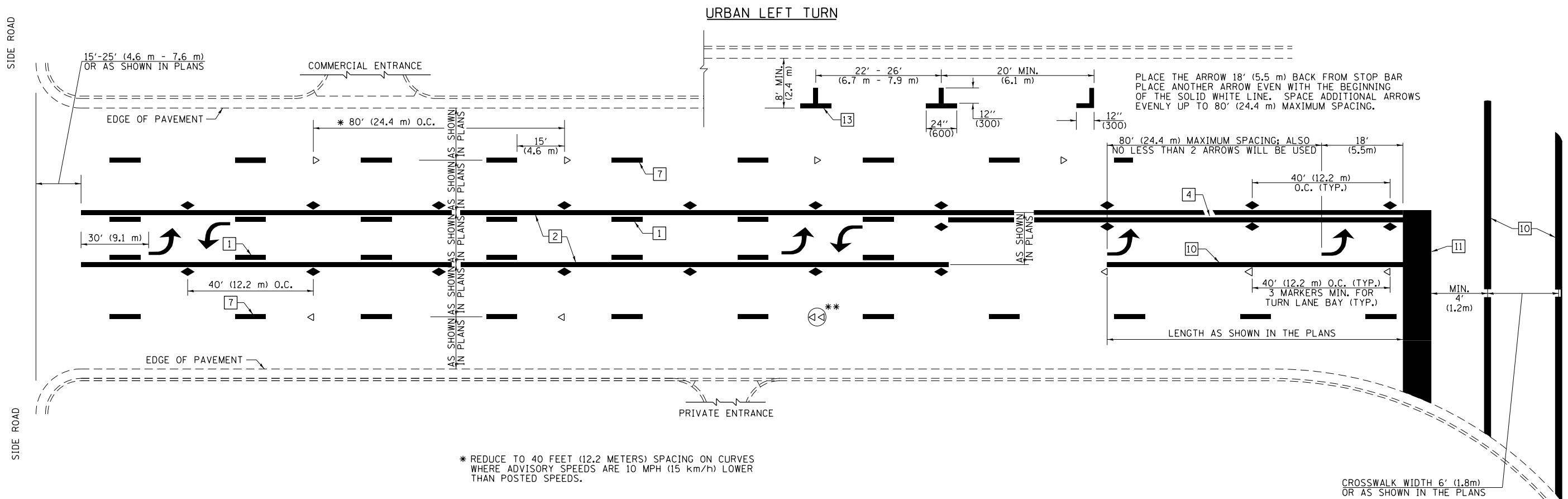

PLACE THE ARROW 18' (5.5 m) BACK FROM STOP BAR
 PLACE ANOTHER ARROW EVEN WITH THE BEGINNING
 OF THE SOLID WHITE LINE. SPACE ADDITIONAL ARROWS
 EVENLY UP TO 80' (24.4 m) MAXIMUM SPACING.

* REDUCE TO 40 FEET (12.2 METERS) SPACING ON CURVES
 WHERE ADVISORY SPEEDS ARE 10 MPH (15 km/h) LOWER
 THAN POSTED SPEEDS.

** DOUBLE LANE LINE MARKERS SHALL BE SPECIFIED
 AND SPACED AS SHOWN IN HIGHWAY STANDARD
 781001 FOR MULTI-LANE DIVIDED AND UNDIVIDED
 HIGHWAYS.

PAVEMENT MARKING LEGEND

- 1 4" (100) SKIP-DASH (YELLOW)
- 2 4" (100) SOLID (YELLOW)
- 3 12" (300) DIAGONAL (YELLOW)
- 4 4" (100) DOUBLE YELLOW (NARROW)
- 5 12" (300) SOLID WHITE
- 6 RESERVED
- 7 6" (150) SKIP-DASH (WHITE)
- 8 4" (100) SOLID (WHITE)
- 9 12" (300) DIAGONAL (WHITE)
- 10 6" (150) SOLID (WHITE)
- 11 24" (600) STOP BAR (WHITE)
- 12 8" (200) SOLID (WHITE)
- 13 4" (100) PARKING WHITE

GENERAL NOTES

1. TURN ARROW PAIRS SHALL BE PLACED AT 250' (75 m) INTERVALS AND SHALL BE EVENLY SPACED BETWEEN BOTH ENDS OF THE BIDIRECTIONAL LEFT TURN LANE. USE A MINIMUM OF TWO PAIRS PER BLOCK.
2. THE SOLID YELLOW PAVEMENT MARKINGS [2] SHOULD GENERALLY START OR END NEAR THE RADIUS POINT OF EACH STREET RETURN EXCEPT WHERE ONE OR BOTH ENDS WOULD INCLUDE STOP BARS.
3. THE SKIP-DASH PAVEMENT MARKINGS [1] OR [7] SHOULD BE CENTERED BETWEEN BOTH ENDS OF EACH CITY BLOCK AND SHALL BE PLACED SO THEY LINE UP ACROSS FROM EACH OTHER.
4. USE LARGE ARROW SIZE FOR BOTH RURAL AND URBAN LOCATIONS. (SEE LAST PAGE OF SECTION 780x FOR SYMBOLS TABLE)
5. LANE LINE EXTENSIONS SHALL BE THE SAME COLOR AND WIDTH AS THE LANE LINE BEING EXTENDED.

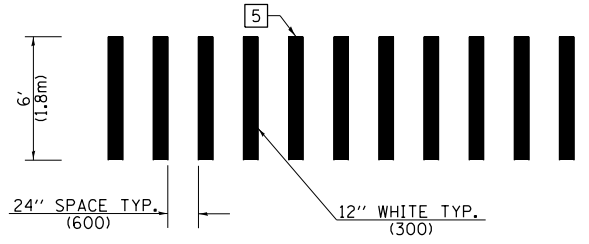

**CROSSWALK DETAIL
 (DECATUR CITY LIMITS ONLY)**

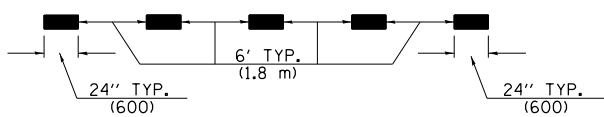

LANE LINE EXTENSIONS

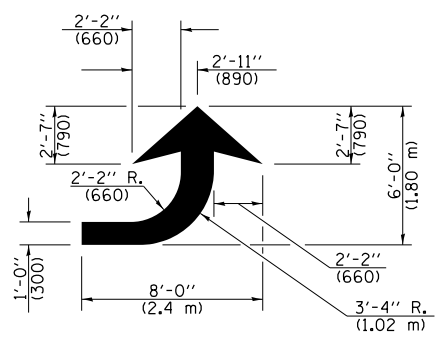

LEFT ARROW

REVERSE FOR RIGHT ARROW
 AREA = 15.6 SQ. FT. (1.47 m²)
 (WHITE)

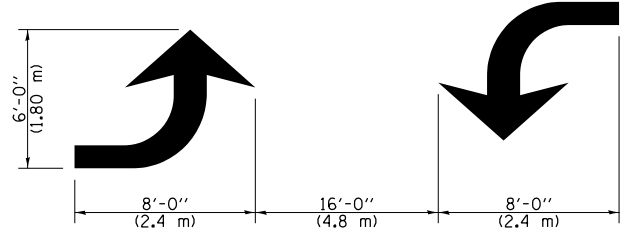

**TYPICAL DOUBLE
 TURN ARROWS (WHITE)**

NOT TO SCALE

Note: All dimensions are in INCHES
 (millimeters) unless otherwise shown.

DISTRICT 7 DETAIL NO. 7800001

FILE NAME =	USER NAME = teasleyck	DESIGNED -	REVISED -	STATE OF ILLINOIS DEPARTMENT OF TRANSPORTATION	PAVEMENT MARKING AND RAISED REFLECTIVE PAVEMENT MARKERS (RURAL & URBAN APPLICATIONS)	F.A.P. RTE.	SECTION	COUNTY	TOTAL SHEETS	SHEET NO.	
ci:\pw\work\p\idot\teasleyck\d0338770\074474-sh1-details.dgn	PLOT SCALE = 100.0000' / 1in.	DRAWN -	REVISED -			325	11-2 RS1.1IRS-2.1ORS-4	SHELBY	19	16	
PLOT DATE = 4/9/2013	DATE -	CHECKED -	REVISED -			CONTRACT NO. 74474					
						ILLINOIS FED. AID PROJECT					

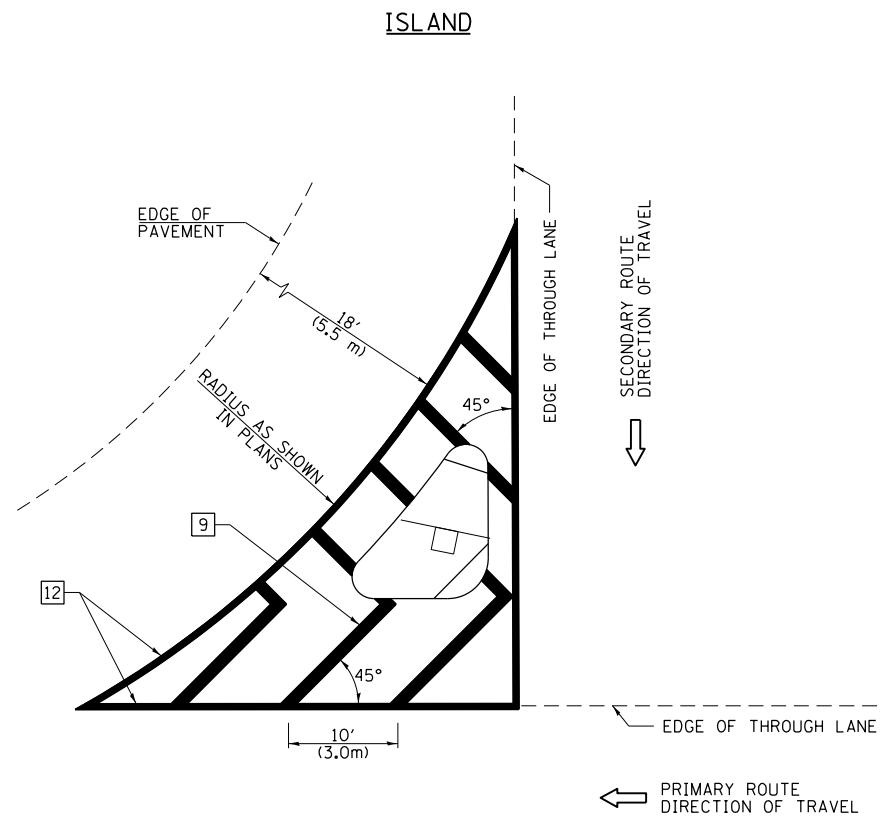

GENERAL NOTES

1. RAISED AND CORRUGATED MEDIANS SHALL BE OUTLINED WITH [2] IF PRESENT.
2. SOME OF THE INFORMATION INCLUDED WITH THIS DETAIL MAY NOT BE APPLICABLE TO THIS IMPROVEMENT.
3. PAVEMENT MARKINGS ARE TO BE EXTENDED THROUGH OMISSIONS WHEN APPLICABLE.
4. FINAL PAVEMENT MARKINGS SHALL BE IN PLACE PRIOR TO PLACING ANY RAISED REFLECTIVE PAVEMENT MARKERS.
5. THE FOLLOWING CRITERIA SHALL BE USED FOR SELECTING THE DIAGONAL PAVEMENT MARKING SPACING:

< 30 MPH (< 50 km/h)	15' (4.5 m)
30-45 MPH (50-75 km/h)	20' (6.0 m)
> 45 MPH (> 75 km/h)	30' (9.0 m)

PAVEMENT MARKING LEGEND

[1] 4" (100) SKIP-DASH (YELLOW)	
[2] 4" (100) SOLID (YELLOW)	
[3] 12" (300) DIAGONAL (YELLOW)	
[4] 4" (100) DOUBLE YELLOW (NARROW)	
[5] 12" (300) SOLID WHITE	
[6] RESERVED	
[7] 6" (150) SKIP-DASH (WHITE)	
[8] 4" (100) SOLID (WHITE)	
[9] 12" (300) DIAGONAL (WHITE)	
[10] 6" (150) SOLID (WHITE)	
[11] 24" (600) STOP BAR (WHITE)	
[12] 8" (200) SOLID (WHITE)	
[13] 4" (100) PARKING WHITE	

RURAL LEFT TURN STRIPING

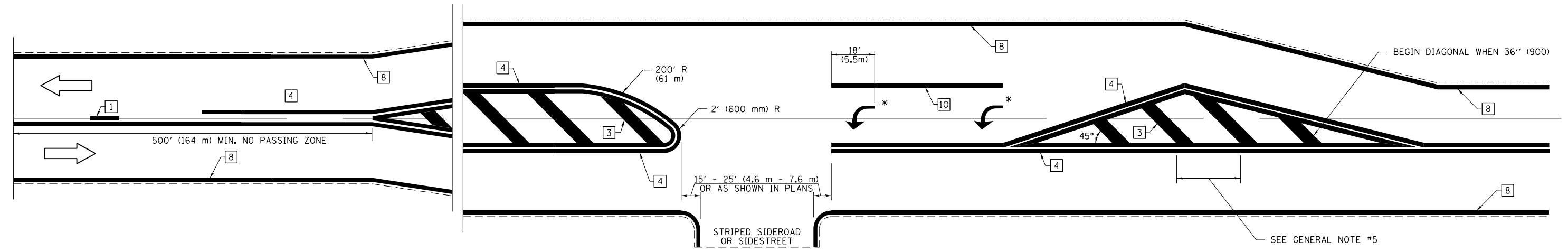

* PLACE AN ARROW 18' (5.5 m) BACK FROM STOP BAR. PLACE ANOTHER ARROW EVEN WITH THE BEGINNING OF THE SOLID WHITE LINE. SPACE ADDITIONAL ARROWS EVENLY UP TO 80' (24.4 m) MAXIMUM SPACING. USE MINIMUM OF 2 ARROWS.

NOT TO SCALE
 Note: All dimensions are in INCHES (millimeters) unless otherwise shown.

DISTRICT 7 DETAIL NO. 7800001

FILE NAME =	USER NAME = teasleyck	DESIGNED -	REVISED -
ci:\pw\work\p\idot\teasleyck\d0338770\07	4474-sh1-details.dgn	DRAWN -	REVISED -
	PLOT SCALE = 100.0000' / 1in.	CHECKED -	REVISED -
	PLOT DATE = 4/9/2013	DATE -	REVISED -

**STATE OF ILLINOIS
 DEPARTMENT OF TRANSPORTATION**

**PAVEMENT MARKING AND RAISED REFLECTIVE PAVEMENT MARKERS
 (RURAL & URBAN APPLICATIONS)**

SCALE: SHEET NO. 3 OF 4 SHEETS STA. TO STA.

F.A.P. RTE.	SECTION	COUNTY	TOTAL SHEETS	SHEET NO.
325	11-2 RS1.1IRS-2.1ORS-4	SHELBY	19	17
				CONTRACT NO. 74474
ILLINOIS FED. AID PROJECT				

PAVEMENT MARKINGS AT RAILROAD-HIGHWAY GRADE CROSSING

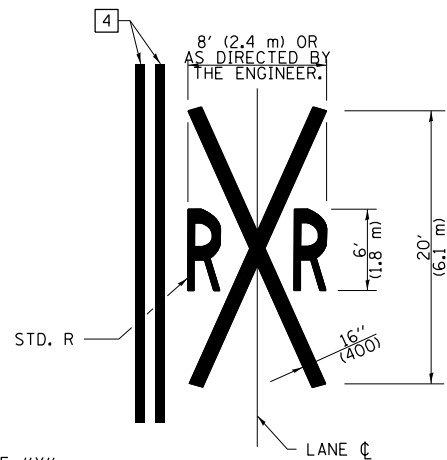
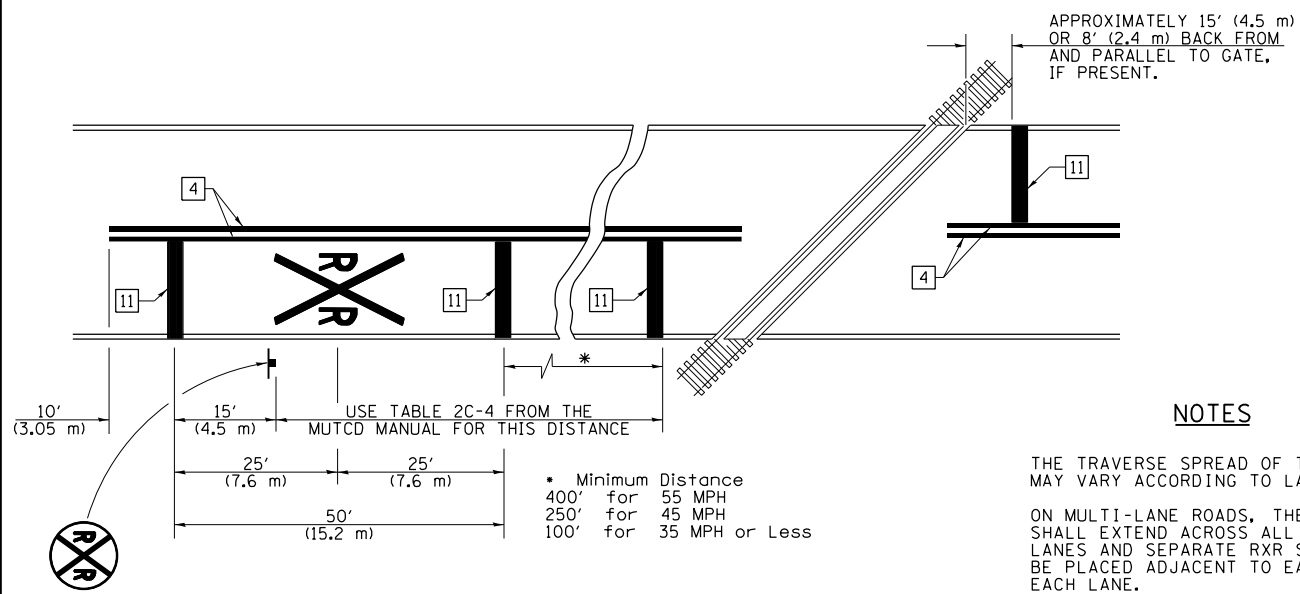

NOTES

THE TRAVERSE SPREAD OF THE "X" MAY VARY ACCORDING TO LANE WIDTH.

ON MULTI-LANE ROADS, THE STOP LINES SHALL EXTEND ACROSS ALL APPROACH LANES AND SEPARATE RXR SYMBOLS SHALL BE PLACED ADJACENT TO EACH OTHER IN EACH LANE.

WHEN THE PAVEMENT MARKING SYMBOL IS USED, A PORTION OF THE SYMBOL SHOULD BE LOCATED DIRECTLY ADJACENT TO THE ADVANCE WARNING SIGN (W10-1) AS PLACED BY TABLE II-1, CONDITION B OF THE MUTCD.

PAVEMENT MARKING LEGEND

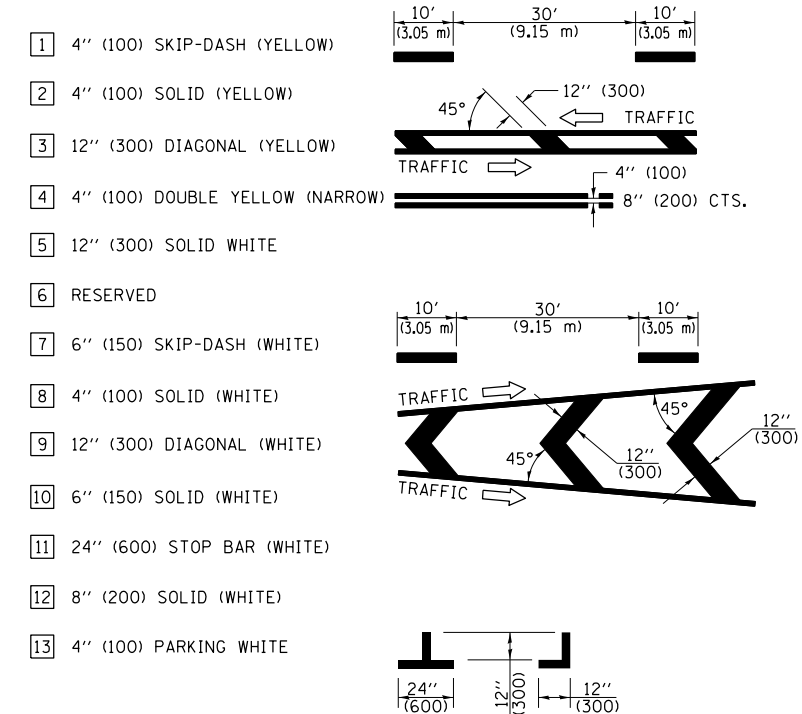

RAILROAD CROSSING WITH INTERCONNECT ONLY

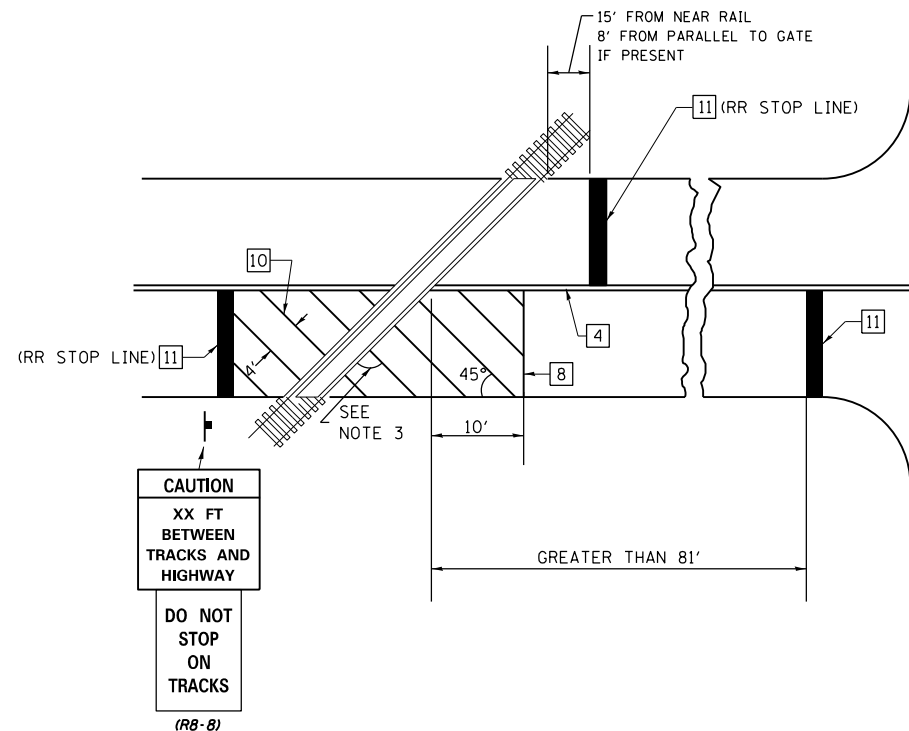

RAILROAD CROSSING WITH INTERCONNECT AND PRE-SIGNALS

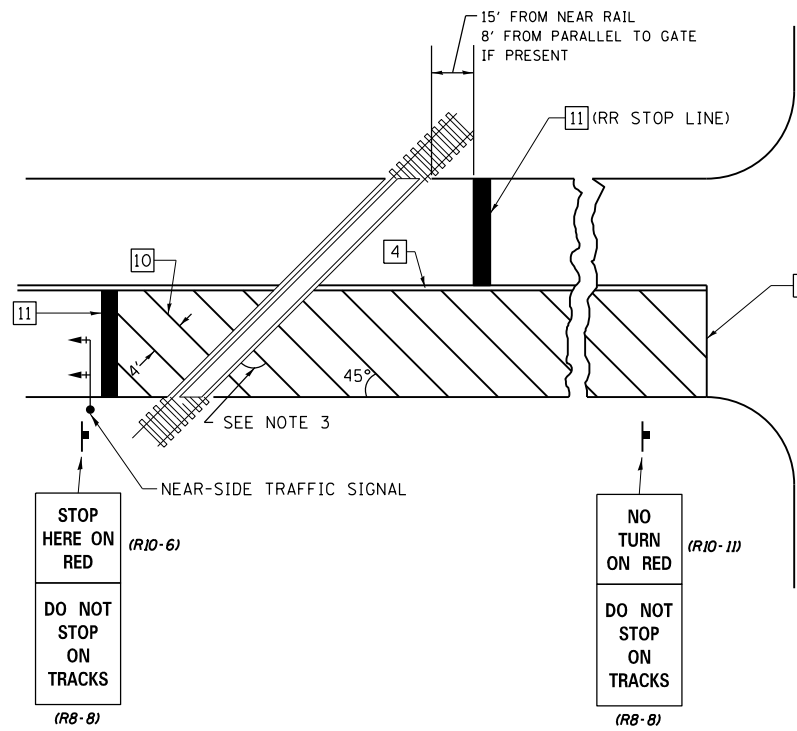

GENERAL NOTES

1. SUPPLEMENTAL PAVEMENT MARKINGS TO BE INSTALLED ONLY ON APPROACHES TO INTERSECTIONS CONTROLLED BY TRAFFIC SIGNALS WHICH ARE INTERCONNECTED WITH THE RAILROAD WARNING SIGNALS.
2. EXTEND PAVEMENT MARKINGS TO THE INTERSECTION ONLY WHERE NEAR-SIDE TRAFFIC SIGNALS ARE USED.
3. WHERE THE ANGLE BETWEEN THE DIAGONAL PAVEMENT MARKINGS AND THE TRACK WOULD BE LESS THAN 20°, THE PAVEMENT MARKINGS SHOULD BE PLACED IN THE OPPOSITE DIRECTION FROM THAT SHOWN.

SUPPLEMENTAL PAVEMENT MARKING TREATMENT FOR RAILROAD-HIGHWAY GRADE CROSSING

NOT TO SCALE

Note: All dimensions are in INCHES (millimeters) unless otherwise shown.

FILE NAME =	USER NAME = teasleyk	DESIGNED -	REVISED -
c:\pwork\pwork\teasleyk\d0338770\07	4474-sh1-details.dgn	DRAWN -	REVISED -
	PLOT SCALE = 100.0000' / 1"	CHECKED -	REVISED -
	PLOT DATE = 4/9/2013	DATE -	REVISED -

STATE OF ILLINOIS
DEPARTMENT OF TRANSPORTATION

PAVEMENT MARKING AND RAISED REFLECTIVE PAVEMENT MARKERS
(RURAL & URBAN APPLICATIONS)

SCALE: SHEET NO. 4 OF 4 SHEETS STA. TO STA.

DISTRICT 7 DETAIL NO. 7800001

F.A.P. RTE.	SECTION	COUNTY	TOTAL SHEETS	SHEET NO.
325	11-2 RS1.1IRS-2.1ORS-4	SHELBY	19	18
				CONTRACT NO. 74474
ILLINOIS FED. AID PROJECT				

DETAIL OF PERMANENT SURVEY MARKER VAULT

FOR RESET LAND SURVEY MONUMENTS IN RIGID AND COMPOSITE PAVEMENTS

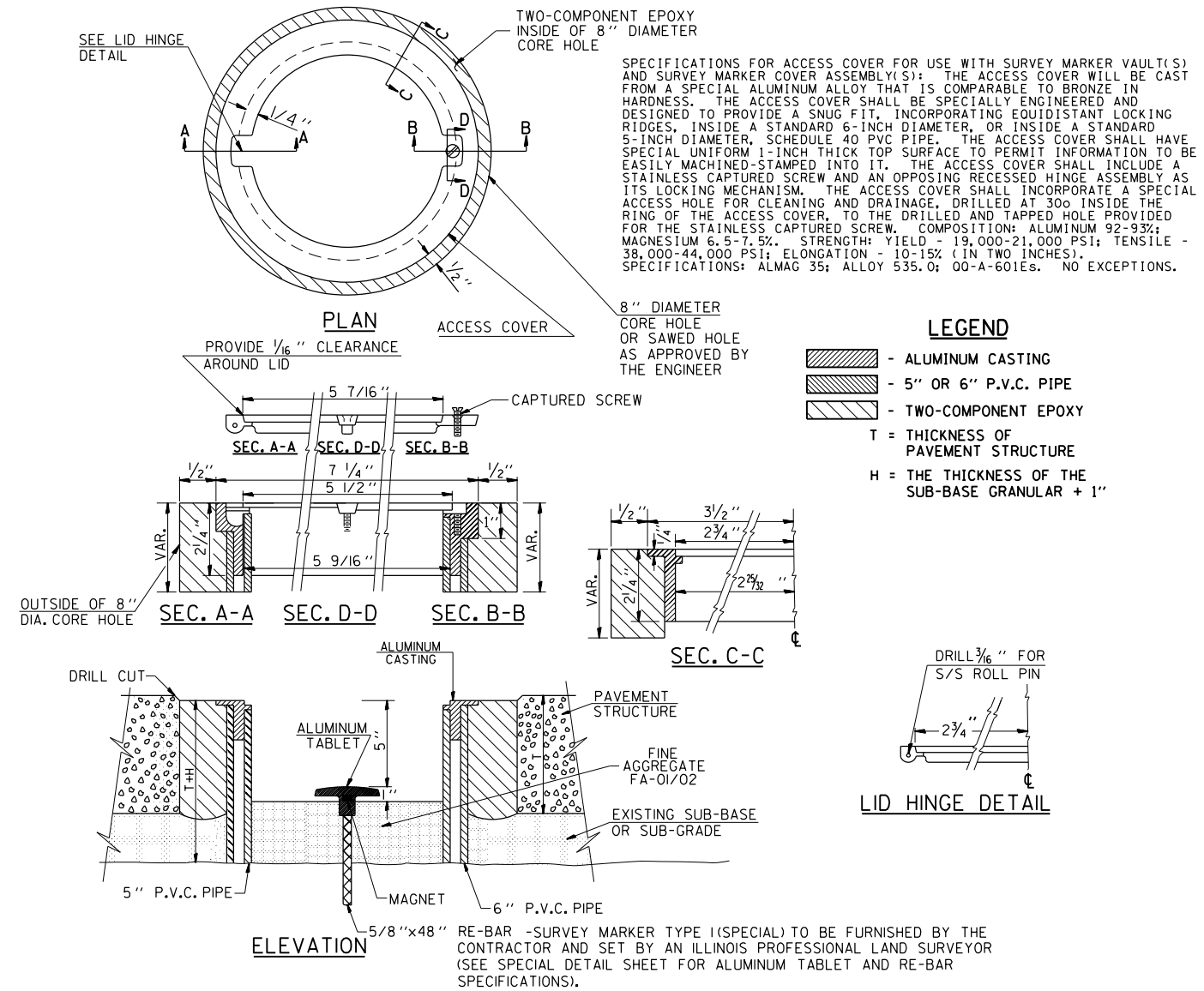

GENERAL NOTES

1. ALUMINUM CASTING SHALL BE EITHER PLACED OVER A 5" P.V.C. PIPE OR INSIDE OF A 6" P.V.C. PIPE.
2. BACKFILL WITH SELECT MATERIAL AS DIRECTED BY THE ENGINEER.
3. TO PREVENT DAMAGE TO THE TOP OF THE 5/8" Ø RE-BAR, AN APPROVED RE-BAR DRIVER SHALL BE USED.
4. WORK SHALL NOT START ON THIS ITEM UNTIL THE FINAL LIFT OF CLASS I HAS BEEN COMPLETED.
5. SEE SPECIAL PROVISION "PRESERVATION OF LAND SURVEY MONUMENTS".
5. THIS WORK WILL BE PAID FOR AT THE CONTRACT UNIT PRICE EACH FOR SURVEY MARKER VAULT WHICH PRICE SHALL INCLUDE ALL LABOR AND MATERIAL AS SPECIFIED INCLUDING DRILLING, EPOXY AND BACKFILL AND NO ADDITIONAL COMPENSATION WILL BE ALLOWED.
6. THE 8" DIAMETER CASTING SHALL BE ANCHORED IN THE CORE HOLE WITH TWO-COMPONENT EPOXY CONFORMING TO APPLICABLE PORTIONS OF ARTICLE 718.08 OF THE STANDARD SPECIFICATIONS.
7. ALL PERMANENT SURVEY MARKERS (SPECIAL) SHALL BE PLACED 1/4" (±) BELOW THE FINAL SURFACE.
8. THE 8" DIAMETER CORE HOLE SHALL BE SUBJECT TO THE APPROVAL OF THE ENGINEER.

BILL OF MATERIAL

ALUMINUM CASTING OF THE DIMENSIONS SHOWN OR OTHER SUBJECT TO ENGINEER'S APPROVAL OF SHOP DRAWINGS, 5" OR 6" Ø P.V.C. PIPE, SCHEDULE 40, ALUMINUM TABLET, STAMPED IN ACCORDANCE WITH STANDARD 2135. 5/8" Ø x 48" RE-BAR, EPOXY, BACKFILL.

FILE NAME =	USER NAME = teasleyck	DESIGNED - A.W.H.	REVISED -	STATE OF ILLINOIS DEPARTMENT OF TRANSPORTATION	DETAIL OF PERMANENT SURVEY MARKER VAULT	F.A.P. RTE.	SECTION	COUNTY	TOTAL SHEETS	SHEET NO.	
ci:\pw\work\p\dot\teasleyck\d0338770\07	4474-sh1-details.dgn	DRAWN - J.H.M.	REVISED -			325	11-2 RS1.IIRS-2.IORS-4	SHELBY	19	19	
Default	PLOT SCALE = 100.0000' / 1".	CHECKED -	REVISED -			CONTRACT NO. 74474					
	PLOT DATE = 4/9/2013	DATE - 2-28-91	REVISED -			ILLINOIS FED. AID PROJECT					