

PLAN	SURVEYED	DATE
	PLOTTED	
	GRADES CHECKED	
	STRUCTURE NOTATIONS CHECKED	
	NOTE BOOK NO.	
	CADD FILE NAME	

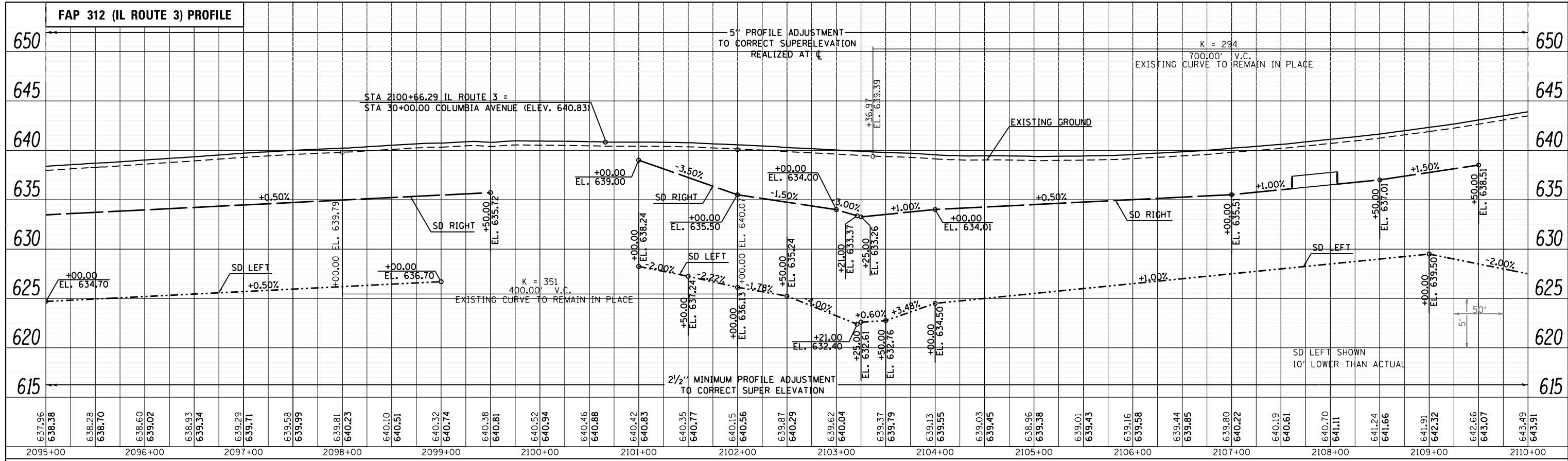

PROFILE	SURVEYED	DATE
	PLOTTED	
	GRADES CHECKED	
	STRUCTURE NOTATIONS CHECKED	
	NOTE BOOK NO.	
	CADD FILE NAME	

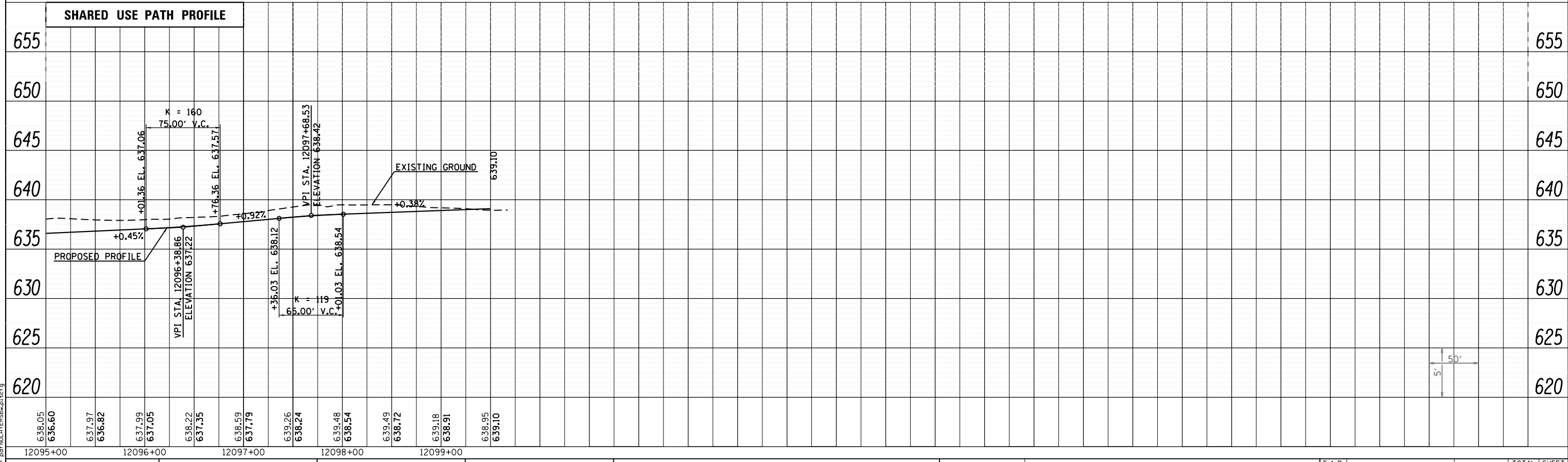

LAST SAVED = 1/22/2013
 PEN TABLE = Vbl-Hs1.rtl
 PLOT DRIVER = pdfNLAVERSpw.pltcf9

FILE NAME =	USER NAME = beriechmann	DESIGNED -	REVISED -
I:\10011001_Phase II - 76817\Cad\T\Plans\029_0876817-sht-profile-09.dgn		DRAWN -	REVISED -
PLOT SCALE = 100.0000' / in.		CHECKED -	REVISED -
PLOT DATE = 1/25/2013 3:29:56 PM		DATE -	REVISED -

STATE OF ILLINOIS
 DEPARTMENT OF TRANSPORTATION



PROFILE
 FAP 312 (IL ROUTE 3)

SCALE: 50H:5V

SHEET NO. 18 OF 40 SHEETS

STA. 2095+00.00 TO STA. 2110+00.00

F.A.P. RTE. 312	SECTION 68-WRS-1	COUNTY MONROE	TOTAL SHEETS 760	SHEET NO. 118
CONTRACT NO. 76817				ILLINOIS FED. AID PROJECT