

- LEGEND**
- HMA SURFACE REMOVAL, VARIABLE DEPTH
  - PAVEMENT REMOVAL
  - PAVED SHOULDER REMOVAL

- REMOVE PIPE UNDERDRAINS PER TYPICAL SECTIONS
- GREAT RIVER ROAD AND AMERICA'S BYWAYS SIGNS ARE TO BE RELOCATED. ALL OTHER SIGNS ARE TO BE REMOVED. SEE SCHEDULE.

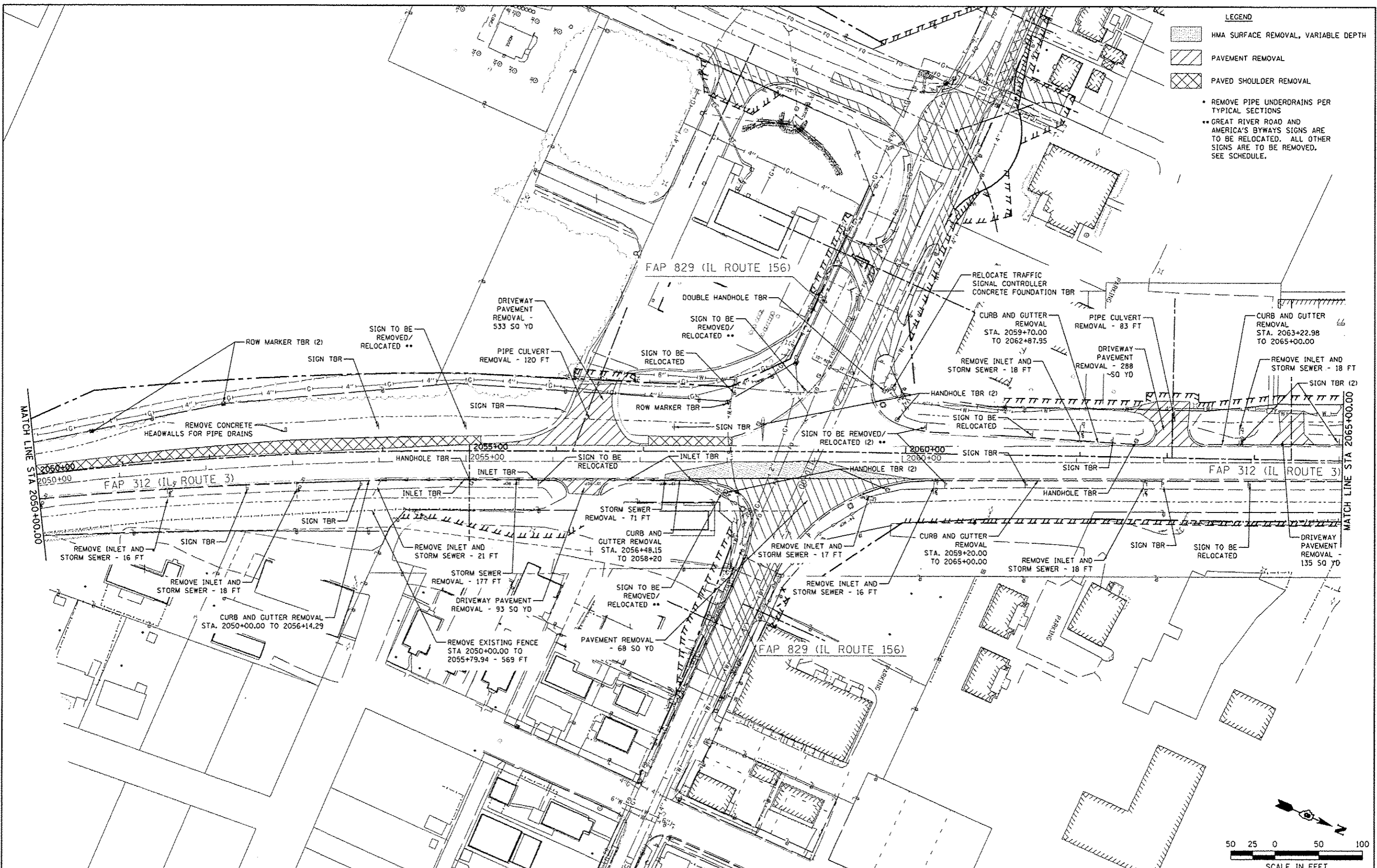

FILE NAME * F:\Projects\DOT PROJECTS\89-101-IL-4\Drawings\CADD Sheets\Contract 2\158.DR76817.dwg	USER NAME * Richard Heineke	DESIGNED - JAH	REVISED <b>4/8/13</b>	<b>STATE OF ILLINOIS</b> <b>DEPARTMENT OF TRANSPORTATION</b>	 McDonough-Whitlow, P.C. PROFESSIONAL DESIGN NO. 164-002754	<b>REMOVAL PLAN</b> IL ROUTE 3	F.A.P. RTE. 312	SECTION 68-WRS-1	COUNTY MONROE	TOTAL SHEETS 760	SHEET NO. 146
	PLOT SCALE = 1/8" = 50'	CHECKED - TMM	DATE				SHEET NO. 6 OF 19 SHEETS	STA. 2050+00.00 TO STA. 2065+00.00	<b>CONTRACT NO. 76817</b>		ILLINOIS FED. AID PROJECT