

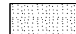

LEGEND

-  HMA SURFACE REMOVAL, VARIABLE DEPTH
-  PAVEMENT REMOVAL
-  PAVED SHOULDER REMOVAL

- REMOVE PIPE UNDERDRAINS PER TYPICAL SECTIONS
- GREAT RIVER ROAD AND AMERICA'S BYWAYS SIGNS ARE TO BE RELOCATED. ALL OTHER SIGNS ARE TO BE REMOVED. SEE SCHEDULE.

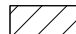

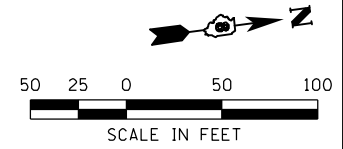
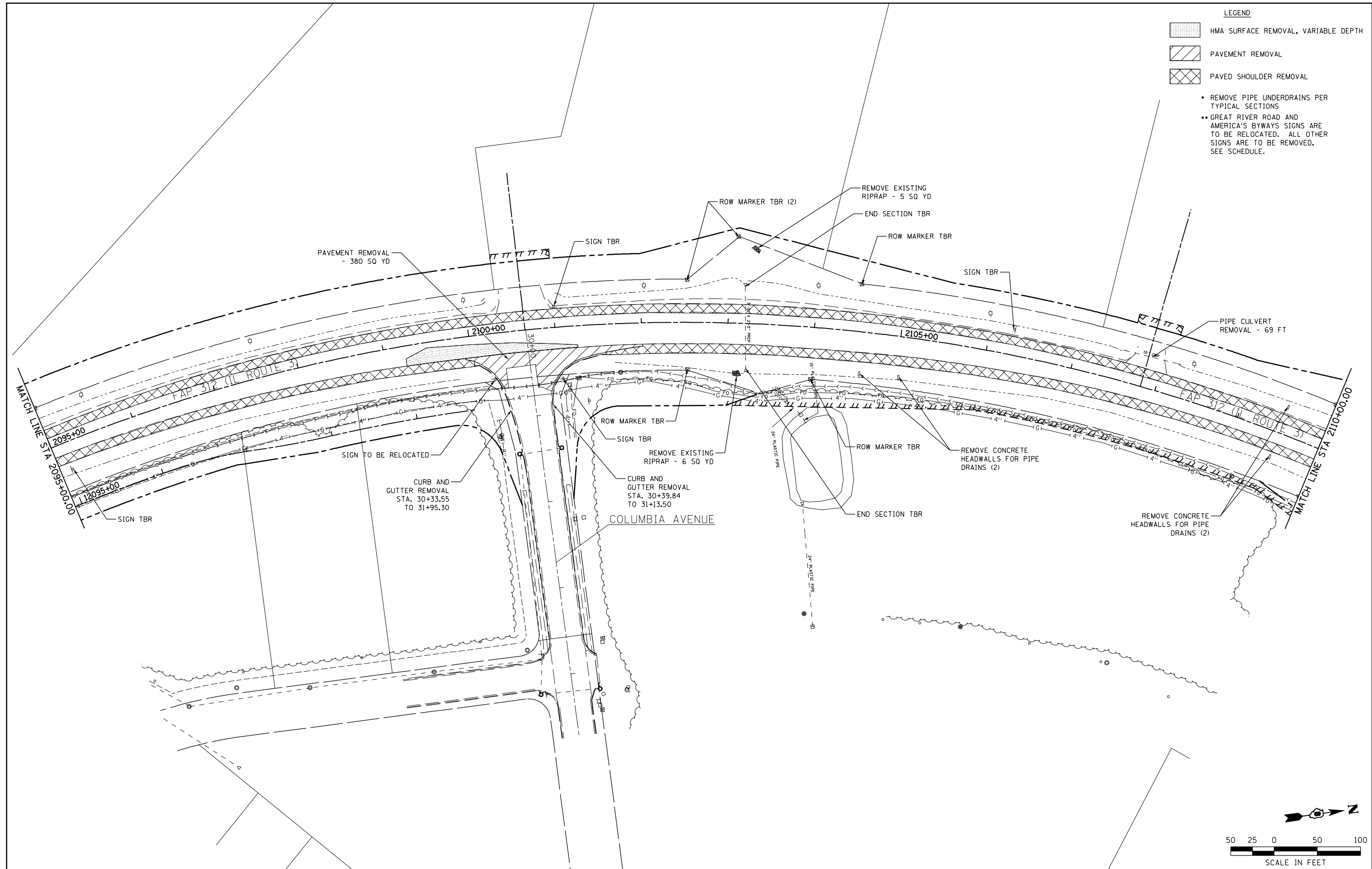
FILE NAME =	USER NAME = Richard Heinke	DESIGNED - JAH	REVISED -	STATE OF ILLINOIS DEPARTMENT OF TRANSPORTATION	 McDonough-Whillow, P.C. PROFESSIONAL DESIGN NO. 184-022754	REMOVAL PLAN	F.A.P. RTE. 312	SECTION 68-WRS-1	COUNTY MONROE	TOTAL SHEETS 760	SHEET NO. 149	
F:\Projects\IDOT PROJECTS\09-101-11.4\Drawings\CADD Sheets\Contract 2\159_0876817-sh	DRAWN - RNH	CHECKED - TMM	REVISED -			SCALE: 1" = 50'	SHEET NO. 9 OF 19 SHEETS	IL ROUTE 3	STA. 2095+00.00 TO STA. 2110+00.00		CONTRACT NO. 76817	
PLOT SCALE = 100.0000' / in.	DATE -	DATE -	REVISED -			ILLINOIS FED. AID PROJECT						
PLOT DATE = 1/24/2013	DATE -	DATE -	REVISED -									