

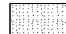

LEGEND

-  HMA SURFACE REMOVAL, VARIABLE DEPTH
-  PAVEMENT REMOVAL
-  PAVED SHOULDER REMOVAL

- REMOVE PIPE UNDERDRAINS PER TYPICAL SECTIONS
- GREAT RIVER ROAD AND AMERICA'S BYWAYS SIGNS ARE TO BE RELOCATED. ALL OTHER SIGNS ARE TO BE REMOVED. SEE SCHEDULE.

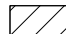

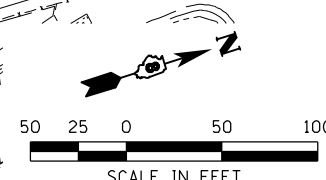
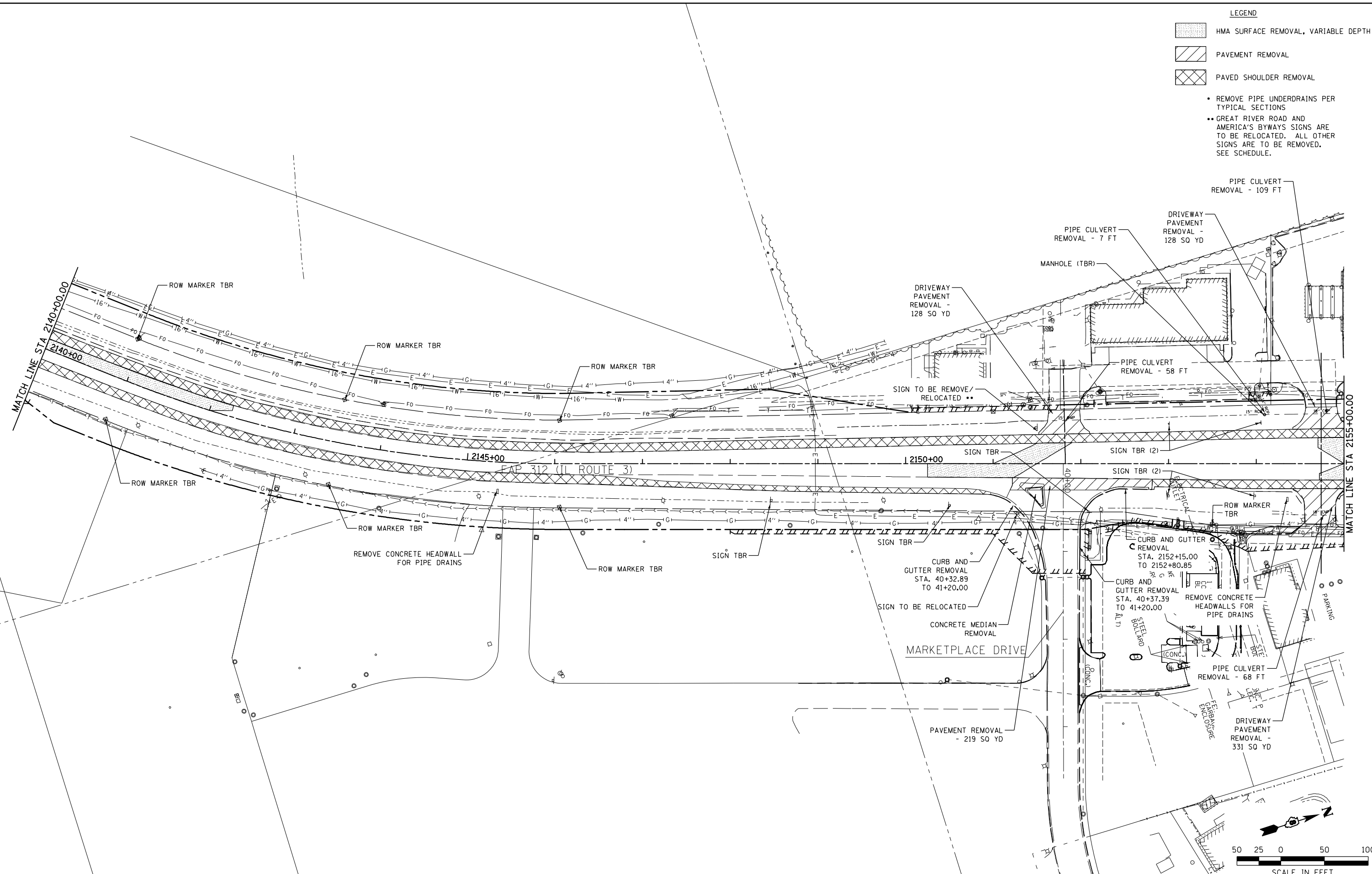
FILE NAME =	USER NAME = Richard Heinke	DESIGNED - JAH	REVISED -
F:\Projects\IDOT PROJECTS\09-101-11.4\Drawings\CADD Sheets\Contract 2\162.D876817-sh	DRAWN - RNH	CHECKED - TMM	DATE -
PLOT SCALE = 100.0000' / in.			
PLOT DATE = 1/25/2013			

**STATE OF ILLINOIS
DEPARTMENT OF TRANSPORTATION**

McDonough-Whillow, P.C.
PROFESSIONAL DESIGN NO. 181-002754
SCALE: 1" = 50'

REMOVAL PLAN
IL ROUTE 3
SHEET NO. 12 OF 19 SHEETS
STA. 2140+00.00 TO STA. 2155+00.00

F.A.P. RTE.	SECTION	COUNTY	TOTAL SHEETS	SHEET NO.
312	68-WRS-1	MONROE	760	152
CONTRACT NO. 76817				
ILLINOIS FED. AID PROJECT				