

STAGE 1A - CONSTRUCTION ACTIVITIES

MAINTAIN EXISTING TRAFFIC LANES & PATTERNS
 CONSTRUCT WIDENING & SHOULDER ALONG WEST LEG OF SOUTH LIBRARY STREET

APPLICABLE TRAFFIC CONTROL HIGHWAY STANDARDS

- 701001
- 701006
- 701011
- 701201
- 701206
- 701301
- 701306
- 701311
- 701326
- 701336
- 701901

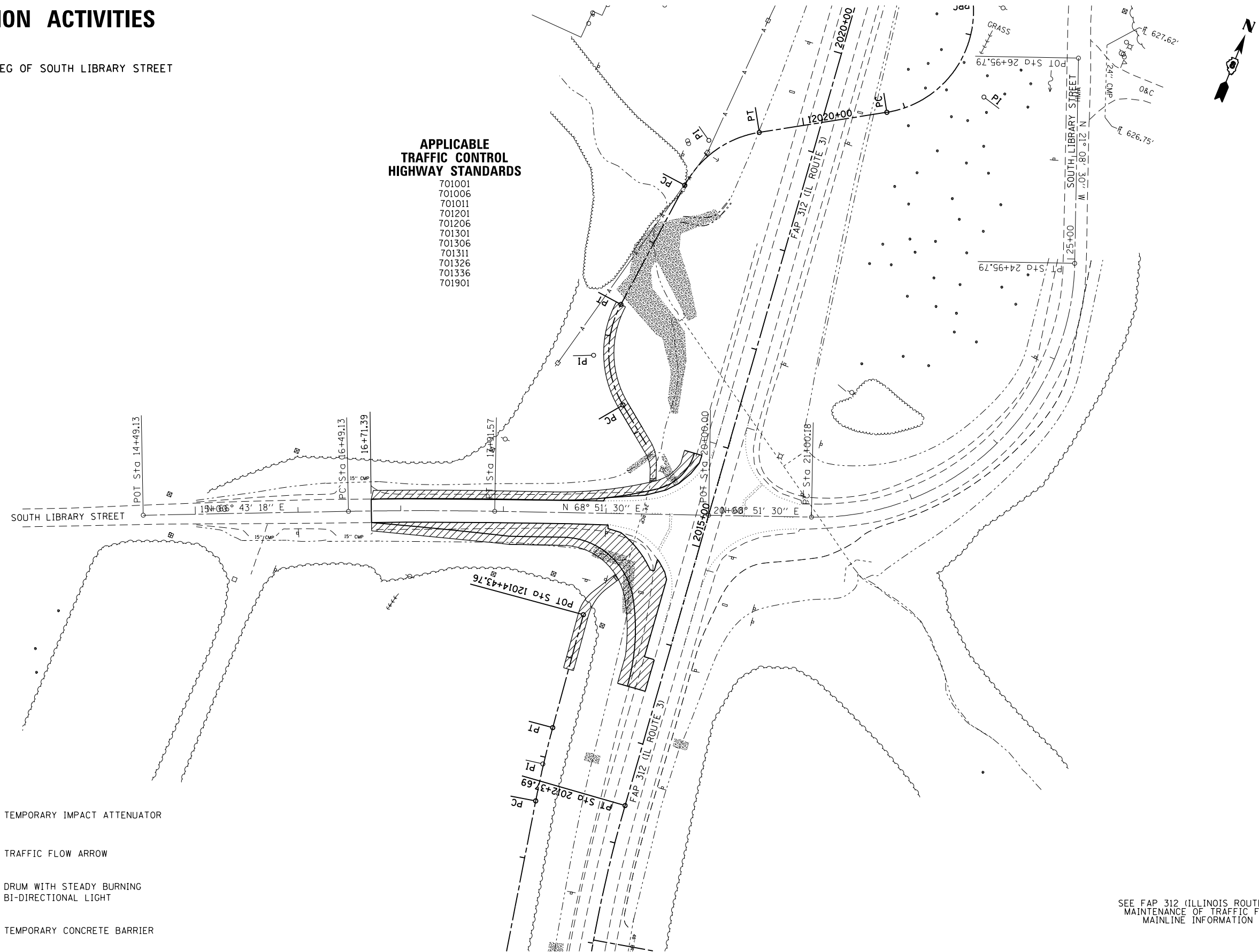

LEGEND

- | | | | |
|--|-----------------------|--|---|
| | TEMPORARY PAVEMENT | | TEMPORARY IMPACT ATTENUATOR |
| | PRESTAGE CONSTRUCTION | | TRAFFIC FLOW ARROW |
| | STAGE 1 CONSTRUCTION | | DRUM WITH STEADY BURNING BI-DIRECTIONAL LIGHT |
| | STAGE 2 CONSTRUCTION | | TEMPORARY CONCRETE BARRIER |
| | STAGE 3 CONSTRUCTION | | |

SEE FAP 312 (ILLINOIS ROUTE 3)
 MAINTENANCE OF TRAFFIC FOR
 MAINLINE INFORMATION

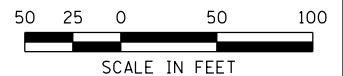

LAST SAVED = 1/25/2013
 PEN TABLE = W:\444\441
 PLOT DRIVER = pdfplotlayers\plctcf

FILE NAME =	USER NAME = beriechmann	DESIGNED -	REVISED -
I:\1001100\Phase II - 76817\Cad\T\Plans\064_0876817-sht-Staging-1A-Library.dgn		DRAWN -	REVISED -
	PLOT SCALE = 100.0000' / 1"	CHECKED -	REVISED -
	PLOT DATE = 1/25/2013 3:30:55 PM	DATE -	REVISED -

STATE OF ILLINOIS
 DEPARTMENT OF TRANSPORTATION

HORNER & SHIRIN, INC.
 ENGINEERS

SUGGESTED STAGES OF CONSTRUCTION AND TRAFFIC CONTROL
 STAGE 1A - SOUTH LIBRARY STREET

SCALE: 1" = 50' SHEET NO. 16 OF 46 SHEETS STA. 2108+00.00 TO STA. 2122+00.00

F.A.P. RTE.	SECTION	COUNTY	TOTAL SHEETS	SHEET NO.
312	68-WRS-1	MONROE	760	175
CONTRACT NO. 76817			ILLINOIS FED. AID PROJECT	