

STAGE 2C - CONSTRUCTION ACTIVITIES

ROUTE BASEBALL ACCESS ROAD TRAFFIC TO FIELDS VIA
RELOCATED BASEBALL ACCESS ROAD
CONSTRUCT REMAINDER OF RELOCATED BASEBALL ACCESS ROAD

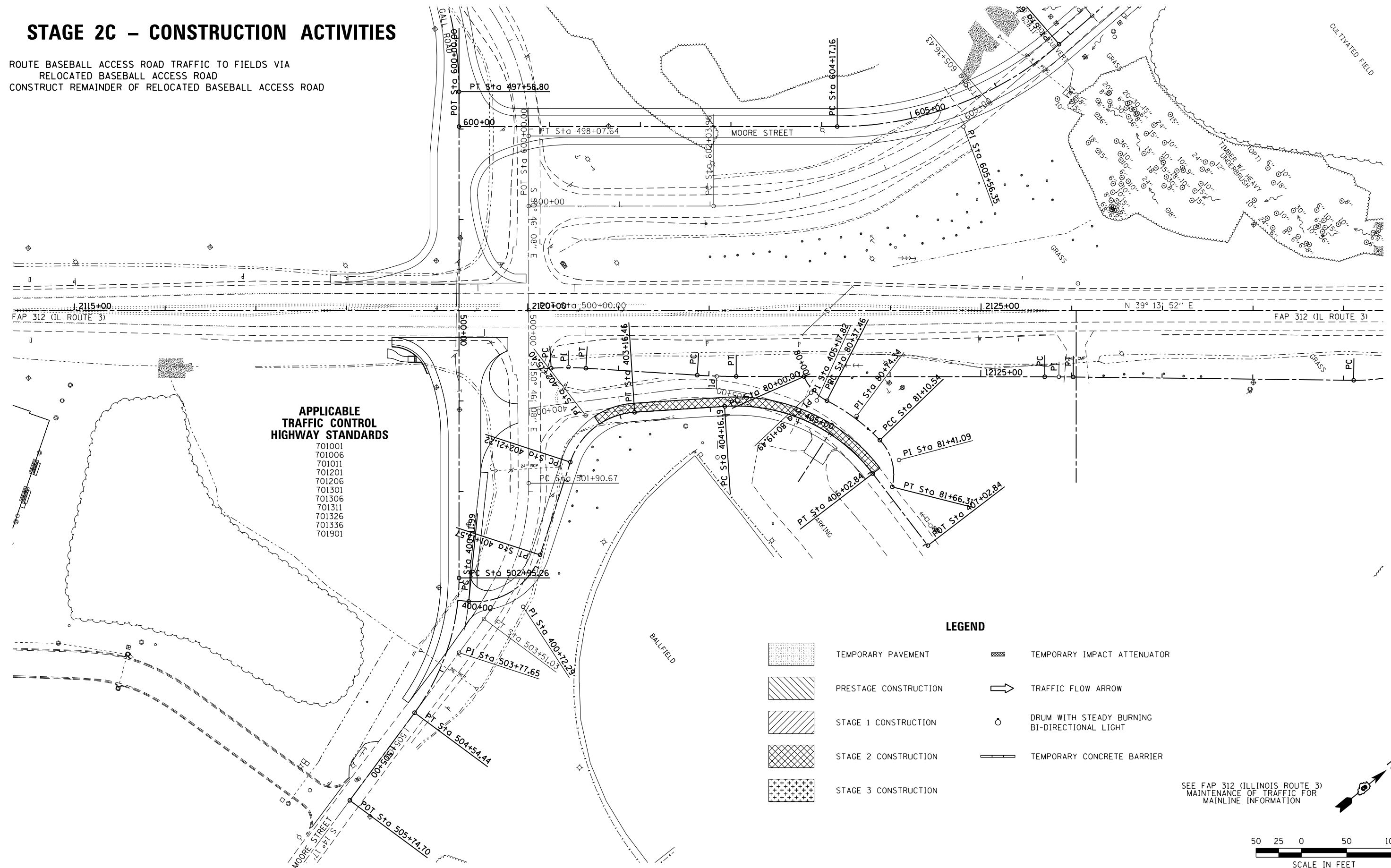

- APPLICABLE TRAFFIC CONTROL HIGHWAY STANDARDS**
- 701001
 - 701006
 - 701011
 - 701201
 - 701206
 - 701301
 - 701306
 - 701311
 - 701326
 - 701336
 - 701901

LEGEND

- TEMPORARY PAVEMENT
- PRESTAGE CONSTRUCTION
- STAGE 1 CONSTRUCTION
- STAGE 2 CONSTRUCTION
- STAGE 3 CONSTRUCTION
- TEMPORARY IMPACT ATTENUATOR
- TRAFFIC FLOW ARROW
- DRUM WITH STEADY BURNING BI-DIRECTIONAL LIGHT
- TEMPORARY CONCRETE BARRIER

SEE FAP 312 (ILLINOIS ROUTE 3)
MAINTENANCE OF TRAFFIC FOR
MAINLINE INFORMATION

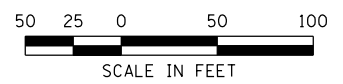

LAST SAVED = 1/23/2013
 PEN TABLE = W2444.dwt
 PLOT DRIVER = pdfplotlayers.pltcf9

FILE NAME =	USER NAME = beriechmann	DESIGNED -	REVISED -
1:\1001100\Phase II - 76817\Cad\T\Plans\069_0876817-sht-Staging-2C-MooreGall.dgn		DRAWN -	REVISED -
		CHECKED -	REVISED -
		DATE -	REVISED -
PLOT SCALE = 100.0000' / 1"			
PLOT DATE = 1/25/2013 3:31:29 PM			

**STATE OF ILLINOIS
DEPARTMENT OF TRANSPORTATION**

**HORNER &
SHIRIN, INC.
ENGINEERS**

**SUGGESTED STAGES OF CONSTRUCTION
AND TRAFFIC CONTROL**
STAGE 2C - MOORE STREET / GALL ROAD

F.A.P. RTE.	SECTION	COUNTY	TOTAL SHEETS	SHEET NO.
312	68-WRS-1	MONROE	760	199
				CONTRACT NO. 76817
ILLINOIS FED. AID PROJECT				

SCALE: 1" = 50' SHEET NO. 40 OF 46 SHEETS STA. 2108+00.00 TO STA. 2122+00.00