

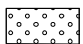





LEGEND

	SEEDING, CLASS 2A AND TEMPORARY EROSION CONTROL SEEDING
	EROSION CONTROL BLANKET AND TEMPORARY EROSION CONTROL BLANKET
	RIPRAP
	AGGREGATE DITCH
	TEMPORARY DITCH CHECK
	INLET & PIPE PROTECTION
	PERIMETER EROSION BARRIER

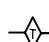

FILE NAME = F:\Projects\IDOT PROJECTS\09-101-11.4\Drawings\CADD Sheets\Contract 2\108.D876817-sh	USER NAME = Richard Heinke	DESIGNED - JAH	REVISED -
PLOT SCALE = 100.0000' / in.	CHECKED - TMM	DRAWN - RNH	REVISED -
PLOT DATE = 1/24/2013	DATE -		REVISED -

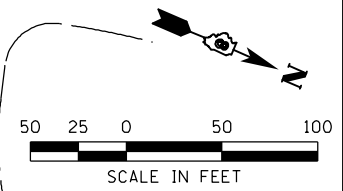
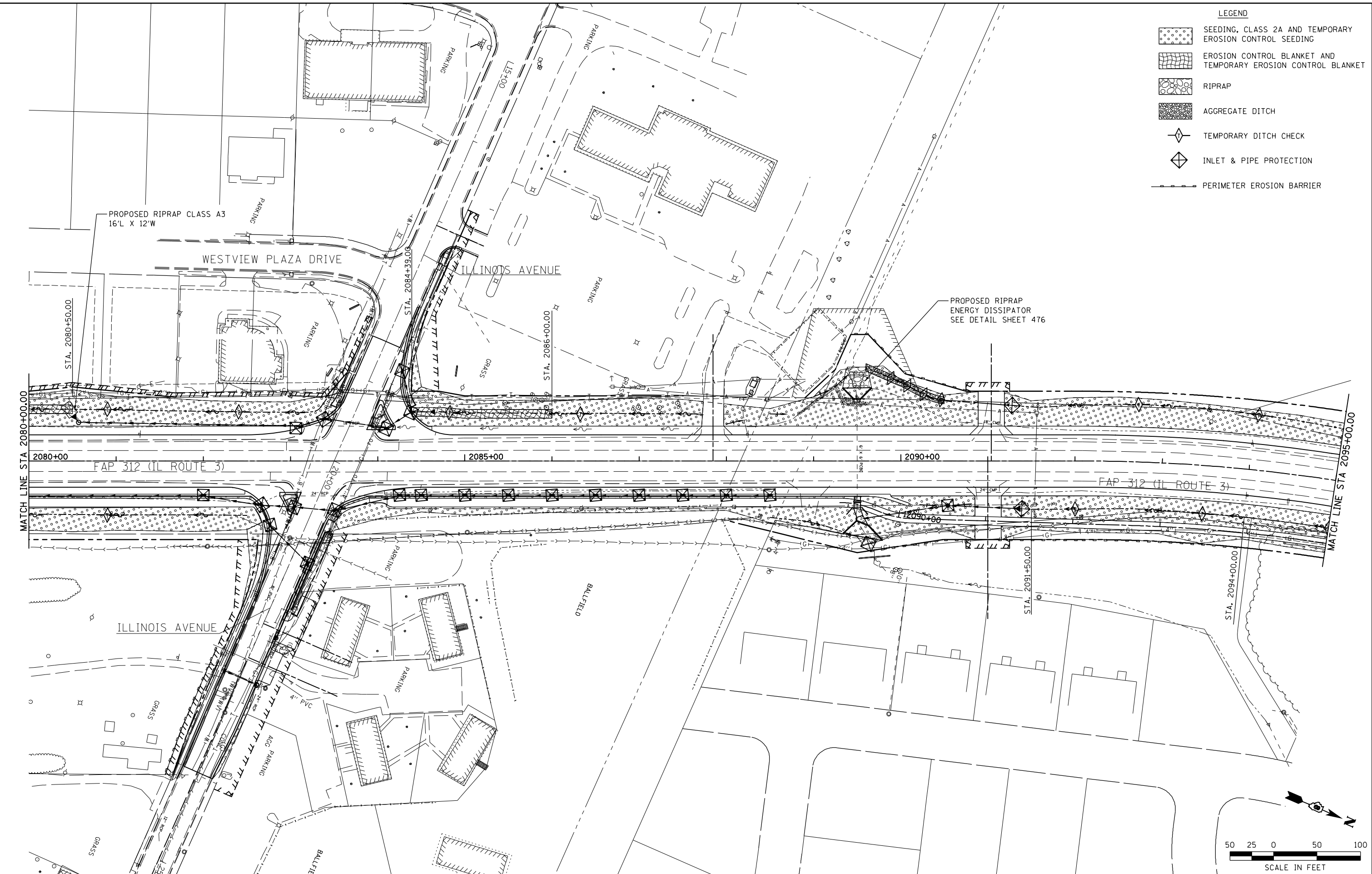
**STATE OF ILLINOIS
DEPARTMENT OF TRANSPORTATION**

McDonough-Whillow, P.C.
PROFESSIONAL DESIGN NO. 184-002754
SCALE: 1" = 50'

EROSION CONTROL PLAN
IL ROUTE 3
SHEET NO. 8 OF 19 SHEETS
STA. 2080+00.00 TO STA. 2095+00.00

F.A.P. RTE. 312	SECTION 68-WRS-1	COUNTY MONROE	TOTAL SHEETS 760	SHEET NO. 216
CONTRACT NO. 76817				ILLINOIS FED. AID PROJECT