

POINT	NORTHING	EASTING
1	610,479.37	2,297,793.68
2	610,479.30	2,297,783.72
3	610,430.84	2,297,805.99
4	610,418.80	2,297,802.19
5	610,423.07	2,297,797.98
6	610,413.35	2,297,845.00
7	610,408.36	2,297,844.72
8	610,409.71	2,297,908.36
9	610,408.00	2,297,918.14
10	610,404.15	2,297,918.06
11	610,407.41	2,297,781.81
12	610,403.13	2,297,786.02
13	610,391.41	2,297,797.56
14	610,389.47	2,297,785.29
15	610,389.50	2,297,779.29
16	610,392.52	2,297,776.06
17	610,402.09	2,297,779.35
18	610,402.06	2,297,785.35
19	610,411.11	2,297,776.02
20	610,351.50	2,297,779.10
21	610,351.47	2,297,785.10
22	610,347.45	2,297,785.08
23	610,349.43	2,297,794.06
24	610,342.08	2,297,788.82
25	610,344.58	2,297,786.28
26	610,326.74	2,297,773.15
27	610,337.80	2,297,784.62
28	610,340.30	2,297,782.08
29	610,347.48	2,297,779.08
30	610,348.52	2,297,774.52
31	610,357.31	2,297,917.99
32	610,353.46	2,297,917.89
33	610,349.96	2,297,891.31
34	610,344.16	2,297,841.67
35	610,339.72	2,297,844.25
36	610,327.62	2,297,814.58
37	610,311.13	2,297,823.04
38	610,326.34	2,297,804.86
39	610,322.06	2,297,800.66
40	610,315.79	2,297,807.04
41	610,301.56	2,297,813.03

STA 2100+66.29 (FAP 312 (IL ROUTE 3)) =
 STA 30+00.00 (COLUMBIA AVENUE)

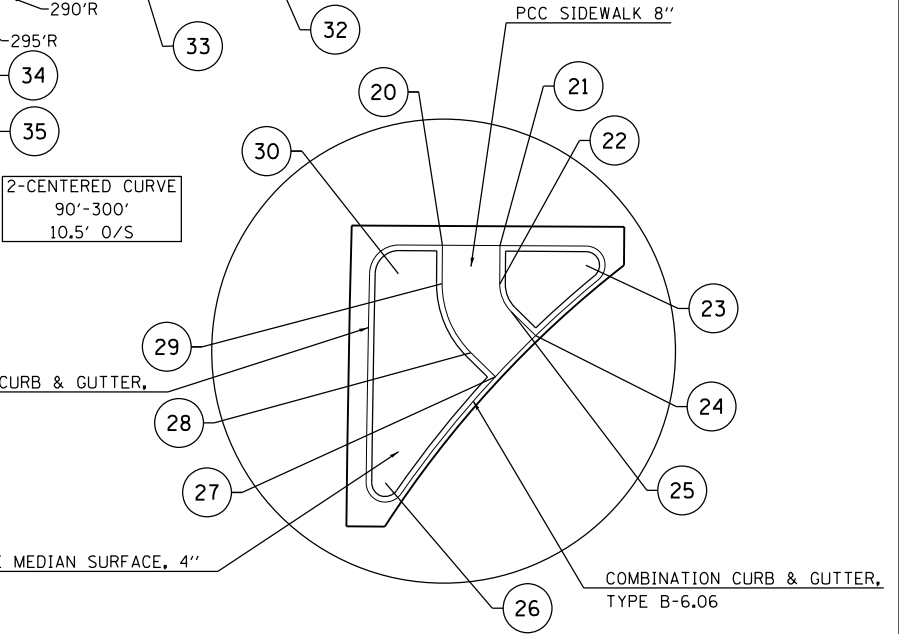
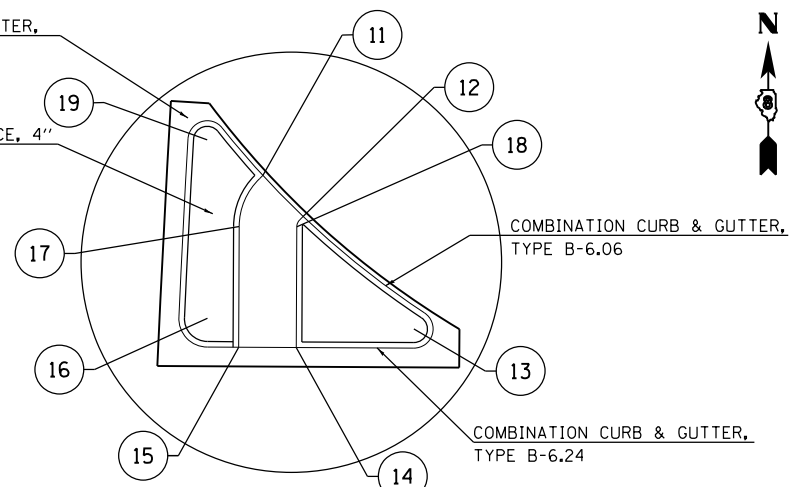
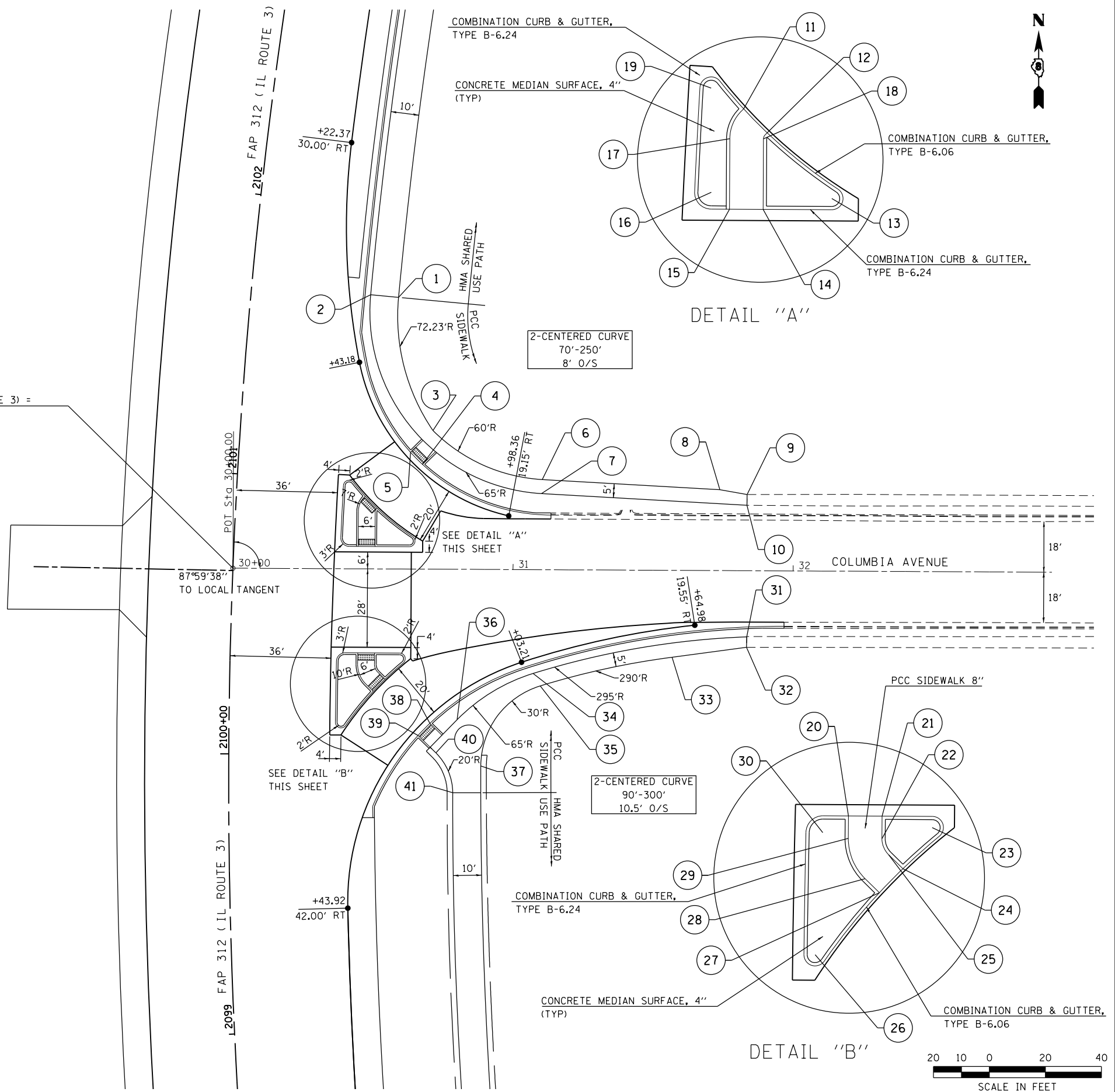

LAST SAVED = 1/24/2013
 PEN TABLE = 1/24/2013
 PLOT DRIVER = pdfplotlayers.plt

FILE NAME =	USER NAME = beriechmann	DESIGNED -	REVISED -
1:\1001100\Phase II - 76817\Cad\T\Plans\081.D876817-sht-intersec-06.dgn		DRAWN -	REVISED -
PLOT SCALE = 40.0000' / in.		CHECKED -	REVISED -
PLOT DATE = 1/25/2013 3:33:18 PM		DATE -	REVISED -

STATE OF ILLINOIS
DEPARTMENT OF TRANSPORTATION



INTERSECTION DETAILS
 FAP 312 (IL ROUTE 3) & COLUMBIA AVENUE

SCALE: 1" = 20' SHEET NO. 1 OF 2 SHEETS STA. TO STA.

F.A.P. RTE.	SECTION	COUNTY	TOTAL SHEETS	SHEET NO.
312	68-WRS-1	MONROE	760	358
CONTRACT NO. 76817				
ILLINOIS FED. AID PROJECT				