

LONGITUDINAL SECTION

- * Cut and/or bend bars to fit.
- ** 12-#6 a₂ bars at 9" cts., Bott. of Top Slab. Cut to fit skew and place remainder in Top of Bott. Slab. Place hooked end along outside edge of slab.
- *** 6-#6 a₁ bars at 9" cts., Bott. of Top Slab and Top of Bottom Slab
- **** 5-#6 a₁ bars at 9" cts., Bott. of Top Slab and Top of Bottom Slab
- 3-#5 a₃ bars at 18" cts., Top of Top Slab
- 3-#4 a bars at 2'-0" cts., Bott. of Bott. Slab
- ***** 2-#6 h bars in Bott. of Headwall and Top of Bott. Slab.
- ***** 8-#5 v₃ bars at 12" cts., N. Wall
- 14-#5 v₃ bars at 12" cts., S. Wall
- ***** 8-#5 h₅ bars at 12" cts., N. Wall
- 8-#5 h₆ bars at 12" cts., S. Wall

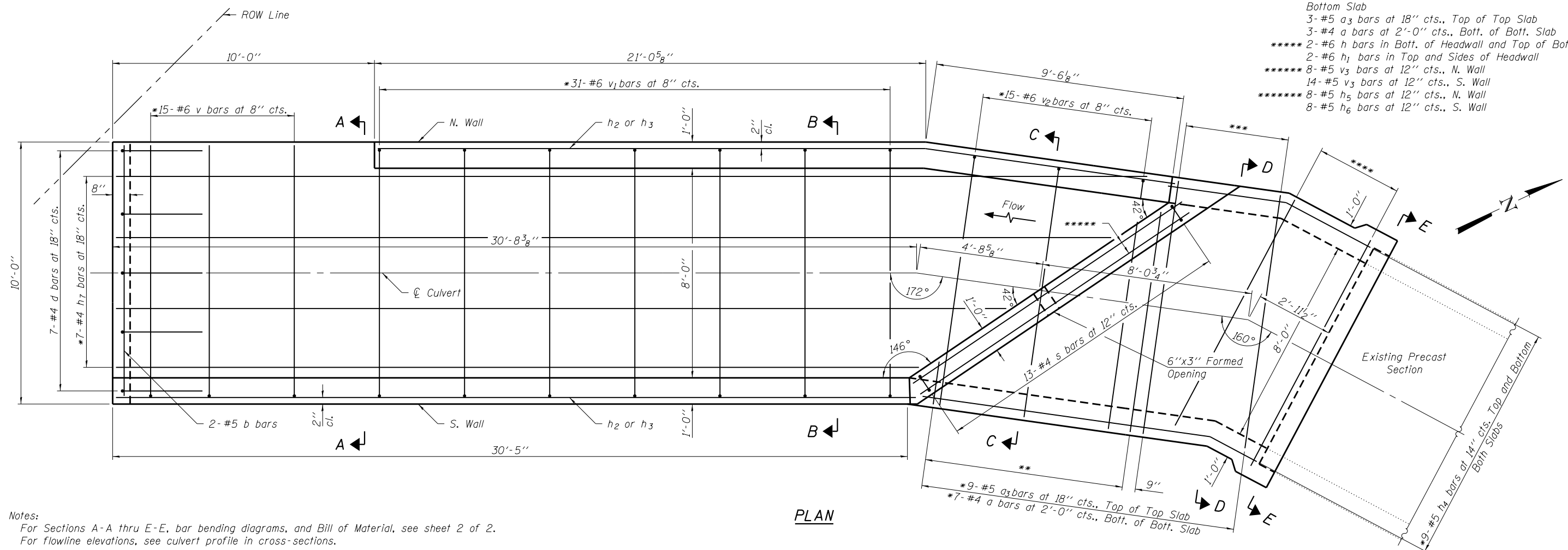

PLAN

Notes:
 For Sections A-A thru E-E, bar bending diagrams, and Bill of Material, see sheet 2 of 2.
 For flowline elevations, see culvert profile in cross-sections.

LAST SAVED = 1/23/2013 11:46:20 AM
 PEN TABLE = V:\2013\11\11001100\Phase II - 76817\Cad\S\Plans\Headwalls-76817.dgn
 PLOT DRIVER = pdfplotlayers=pltdcf9

FILE NAME = 11001100\Phase II - 76817\Cad\S\Plans\Headwalls-76817.dgn	USER NAME = elagemann	DESIGNED K.A. Klues	REVISED -
		DRAWN K.A. Klues	REVISED -
		CHECKED E.M. Lagemann	REVISED -
PLOT DATE = 1/23/2013 11:46:20 AM		DATE 01/09/2013	REVISED -

STATE OF ILLINOIS
 DEPARTMENT OF TRANSPORTATION

HORNER &
 SHIRIN, INC.
 ENGINEERS

DOWNSTREAM APRON DETAILS
 CULVERT AT STA. 2028+57.35

SCALE: SHEET NO. 1 OF 2 SHEETS STA. 2027+92.00 TO STA. 2028+94.45

F.A.P. R.E. 312	SECTION 68-WRS-1	COUNTY MONROE	TOTAL SHEETS 760	SHEET NO. 437
CONTRACT NO. 76817				
ILLINOIS FED. AID PROJECT				