

DEVELOPED PARTIAL ELEVATION

(Looking East)
(All dimensions measured along front face of wall)

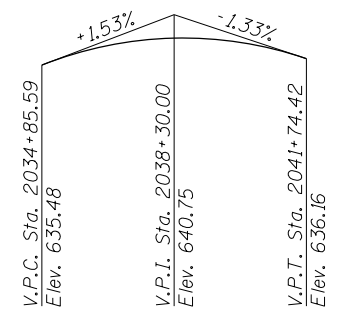

PROFILE GRADE
(Along @ F.A.P. Rte. 312)

LOADING

Wind Load = 25 psf

DESIGN SPECIFICATIONS

2012 AASHTO LRFD Bridge Design Specifications, 6th Edition
2002 AASHTO "Guide Specifications for Structural Design of Sound Barriers"

DESIGN STRESSES

FIELD UNITS

f'_c = 3,500 psi
 f_y = 60,000 psi (Reinforcement)
 f_y = 50,000 psi (M270 Grade 50)

F.A.P. Rte. 312

CURVE CENSHT31 DATA

P.I. Sta. = 2036+53.48
 Δ = 22° 38' 38" (Lt.)
 D = 3° 01' 14"
 R = 1,896.86'
 T = 379.79'
 L = 749.66'
 E = 37.65'
P.C. Sta. = 2032+73.70
P.T. Sta. = 2040+23.36
S.E. = 5.00%

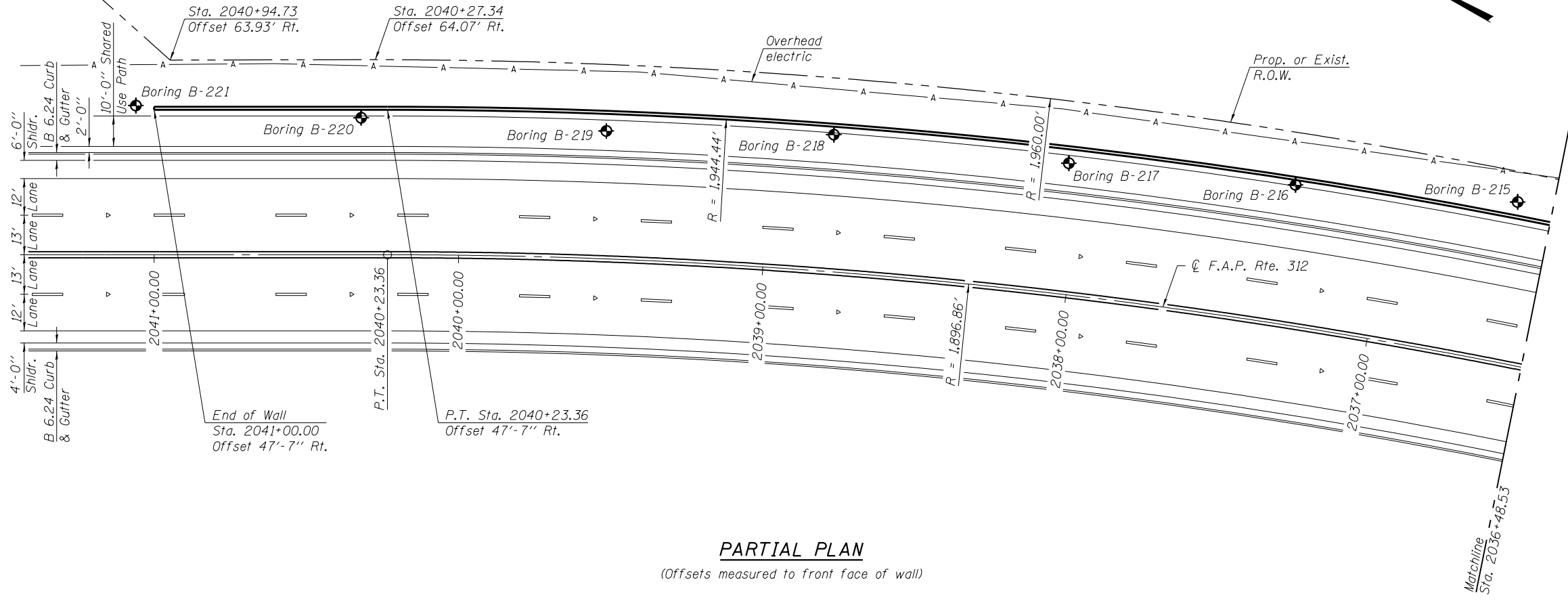

PARTIAL PLAN

(Offsets measured to front face of wall)

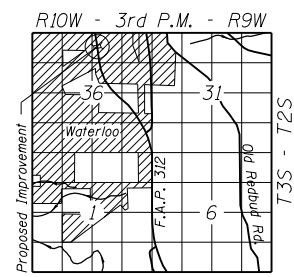

LOCATION SKETCH

Note:
For Typical Section, see sheet 3 of 10.

LAST SAVED = 1/23/2013 12:00:40 PM
 PEN TABLE = W:\4414141
 PLOT DRIVER = pdfplotlayers.batcf9

FILE NAME = I:\1001100\Phase II - 76817\Cad\5\Plans\NoiseWall-76817.dgn	USER NAME = elagemann	DESIGNED E.M. Lagemann	REVISED -	STATE OF ILLINOIS DEPARTMENT OF TRANSPORTATION	HORNER & SHIRIN, INC. ENGINEERS	GENERAL PLAN & ELEVATION I NOISEWALL		F.A.P. RTE. 312	SECTION 68-WRS-1	COUNTY MONROE	TOTAL SHEETS 760	SHEET NO. 453	
PLOT SCALE = 0:2.0000 '1' = 1"	CHECKED K.L. Hayes	REVISOR	REVISOR			SCALE:	SHEET NO. 1 OF 10 SHEETS	STA. 2032+00.00 TO STA. 2041+00.00	CONTRACT NO. 76817				
PLOT DATE = 1/23/2013 12:00:40 PM	DATE 12/14/12	REVISOR	REVISOR			ILLINOIS FED. AID PROJECT							