

DATE	
BY	
FINAL SURVEY	SURVEYED
NOTE BOOK	PLOTTED
NO.	TEMPLATE
	AREAS
	CHECKED

DATE	
BY	
ORIGINAL SURVEY	SURVEYED
NOTE BOOK	PLOTTED
NO.	TEMPLATE
	AREAS
	CHECKED

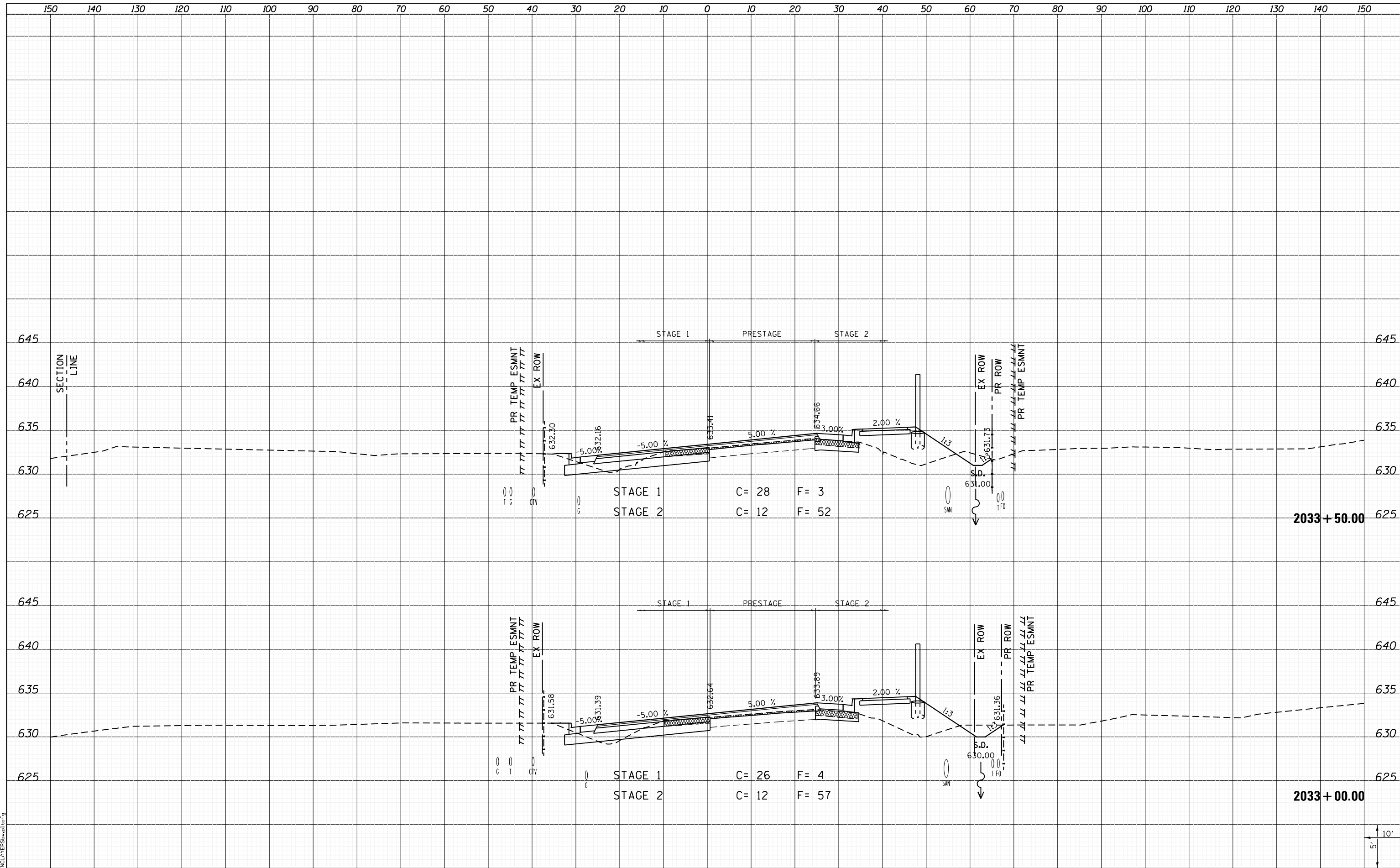

LAST SAVED = 1/25/2013 4:53:36 PM
 PEN TABLE = \\h1-hat\rd1
 PLOT DRIVER = \\h1-hat\rd1

FILE NAME =	USER NAME = kakluos	DESIGNED -	REVISIED -
I:\1001100\Phase II - 76817\Cad\T\Plans\300.08	76817-sh1-IL3-xssht.dgn	DRAWN -	REVISIED -
	PLOT SCALE = 20.0000' / in.	CHECKED -	REVISIED -
	PLOT DATE = 1/25/2013 4:53:36 PM	DATE -	REVISIED -

**STATE OF ILLINOIS
DEPARTMENT OF TRANSPORTATION**



**CROSS SECTIONS
IL ROUTE 3**

SCALE: SHEET 51 OF 197 SHEETS STA. 2033+00.00 TO STA. 2033+50.00

F.A.P. RTE.	SECTION	COUNTY	TOTAL SHEETS	SHEET NO.
312	68-WRS-1	MONROE	760	537
				CONTRACT NO. 76817
ILLINOIS FED. AID PROJECT				

