

DATE	
BY	
FINAL SURVEY	SURVEYED
NOTE BOOK	PLOTTED
NO.	TEMPLATE
	AREAS
	CHECKED

DATE	
BY	
ORIGINAL SURVEY	SURVEYED
NOTE BOOK	PLOTTED
NO.	TEMPLATE
	AREAS
	CHECKED

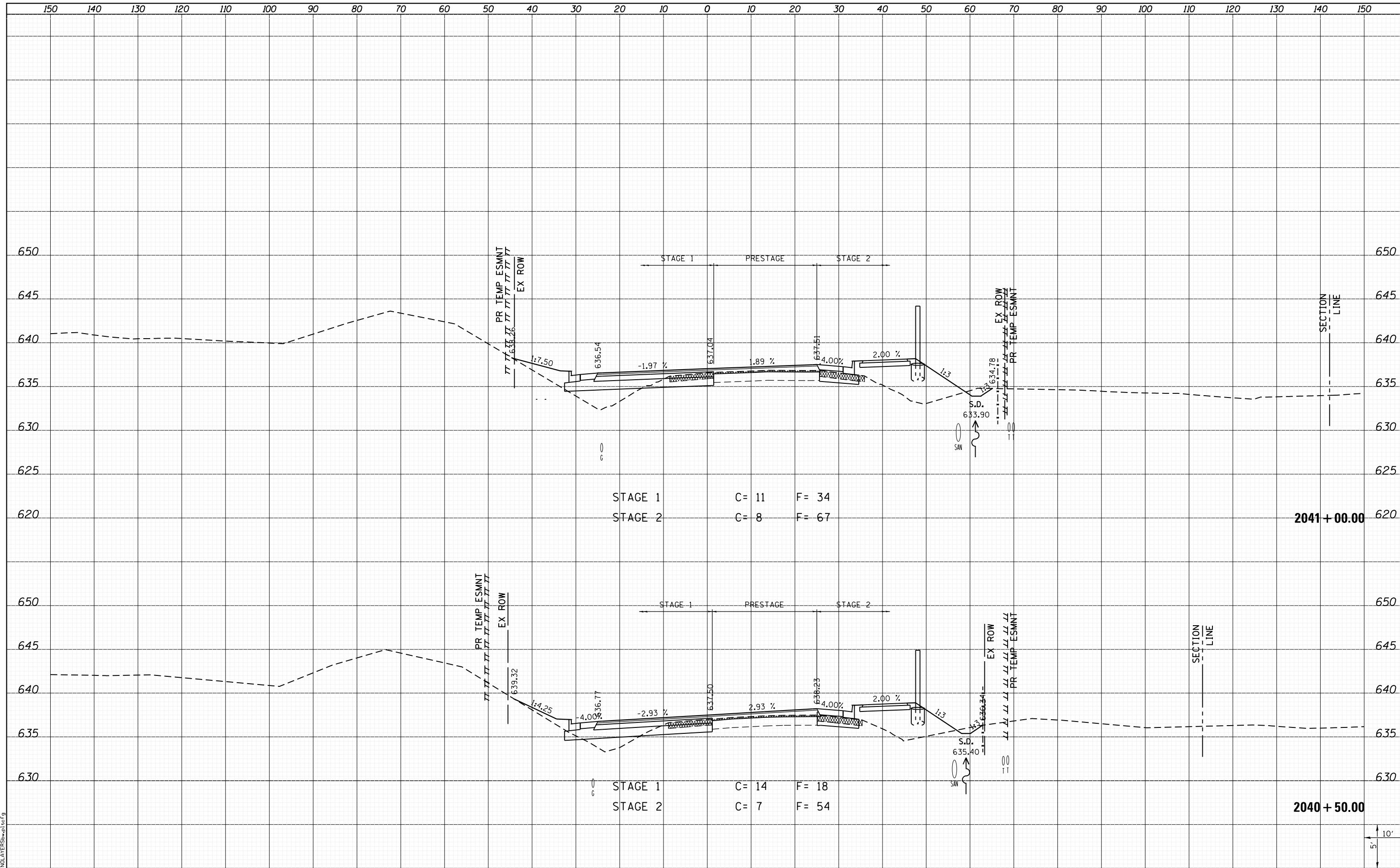

STAGE 1 C= 11 F= 34  
 STAGE 2 C= 8 F= 67

STAGE 1 C= 14 F= 18  
 STAGE 2 C= 7 F= 54

2041 + 00.00

2040 + 50.00

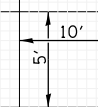

LAST SAVED = 1/25/2013  
 PEN TABLE = VBI-HAI-FBI  
 PLOT DRIVER = PLOTDRIVER\$HWPLT\$G

FILE NAME =	USER NAME = kakluos	DESIGNED -	REVISD -
I:\1001100\Phase II - 76817\Cad\T\Plans\300.08	76817-sh1-IL3-xssh.dgn	DRAWN -	REVISD -
	PLOT SCALE = 20.0000' / in.	CHECKED -	REVISD -
	PLOT DATE = 1/25/2013 4:54:11 PM	DATE -	REVISD -

STATE OF ILLINOIS  
 DEPARTMENT OF TRANSPORTATION



CROSS SECTIONS  
 IL ROUTE 3

SCALE: SHEET 58 OF 197 SHEETS STA. 2040+50.00 TO STA. 2041+00.00

F.A.P. RTE.	SECTION	COUNTY	TOTAL SHEETS	SHEET NO.
312	68-WRS-1	MONROE	760	544
			CONTRACT NO. 76817	
ILLINOIS FED. AID PROJECT				