

DATE	
BY	
FINAL SURVEY	
PLOTTED	
TEMPLATE	
NOTE BOOK	
AREAS CHECKED	
NO.	

DATE	
BY	
ORIGINAL SURVEY	
PLOTTED	
TEMPLATE	
NOTE BOOK	
AREAS CHECKED	
NO.	

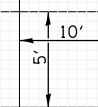
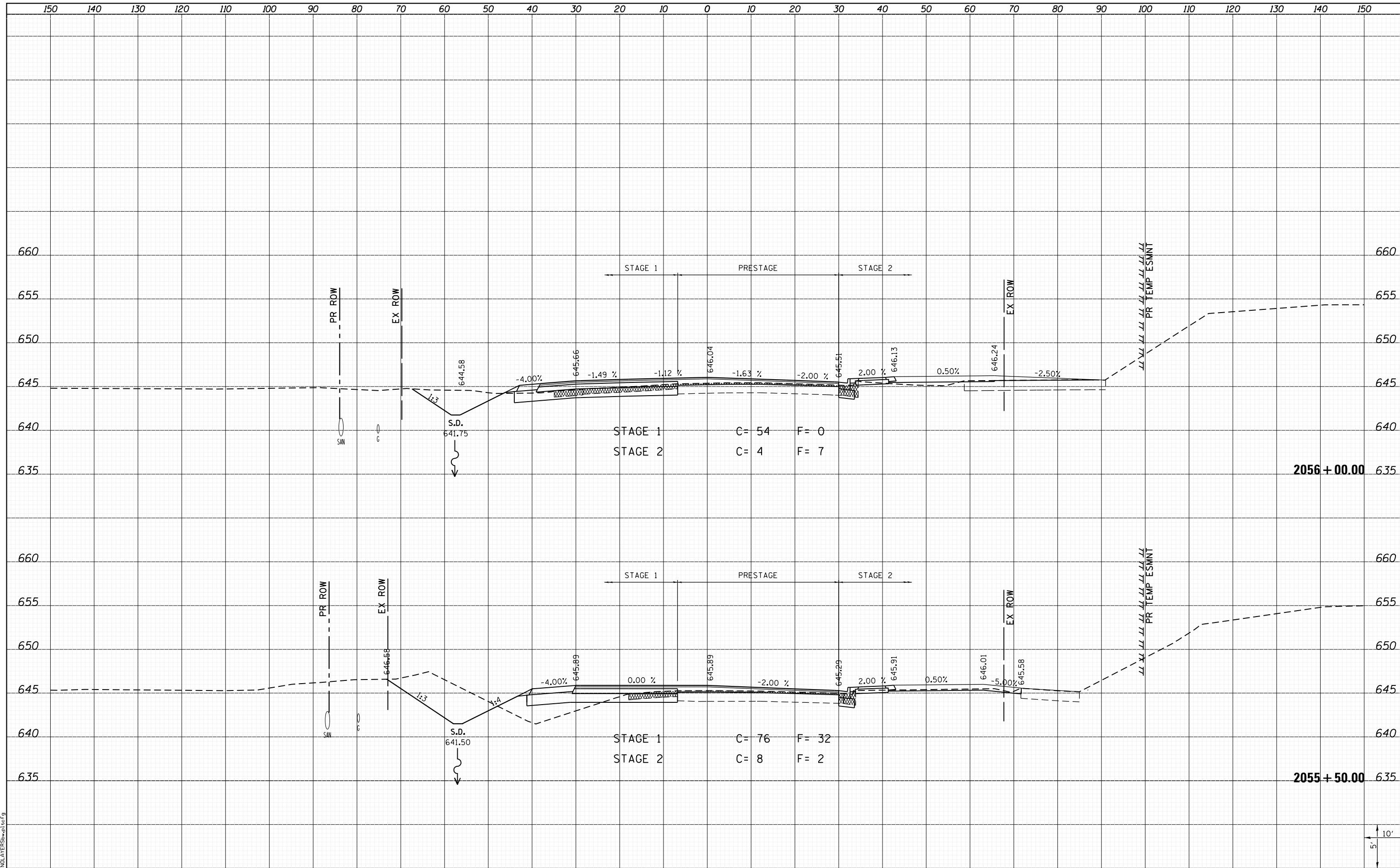

LAST SAVED = 1/25/2013 4:55:29 PM  
PEN TABLE = \\h1-hat\rd1  
PLOT DRIVER = \\h1-hat\rd1

FILE NAME =	I:\10011001_Phase II - 76817\Cad\T\Plans\300.08
USER NAME =	kakluos
DESIGNED -	REVISIED -
DRAWN -	REVISIED -
CHECKED -	REVISIED -
DATE -	REVISIED -
PLOT SCALE =	20.0000' / in.
PLOT DATE =	1/25/2013 4:55:29 PM

**STATE OF ILLINOIS  
DEPARTMENT OF TRANSPORTATION**



**CROSS SECTIONS  
IL ROUTE 3**

SCALE: SHEET 74 OF 197 SHEETS STA. 2055+50.00 TO STA. 2056+00.00

F.A.P. RTE.	SECTION	COUNTY	TOTAL SHEETS	SHEET NO.
312	68-WRS-1	MONROE	760	560
				CONTRACT NO. 76817
ILLINOIS FED. AID PROJECT				