

DATE	
BY	
SURVEYED	
PLOTTED	
TEMPLATE	
AREAS	
CHECKED	
NO.	

DATE	
BY	
SURVEYED	
PLOTTED	
TEMPLATE	
AREAS	
CHECKED	
NO.	

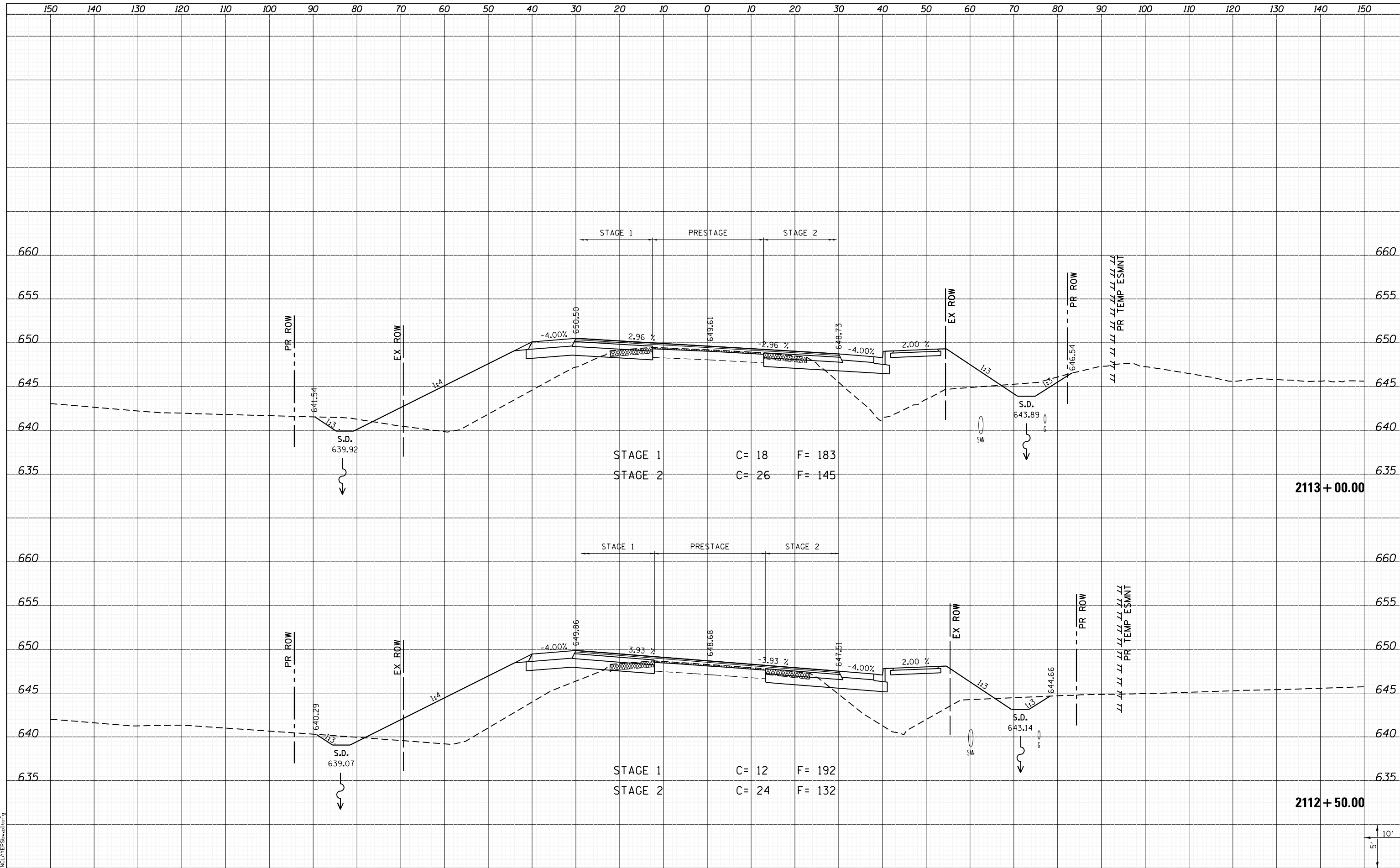

LAST SAVED = 1/25/2013
 PEN TABLE = VBI-H&I-F&E
 PLOT DRIVER = PLOTDRIVER\$HPLOT\$G

FILE NAME = I:\10011001_Phase II - 76817\Cad\T\Plans\300.08	USER NAME = kakluos	DESIGNED -	REVISED -
	76817-sh1-IL3-xssht.dgn	DRAWN -	REVISED -
	PLOT SCALE = 20.0000' / in.	CHECKED -	REVISED -
	PLOT DATE = 1/25/2013 5:00:41 PM	DATE -	REVISED -

**STATE OF ILLINOIS
 DEPARTMENT OF TRANSPORTATION**



**CROSS SECTIONS
 IL ROUTE 3**

SCALE: SHEET 134 OF 197 SHEETS STA. 2112+50.00 TO STA. 2113+00.00

F.A.P. RTE.	SECTION	COUNTY	TOTAL SHEETS	SHEET NO.
312	68-WRS-1	MONROE	760	620
CONTRACT NO. 76817			ILLINOIS FED. AID PROJECT	

