

DATE	
BY	
SURVEYED	
PLOTTED	
TEMPLATE	
AREAS	
CHECKED	
NO.	

DATE	
BY	
SURVEYED	
PLOTTED	
TEMPLATE	
AREAS	
CHECKED	
NO.	

LAST SAVED = 1/25/2013 5:01:01 PM  
 PEN TABLE = hb\hpl\tbl  
 PLOT DRIVER = hb\hpl\drivers\p13.ctb

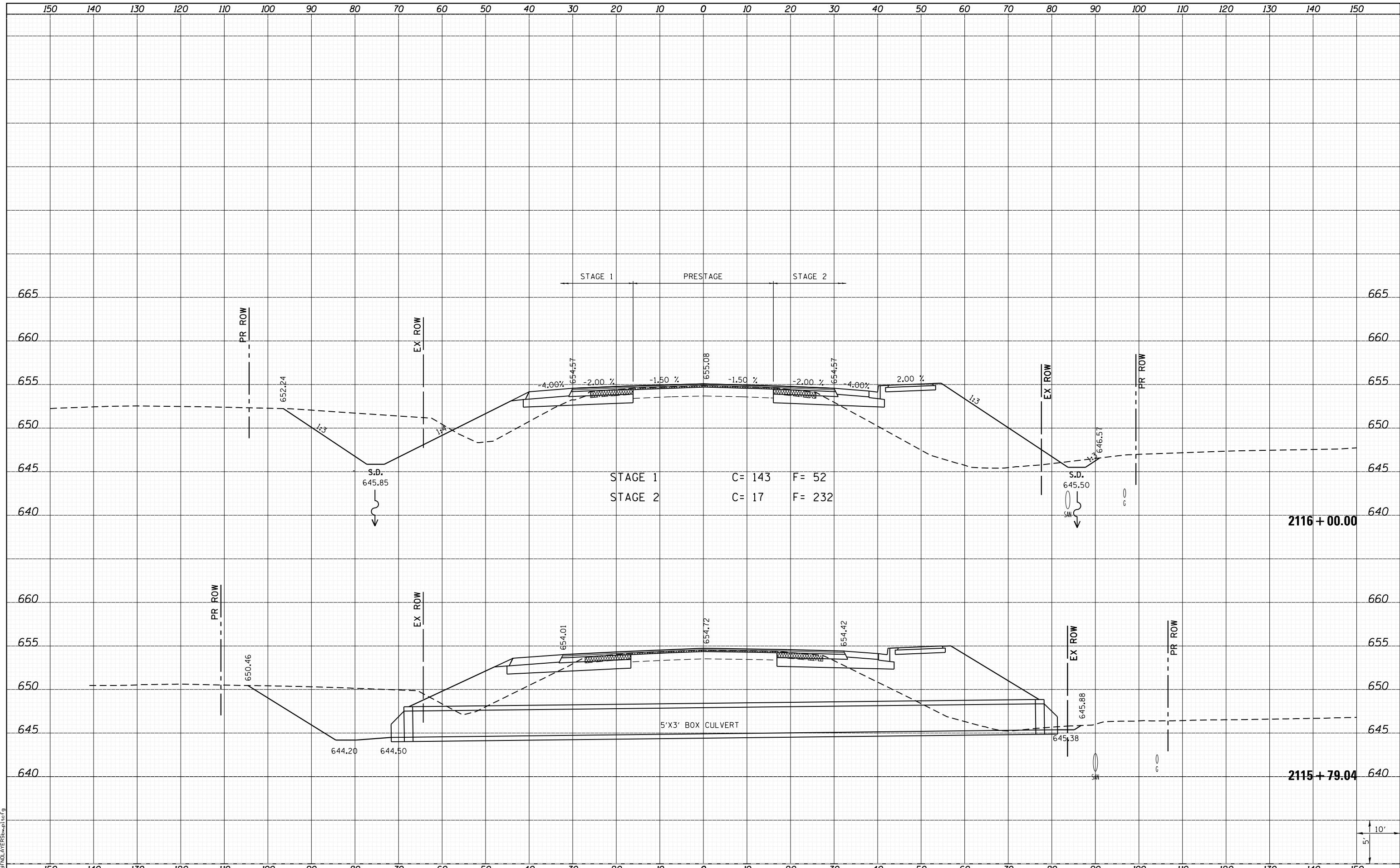

FILE NAME = I:\10011001_Phase II - 76817\Cad\T\Plans\300.08	USER NAME = kakluos	DESIGNED -	REVISIED -	<b>STATE OF ILLINOIS</b> <b>DEPARTMENT OF TRANSPORTATION</b>	<b>HORNER &amp; SHIRIN, INC.</b> <b>ENGINEERS</b>	<b>CROSS SECTIONS</b>		F.A.P. RTE. 312	SECTION 68-WRS-1	COUNTY MONROE	TOTAL SHEETS 760	SHEET NO. 624		
PLOT SCALE = 20.0000' / in.	CHECKED -	REVISIED -	SCALE:			SHEET 138 OF 197 SHEETS	STA. 2115+79.04 TO STA. 2116+00.00	CONTRACT NO. 76817		ILLINOIS FED. AID PROJECT				
PLOT DATE = 1/25/2013 5:01:01 PM	DATE -	REVISIED -												