

DATE	
BY	
FINAL SURVEY	SURVEYED
NOTE BOOK	PLOTTED
NO.	TEMPLATE
	AREAS
	CHECKED

DATE	
BY	
ORIGINAL SURVEY	SURVEYED
NOTE BOOK	PLOTTED
NO.	TEMPLATE
	AREAS
	CHECKED

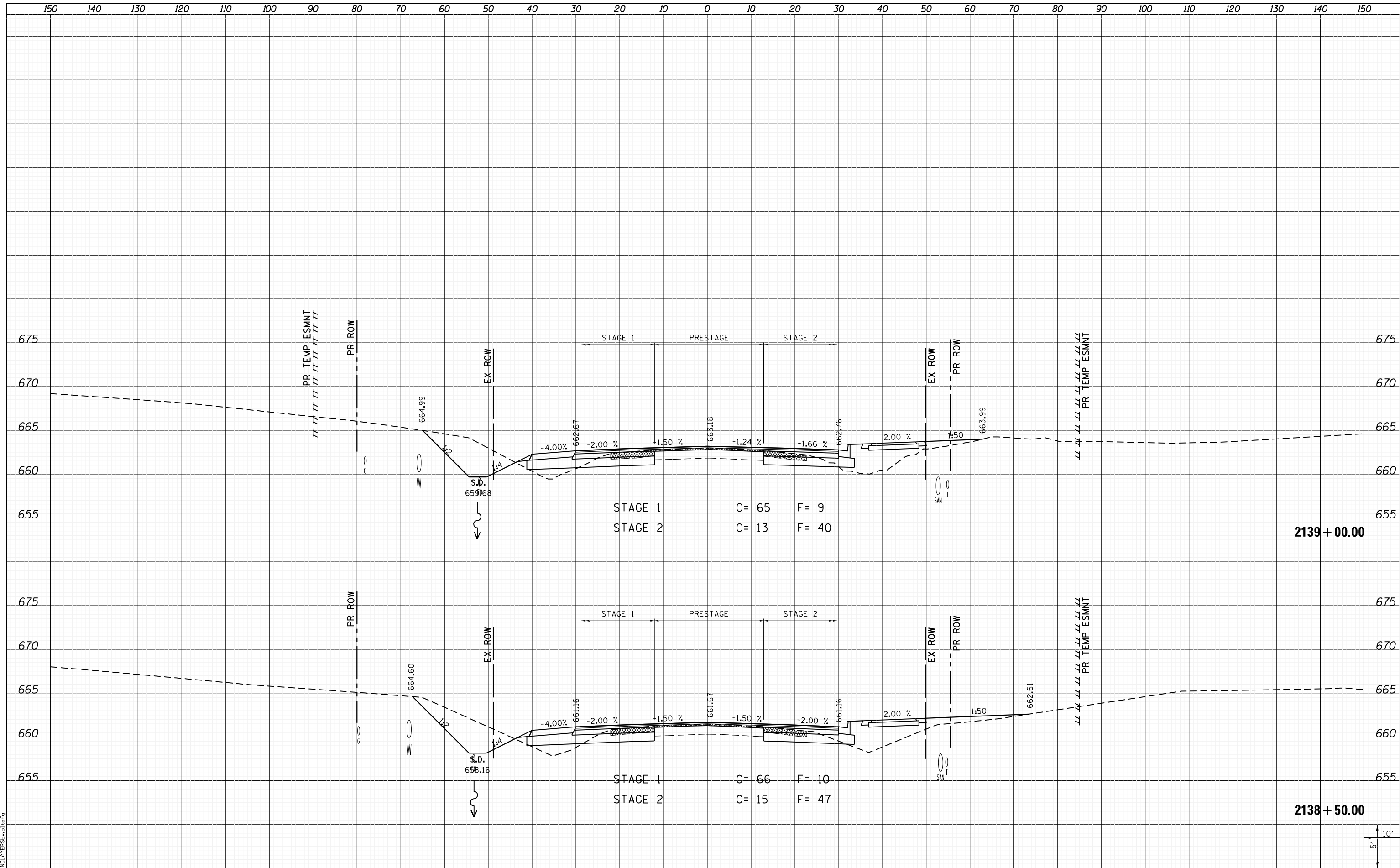

LAST SAVED = 1/25/2013
 PEN TABLE = 161-hat.rdi
 PLOT DRIVER = pdfplotter.exe

FILE NAME =	I:\10011001_Phase II - 76817\Cad\T\Plans\300.08
USER NAME =	kaklues
DESIGNED -	REVISD -
DRAWN -	REVISD -
CHECKED -	REVISD -
DATE -	REVISD -
PLOT SCALE =	20.0000' / in.
PLOT DATE =	1/25/2013 5:03:04 PM

DESIGNED -	REVISD -
DRAWN -	REVISD -
CHECKED -	REVISD -
DATE -	REVISD -

STATE OF ILLINOIS
 DEPARTMENT OF TRANSPORTATION



CROSS SECTIONS
 IL ROUTE 3

SCALE: SHEET 163 OF 197 SHEETS STA. 2138+50.00 TO STA. 2139+00.00

F.A.P. RTE.	SECTION	COUNTY	TOTAL SHEETS	SHEET NO.
312	68-WRS-1	MONROE	760	649
				CONTRACT NO. 76817
ILLINOIS FED. AID PROJECT				