

DATE	
BY	
SURVEYED	
PLOTTED	
TEMPLATE	
AREAS	
CHECKED	
NO.	

DATE	
BY	
SURVEYED	
PLOTTED	
TEMPLATE	
AREAS	
CHECKED	
NO.	

LAST SAVED = 1/25/2013  
 PEN TABLE = VBI-Hat.rdi  
 PLOT DRIVER = PLOTDRIVER.batcf9

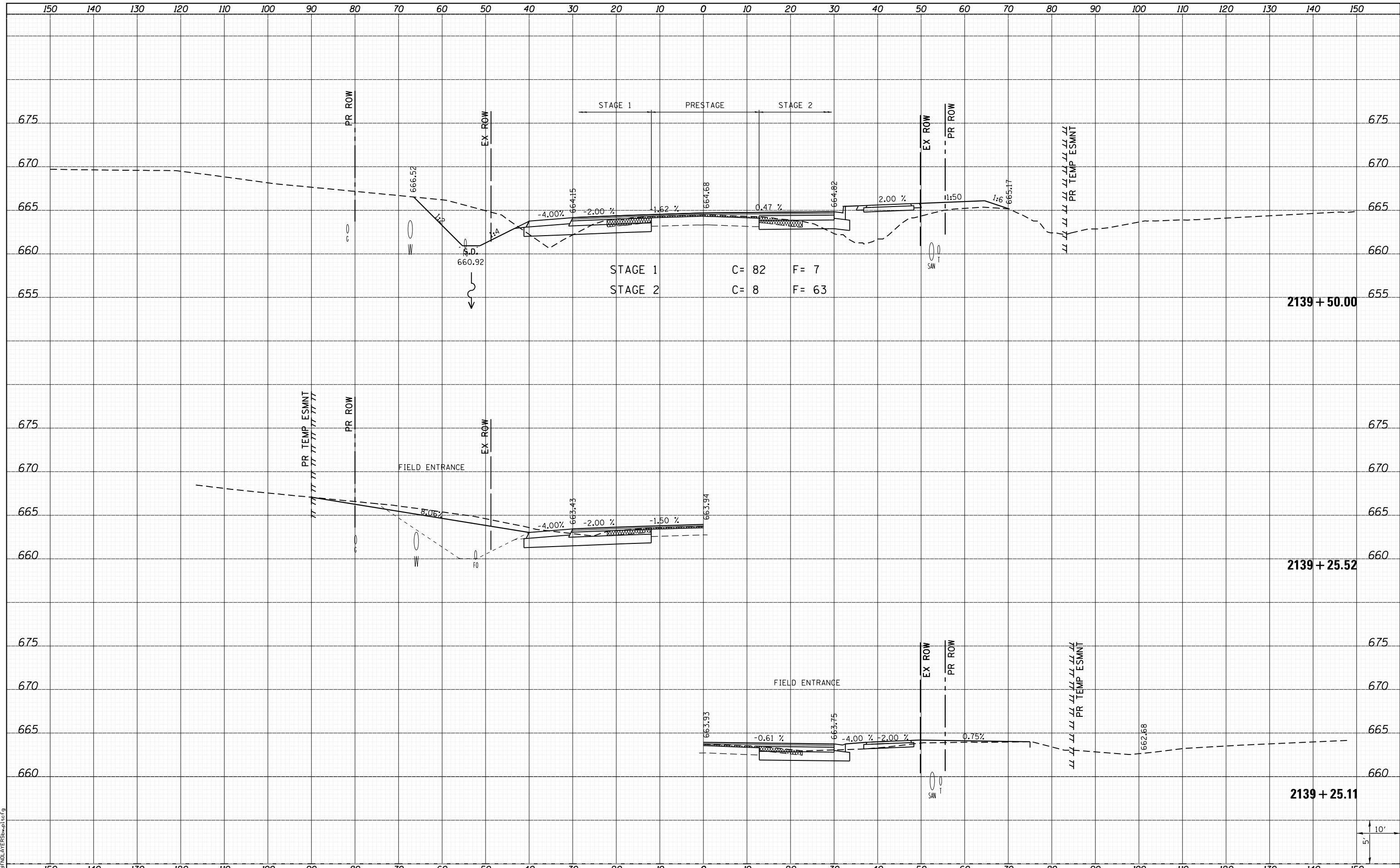

STAGE 1 C = 82 F = 7  
 STAGE 2 C = 8 F = 63

2139 + 50.00

2139 + 25.52

2139 + 25.11

FILE NAME = I:\10011001_Phase II - 76817\Cad\T\Plans\300.08	USER NAME = kakluos	DESIGNED -	REVISIED -	<b>STATE OF ILLINOIS</b> <b>DEPARTMENT OF TRANSPORTATION</b>		<b>CROSS SECTIONS</b>		F.A.P. RTE. 312	SECTION 68-WRS-1	COUNTY MONROE	TOTAL SHEETS 760	SHEET NO. 650	
		DRAWN -	REVISIED -			SCALE:	SHEET 164 OF 197 SHEETS	STA. 2139+25.11	TO STA. 2139+50.00	CONTRACT NO. 76817			
		CHECKED -	REVISIED -			ILLINOIS FED. AID PROJECT							
		DATE -	REVISIED -										