

DATE	
BY	
FINAL SURVEY	SURVEYED
NOTE BOOK	PLOTTED
NO.	TEMPLATE
	AREAS CHECKED
	AREAS CHECKED

DATE	
BY	
ORIGINAL SURVEY	SURVEYED
NOTE BOOK	PLOTTED
NO.	TEMPLATE
	AREAS CHECKED
	AREAS CHECKED

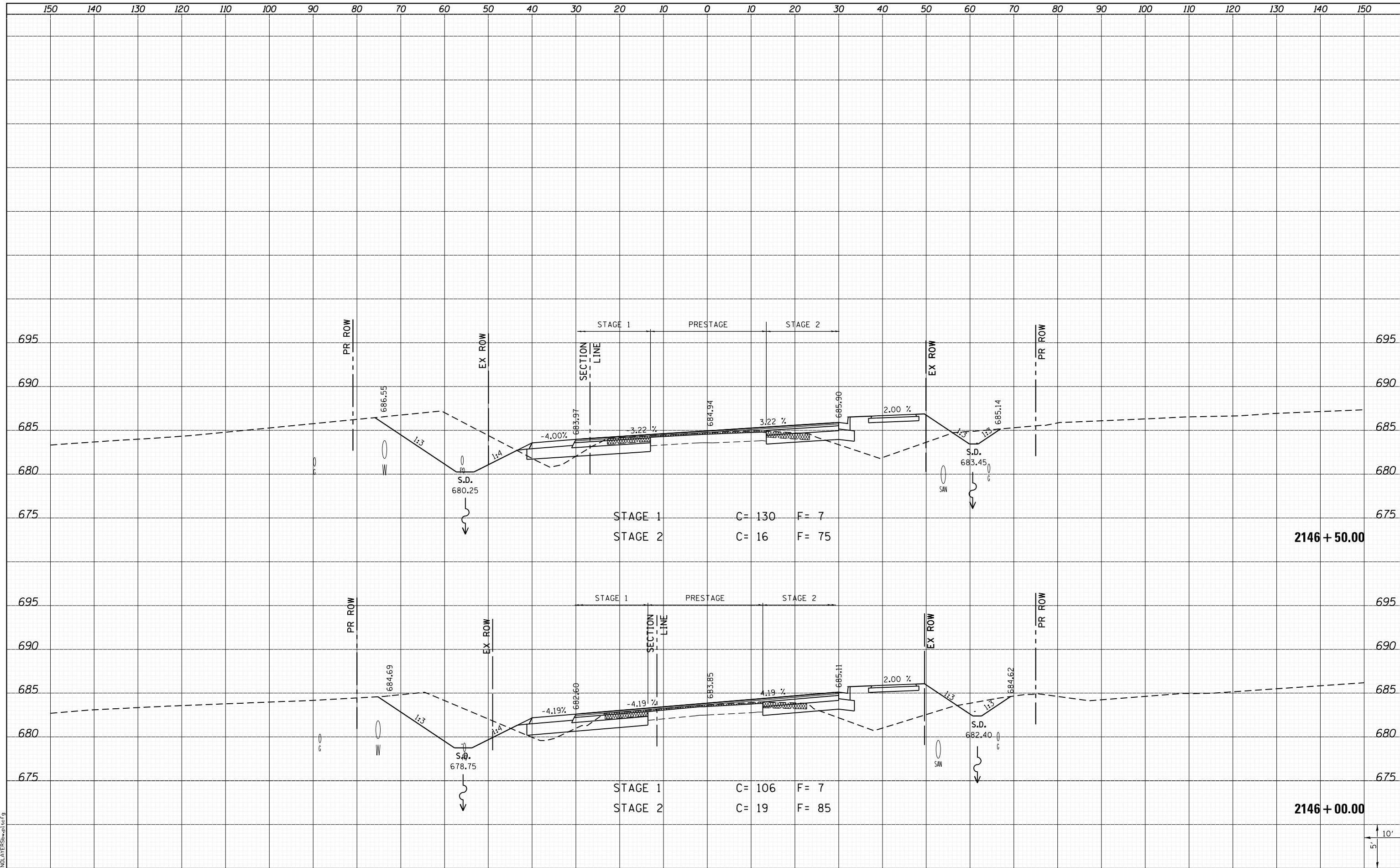

LAST SAVED = 1/25/2013
 PEN TABLE = 161-hat.tbl
 PLOT DRIVER = pdfplotter.exe

FILE NAME = I:\10011001\Phase II - 76817\Cad\T\Plans\300.08	USER NAME = kakluus	DESIGNED -	REVISD -	STATE OF ILLINOIS DEPARTMENT OF TRANSPORTATION		CROSS SECTIONS IL ROUTE 3		F.A.P. RTE.	SECTION	COUNTY	TOTAL SHEETS	SHEET NO.
		DRAWN -	REVISD -					312	68-WRS-1	MONROE	760	657
		CHECKED -	REVISD -					CONTRACT NO. 76817				
		DATE -	REVISD -					ILLINOIS FED. AID PROJECT				
PLOT SCALE = 20.0000' / in. PLOT DATE = 1/25/2013 5:03:44 PM				SCALE:		SHEET 171 OF 197 SHEETS		STA. 2146+00.00 TO STA. 2146+50.00				