

DATE	
BY	
SURVEYED	
PLOTTED	
TEMPLATE	
NOTE BOOK	
AREAS CHECKED	
NO.	

DATE	
BY	
SURVEYED	
PLOTTED	
TEMPLATE	
NOTE BOOK	
AREAS CHECKED	
NO.	

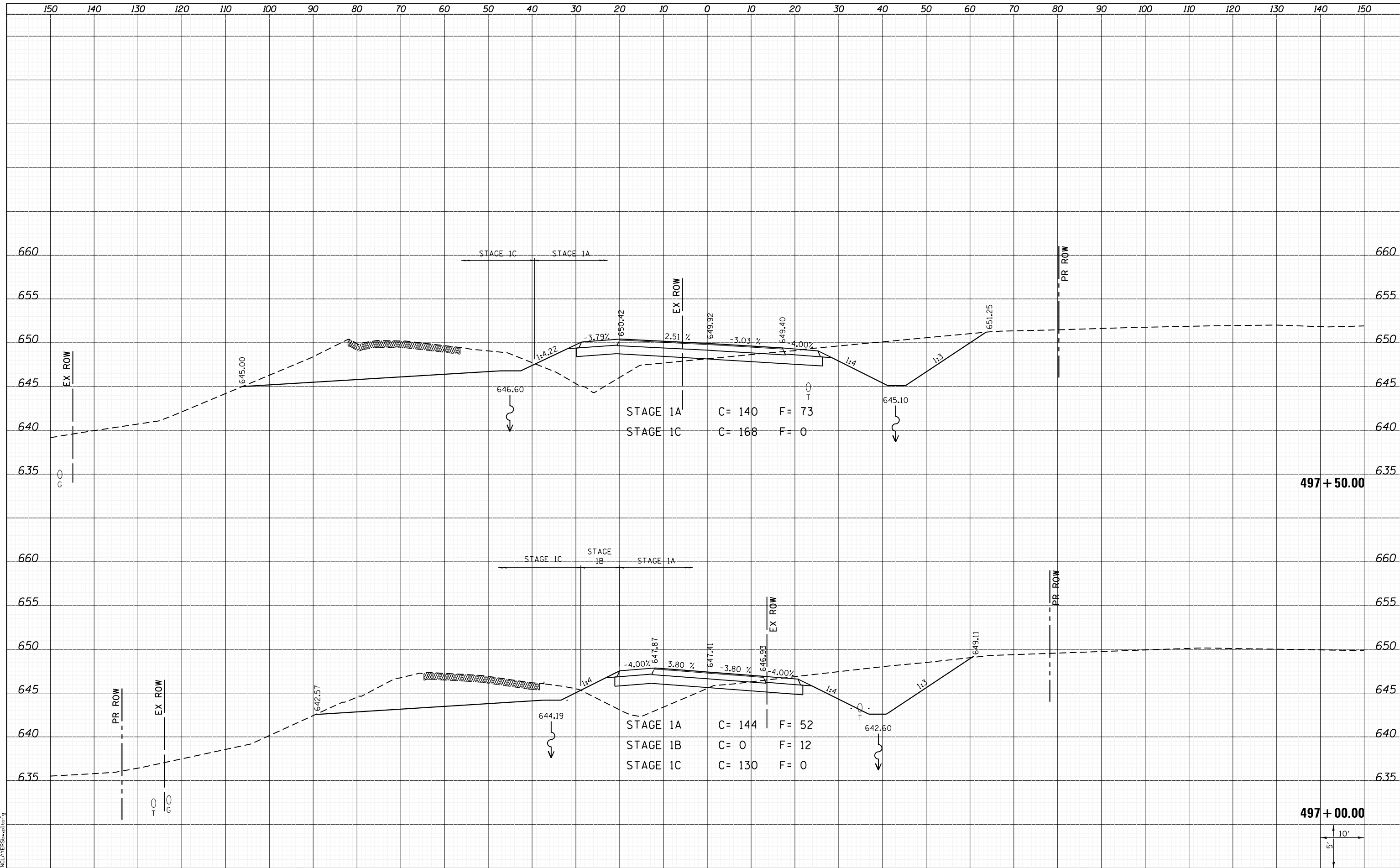

STAGE 1A C = 140 F = 73  
 STAGE 1C C = 168 F = 0

STAGE 1A C = 144 F = 52  
 STAGE 1B C = 0 F = 12  
 STAGE 1C C = 130 F = 0

497 + 50.00

497 + 00.00

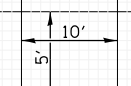

LAST SAVED = 1/22/2013  
 PEN TABLE = 161-hat.tbl  
 PLOT DRIVER = pdfplotter.exe

FILE NAME = I:\10011001_Phase II - 76817\Cad\T\Plans\308.08	USER NAME = kakluos	DESIGNED -	REVISIED -
76817-sh1-GallMoore-xssht.dgn		DRAWN -	REVISIED -
PLOT SCALE = 20.0000' / in.		CHECKED -	REVISIED -
PLOT DATE = 1/25/2013 5:06:31 PM		DATE -	REVISIED -

STATE OF ILLINOIS  
 DEPARTMENT OF TRANSPORTATION



CROSS SECTIONS  
 GALL RD./NORTH MOORE ST.  
 SCALE: SHEET 6 OF 13 SHEETS STA. 497+00.00 TO STA. 497+50.00

F.A.P. RTE.	SECTION	COUNTY	TOTAL SHEETS	SHEET NO.
312	68-WRS-1	MONROE	760	722
CONTRACT NO. 76817			ILLINOIS FED. AID PROJECT	