

STATE OF ILLINOIS
DEPARTMENT OF TRANSPORTATION
DIVISION OF HIGHWAYS
PROPOSED
HIGHWAY PLANS

F.A.P. RTE.	SECTION	COUNTY	TOTAL SHEETS	SHEET NO.
312	(74-1,75,75-1)RS-3	RANDOLPH	130	1
FED. ROAD DIST. NO.	ILLINOIS	CONTRACT NO. 76F92		

FOR INDEX OF SHEETS, SEE SHEET NO. 2

FAP ROUTE 312 (IL 3)
 SECTION: (74-1,75,75-1)RS-3
 PROJECT HSIP-0312(044)
 RANDOLPH COUNTY
 HSIP - RESURFACING &
 SHOULDER/RUMBLE STRIP

C-98-084-12

ROAD DISTRICT 2

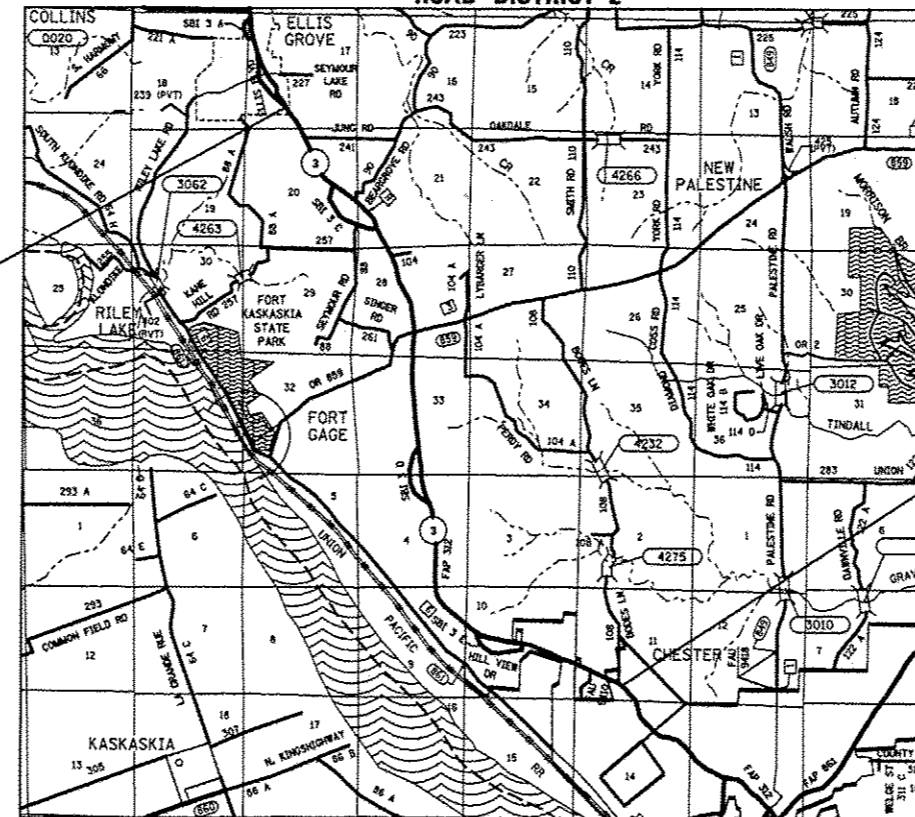

END PROJECT:
 (ELLIS BLVD.)
 STA. 423+17
 LAT: 38.004498
 LONG: -89.900194

BEGIN PROJECT:
 STA. 61+00
 LAT: 37.929413
 LONG: -89.844424

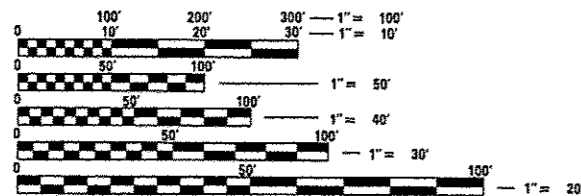

FULL SIZE PLANS HAVE BEEN PREPARED USING STANDARD ENGINEERING SCALES. REDUCED SIZED PLANS WILL NOT CONFORM TO STANDARD SCALES. IN MAKING MEASUREMENTS ON REDUCED PLANS, THE ABOVE SCALES MAY BE USED.

J.U.L.I.E.
 JOINT UTILITY LOCATION INFORMATION FOR EXCAVATION
 1-800-892-0123
 OR 811

PROJECT ENGINEER: MIKE PRITCHETT (618) 346-3180
 SQUAD LEADER: GWEN LAGEMANN (618) 346-3181

CONTRACT NO. 76F92

ADT
4650 (2011)
4700 (2013)
5700 (2033)
SU = 3.9%
MU = 5.4%

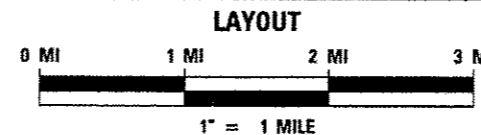

GROSS LENGTH: 36,217 FT (6.86 MILES)
 NET LENGTH: 36,217 FT (6.86 MILES)

FUNCTIONAL ROADWAY CLASSIFICATION:
 OTHER PRINCIPAL ARTERIAL

STATE OF ILLINOIS
 DEPARTMENT OF TRANSPORTATION
 DIVISION OF HIGHWAYS

SUBMITTED April 25 2013

Jeffrey J. Kain
 ACTING DEPUTY DIRECTOR OF HIGHWAYS, REGION 5 ENGINEER

May 10 2013
John D. Baranzelli, P.E.
 ENGINEER OF DESIGN AND ENVIRONMENT

May 10 2013
Omer Osman, P.E.
 DIRECTOR OF HIGHWAYS, CHIEF ENGINEER

**PRINTED BY THE AUTHORITY
 OF THE STATE OF ILLINOIS**