

**NOTE:**

TOP AND FACE OF CURB ARE TO BE PAINTED AND  
RAISED REFLECTIVE PAVEMENT MARKERS PLACED ON  
TOP OF CURB EVERY 40' (SEE DETAIL SHEET NO. 10)

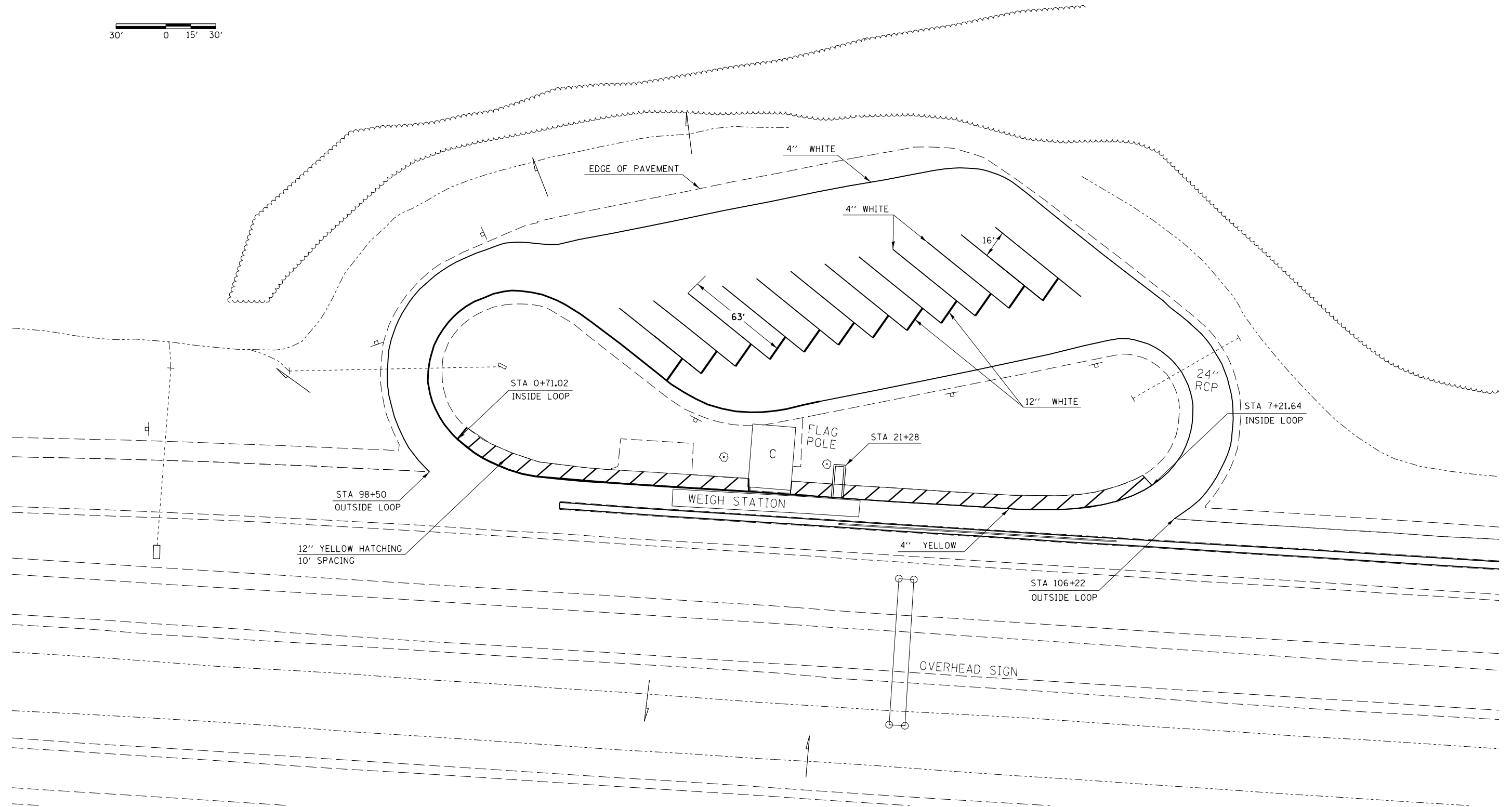

|  |                             |            |           |
|--|-----------------------------|------------|-----------|
| FILE NAME =  | USER NAME = #USER#          | DESIGNED - | REVISED - |
| ct:\pwork\pwork\beelerlj\d0335048\78353-sht-plan.dgn |                             | DRAWN -    | REVISED - |
| #MODELNAME#  | PLOT SCALE = 60.0000' / in. | CHECKED -  | REVISED - |
|  | PLOT DATE = 2/20/2013       | DATE -     | REVISED - |

**STATE OF ILLINOIS  
DEPARTMENT OF TRANSPORTATION**

**SOUTHBOUND WEIGH SCALE**

SCALE: SHEET OF SHEETS STA. TO STA.

| F.A.I. RTE.        | SECTION | COUNTY     | TOTAL SHEETS | SHEET NO. |
|--------------------|---------|------------|--------------|-----------|
| 57                 | *       | WILLIAMSON | 10           | 8         |
| CONTRACT NO. 78353 |         |            |              |           |

ILLINOIS FED. AID PROJECT

\* D9 WEIGH SCALE STRIPING 2013-1