

INDEX OF SHEETS

1	COVER SHEET
2	SUMMARY OF QUANTITIES, SCHEDULE OF QUANTITIES
3	GENERAL NOTES
4-5	TYPICAL SECTIONS
6	PLAN / PROFILE - WINDSOR
7	PLAN / PROFILE - ELKHORN
8-10	PLAN / PROFILE - RALSTON
11	CROSS SECTIONS - WINDSOR
12	CROSS SECTIONS - RALSTON
13	RAMP DETAILS - WINDSOR / ELKHORN & RALSTON
14	RAMP DETAILS - RALSTON
15	DETAILS

F.A. RTE	SECTION	COUNTY	TOTAL SHEETS	SHEET NO.
	10-00027-00-SW	WINNEBAGO	15	1
SRTS-4009(056)		ILLINOIS	CONTRACT NO. 85584	

STATE OF ILLINOIS

SAFE ROUTES TO SCHOOL

SIDEWALK IMPROVEMENTS

SECTION NUMBER: 10-00027-00-SW
PROJECT NUMBER: SRTS-4009(056)
JOB NUMBER: C-40-047-09
CONTRACT No. 85584

VILLAGE OF MACHESNEY PARK/CITY OF LOVES PARK
WINNEBAGO COUNTY, ILLINOIS

HIGHWAY STANDARDS

424001-07	PERPENDICULAR CURB RAMPS FOR SIDEWALKS
424006-01	DIAGONAL CURB RAMPS FOR SIDEWALKS
701006-04	OFF-RD OPERATIONS, 2L 2W, 15'(4.5m) TO 24"(600mm) FROM PAVEMENT EDGE
701101-03	OFF-RD OPERATIONS, MULTILANE, 15'(4.5m) TO 24"(600mm) FROM PAVEMENT EDGE
701301-04	LANE CLOSURE, 2L, 2W, SHORT TIME OPERATIONS
701501-06	URBAN LANE CLOSURE, 2L, 2W, UNDIVIDED
701801-05	SIDEWALK, CORNER OR CROSSWALK CLOSURE
701901-02	TRAFFIC CONTROL DEVICES
720011-01	METAL POSTS FOR SIGNS, MARKERS & DELINEATORS
728001-01	TELESCOPING STEEL SIGN SUPPORT
729001-01	APPLICATIONS OF TYPES A & B METAL POSTS (FOR SIGNS & MARKERS)
780001-03	TYPICAL PAVEMENT MARKINGS
876001-02	PEDESTRIAN PUSHBUTTON POST
878001-09	CONCRETE FOUNDATION DETAILS

UTILITIES

- ELECTRIC:**
COMMONWEALTH EDISON COMPANY
123 ENERGY AVENUE
ROCKFORD, IL 61109
(800) 334-7661
- GAS**
NICOR
4651 LINDEN ROAD
ROCKFORD, IL 61109
(888) 642-6748
- SANITARY SEWER**
R.R.W.R.D.
3333 KISHWAUKEE STREET
ROCKFORD, IL 61109
(815) 387-7660
- WATER**
N.P.P.W.D.
1350 TURRET DRIVE
MACHESNEY PARK, IL 61115
(815) 633-5461
- TELEPHONE**
PROGRESSIVE COMMUNICATIONS SERVICES
625 PURPLE SAGE DRIVE
ROSCOE, IL 61073
- CABLE T.V.**
COMCAST
4450 KISHWAUKEE STREET
ROCKFORD, IL 61109
(815) 395-8977

VILLAGE OF MACHESNEY PARK

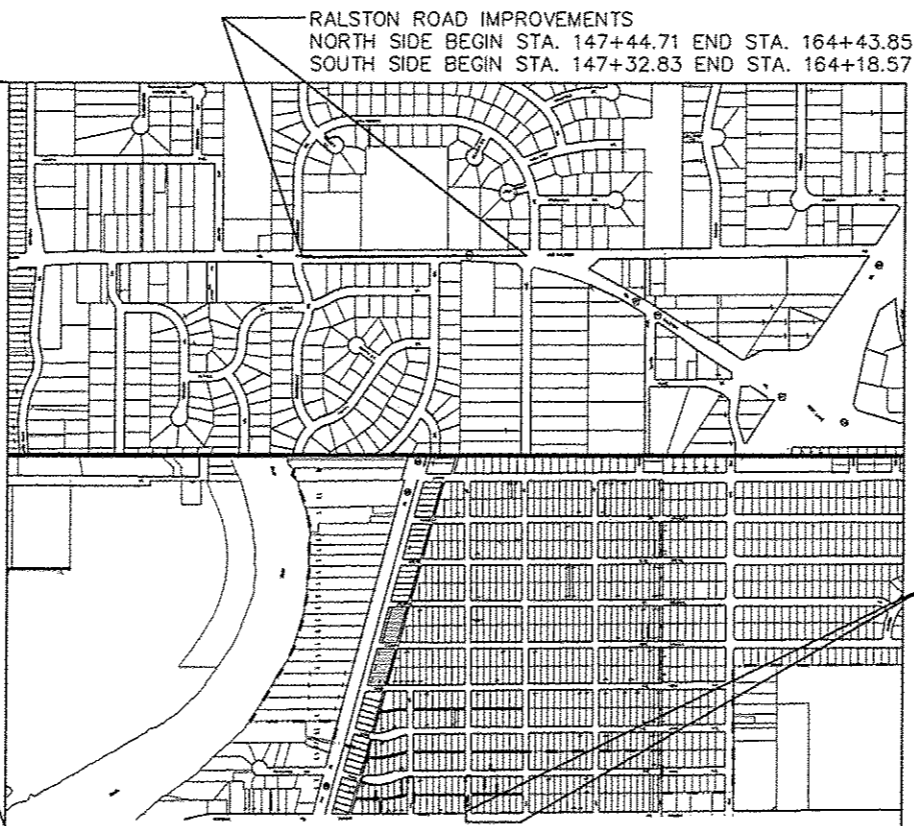
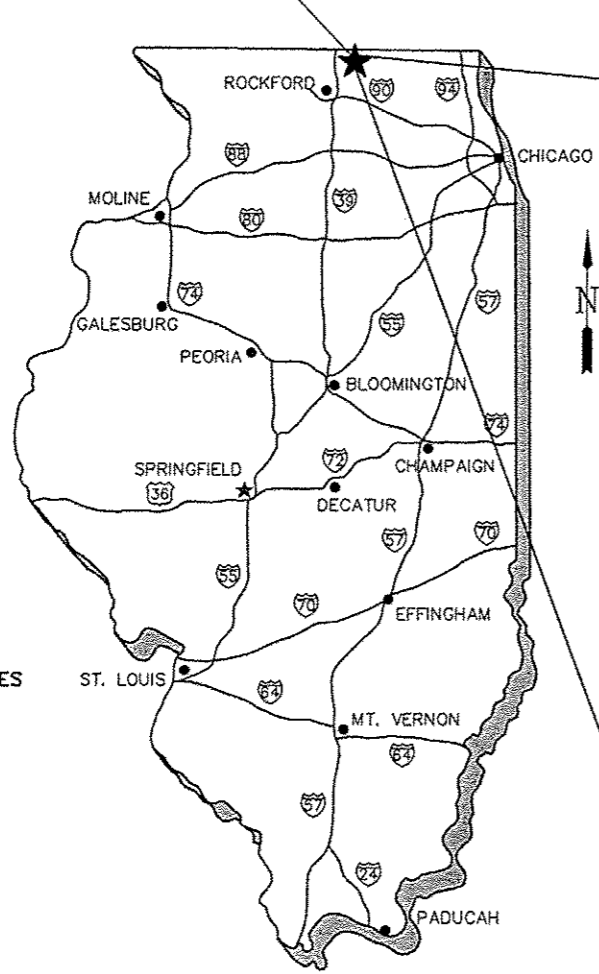

MAP SCALE: NONE
PLAN & PROFILE — HORIZ. SCALE = 1" = 20'
VERT. SCALE = 1" = 5'

FUNCTIONAL CLASSIFICATION: RALSTON RD = COLLECTOR 10,800 ADT
ELKHORN ST = LOCAL <400 ADT

POSTED SPEED LIMIT: RALSTON RD = 35 MPH
ELKHORN ST = 30 MPH

NET LENGTH: RALSTON RD = 1588' = 0.300 MILES
ELKHORN ST = 2610' = 0.494 MILES

WINDSOR ROAD
(SOUTH SIDE ONLY)
BEGIN STA. 131+14.31
END STA. 135+33.38
ELKHORN STREET
(WEST SIDE ONLY)
BEGIN STA. 128+05.15
END STA. 129+13.51

AGENCY RESPONSIBLE FOR LETTING

APPROVED: 3-27-13
DATE: *Tom Stuchland*
VILLAGE OF MACHESNEY PARK

APPROVED: 3-27-13
DATE: *Paul A. Taylor*
CITY OF LOVES PARK

APPROVED: 3/27/13
DATE: *James W. Kroepf*
WINNEBAGO COUNTY Engineer

PASSED: April 11, 2013
DATE: *Jim T. Johnson*
DISTRICT #2 ENGINEER OF LOCAL ROADS & STREETS

RELEASING FOR 'BID BASED ON LIMITED REVIEW:
DATE: April 11, 2013
Paul A. Taylor
DEPUTY DIRECTOR OF HIGHWAYS, REGIN #2 ENGINEER

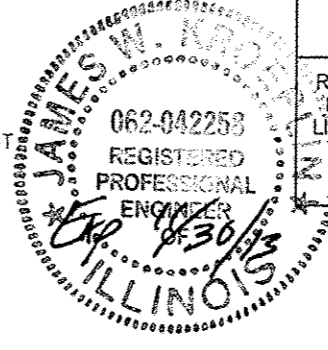

James W. Kroepf 3/27/13
JAMES W. KROEPF, P.E.
ILLINOIS REGISTERED PROFESSIONAL ENGINEER NO. 062-042258

REVISION #2 03/14/13

DATE	JAN. 18, 2013
PROJECT NO.	M0031-71-0102
SHEET NO.	1
TOTAL SHEETS	15



UTILITY LOCATIONS ARE PROVIDED FOR THE CONTRACTORS CONVENIENCE AND ARE BASED ON AVAILABLE INFORMATION. THE CONTRACTOR IS RESPONSIBLE FOR LOCATION AND PROTECTION OF UNDERGROUND UTILITIES. CONTACT J.U.L.I.E. 1-800-892-0123 FOR LOCATION OF UNDERGROUND UTILITIES.