

ROUTE NO.	SECTION	COUNTY	TOTAL SHEETS	SHEET NO.
CENTERVILLE ROAD	12-08120-00-BR	BOONE	26	1
ROAD DIST.	ILLINOIS	POPLAR GROVE		

CONTRACT NO. 85589



LOCATION OF SECTION INDICATED THIS: - [Black Box]

PASSED 3/28 2013  
*Wayne D. Ware*  
 ROAD DISTRICT COMMISSIONER

APPROVED 3/28 2013  
*[Signature]*  
 COUNTY ENGINEER

PASSED 4/15 2013  
*[Signature]*  
 DISTRICT 2 ENGINEER OF LOCAL ROADS & STREETS

RELEASED FOR BID BASED ON LIMITED REVIEW 4/15 2013  
*Paul A. Foster*  
 DEPUTY DIRECTOR OF HIGHWAYS, REGION 2 ENGINEER

STATE OF ILLINOIS  
 DEPARTMENT OF TRANSPORTATION

**INDEX OF SHEETS**

1. TITLE SHEET
2. GENERAL NOTES, UTILITY CONTACTS, AND SUMMARY OF QUANTITIES
3. ALIGNMENTS, TIES, BENCHMARKS, REMOVAL PLAN, AND TYPICAL SECTION
4. PLAN AND PROFILE
5. EROSION CONTROL PLAN
6. TRAFFIC CONTROL PLAN
- 7.-21 BRIDGE PLANS (INCLUDING BORING LOGS)
- 22-26 CROSS SECTIONS

**LIST OF STANDARDS**

- |           |  |
|-----------|--|
| 280001-07 | TEMPORARY EROSION CONTROL SYSTEMS  |
| 515001-03 | NAME PLATE FOR BRIDGES   |
| 631032-08 | TRAFFIC BARRIER TERMINAL, TYPE 6A  |
| 635006-03 | REFLECTOR AND TERMINAL MARKER PLACEMENT  |
| 635011-02 | REFLECTOR MARKER AND MOUNTING DETAILS  |
| 667101-02 | PERMANENT SURVEY MARKERS   |
| 701006-04 | OFF-RD OPERATIONS, 2L, 2W,<br>15' TO 24" FROM PAVEMENT EDGE  |
| 701301-04 | LANE CLOSURE, 2L, 2W, SHORT TIME OPERATIONS  |
| 701901-02 | TRAFFIC CONTROL DEVICES  |
| 720001-01 | SIGN PANEL MOUNTING DETAILS  |
| 720006-03 | SIGN PANEL ERECTION DETAILS  |
| 720011-01 | METAL POSTS FOR SIGNS, MARKERS & DELINEATORS   |
| 728001-01 | TELESCOPING STEEL SIGN SUPPORT   |
| 729001-01 | APPLICATIONS OF TYPES A & B METAL POSTS<br>(FOR SIGNS & MARKERS)   |
| 731001-01 | BASE FOR TELESCOPING STEEL SIGN SUPPORT  |
| BLR 21-9  | TYPICAL APPLICATION OF TRAFFIC CONTROL DEVICES FOR CONSTRUCTION ON RURAL LOCAL HIGHWAYS                          |
| BLR 22-7  | APPLICATION OF TRAFFIC CONTROL DEVICES FOR CONSTRUCTION ON RURAL LOCAL HIGHWAYS (TWO-LANE TWO WAY RURAL TRAFFIC) |

UTILITY NAME	TYPE	PHONE NUMBER
COMED/JOLIET DESIGN STAGE LOCATE LINE	ELECTRIC	630-576-7094
FRONTIER COMMUNICATIONS DARRELL SENIOR	TELEPHONE	309-827-1253

STATE OF ILLINOIS  
 DEPARTMENT OF TRANSPORTATION  
 DIVISION OF HIGHWAYS  
**PLANS FOR PROPOSED  
 SURFACE TRANSPORTATION  
 PROGRAM – BRIDGE**  
 SECTION 12-08120-00-BR  
 BOONE COUNTY  
 T.R. 33 (CENTERVILLE ROAD)  
 POPLAR GROVE ROAD DISTRICT  
 PROJECT NO. BROS-0007(050)  
 C-92-065-13  
**CONTRACT NO. 85589**

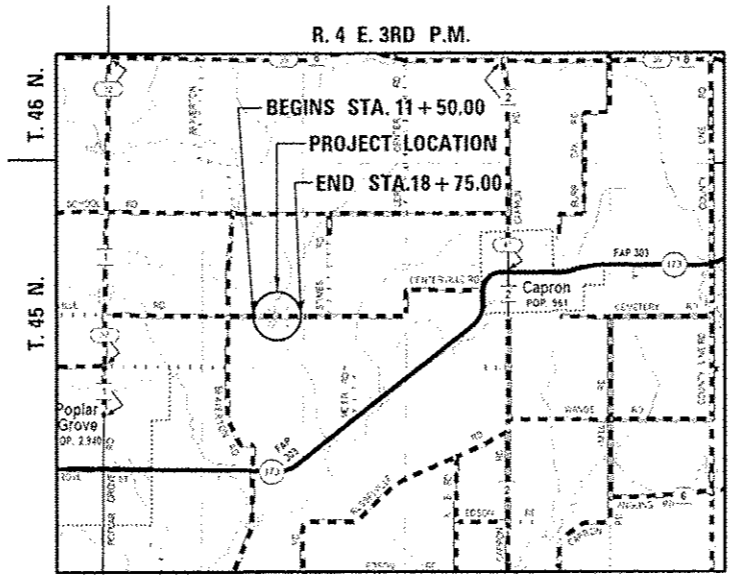

**LOCATION PLAN**

GROSS LENGTH OF SECTION = 725.00 FEET = 0.137 MILES  
 NET LENGTH OF SECTION = 725.00 FEET = 0.137 MILES

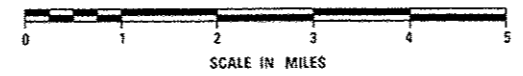

**PROPOSED IMPROVEMENTS:**

STA. 15+12.75 SPECIAL BRIDGE DESIGN  
 THREE-SPAN P.P.C. DECK BEAM BRIDGE  
 (21" DEPTH) 32'-0", 54'-0", 32'-0",  
 119'-9" BK.-BK. ABUTMENTS  
 30'-0" RDWY. WIDTH  
 0° SKEW  
 EXISTING S.N. 004-3030  
 PROPOSED S.N. 004-3096

**TRAFFIC DATA**

CLASSIFICATION: LOCAL ROAD (NON-URBAN)  
 DESIGN VOLUME: 400-750 ADT; 1% TRUCKS  
 CURRENT ADT: 468 (2013)  
 DESIGN SPEED: 50 M.P.H.



*Gary J. Cartwright* 3-27-13  
 ILLINOIS PROFESSIONAL NO. 43408  
 EXPIRES 11-30-13

**NOTE**

THE FINAL STRUCTURAL PLANS AND SPECIFICATIONS FOR THIS PROJECT ARE ACCEPTED BASED UPON THE STRUCTURAL ENGINEER'S SEAL, CERTIFICATION AND SIGNATURE.

4440 ASH GROVE  
 SPRINGFIELD, IL 62711  
 (217) 793 8600  
 www.fehr-graham.com

**FEHR GRAHAM**  
 ENGINEERING & ENVIRONMENTAL

TOLL FREE JOINT UTILITY LOCATING INFORMATION FOR EXCAVATORS (J.U.L.I.E.)  
 TELEPHONE NUMBER 1-800-892-0123 OR 811

**UTILITY NOTE**

THE LOCATIONS OF THOSE BURIED AND ABOVEGROUND UTILITIES SHOWN ARE APPROXIMATE, ARE SHOWN FOR CONTRACTOR INFORMATIONAL USE ONLY, AND ARE NOT TO BE REFERENCED FOR CONSTRUCTION PURPOSES. THE IMPLIED PRESENCE OR ABSENCE OF UTILITIES IS NOT TO BE CONSTRUED BY THE OWNER, ENGINEER, CONTRACTOR, OR SUBCONTRACTORS TO BE AN ACCURATE AND COMPLETE REPRESENTATION OF UTILITIES THAT MAY OR MAY NOT EXIST ON THE CONSTRUCTION SITE. BURIED AND ABOVEGROUND UTILITY LOCATION, IDENTIFICATION, AND MARKING ARE THE SOLE RESPONSIBILITY OF THE CONTRACTOR. REROUTING, DISCONNECTION, PROTECTION, ETC. OF ANY UTILITIES MUST BE COORDINATED AMONG THE CONTRACTOR, UTILITY COMPANY, AND OWNER. SITE SAFETY, INCLUDING THE AVOIDANCE OF HAZARDS, ASSOCIATED WITH BURIED AND ABOVEGROUND UTILITIES REMAIN THE SOLE RESPONSIBILITY OF THE CONTRACTOR.