

FAS ROUTE NO.	SEC	COUNTY	TOTAL SHEETS	SHEET NO.
-	*	STEPHENSON	16	7

ILLINOIS PROJECT BROS-0177(044)

* 12-08122-00-BR
CONTRACT NO. 85590

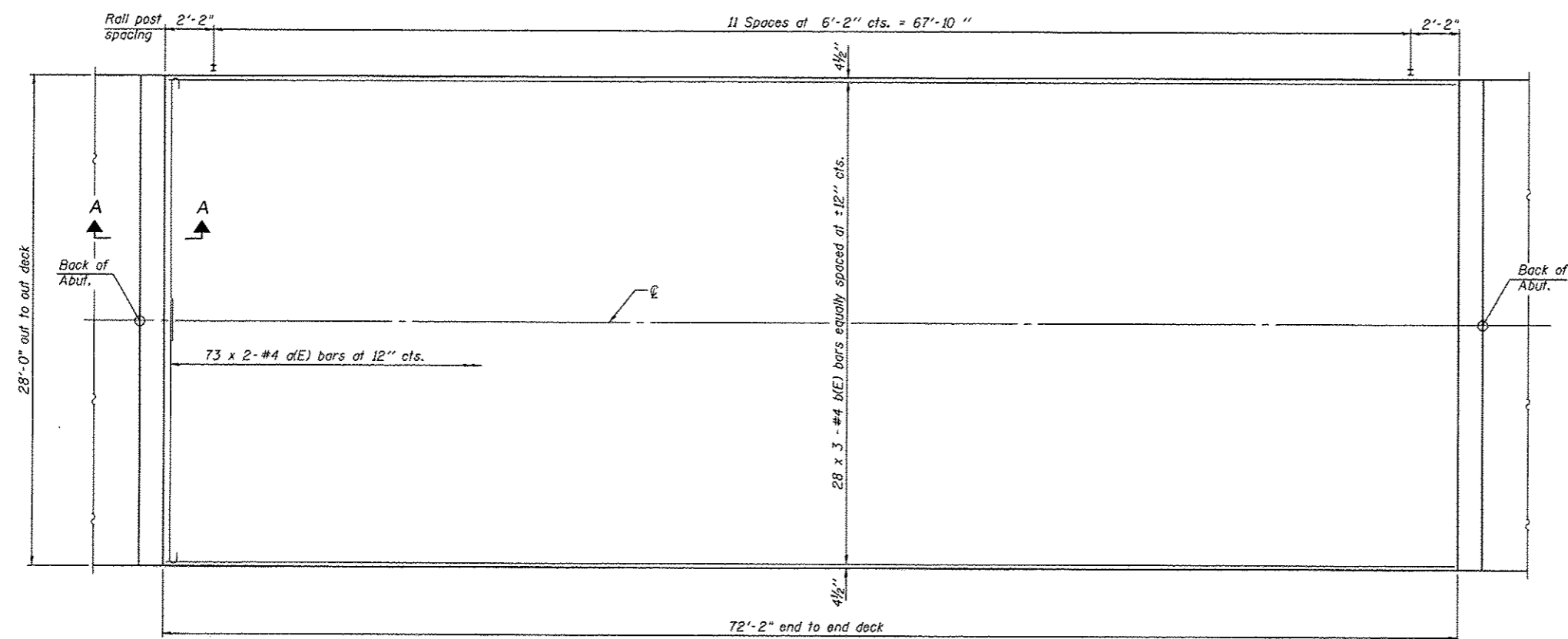
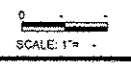

PLAN

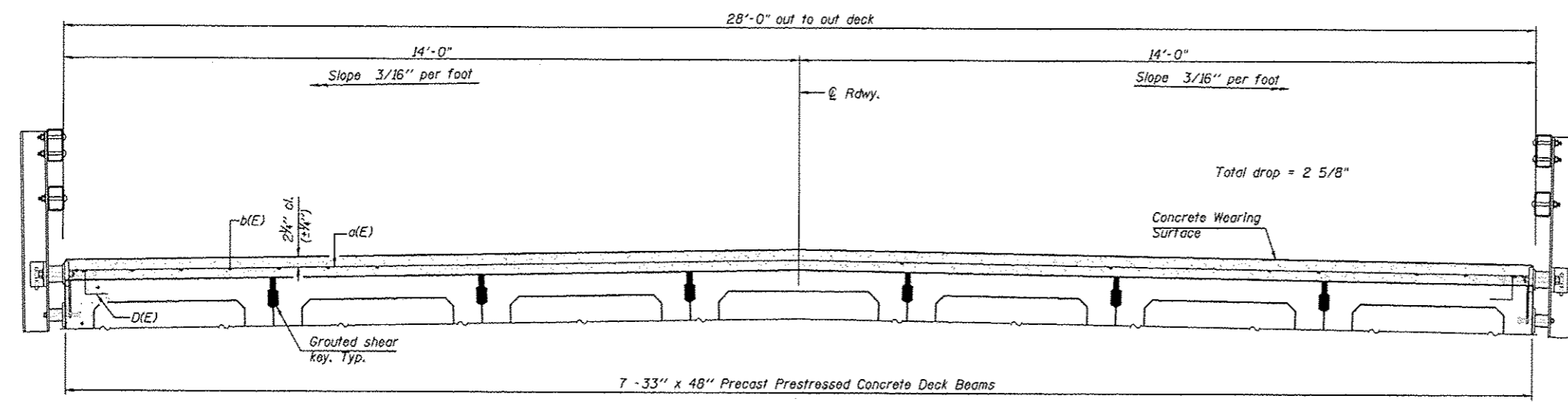

CROSS SECTION
(Looking EAST)

SECTION A-A

Notes:
All concrete wearing surfaces shall be placed prior to casting a backwall and/or approach slab.
See sheet 8 of 16 for fabric bearing pad details.

NO.	DATE	REVISIONS

DESIGNED BY	CHECKED BY	DATE

wendler
GROUND-BREAKING SOLUTIONS
engineers - surveyors - scientists
www.wendlergs.com ph: 615.288.2261
Illinois Professional Design Firm No. 184-009848

SUPERSTRUCTURE DETAILS
OF
WEST DAMEIER ROAD BRIDGE
FOR
STEPHENSON COUNTY

SHEET TITLE
DETAILS

JOB NUMBER
2120191

DATE
4/01/2013

SHEET NO.
7 of 16

PDS-S-R34-0 7-1-10

Notes:
See sheet 8 of 16 for Superstructure Details and Bill of Material.
Bars indicated thus 20 x 2-#4 etc. indicates 20 lines of bars with 2 lengths per line.

MINIMUM BAR LAP
#4 bar = 2'-0"

S.N. 089-3287
33" X 48" PPC DECK BEAMS
CONCRETE OVERLAY DETAILS
SECTION 12-08122-00-BR
STEPHENSON COUNTY