

ROUTE	SECTION	COUNTY	TOTAL SHEETS	SHEET NO.
TR 88A	10-01197-00-BR	UNION	12	2
PROJECT NO. BROS-0181(055)			CONTRACT NO. 99480	

B.M. - Dbl. Nails in Telephone Pole  
 20' Lt. Sta. 15+25  
 Elev. 455.00

**CURVE DATA - PI STA=13+43.95**  
 $\Delta = 16^{\circ}01'13''$   $T = 43.94'$   
 $D = 18^{\circ}20'58''$   $L = 87.31'$   
 $R = 312.25'$   $E = 3.08'$

**CURVE DATA - PI STA=16+25.42**  
 $\Delta = 17^{\circ}10'09''$   $T = 72.30'$   
 $D = 11^{\circ}57'46''$   $L = 143.52'$   
 $R = 478.95'$   $E = 5.43'$

Existing Structure - Timber deck with steel stringers on one timber and one concrete closed abutment. 14.8' Wide x 27.3' Long

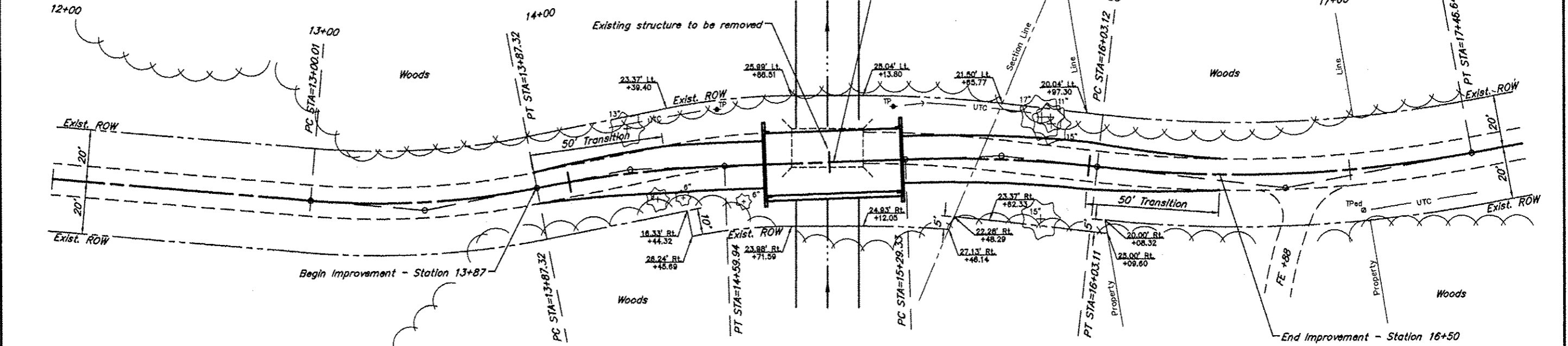

**Tree Removal**

Sta.	Offset	Unit Dia.
14+24	17' Lt.	13
14+33	11' Rt.	9
14+43	11' Rt.	6
14+67	14' Rt.	6
15+81	17' Lt.	17
15+84	17' Lt.	11
15+84	15' Lt.	15

Note: All trees listed are stumps.

SCALES:  
 1" = 40' HOR  
 1" = 20' VER

**CURVE DATA - PI STA=14+23.71**  
 $\Delta = 9^{\circ}08'42''$   $T = 36.39'$   
 $D = 12^{\circ}35'33''$   $L = 72.62'$   
 $R = 455.00'$   $E = 1.45'$

**CURVE DATA - PI STA=15+66.29**  
 $\Delta = 8^{\circ}27'20''$   $T = 36.96'$   
 $D = 11^{\circ}27'33''$   $L = 73.79'$   
 $R = 500.00'$   $E = 1.36'$

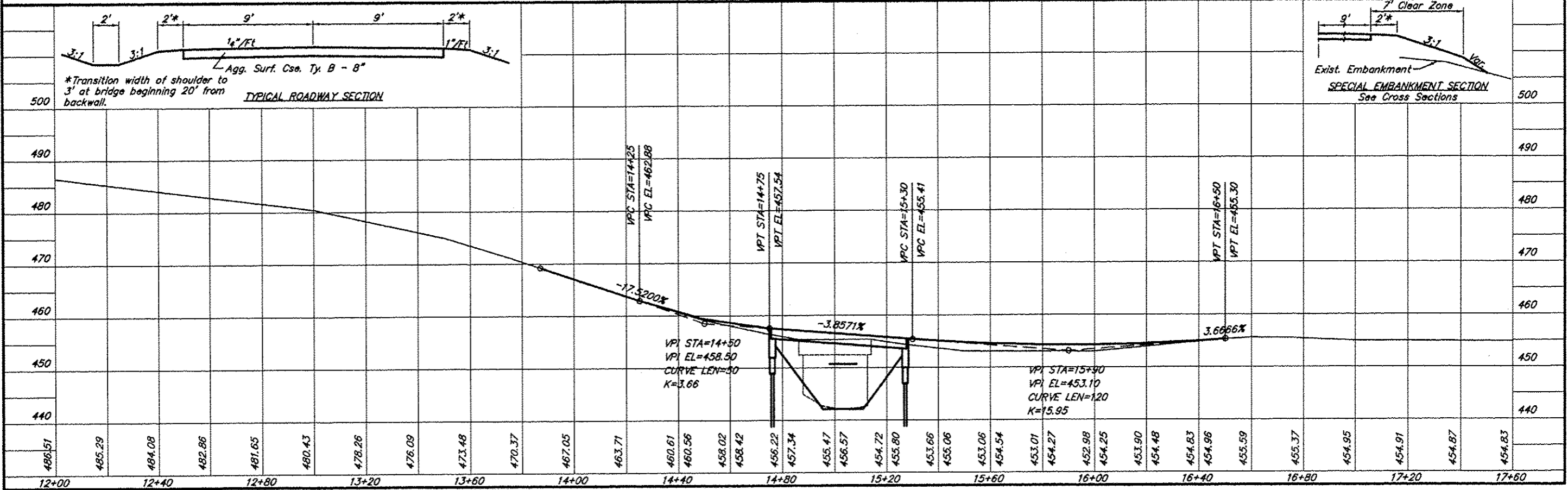

**TYPICAL ROADWAY SECTION**  
 \*Transition width of shoulder to 3' at bridge beginning 20' from backwall.  
 Agg. Surf. Cse. Ty. B - 8"

**SPECIAL EMBANKMENT SECTION**  
 See Cross Sections

VPI STA=14+50  
 VPI EL=458.90  
 CURVE LEN=50  
 K=3.66

VPI STA=15+90  
 VPI EL=453.10  
 CURVE LEN=120  
 K=15.95

486.51	485.29	484.08	482.86	481.65	480.43	478.26	476.09	473.48	470.37	467.05	463.71	460.61	458.02	458.42	456.22	457.34	455.47	456.57	454.72	455.80	453.66	455.06	453.06	454.54	453.01	454.27	452.98	454.25	453.90	454.48	454.83	454.96	455.59	455.37	454.95	454.91	454.87	454.83
12+00	12+40	12+80	13+20	13+60	14+00	14+40	14+80	15+20	15+60	16+00	16+40	16+80	17+20	17+60																								