

STATE OF ILLINOIS
DEPARTMENT OF TRANSPORTATION
PLANS FOR PROPOSED
HIGHWAY BRIDGE PROGRAM

TOWNSHIP ROUTE 164 (BUTLER ROAD)
HARRISBURG TOWNSHIP
SECTION 10-06119-00-BR
PROJECT NO. BROS-165(36)
JOB NO. C-99-522-11
BRIER CREEK

SALINE COUNTY

ROUTE	SECTION	COUNTY	TOTAL SHEETS	SHEET NO.
TR 164	10-06119-00-BR	SALINE	13	1
PROJECT NO. BROS-165(36)			CONTRACT NO. 99489	

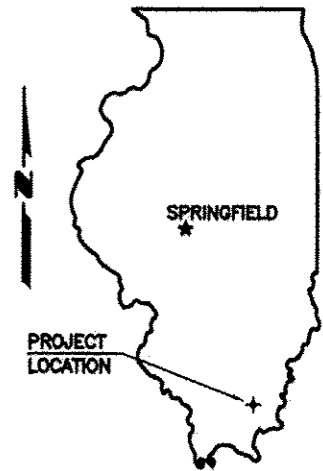

INDEX OF SHEETS

1. COVER SHEET
 2. PLAN AND PROFILE
 3. GENERAL PLAN AND ELEVATION
 4. 17" X 36" PPC DECK BEAM
 5. 17" X 36" PPC DECK BEAM DETAILS
 6. 17" X 48" PPC DECK BEAM
 7. 17" X 48" PPC DECK BEAM DETAILS
 8. ABUTMENT
 9. STEEL RAILING, TYPE S1
 10. NAME PLATES
 11. PILING DETAILS
 12. ROAD CROSS SECTIONS
 13. CHANNEL CROSS SECTIONS
- STANDARDS 000001-06 STANDARD SYMBOLS, ABBREVIATIONS AND PATTERNS
280001-07 TEMPORARY EROSION CONTROL SYSTEMS
635006-03 REFLECTOR AND TERMINAL MARKER PLACEMENT
701901-02 TRAFFIC CONTROL DEVICES
BLR 21-9 TYPICAL APPLICATION OF TRAFFIC CONTROL DEVICES

CODE NO.	PAY ITEM	UNIT	TOTAL
* X2501000	SEEDING, CLASS 2 (SPECIAL)	ACRE	0.1
20100110	TREE REMOVAL (6 TO 15 UNITS DIAMETER)	UNIT	32
20200100	EARTH EXCAVATION	CU YD	70
* 20300100	CHANNEL EXCAVATION	CU YD	57
* 28100809	STONE DUMPED RIPRAP, CLASS A5	TON	125
* 40200800	AGGREGATE SURFACE COURSE, TYPE B	TON	117
* 50100100	REMOVAL OF EXISTING STRUCTURES	EACH	1
50200100	STRUCTURE EXCAVATION	CU YD	36
50300225	CONCRETE STRUCTURES	CU YD	21.8
50300280	CONCRETE ENCASEMENT	CU YD	2.7
50400305	PRECAST PRESTRESSED CONCRETE DECK BEAMS (17" DEPTH)	SQ FT	720
50800105	REINFORCEMENT BARS	POUND	2640
Δ 50900205	STEEL RAILING, TYPE S1	FOOT	62
51201400	FURNISHING STEEL PILES HP10X42	FOOT	160
51202305	DRIVING PILES	FOOT	160
51500100	NAME PLATES	EACH	1
67100100	MOBILIZATION	L SUM	1
Δ 78201000	TERMINAL MARKER - DIRECT APPLIED	EACH	4

* SEE SPECIAL PROVISIONS Δ SPECIALTY ITEMS

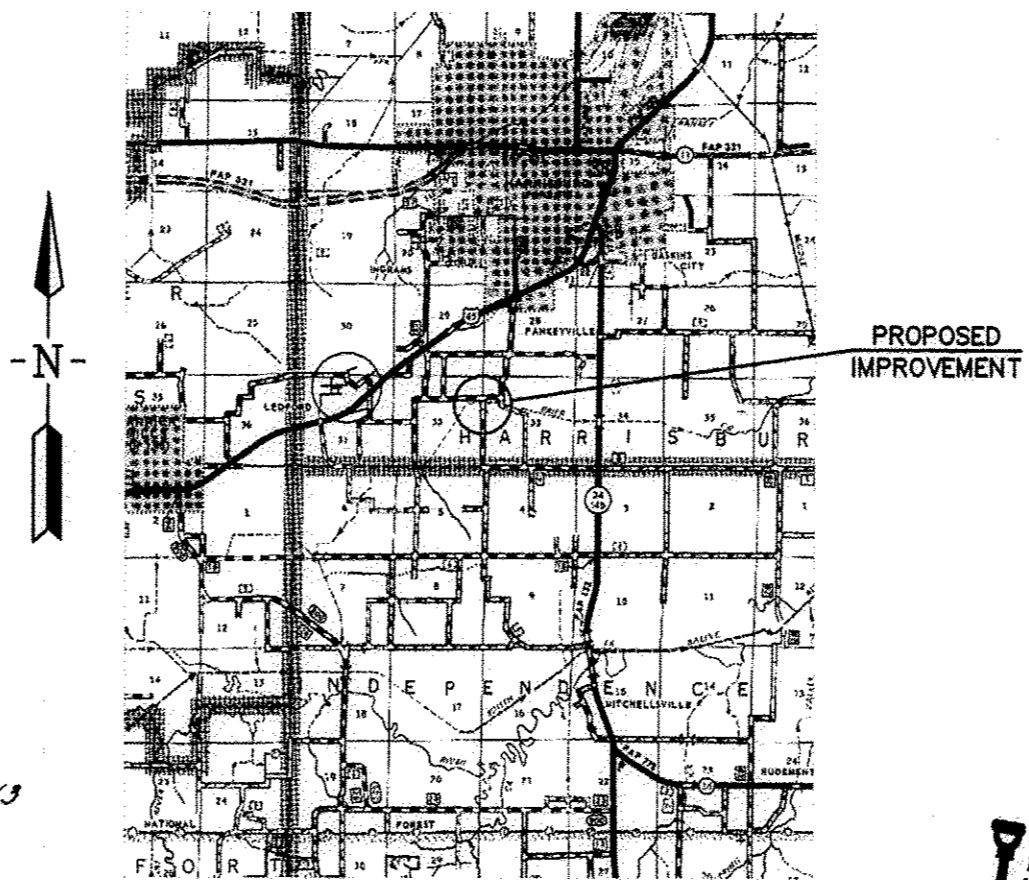

LOCATION MAP

SCALE: 1" = 2 MILES

NET LENGTH OF IMPROVEMENT = 117.86 FT. = 0.0223 MILES

CLASSIFICATION : LOCAL ROAD (RURAL)
ADT : 250
DESIGN SPEED : 30 MPH

CONTRACT NO. 99489



3-25-13

E. MILLER ENGINEERING, INC.
CONSULTING ENGINEERS
HARRISBURG, ILLINOIS

Edward W. Miller
Edward W. Miller
PROFESSIONAL ENGINEER
#062-025277
EXPIRES NOV. 30, 2013



ILLINOIS DEPARTMENT OF TRANSPORTATION	
Approved	<u>3-27-13</u> <i>Bob Smith</i> Harrisburg Township Road Commissioner
Approved	<u>03-27-13</u> <i>[Signature]</i> Saline County Engineer
Passed	<u>4/11/13</u> <i>Deni W. Hill</i> District 9 Engineer of Local Roads and Streets
Releasing for Bid Based on Limited Review	<u>4/11/13</u> <i>Jeffrey L. Kevin</i> Deputy Director of Highways, Region 5 Engineer Illinois Department of Transportation