

REVISION	DATE

LITCHFIELD MUNICIPAL AIRPORT
LITCHFIELD, ILLINOIS

IL PROJ.: 31F-4194 BLOCK GRANT PROJ.: 3-17-0063-B19

Hanson Proj. No. 12A0062D	Filename: E-142-6-ELEC.dwg
Scale 1" = 20'	Date 01/11/13
LAYOUT	CAH 06/11/12
DRAWN	BAK 06/11/12
REVIEWED	CAH/KNL 01/10/13

HANSON
Professional Services Inc. 2013
Hanson Professional Services Inc.
1525 South Sixth Street
Springfield, Illinois 62703-2986
Ph: (217) 788-2450 Fax: (217) 788-2503
www.hanson-inc.com
Offices Nationwide

REALIGN TAXIWAY "A"
PROPOSED CABLE LAYOUT FOR WIND CONE

THE LOCATION, SIZE, AND TYPE OF MATERIAL OF EXISTING UNDERGROUND AND/OR ABOVEGROUND UTILITIES INDICATED ON THE PLANS ARE NOT REPRESENTED AS BEING ACCURATE, SUFFICIENT OR COMPLETE. NEITHER THE OWNER NOR THE ENGINEER ASSUMES ANY RESPONSIBILITY WHATEVER IN RESPECT TO THE ACCURACY, COMPLETENESS, OR SUFFICIENCY OF THE INFORMATION. THERE IS NO GUARANTEE, EITHER EXPRESSED OR IMPLIED, THAT THE LOCATIONS, SIZE AND TYPE OF MATERIAL OF EXISTING UNDERGROUND UTILITIES INDICATED ARE REPRESENTATIVE OF THOSE TO BE ENCOUNTERED IN THE CONSTRUCTION. IT SHALL BE THE CONTRACTOR'S RESPONSIBILITY TO DETERMINE THE ACTUAL LOCATION OF ALL SUCH FACILITIES, INCLUDING SERVICE CONNECTIONS TO UNDERGROUND UTILITIES. PRIOR TO CONSTRUCTION, THE CONTRACTOR SHALL NOTIFY THE UTILITY COMPANIES OF HIS OPERATIONAL PLANS AND SHALL OBTAIN FROM THE RESPECTIVE UTILITY COMPANIES DETAILED INFORMATION AND ASSISTANCE RELATIVE TO THE LOCATION OF THEIR FACILITIES AND THE WORKING SCHEDULE OF THE COMPANIES FOR REMOVAL OR ADJUSTMENT WHERE REQUIRED. IN THE EVENT AN UNEXPECTED UTILITY INTERFERENCE IS ENCOUNTERED DURING CONSTRUCTION, THE CONTRACTOR SHALL IMMEDIATELY NOTIFY THE UTILITY COMPANY OF JURISDICTION. THE OWNER'S REPRESENTATIVE AND/OR THE RESIDENT ENGINEER SHALL ALSO BE IMMEDIATELY NOTIFIED. ANY DAMAGE TO SUCH MAINS AND SERVICES SHALL BE RESTORED TO SERVICE AT ONCE AND PAID FOR BY THE CONTRACTOR AT NO ADDITIONAL COST TO THE CONTRACT.

ALL UTILITY CABLES AND LINES SHALL BE LOCATED BY THE RESPECTIVE UTILITY. CONTACT JULIE (JOINT UTILITY LOCATION INFORMATION FOR EXCAVATORS) FOR UTILITY INFORMATION, PHONE: 1-800-892-0123. CONTACT THE FAA (FEDERAL AVIATION ADMINISTRATION) FOR ASSISTANCE IN LOCATING FAA CABLES AND UTILITIES. LOCATION OF FAA POWER, CONTROL, AND COMMUNICATION CABLES SHALL BE COORDINATED WITH AND/OR LOCATED BY THE FAA. ALSO CONTACT AIRPORT DIRECTOR/MANAGER AND AIRPORT PERSONNEL FOR ASSISTANCE IN LOCATING UNDERGROUND AIRPORT CABLES AND/OR UTILITIES. ALSO COORDINATE WORK WITH ALL ABOVEGROUND UTILITIES.

NOTE TO CONTRACTOR:

ONLY THE EXISTING AND PROPOSED ELECTRICAL CABLES (FOR THE PRIMARY LIGHTED WIND TEE) IDENTIFIED ON THIS SHEET HAVE BEEN SHOWN FOR CLARITY. ALL OTHER EXISTING AND PROPOSED ELECTRICAL CABLES HAVE NOT BEEN SHOWN. WHILE INSTALLING THESE CABLES THE CONTRACTOR SHALL BE AWARE THAT THE OTHER EXISTING AND PROPOSED ELECTRICAL CABLES, EVEN THOUGH NOT SHOWN, ARE STILL PRESENT. WHEN IN DOUBT THE CONTRACTOR SHOULD REFER TO THE OTHER PROPOSED CABLE LAYOUT SHEETS TO DETERMINE LOCATION OF OTHER EXISTING AND PROPOSED CABLES.

THE CONTRACTOR WILL KEEP THE EXISTING WIND TEE LIGHTING CIRCUIT ACTIVE UNTIL HE HAS REPLACED THE EXISTING WIND CONE LIGHTING CIRCUIT CABLES. THE CONTRACTOR WILL THEN BE PERMITTED TO REPLACE THE EXISTING WIND TEE LIGHTING CABLES.

- LEGEND**
- EXISTING PAVEMENT
 - PROPOSED IMPROVEMENTS
 - EXISTING ELECTRICAL DUCT
 - PROPOSED ELECTRICAL DUCT
 - EXISTING ELECTRICAL CABLES
 - PROPOSED 1/C #8 AWG, FAA L-824, 5000 V TYPE C UNDERGROUND CABLE IN UNIT DUCT
 - PROPOSED 2-1/C #4 AWG, XLP-USE 600 V UNDERGROUND CABLE IN UNIT DUCT
 - PROPOSED 3-1/C #6 AWG, XLP-USE 600 V UNDERGROUND CABLE IN UNIT DUCT
 - PROPOSED 3-1/C #8 AWG, XLP-USE 600 V UNDERGROUND CABLE IN UNIT DUCT
 - EXISTING UNDERDRAIN
 - EXISTING STORM SEWER
 - PROPOSED STORM SEWER
 - RELOCATED STAKE MOUNTED TAXIWAY LIGHT
 - RELOCATED BASE MOUNTED TAXIWAY LIGHT
 - PROPOSED ELECTRICAL HANDHOLE, MANHOLE
 - EXISTING STAKE MOUNTED RUNWAY THRESHOLD LIGHT
 - RELOCATED TAXI GUIDANCE SIGN
 - PROPOSED INLET
 - PROPOSED END SECTION

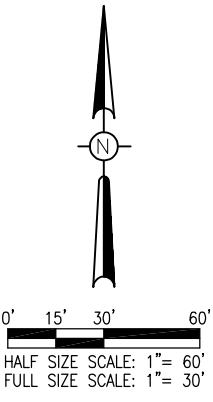
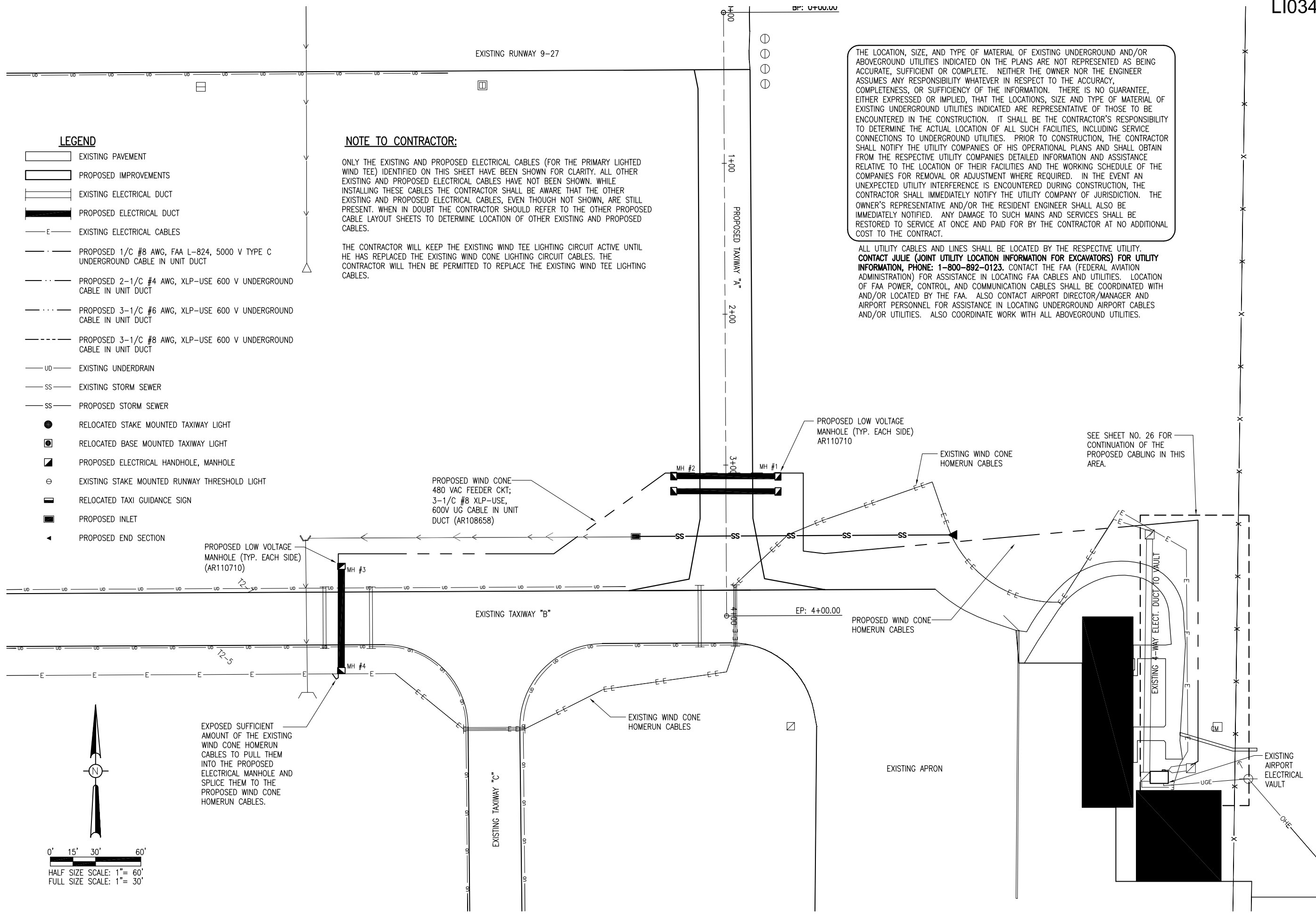

FEB 05, 2013 4:16 PM HAGL000382
pw:\sps-sv306\hanson\dom\hanson\Projects\Documents\12A0062D\CAD\litchfield\litchfield\12A0062D\CAD\litchfield\12A0062D\12A0062D.dwg