

UTILITY NOTE

THE LOCATION, SIZE, AND TYPE OF MATERIAL OF EXISTING UNDERGROUND AND/OR ABOVEGROUND UTILITIES INDICATED ON THE PLANS ARE NOT REPRESENTED AS BEING ACCURATE, SUFFICIENT OR COMPLETE. NEITHER THE OWNER NOR THE ENGINEER ASSUMES ANY RESPONSIBILITY WHATSOEVER IN RESPECT TO THE ACCURACY, COMPLETENESS, OR SUFFICIENCY OF THE INFORMATION. THERE IS NO GUARANTEE, EITHER EXPRESSED OR IMPLIED, THAT THE LOCATIONS, SIZE AND TYPE OF MATERIAL OF EXISTING UNDERGROUND UTILITIES INDICATED ARE REPRESENTATIVE OF THOSE TO BE ENCOUNTERED IN THE CONSTRUCTION. IT SHALL BE THE CONTRACTOR'S RESPONSIBILITY TO DETERMINE THE ACTUAL LOCATION OF ALL SUCH FACILITIES, INCLUDING SERVICE CONNECTIONS TO UNDERGROUND UTILITIES. PRIOR TO CONSTRUCTION, THE CONTRACTOR SHALL NOTIFY THE UTILITY COMPANIES OF HIS OPERATIONAL PLANS AND SHALL OBTAIN FROM THE RESPECTIVE UTILITY COMPANIES DETAILED INFORMATION AND ASSISTANCE RELATIVE TO THE LOCATION OF THEIR FACILITIES AND THE WORKING SCHEDULE OF THE COMPANIES FOR REMOVAL OR ADJUSTMENT WHERE REQUIRED. IN THE EVENT AN UNEXPECTED UTILITY INTERFERENCE IS ENCOUNTERED DURING CONSTRUCTION, THE CONTRACTOR SHALL IMMEDIATELY NOTIFY THE UTILITY COMPANY OF JURISDICTION. THE OWNER'S REPRESENTATIVE AND/OR THE RESIDENT ENGINEER SHALL ALSO BE IMMEDIATELY NOTIFIED. ANY DAMAGE TO SUCH MAINS AND SERVICES SHALL BE RESTORED TO SERVICE AT ONCE AND PAID FOR BY THE CONTRACTOR AT NO ADDITIONAL COST TO THE CONTRACT. ALL UTILITY CABLES AND LINES SHALL BE LOCATED BY THE RESPECTIVE UTILITY. **CONTACT JULIE (JOINT UTILITY LOCATION INFORMATION FOR EXCAVATORS) FOR UTILITY INFORMATION, PHONE: 1-800-892-0123.** CONTACT THE FAA (FEDERAL AVIATION ADMINISTRATION) FOR ASSISTANCE IN LOCATING FAA CABLES AND UTILITIES. LOCATION OF FAA POWER, CONTROL, AND COMMUNICATION CABLES SHALL BE COORDINATED WITH AND/OR LOCATED BY THE FAA. ALSO CONTACT AIRPORT DIRECTOR/MANAGER AND AIRPORT PERSONNEL FOR ASSISTANCE IN LOCATING UNDERGROUND AIRPORT CABLES AND/OR UTILITIES. ALSO COORDINATE WORK WITH ALL ABOVEGROUND UTILITIES.

J.U.L.I.E. INFORMATION

COUNTY _____ ST. CLAIR
 CITY _____ CAHOKIA
 TOWNSHIP _____ CENTERVILLE
 SECTION NO. _____ T.1N. - R.10W.
 ADDRESS _____ ST. LOUIS DOWNTOWN AIRPORT
 6100 ARCHVIEW DRIVE
 CAHOKIA, IL 62206-1445

LEGEND

- EXISTING IMPROVEMENTS
- EXISTING BUILDINGS
- PROPOSED IMPROVEMENTS
- PROPOSED CONTRACTOR STAGING AREA
- EXISTING FENCE
- AIRPORT PROPERTY LINE

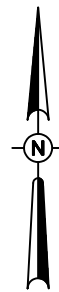

0' 250' 500' 1000'
 HALF SIZE SCALE: 1" = 1000'
 FULL SIZE SCALE: 1" = 500'

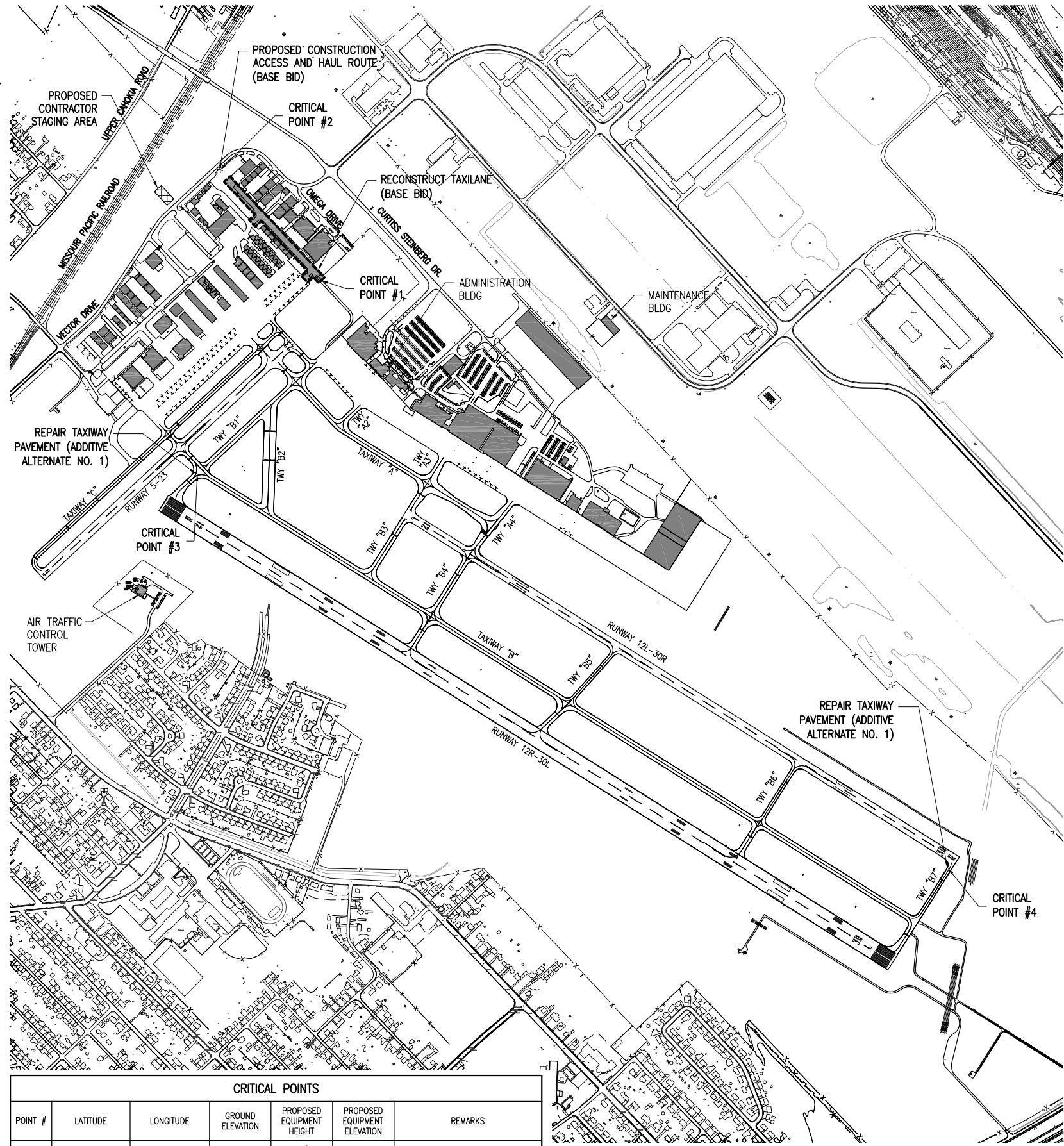

CRITICAL POINTS						
POINT #	LATITUDE	LONGITUDE	GROUND ELEVATION	PROPOSED EQUIPMENT HEIGHT	PROPOSED EQUIPMENT ELEVATION	REMARKS
1	N 38° 34' 44.30"	W 90° 09' 38.22"	407.2	25'	432.2	---
2	N 38° 34' 53.10"	W 90° 09' 48.50"	408.7	25'	433.7	---
3	N 38° 34' 28.77"	W 90° 09' 50.78"	411.5	25'	436.5	ADDITIVE ALTERNATE 1
4	N 38° 33' 57.10"	W 90° 08' 34.05"	405.0	25'	430.0	ADDITIVE ALTERNATE 1

GENERAL NOTES

SD056

- THE SCOPE OF WORK SHEET IS INTENDED ONLY AS A GENERAL DESCRIPTION OF WORK ITEMS AND THEIR APPROXIMATE LOCATIONS AND LIMITS, FOR THE PURPOSE OF UNDERSTANDING THE SCOPE OF THE PROJECT. THIS SHEET SHALL NOT BE USED AS A CONSTRUCTION PLAN. REFER TO THE FOLLOWING PLAN SHEETS FOR DETAILED CONSTRUCTION REQUIREMENTS, LOCATIONS, AND ITEMS OF WORK.
- WORK FOR THIS PROJECT (BASE BID) SHALL CONSIST OF, BUT IS NOT LIMITED TO, RECONSTRUCTION OF AN ACCESS TAXILANE, INCLUDING PAVEMENT REMOVAL, AGGREGATE BASE COURSE, BITUMINOUS PAVING, CONCRETE PAVING, PAVEMENT MARKING AND OTHER ASSOCIATED ITEMS. AN ADDITIVE ALTERNATE BID CONSISTS OF TAXIWAY PAVEMENT REPAIRS, INCLUDING PAVEMENT REMOVAL AND CONCRETE PAVING.
- THE CONTRACTOR SHALL FURNISH ALL LABOR, MATERIAL, EQUIPMENT, AND TRANSPORTATION NECESSARY TO CONSTRUCT ALL ELEMENTS OF THE PROJECT AS DESCRIBED IN THE CONSTRUCTION PLANS AND SPECIFICATIONS.
- THE RULES, REGULATIONS, AND SPECIFICATIONS ENUMERATED HEREIN SHALL BE CONSIDERED AS MINIMUM REQUIREMENTS. THEY SHALL NOT PROHIBIT THE CONTRACTOR FROM FURNISHING AND INSTALLING HIGHER GRADES OF MATERIAL THAN ARE SPECIFIED HEREIN.
- THE CONTRACTOR IS NOT PERMITTED TO USE THE AIRPORT ENTRANCE DRIVE AND AUTO PARKING LOT FOR MATERIAL AND EQUIPMENT HAULING OR STORAGE. THE CONSTRUCTION ENTRANCE AS SHOWN ON THE SCOPE OF WORK AND/OR SAFETY PHASING PLAN ARE ONLY TO BE USED FOR THE PROJECT. ACCESS TO THE PROJECT FOR ALL HAULING OF MATERIALS AND EQUIPMENT SHALL BE RESTRICTED TO THE DESIGNATED CONSTRUCTION ENTRANCE.
- IT SHALL BE THE RESPONSIBILITY OF THE CONTRACTOR TO PROTECT, PRESERVE AND REPAIR THE EXISTING AIRFIELD AND ROADWAY PAVEMENTS AT ALL TIMES. THE CONTRACTOR SHALL REPAIR ANY DAMAGE TO EXISTING ELECTRICAL, DRAINAGE, AND PAVEMENT STRUCTURES AT NO ADDITIONAL COST TO THE CONTRACT.
- NO EQUIPMENT SHALL BE PERMITTED TO CROSS OR USE ANY EXISTING PAVEMENT OUTSIDE THE CONSTRUCTION LIMITS, GENERAL PROJECT AREA OR HAUL ROUTE.
- CONTRACTOR IS REQUIRED TO PROVIDE THEIR OWN RESTROOM FACILITIES.
- UNLESS OTHERWISE NOTED, ALL DISTURBED AREAS OUTSIDE OF THE PROPOSED CONSTRUCTION LIMITS SHALL BE GRADED, SEEDED AND/OR HYDROMULCH SEEDED AT NO ADDITIONAL COST TO THE CONTRACT.
- ALL WASTE MATERIAL SHALL BE HAULED FROM THE AIRPORT AND PROPERLY DISPOSED OF UNLESS OTHERWISE SPECIFIED HEREIN.
- THE CONTRACTOR SHALL BE RESPONSIBLE FOR OBTAINING PERMITS FOR HAULING ON PUBLIC ROADS, AS APPLICABLE. THE CONTRACTOR SHALL BE RESPONSIBLE FOR CORRECTING ANY DAMAGES TO ANY PAVEMENTS (PUBLIC OR PRIVATE) CAUSED BY HIS/HER CONSTRUCTION EQUIPMENT OR PERSONNEL.
- THE OWNER SHALL HAVE THE RIGHT OF FIRST REFUSAL FOR ALL SALVAGEABLE MATERIAL REMOVED ON THE PROJECT.
- THE CONTRACTOR SHALL PROVIDE ONE SET OF REDLINED AS-BUILT DRAWINGS TO THE RESIDENT ENGINEER AT THE COMPLETION OF THE PROJECT.
- CONTRACTOR SHALL NOTE THAT ALL AREAS WITHIN THE AIRPORT PROPERTY LINE AND OUTSIDE THE CONSTRUCTION LIMITS MAY BE USED FOR AGRICULTURAL PURPOSES. THE CONSTRUCTION LIMITS SHALL BE RESTRICTED TO AREAS THAT ARE ABSOLUTELY NECESSARY TO DISTURB TO COMPLETE THE REQUIRED WORK ITEMS. LIMITS SHALL BE COORDINATED WITH THE RESIDENT ENGINEER PRIOR TO BEGINNING ANY WORK. ALL AREAS WHICH HAVE BEEN FARMED AND OR DESIGNATED TO BE FARMED AFTER THE PROJECT COMPLETION, AND HAVE BEEN DISTURBED BY CONSTRUCTION ACTIVITY, SHALL BE CHISEL PLOWED (36" MAX.) OR OTHERWISE SCARIFIED TO RETURN THE AREA TO A REASONABLE TILLABLE CONDITION (IF SO PERMITTED BY THE AIRPORT MANAGER.)
- CONTRACTOR SHALL RESTORE TO ORIGINAL CONDITION ALL GRASS, STONE, OR PAVEMENT DISTURBED BY CONTRACTOR'S CONSTRUCTION OPERATIONS, STAGING, AND CONSTRUCTION ACCESS ROUTES. DISTURBED AREAS TO BE REPAIRED, GRADED, AND MULCHED SEEDED UNLESS OTHERWISE NOTED. STAGING AREA AND SITE ACCESS RESTORATION SHALL BE INCLUDED IN THE COST OF THE HAUL ROUTE.
- THE PROJECT PAY ITEMS ARE INTENDED TO BE INCLUSIVE OF ALL WORK TO BE PERFORMED AS SHOWN IN THESE PLANS. ALL INCIDENTAL WORK REQUIRED TO COMPLETE THE PROJECT TO THE SATISFACTION OF THE RESIDENT ENGINEER IS TO BE INCLUDED IN THE COSTS OF PERFORMING THESE ITEMS.
- APPROXIMATE LOCATIONS OF UNDERGROUND UTILITIES ARE SHOWN THROUGHOUT THESE PLANS. THE CONTRACTOR SHALL DETERMINE EXACT LOCATIONS AND PROTECT THESE UTILITIES DURING CONSTRUCTION. ANY UTILITIES DAMAGED DURING CONSTRUCTION SHALL BE REPAIRED AT THE CONTRACTOR'S EXPENSE. CONTRACTOR SHALL COORDINATE WITH THE PROPER PERSONS FOR THE PURPOSE OF LOCATING AND PROTECTING EXISTING UNDERGROUND UTILITIES.
- THE CONTRACTOR MUST AT ALL TIMES MAINTAIN PROPER DRAINAGE FOR ALL AREAS AFFECTED BY HIS WORK.

<p>SAINT LOUIS DOWNTOWN AIRPORT <small>A Division of Bi-State Development Agency</small></p>	<p>SD056</p>
<p>IL PROJ.: CPS-4213 BLOCK GRANT PROJ.: 3-17-0039-B30</p>	
<p>Hanson Project No. 12A0069 G-003-SOW.dwg AS SHOWN 03/08/13</p>	<p>LAYOUT 01/16/13 DRAWN MLH 01/16/13 REVIEWED BSS 03/08/13</p>
<p>HANSON <small>© Copyright Hanson Professional Services Inc. 2013 Hanson Professional Services Inc. 1525 S.W. 11th Street, Suite 200 Springfield, Illinois 62703-2886</small></p>	<p>RECONSTRUCT TAXILANE IN NORTHWEST QUADRANT</p> <p>PROPOSED SCOPE OF WORK PLAN</p>
<p>3</p> <p>3 of 18 sheets</p>	

MAR 11, 2013 11:58 AM HARR01115
 pw: \\sp1-sv306\hanson\dom\hanson\Projects\Documents\12A0069\12A0069.dwg\CAID\Airport\Sheet\G-003-SOW