

SAR-V-ALAE
 SAR-C-SPAL
 SAR-V-AL
 KEYMAP

SP023

REVISIONS		
NUMBER	BY	DATE

0 1 2
 THIS BAR IS EQUAL TO 2"
 AT FULL SCALE (34X22).

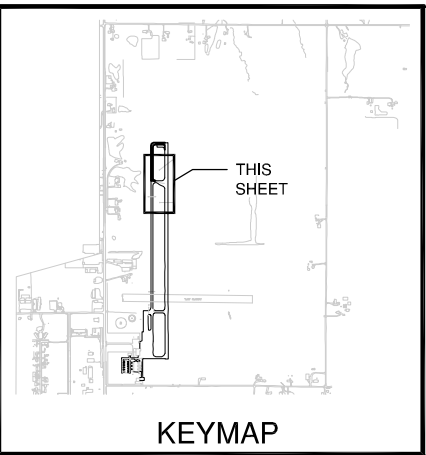

LEGEND

- NEW 1 1/2" BITUMINOUS SURFACE (401)
 NEW 2 1/2" BITUMINOUS BASE (408)
 NEW 11" CRUSHED AGGREGATE BASE (209)
- NEW BITUMINOUS SEAL COAT
- EXISTING 4" BITUMINOUS
 EXISTING 8" AGGREGATE BASE
- NEW 1 1/2" BITUMINOUS SURFACE (401)
- BUTT JOINT - NEW 1 1/2" BITUMINOUS SURFACE (401)

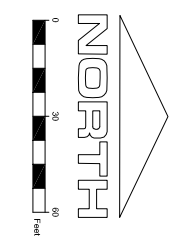

TAXIWAY A3
 STA. = 1+17.50
 NORTH = 541671.75
 EAST = 2430649.98

TAXIWAY A
 STA. = 40+00.00
 NORTH = 541889.71
 EAST = 2430649.80

TAXIWAY A
 STA. = 44+52.18
 NORTH = 542341.89
 EAST = 2430649.43

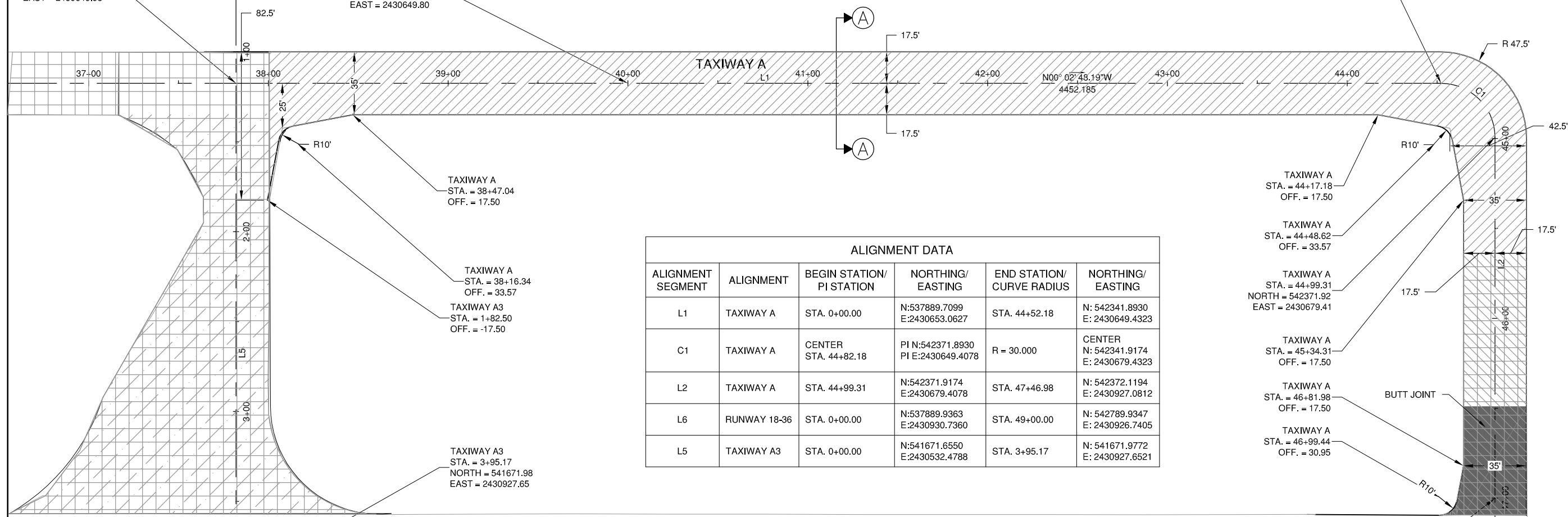

ALIGNMENT DATA					
ALIGNMENT SEGMENT	ALIGNMENT	BEGIN STATION/ PI STATION	NORTHING/ EASTING	END STATION/ CURVE RADIUS	NORTHING/ EASTING
L1	TAXIWAY A	STA. 0+00.00	N:537889.7099 E:2430653.0627	STA. 44+52.18	N: 542341.8930 E: 2430649.4323
C1	TAXIWAY A	CENTER STA. 44+82.18	PI N:542371.8930 PI E:2430649.4078	R = 30.000	CENTER N: 542341.9174 E: 2430679.4323
L2	TAXIWAY A	STA. 44+99.31	N:542371.9174 E:2430679.4078	STA. 47+46.98	N: 542372.1194 E: 2430927.0812
L6	RUNWAY 18-36	STA. 0+00.00	N:537889.9363 E:2430930.7360	STA. 49+00.00	N: 542789.9347 E: 2430926.7405
L5	TAXIWAY A3	STA. 0+00.00	N:541671.6550 E:2430532.4788	STA. 3+95.17	N: 541671.9772 E: 2430927.6521

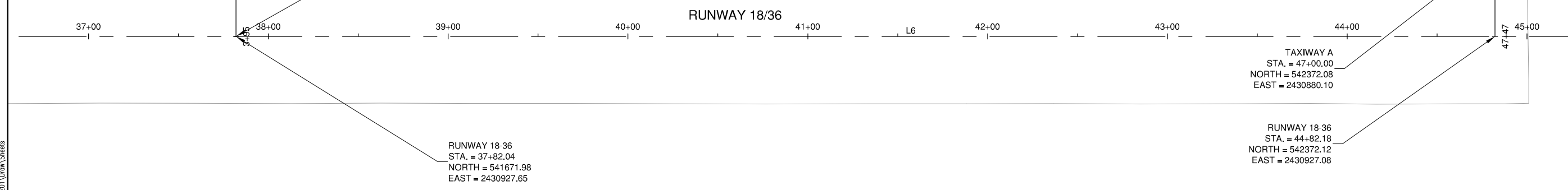

SPARTA COMMUNITY AIRPORT
 HUNTER FIELD
 SPARTA, ILLINOIS

TAXIWAY EXTENSION
 PROPOSED IMPROVEMENTS

© Copyright CMT, Inc.
CMT
 CRAWFORD, MURPHY & TILLY, INC.
 CONSULTING ENGINEERS
 License No. 184-000613



DESIGN BY:	CBG
DRAWN BY:	CMT
CHECKED BY:	CET
APPROVED BY:	CET
DATE:	MARCH 1, 2013
JOB No:	1241201

IL. PROJ. NO. SAR-4224
 SBG NO. 3-17-0094-B11