

SP023

REVISIONS		
NUMBER	BY	DATE

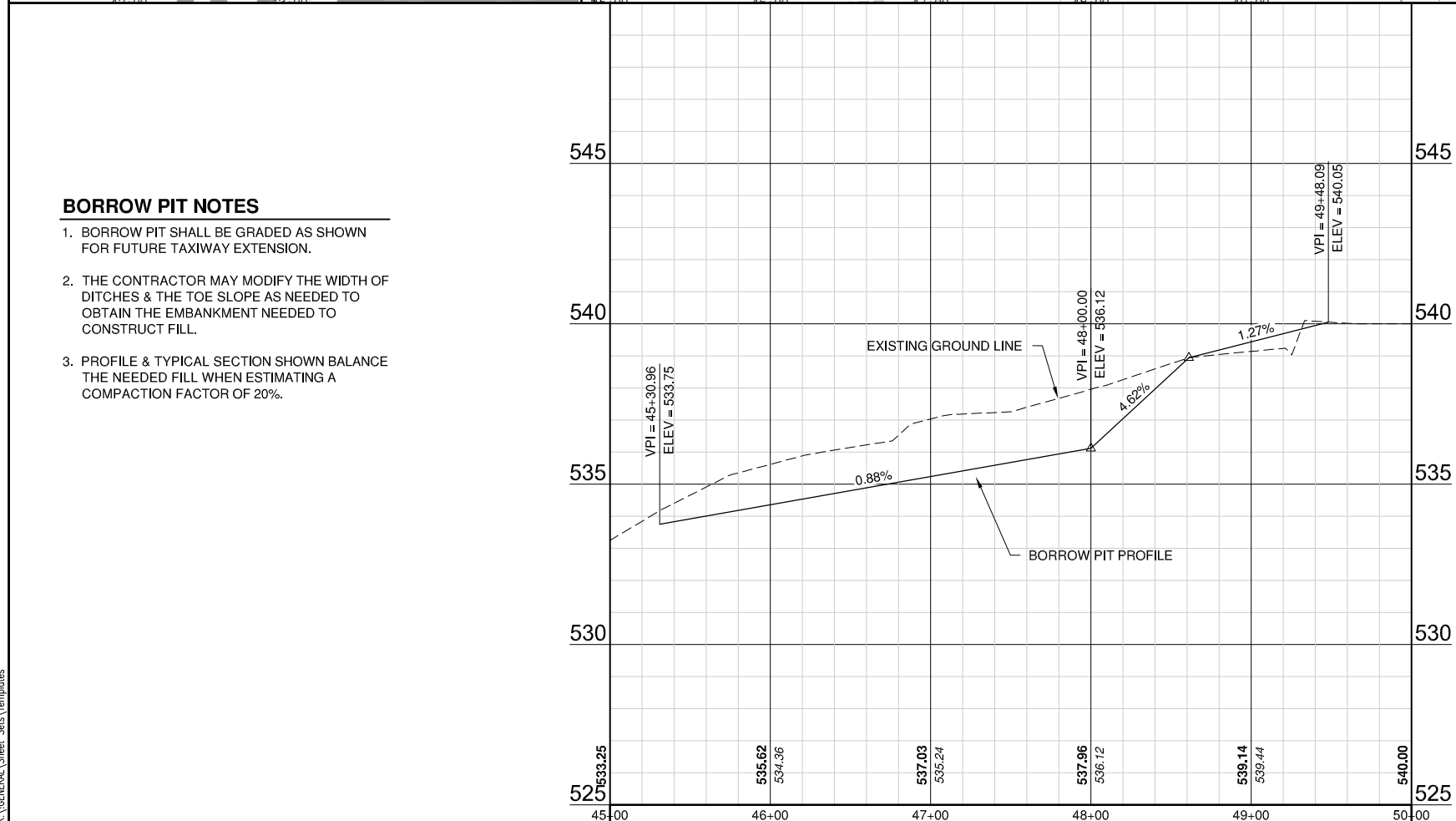

ALIGNMENT DATA					
ALIGNMENT SEGMENT	ALIGNMENT	BEGIN STATION/ PI STATION	NORTHING/ EASTING	END STATION/ CURVE RADIUS	NORTHING/ EASTING
L1	BORROW PIT	STA. 45+00.00	N:542389.7084 E:2430649.3933	STA. 50+00.00	N: 542889.7082 E: 2430648.9856

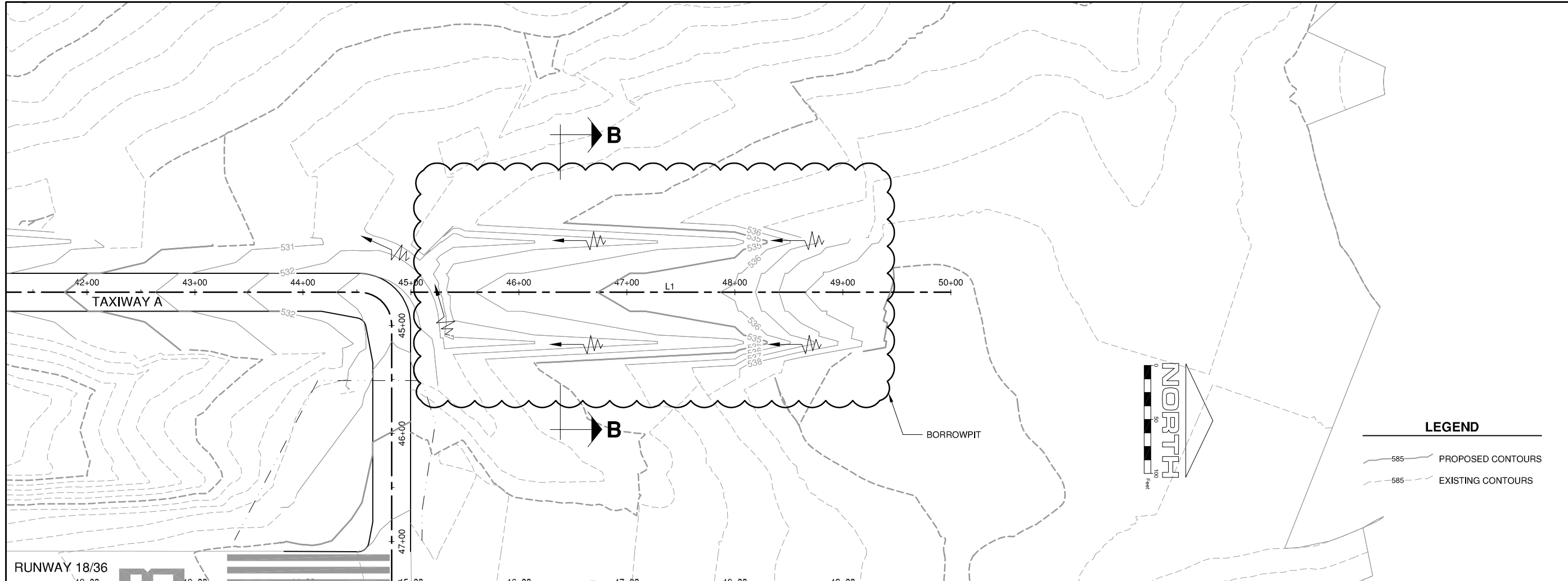
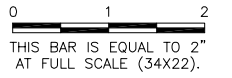
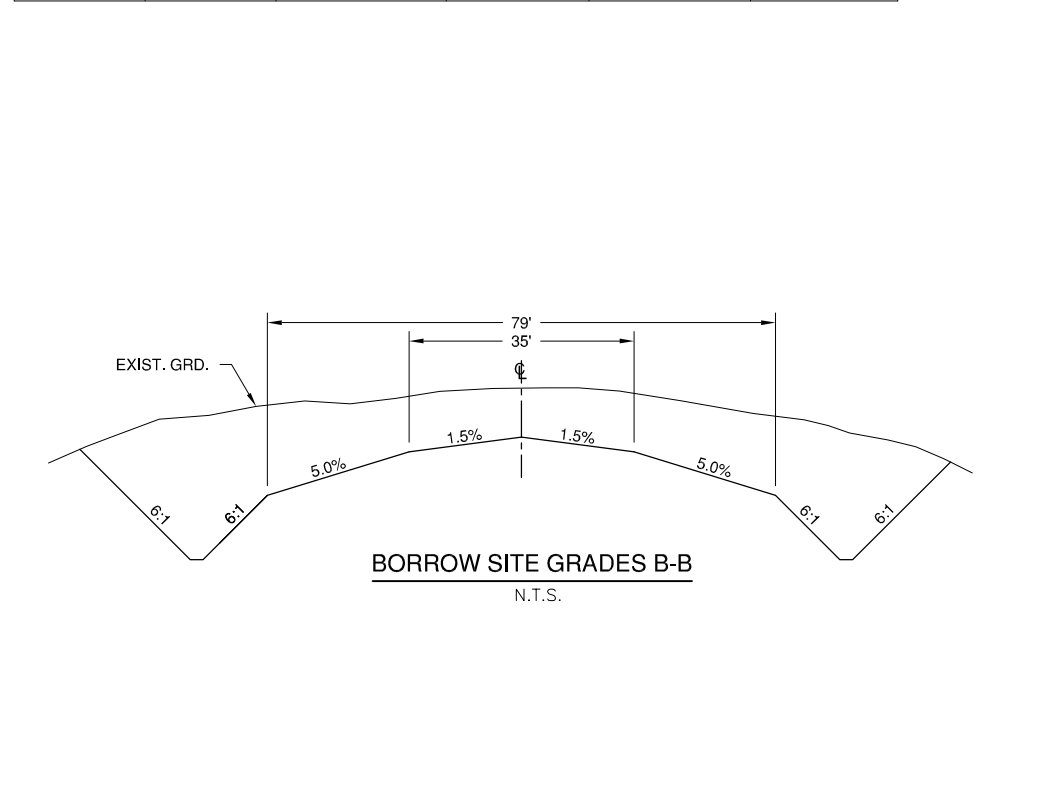

BORROW PIT NOTES

- BORROW PIT SHALL BE GRADED AS SHOWN FOR FUTURE TAXIWAY EXTENSION.
- THE CONTRACTOR MAY MODIFY THE WIDTH OF DITCHES & THE TOE SLOPE AS NEEDED TO OBTAIN THE EMBANKMENT NEEDED TO CONSTRUCT FILL.
- PROFILE & TYPICAL SECTION SHOWN BALANCE THE NEEDED FILL WHEN ESTIMATING A COMPACTION FACTOR OF 20%.

SPARTA COMMUNITY AIRPORT
 HUNTER FIELD
 SPARTA, ILLINOIS

TAXIWAY EXTENSION
 BORROW SITE PLAN AND PROFILE

© Copyright CMT, Inc.
CMT
 CRAWFORD, MURPHY & TILLY, INC.
 CONSULTING ENGINEERS
 License No. 184-000613

DESIGN BY:	CBG
DRAWN BY:	CMT
CHECKED BY:	CET
APPROVED BY:	CET
DATE:	MARCH 1, 2013
JOB No:	1241201
IL. PROJ. NO. SAR-4224 SBG NO. 3-17-0094-B11	
SHEET 23 OF 28 SHEETS	