

TA005

REVISIONS		
NUMBER	BY	DATE

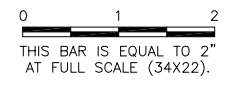

TAYLORVILLE MUNICIPAL AIRPORT
TAYLORVILLE AIRPORT
TAYLORVILLE, ILLINOIS
TAXIWAY EXTENSION
CONSTRUCTION ACTIVITY PLAN 1

© Copyright CMT, Inc.
CMT
 CRAWFORD, MURPHY & TILLY, INC.
 CONSULTING ENGINEERS
 License No. 184-000613

DESIGN BY:	CBG
DRAWN BY:	CMT
CHECKED BY:	CET
APPROVED BY:	CET
DATE:	MARCH 13, 2013
JOB No:	11050-01
IL. PROJ. NO. TAZ-4096 SBG NO. 3-17-0100-B13	
SHEET 03 OF 25 SHEETS	

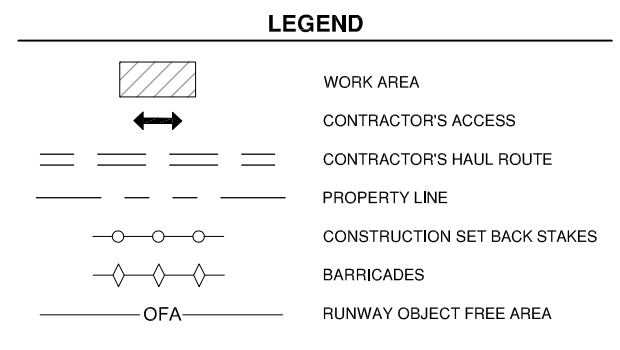
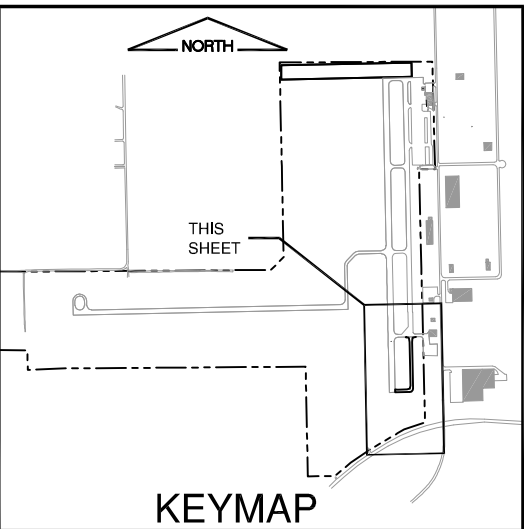

- CONSTRUCTION PHASE 1 NOTES**
- CONTRACTOR SHALL ACCESS THE SITE THROUGH TEMPORARY HAUL ROAD.
 - HAUL ROAD SHALL BE OUTSIDE OF TAXIWAY SAFETY AREA AND RUNWAY OBJECT FREE AREA BUT ALSO REMAIN ON AIRPORT PROPERTY.
 - RUNWAY 18/36 AND TAXIWAY SHALL REMAIN OPEN FOR THIS PHASE OF THE PROJECT.
 - CONSTRUCTION ACTIVITIES WILL INCLUDE EMBANKMENT EXCAVATION, PAVEMENT CONSTRUCTION, DRAINAGE IMPROVEMENTS, ELECTRICAL IMPROVEMENTS, PAVEMENT MARKING AND TURFING.
 - CONTRACTOR'S EQUIPMENT SHALL BE RESTRICTED TO 15' MAXIMUM HEIGHT WHEN ACCESSING THE HAUL ROUTE AND SHALL BE NO MORE THAN 25' FROM THE EXISTING FENCE WHILE RUNWAY 18-36 IS OPENED. DELIVERY VEHICLES AND EQUIPMENT GREATER 15' WILL REQUIRE THE CONTRACTOR TO COORDINATE WITH THE AIRPORT THROUGH THE RESIDENT ENGINEER TO ENSURE THAT THE RUNWAY 36 APPROACH SURFACE REMAINS PROTECTED.

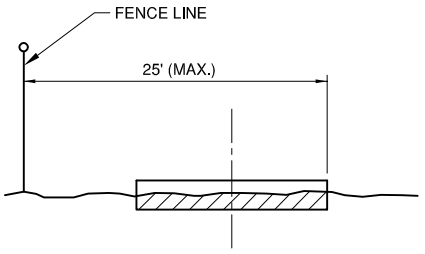

HAUL ROUTE LOCATION
N.T.S.

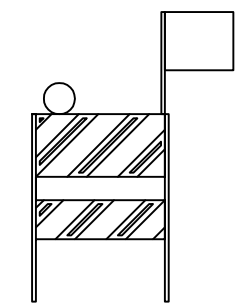

FLASHER BARRICADE DETAIL
N.T.S.

- NOTES**
- STEADY BURN TO BE BATTERY OPERATED OMNI DIRECTIONAL LENS TO BE RED.
 - SANDBAGS TO BE PLACED ON EACH SUPPORT BRACE AS REQUIRED TO PREVENT DISPLACEMENT BY WIND, JET OR PROP BLAST.
 - NO SEPARATE PAYMENT WILL BE MADE FOR THIS ITEM. COSTS SHALL BE CONSIDERED INCIDENTAL TO THE PROJECT.
 - PLACE AT 15' INTERVALS.
 - ONE 20" x 20" ORANGE FLAG TO BE INSTALLED ON EACH BARRICADE AND SECURELY FASTENED.

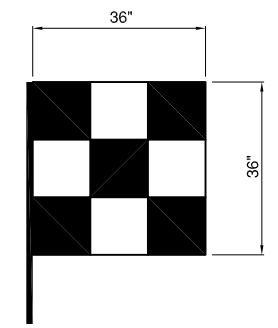
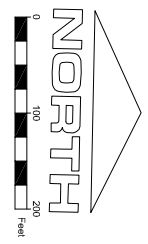
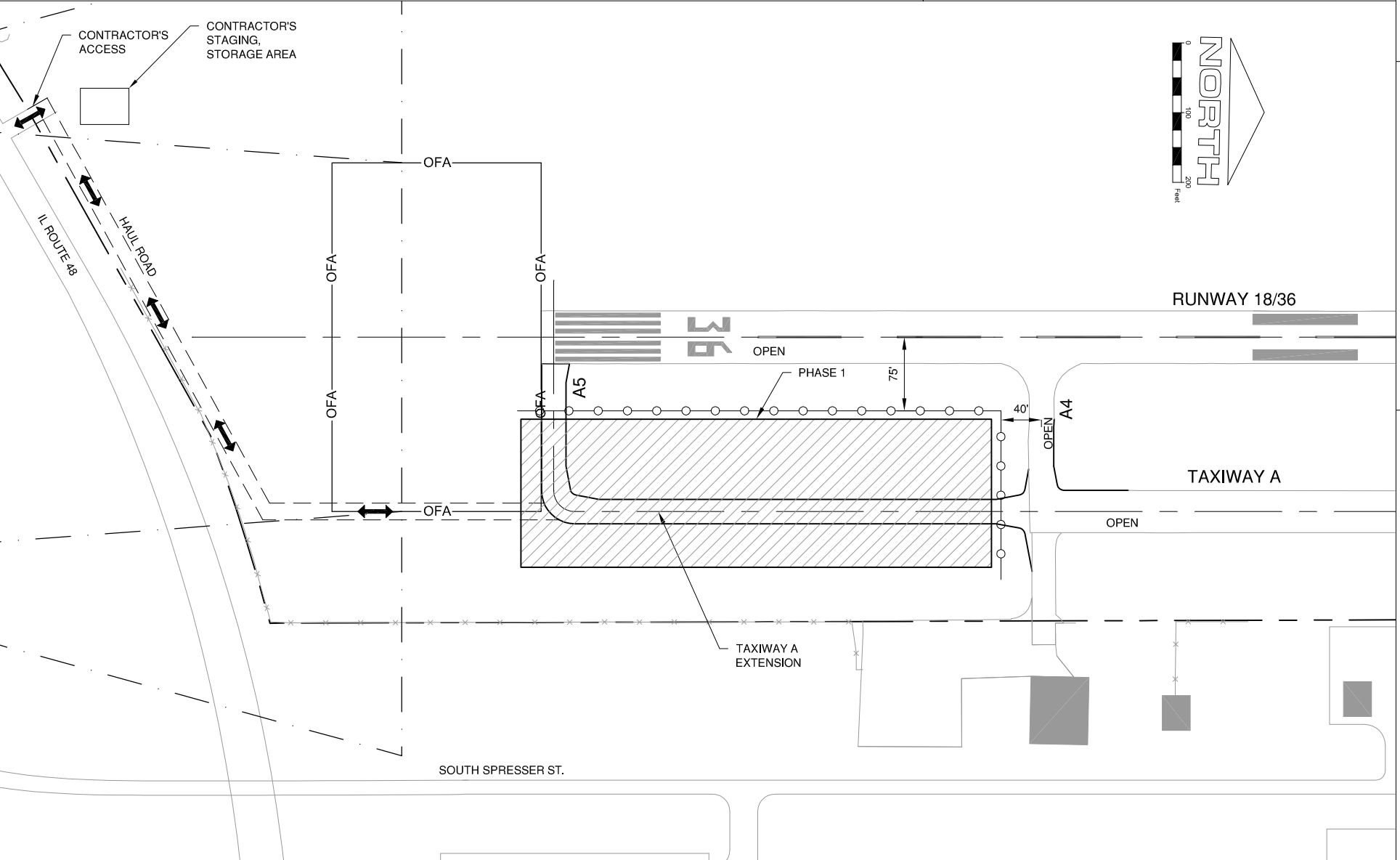

TRUCK SIGNAL FLAG
ORANGE / WHITE
N.T.S.

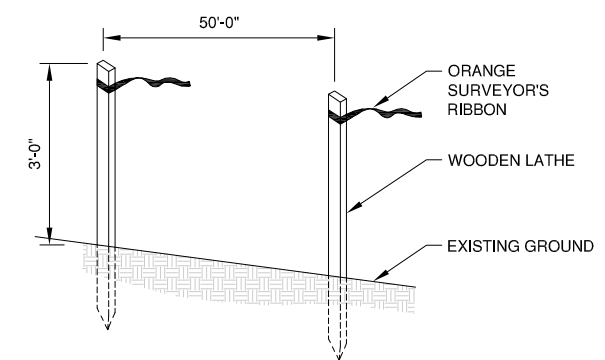

CONSTRUCTION SETBACK LINE DETAIL
N.T.S.

K:\projects\taz\1105001\Draw Sheets