

ALIGNMENT DATA					
ALIGNMENT SEGMENT	ALIGNMENT	BEGIN STATION/ PI STATION	NORTHING/ EASTING	END STATION/ CURVE RADIUS	NORTHING/ EASTING
L3	RUNWAY 18-36	STA. 257+00.00	N:1042127.9889 E:2533343.9470	STA. 307+00.00	N: 1047126.8677 E: 2533238.0639
L4	TAXIWAY A4	STA. 10+00.00	N:1043345.5633 E:2533318.1546	STA. 14+50.00	N: 1043355.0928 E: 2533768.0537
L1	TAXIWAY A	STA. 362+48.34	N:1042681.5025 E:2533582.2789	STA. 407+00.00	N: 1047132.1618 E: 2533488.0081
C1	TAXIWAY A	CENTER STA. 362+31.22	PI N:1042651.5092 PI E:2533582.9142	R = 30.000	CENTER N: 1042680.8672 E: 2533552.2856
L2	TAXIWAY A	STA. 359+00.00	N:1042644.4952 E:2533251.7700	STA. 362+01.22	N: 1042650.8739 E: 2533552.9209

LEGEND	
	NEW TAXIWAY EDGE OF PAVEMENT
	NEW 1 1/2" BITUMINOUS SURFACE COURSE (401) NEW 2 1/2" BITUMINOUS BASE COURSE (403) NEW 11" CRUSHED AGGREGATE BASE COURSE (209)

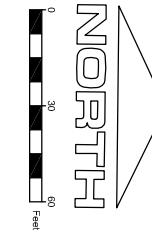

FILE: TAZ-4096-CP101.dwg
 UPDATE BY: Chris Groth
 PLOT DATE: 4/26/2013 2:52 PM

TA005

REVISIONS		
NUMBER	BY	DATE

0 1 2
 THIS BAR IS EQUAL TO 2"
 AT FULL SCALE (34X22).

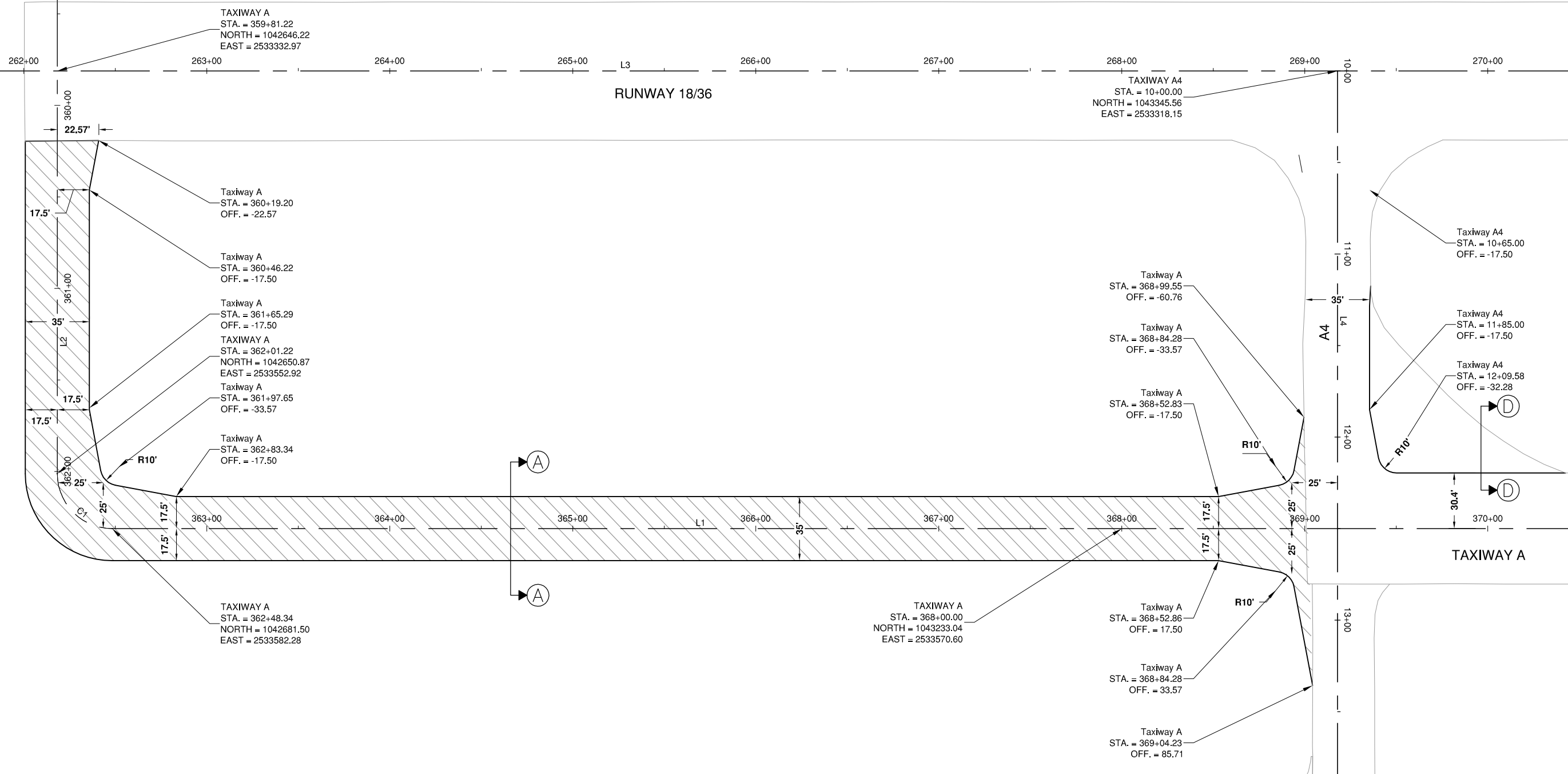

TAYLORVILLE MUNICIPAL AIRPORT
TAYLORVILLE AIRPORT
TAYLORVILLE, ILLINOIS
TAXIWAY EXTENSION
PROPOSED IMPROVEMENTS

© Copyright CMT, Inc.

CMT
 CRAWFORD, MURPHY & TILLY, INC.
 CONSULTING ENGINEERS
 License No. 184-000613

DESIGN BY:	CBG
DRAWN BY:	CMT
CHECKED BY:	CET
APPROVED BY:	CET
DATE:	MARCH 13, 2013
JOB No:	11050-01
IL PROJ. NO.	TAZ-4096
SBG NO.	3-17-0100-B13
SHEET	08 OF 25 SHEETS