

**TA005**

REVISIONS		
NUMBER	BY	DATE

0 1 2  
 THIS BAR IS EQUAL TO 2"  
 AT FULL SCALE (34X22).

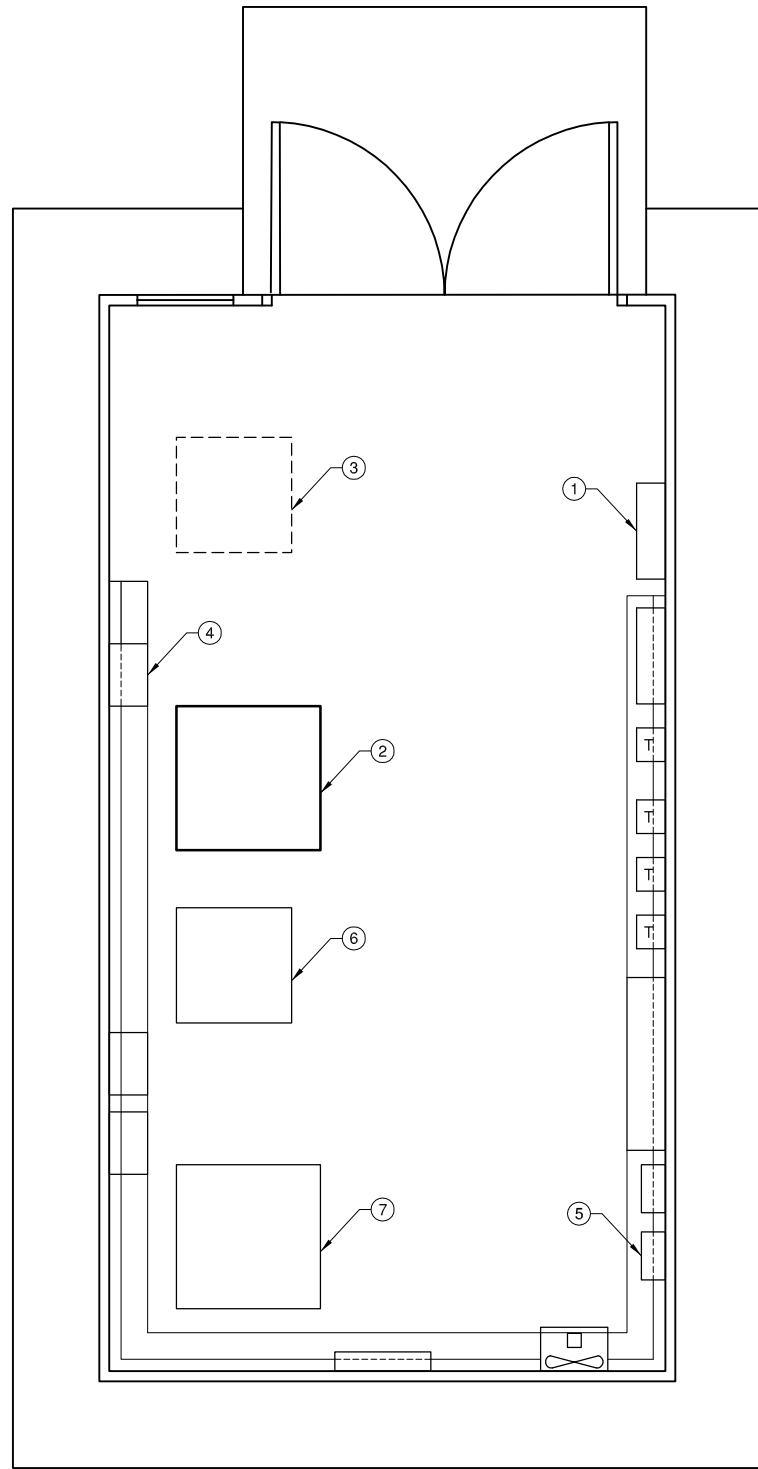

VAULT ELECTRICAL EQUIPMENT PLAN  
 N.T.S.

○ **VAULT PLAN KEYED NOTES**

- 1 EXISTING DISTRIBUTION PANELBOARD.
  - DISCONNECT EXISTING NORTH-SOUTH TAXIWAY REGULATOR POWER WIRING AT BOTH DISTRIBUTION PANELBOARD 50A, 2P CIRCUIT BREAKER AND EXISTING REGULATOR, AND REMOVE. DISPOSE OF OFFSITE. RELABEL 50A, 2P CIRCUIT BREAKER AS "SPARE" IN PANELBOARD SCHEDULE.
  - INSTALL NEW 90A, 2P CIRCUIT BREAKER COMPATIBLE WITH AND BY SAME MANUFACTURER AS EXISTING DISTRIBUTION PANELBOARD. LABEL AS "N-S TXY REGULATOR" IN PANELBOARD SCHEDULE.
  - INSTALL NEW 240V POWER WIRING, TWO #3 THWN, ONE #8 GROUND, FROM DISTRIBUTION PANELBOARD TO NEW NORTH-SOUTH TAXIWAY REGULATOR, IN EXISTING WIREWAY AND NEW LIQUIDTIGHT FLEXIBLE METAL CONDUIT.
- 2 LOCATION OF EXISTING NORTH-SOUTH TAXIWAY REGULATOR.
  - DISCONNECT EXISTING REGULATOR FROM EXISTING POWER AND CONTROL WIRING AND RELOCATE REGULATOR AS INDICATED.
  - INSTALL NEW NORTH-SOUTH TAXIWAY REGULATOR, 15KW, 240V INPUT, 3-STEP, 6.6A OUTPUT HERE. PROVIDE ENGRAVED NAMEPLATE READING "NORTH-SOUTH TAXIWAY".
  - CONNECT NEW REGULATOR TO NEW 240V POWER WIRING, EXISTING L\_854 PCAL RADIO INTERFACE UNIT CONTROL WIRING AND EXISTING TAXIWAY SERIES CIRCUIT WIRING. INSTALL #6 GROUND WIRE WITH GREEN INSULATION FROM REGULATOR GROUND LUG TO VAULT GROUND BUS.
- 3 RELOCATE EXISTING NORTH-SOUTH TAXIWAY REGULATOR TO HERE.
- 4 EXISTING S-1 PUG CUTOUT IN NEMA 1 ENCLOSURE. RECONNECT EXISTING SERIES CIRCUIT L-824, 5KV, TYPE C WIRING IN LIQUIDTIGHT FLEXIBLE CONDUIT FROM THIS PLUG CUTOUT TO NEW REGULATOR. IF NECESSARY, INSTALL NEW SERIES CIRCUIT L-824, 5KV, TYPE C WIRING IN LIQUIDTIGHT FLEXIBLE CONDUIT.
- 5 EXISTING NORTH-SOUTH TAXIWAY L-854 PCAL RADIO INTERFACE UNIT. EXISTING CONTROL WIRING TO BE RECONNECTED TO NEW NORTH-SOUTH TAXIWAY REGULATOR.
- 6 EXISTING RUNWAY 9-27 REGULATOR, 10KW, 240V INPUT, 3-STEP 6.6A OUTPUT. TO REMAIN.
- 7 EXISTING RUNWAY 18-36 REGULATOR, 7.5KW, 240V INPUT, 3-STEP 6.6A OUTPUT. TO REMAIN.

TAYLORVILLE MUNICIPAL AIRPORT  
 TAYLORVILLE AIRPORT  
 TAYLORVILLE, ILLINOIS

TAXIWAY EXTENSION  
 ELECTRICAL DETAILS 3

© Copyright CMT, Inc.  
**CMT**  
 CRAWFORD, MURPHY & TILLY, INC.  
 CONSULTING ENGINEERS  
 License No. 184-000613

DESIGN BY:	CBG
DRAWN BY:	CMT
CHECKED BY:	CET
APPROVED BY:	CET
DATE:	MARCH 13, 2013
JOB No:	11050-01
IL. PROJ. NO. TAZ-4096 SBG NO. 3-17-0100-B13	
SHEET	15 OF 25 SHEETS