

STATE OF ILLINOIS
DEPARTMENT OF TRANSPORTATION

F.A.U. RTE.	SECTION	COUNTY	TOTAL SHEETS	SHEET NO.
1551	17-00079-00-BR	DUPAGE	16	1
		ILLINOIS	CONTRACT NO. 61F83	

PLANS FOR PROPOSED FEDERAL AID HIGHWAY

FAU 1551 (83RD STREET)
OVER INTERSTATE 355
BRIDGE IMPROVEMENTS
SECTION: 17-00079-00-BR
PROJECT NO.: QDF8(241)
VILLAGE OF WOODRIDGE
DUPAGE COUNTY
JOB NO.: C-91-118-18



SEE INDEX OF SHEETS ON SHEET 2

TRAFFIC INFORMATION

CLASSIFICATION	MINOR ARTERIAL
	83RD STREET
DESIGN SPEED =	35 MPH
POSTED SPEED =	30 MPH
ADT (2010) =	15250
ADT (2030) =	21350



FULL SIZE PLANS HAVE BEEN PREPARED USING STANDARD ENGINEERING SCALES. REDUCED SIZED PLANS WILL NOT CONFORM TO STANDARD SCALES. IN MAKING MEASUREMENTS ON REDUCED PLANS, THE ABOVE SCALES MAY BE USED.

J.U.L.I.E.
JOINT UTILITY LOCATION INFORMATION FOR EXCAVATION
1-800-892-0123
OR 811

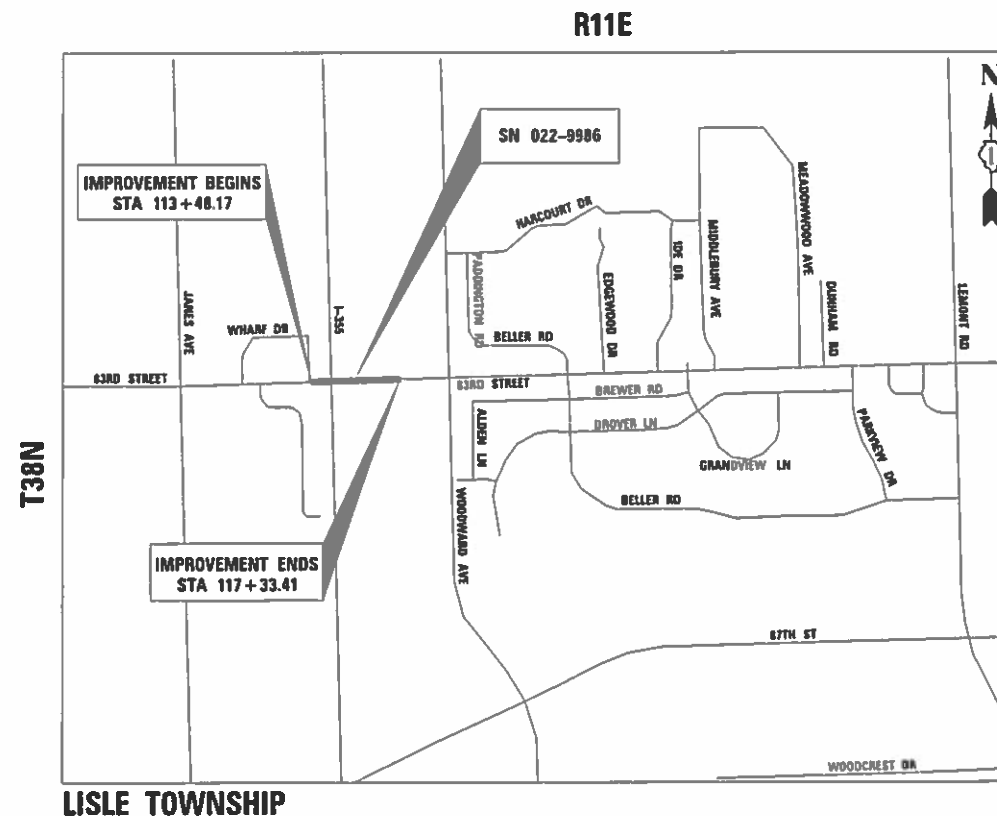

LOCATION MAP
NOT TO SCALE
GROSS LENGTH = 386 FT. = 0.07 MILES
NET LENGTH = 386 FT. = 0.07 MILES

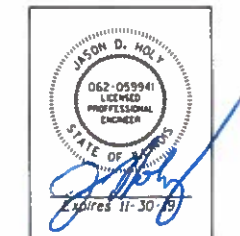

JASON D. HOLY
PROJECT MANAGER

STATE OF ILLINOIS
DEPARTMENT OF TRANSPORTATION

Approved Apr 11, 2019

Chris Burke
VILLAGE OF WOODRIDGE, DIRECTOR OF PUBLIC WORKS

Passed 4/11, 2019

Steph M. Zwick
DISTRICT 1 ENGINEER OF LOCAL ROADS AND STREETS

Released for Bid
Based on Limited
Review APRIL 11, 2019

Anthony J. D'Amico/CMB
REGIONAL ENGINEER

PRINTED BY THE AUTHORITY
OF THE STATE OF ILLINOIS

FEDERAL AID PROGRAM ENGINEER: CARMEN E. RAMOS, P.E., SCHAUMBURG, IL

CONTRACT NO.: 61F83

GENERAL NOTES

- ALL CONSTRUCTION SHALL BE PERFORMED IN ACCORDANCE WITH THE ILLINOIS DEPARTMENT OF TRANSPORTATION "STANDARD SPECIFICATIONS FOR ROAD AND BRIDGE CONSTRUCTION", ADOPTED APRIL 1, 2016 (HEREINAFTER REFERRED TO AS THE STANDARD SPECIFICATIONS); THE "SUPPLEMENTAL SPECIFICATIONS AND RECURRING SPECIAL PROVISIONS", IN EFFECT ON THE DATE OF THE INVITATION OF BIDS; THE LATEST EDITION OF THE "ILLINOIS MANUAL ON UNIFORM TRAFFIC CONTROL DEVICES FOR STREETS, THE "DETAILS" ON THE PLANS AND THE "SPECIAL PROVISIONS" INCLUDED IN THE CONTRACT DOCUMENTS. ANY REFERENCE TO STANDARDS THROUGHOUT THE PLANS OR SPECIAL PROVISIONS SHALL BE INTERPRETED AS THE LATEST STANDARD OF THE ILLINOIS DEPARTMENT OF TRANSPORTATION.
- THE CONTRACTOR SHALL NOTIFY THE ENGINEER AND VILLAGE CONTACT AT 630-719-2941 AT LEAST 72 HOURS IN ADVANCE OF BEGINNING WORK AND SHALL COORDINATE ALL CONSTRUCTION OPERATIONS WITH THE ENGINEER. ATTENTION IS CALLED TO SECTION 701 OF THE STANDARD SPECIFICATIONS AND THE SPECIAL PROVISIONS FOR TRAFFIC CONTROL AND PROTECTION. THE STORAGE OF EQUIPMENT AND/OR MATERIALS WITHIN THE RIGHT-OF-WAY OF ANY STREET AND/OR PARK PROPERTY SHALL REQUIRE PRIOR APPROVAL OF THE ENGINEER.
- THE CONTRACTOR SHALL FURNISH, ERECT, AND MAINTAIN ALL SIGNS, BARRICADES AND OTHER TRAFFIC CONTROL DEVICES, REQUIRED TO MAINTAIN TRAFFIC FLOW. PORTABLE/CHANGEABLE ELECTRONIC MESSAGE BOARDS SHALL BE USED IN ADVANCE OF THE PROJECT ACCORDING TO IDOT STANDARDS AND SHALL BE IN PLACE A MINIMUM OF 72 HOURS PRIOR TO COMMENCING THE WORK AND REMAIN THROUGHOUT THE ROADWAY CONSTRUCTION WORK.
- THE CONTRACTOR SHALL MAKE ALL FULL DEPTH SAW CUTS AT THE EDGE OF PAVEMENT ADJACENT TO THE REMOVAL OF ALL CONCRETE CURB OR COMBINATION CONCRETE CURB AND GUTTER. THE CONTRACTOR SHALL MAKE ALL FULL DEPTH SAW CUTS REQUIRED FOR THE HMA PAVEMENT PATCHING AND CONCRETE CURB AND GUTTERS AS SPECIFIED, OR AS DIRECTED BY THE ENGINEER.
- THE CONTRACTOR SHALL MAINTAIN THE SITE IN A CLEAN AND ORDERLY MANNER. DEBRIS AND ANY SURPLUS MATERIAL SHALL BE REMOVED AND RESTORATION SHALL PROCEED AS THE WORK PROCEEDS. IF THE ENGINEER SO DIRECTS, THE CONTRACTOR SHALL STOP ALL OTHER WORK AND CONCENTRATE ON CLEAN-UP AND RESTORATION. DEBRIS AND SURPLUS MATERIAL SHALL BE DISPOSED OF BY THE CONTRACTOR OFF-SITE. ANY DAMAGE CAUSED BY THE CONTRACTOR TO EXISTING PAVEMENT, CURB & GUTTER, OR SIDEWALK NOT SHOWN TO BE REMOVED OR WORKED ON DURING CONSTRUCTION SHALL BE REPAIRED OR REPLACED.
- THE CONTRACTOR SHALL CONFINE OPERATIONS WITHIN THE CONSTRUCTION LIMITS OF THE PROJECT. ANY DAMAGE CAUSED BY THE CONTRACTOR OUTSIDE OF SAID CONSTRUCTION LIMITS SHALL BE REPAIRED.
- DURING CONSTRUCTION, ALL SIGNS, BARRICADES AND TEMPORARY PAVEMENT MARKINGS WILL CONFORM TO THE MUTCD AND ILLINOIS MUTCD. VEHICULAR ACCESS TO LOCAL PROPERTIES WILL BE MAINTAINED AT ALL TIMES DURING CONSTRUCTION.
- PRIOR TO NEW WORK, IT SHALL BE THE CONTRACTOR'S RESPONSIBILITY TO FIELD CHECK ALL DIMENSIONS AND ELEVATIONS AND TO VERIFY THE LOCATION AND ELEVATION OF EXISTING UTILITY LINES AND STRUCTURES THAT MAY BE IMPACTED BY THE PROPOSED WORK PRIOR TO ORDERING MATERIAL OR BEGINNING CONSTRUCTION. ANY DISCREPANCIES FROM THE PLANS SHALL BE REPORTED TO THE ENGINEER IMMEDIATELY.
- ALL APPLICABLE PROVISIONS OF THE CURRENT OCCUPATIONAL SAFETY AND HEALTH ACT ARE HEREIN INCORPORATED BY REFERENCE.
- THE ENGINEER AND OWNER ARE NOT RESPONSIBLE FOR THE CONSTRUCTION MEANS, METHODS, TECHNIQUES, SEQUENCES OR PROCEDURES, TIME OF PERFORMANCE, PROGRAMS OR FOR ANY SAFETY PRECAUTIONS USED BY THE CONTRACTOR. THE CONTRACTOR IS SOLELY RESPONSIBLE FOR EXECUTION OF HIS/HER WORK IN ACCORDANCE WITH THE CONTRACT DOCUMENTS AND SPECIFICATIONS.
- THE CONTRACTOR IS RESPONSIBLE FOR HAVING A SET OF "APPROVED" ENGINEERING PLANS WITH THE LATEST REVISION DATE ON THE JOB SITE PRIOR TO THE START OF CONSTRUCTION AND AT ALL TIMES DURING CONSTRUCTION.
- PROTECTIVE COAT SHALL BE PLACED ON THE ROADWAY DECK AS WELL AS THE CONCRETE SIDEWALKS ON THE BRIDGE DECK

IDOT HIGHWAY STANDARDS	
000001-07	STANDARD SYMBOLS ABBREVIATION AND PATTERNS
280001-07	TEMPORARY EROSION CONTROL SYSTEMS
606001-07	CONCRETE CURB TYPE B AND COMBINATION CONCRETE CURB AND GUTTER
701006-05	OFF-RD OPERATIONS, 2L, 2W, 15' (4.5 m) TO 24" (600mm) FROM PAVEMENT EDGE
701101-05	OFF-RD OPERATIONS, MULTILANE, 15' (4.5 m) TO 24" (600mm) FROM PAVEMENT EDGE
701701-10	URBAN LANE CLOSURE, MULTILANE INTERSECTION
701801-06	SIDEWALK, CORNER OR CROSSWALK CLOSURE
701901-08	TRAFFIC CONTROL DEVICES

IDOT DISTRICT 1 STANDARDS	
BD-24	CURB OR CURB AND GUTTER REMOVAL AND REPLACEMENT
TC-13	DISTRICT ONE TYPICAL PAVEMENT MARKINGS
TC-22	ARTERIAL ROAD INFORMATION SIGNING

COMMITMENTS

NO WORK SHALL COMMENCE PRIOR TO AUGUST 12, 2019.

INDEX OF SHEETS

- | | |
|--------|---------------------------------------|
| 1 | TITLE SHEET |
| 2 | GENERAL NOTES |
| 3 - 4 | SUMMARY OF QUANTITIES |
| 5 | TYPICAL SECTIONS |
| 6 | ALIGNMENT, TIES, AND BENCHMARKS |
| 7 | REMOVAL PLAN |
| 8 | ROADWAY PLAN AND PROFILE |
| 9 | DETOUR PLAN |
| 10 | PAVEMENT MARKING AND LANDSCAPING PLAN |
| 11- 12 | STRUCTURAL PLAN |
| 13 | STRUCTURAL DETAILS |
| 14- 16 | CONSTRUCTION DETAILS |

 V3 Companies 7325 Janes Avenue Woodridge, IL 60517 630.724.9200 phone 630.724.9202 fax www.v3co.com	USER NAME = cf1gus	DESIGNED - BMS	REVISED -	STATE OF ILLINOIS DEPARTMENT OF TRANSPORTATION	GENERAL NOTES		F.A.U. RTE.	SECTION	COUNTY	TOTAL SHEETS	SHEET NO.
	PLOT SCALE = 2.0000' / in.	CHECKED - JDH	REVISED -		1551	17-00079-00-BR	DUPAGE	16	2		
	PLOT DATE = 3/29/2019	DATE -	REVISED -		SCALE:		SHEET 1 OF 1 SHEETS	STA.	TO STA.	ILLINOIS FED. AID PROJECT CONTRACT NO. 61F83	

SPECIALTY ITEM	SPECIAL PROVISION	CODE NO.	ITEM	UNIT	TOTAL QUANTITY
		28000510	INLET FILTERS	EACH	4
		40600290	BITUMINOUS MATERIALS (TACK COAT)	POUND	3
		40603335	HOT-MIX ASPHALT SURFACE COURSE, MIX "D", N50	TON	1
		42101300	PROTECTIVE COAT	SQ YD	2,749
		42400200	PORTLAND CEMENT CONCRETE SIDEWALK 5 INCH	SQ FT	125
		44000155	HOT-MIX ASPHALT SURFACE REMOVAL, 1 1/2"	SQ YD	6
		44000500	COMBINATION CURB AND GUTTER REMOVAL	FOOT	10
		44000600	SIDEWALK REMOVAL	SQ FT	125
		50300260	BRIDGE DECK GROOVING	SQ YD	1,975
		60605000	COMBINATION CONCRETE CURB AND GUTTER, TYPE B-6.24	FOOT	10
		67100100	MOBILIZATION	LSUM	1
		70107025	CHANGEABLE MESSAGE SIGN	CAL DA	50
△		78008210	POLYUREA PAVEMENT MARKING TYPE I - LINE 4"	FOOT	1,927
△		78008250	POLYUREA PAVEMENT MARKING TYPE I - LINE 12"	FOOT	205
		78300200	RAISED REFLECTIVE PAVEMENT MARKER REMOVAL	EACH	20
	#	X6025300	CATCH BASINS TO BE ADJUSTED (SPECIAL)	EACH	2

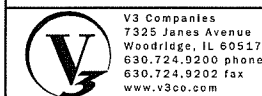

V3 Companies
 7325 Janes Avenue
 Woodridge, IL 60517
 630.724.9200 phone
 630.724.9202 fax
 www.v3co.com

USER NAME = cfigus
 DESIGNED - BMS
 DRAWN -
 CHECKED - JDH
 DATE -
 PLOT SCALE = 2.0000' / 1"

REVISED -
 REVISED -
 REVISED -
 REVISED -

STATE OF ILLINOIS
DEPARTMENT OF TRANSPORTATION

SUMMARY OF QUANTITIES
 SCALE: SHEET 1 OF 1 SHEETS STA. TO STA.

F.A.J. RTE.	SECTION	COUNTY	TOTAL SHEETS	SHEET NO.
1551	17-00079-00-BR	DUPAGE	16	3
ILLINOIS FED. AID PROJECT			CONTRACT NO. 61F83	

SPECIALTY ITEM	SPECIAL PROVISION	CODE NO.	ITEM	UNIT	TOTAL QUANTITY
	#	X7010216	TRAFFIC CONTROL AND PROTECTION, (SPECIAL)	LSUM	1
	#	Z0012130	BRIDGE DECK SCARIFICATION 3/4"	SQ YD	1,402
	#	Z0012136	BRIDGE DECK SCARIFICATION 1 1/2"	SQ YD	542
	#	Z0013798	CONSTRUCTION LAYOUT	LSUM	1
	#	Z0030850	TEMPORARY INFORMATION SIGNING	SQ FT	43
	#	Z0073510	TEMPORARY TRAFFIC SIGNAL TIMING	EACH	6
	#	Z0005994	BRIDGE DECK LATEX CONCRETE OVERLAY, 1 1/2"	SQ YD	1,975
	#	XX009315	BRIDGE DECK SCARIFICATION VARIABLE DEPTH	SQ YD	31

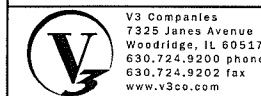

V3 Companies
7325 Janes Avenue
Woodridge, IL 60517
630.724.9200 phone
630.724.9202 fax
www.v3co.com

USER NAME = cf1gus	DESIGNED - BMS	REVISED -
PLOT SCALE = 2.0000' / 1in.	DRAWN -	REVISED -
PLOT DATE = 3/29/2019	CHECKED - JDH	REVISED -
	DATE -	REVISED -

STATE OF ILLINOIS
DEPARTMENT OF TRANSPORTATION

SUMMARY OF QUANTITIES

SCALE: SHEET 1 OF 1 SHEETS STA. TO STA.

F.A.U. RTE.	SECTION	COUNTY	TOTAL SHEETS	SHEET NO.
1551	17-00079-00-BR	DUPAGE	16	4
CONTRACT NO. 61F83				
ILLINOIS FED. AID PROJECT				

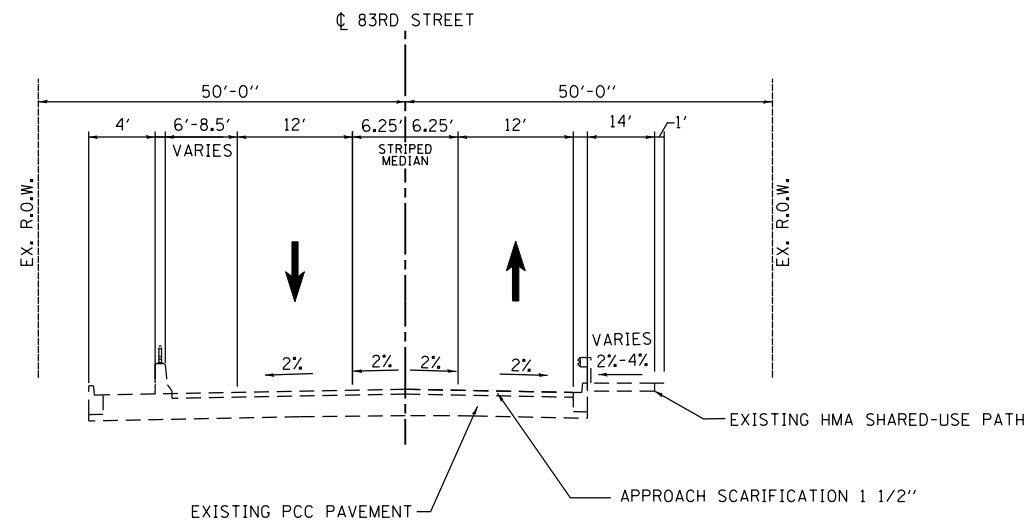

EXISTING TYPICAL SECTION

STA 113+48.17 TO STA 114+00.84
 STA 116+81.19 TO STA 117+33.41
 83RD STREET
 PCC APPROACH PAVEMENT/SLAB

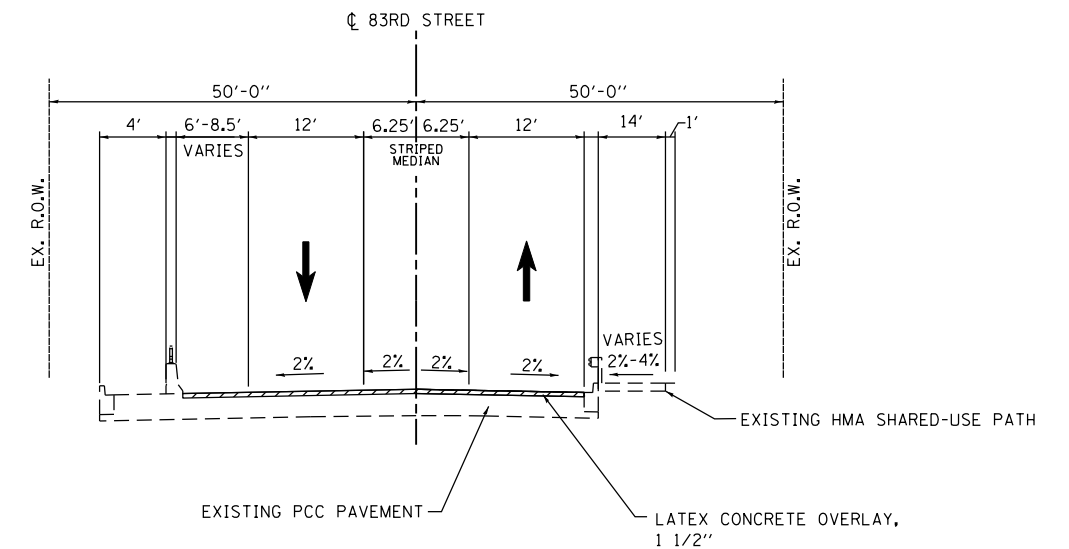

PROPOSED TYPICAL SECTION

STA 113+48.17 TO STA 114+00.84
 STA 116+81.19 TO STA 117+33.41
 83RD STREET
 PCC APPROACH PAVEMENT/SLAB

HOT-MIX ASPHALT REQUIREMENTS	
MIXTURE TYPE	VOIDS
83RD STREET ROADWAY SHOULDER	
HMA SURFACE COURSE, MIX "D", N50 (IL-9.5mm), 1.5"	4% @ 50 GYR

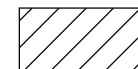

WORK TO BE PERFORMED

NOTES:

1. THE UNIT WEIGHT USED TO CALCULATE ALL HMA SURFACE MIXTURE QUANTITIES IS 112 LBS/SOYD/IN
2. THE "AC TYPE" FOR POLYMERIZED HMA MIXES SHALL BE "PG 76-22". FOR NON-POLYMERIZED HMA MIXES, THE "AC TYPE" SHALL BE "PG 64-22". UNLESS MODIFIED BY DISTRICT ONE SPECIAL PROVISIONS.

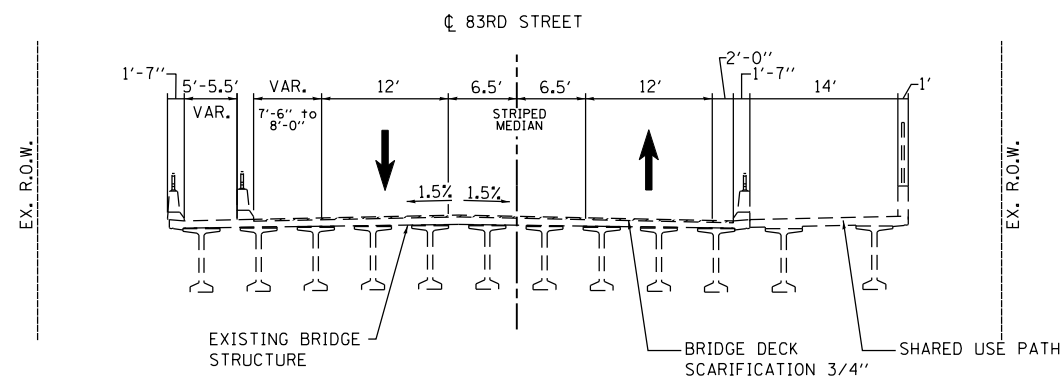

EXISTING TYPICAL SECTION

STA 114+00.84 TO STA 116+81.19
 83rd STREET BRIDGE
 SN 22-9986

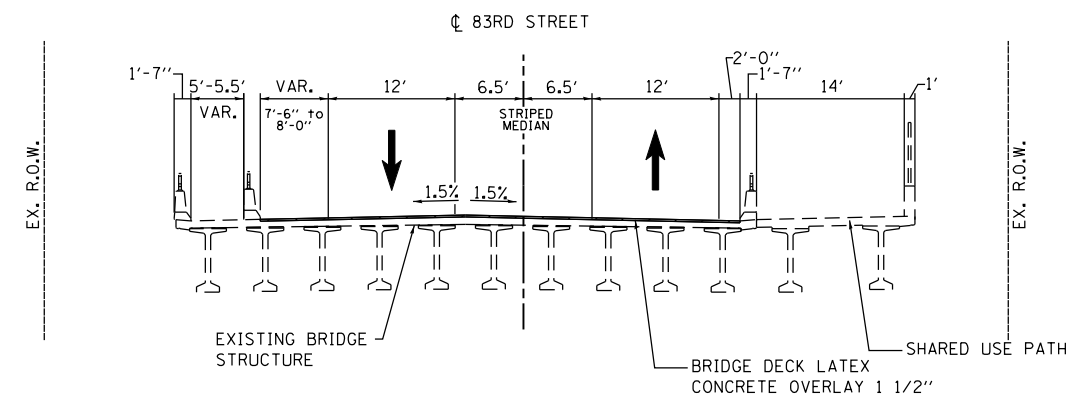

PROPOSED TYPICAL SECTION

STA 114+00.84 TO STA 116+81.19
 83rd STREET BRIDGE
 SN 22-9986

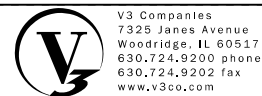

USER NAME = cf1gus	DESIGNED - BMS	REVISED -
PLOT SCALE = 20.0000' / in.	DRAWN -	REVISED -
PLOT DATE = 3/29/2019	CHECKED - JDH	REVISED -
	DATE -	REVISED -

**STATE OF ILLINOIS
 DEPARTMENT OF TRANSPORTATION**

TYPICAL SECTIONS	
SCALE:	SHEET 1 OF 2 SHEETS STA. TO STA.

F.A.U. RTE.	SECTION	COUNTY	TOTAL SHEETS	SHEET NO.
1551	17-00079-00-BR	DUPAGE	16	5
CONTRACT NO. 61F83				
ILLINOIS FED. AID PROJECT				

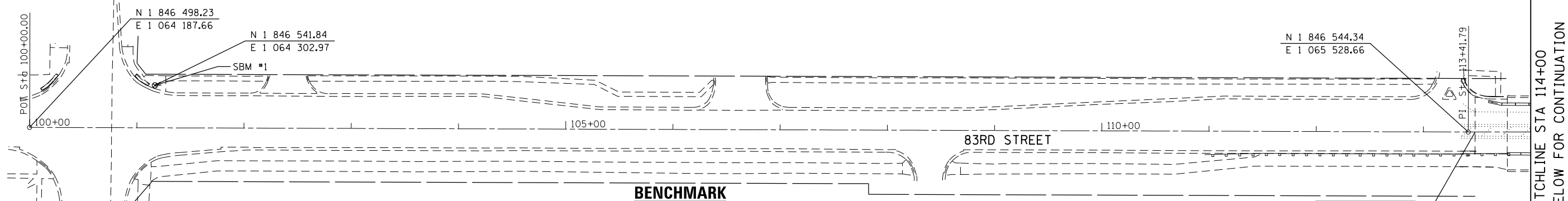
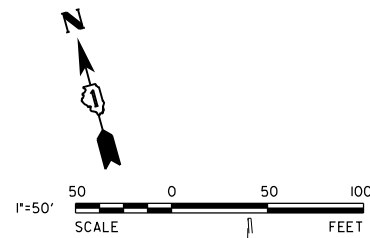

<p>SOURCE:</p> <p>STATION DESIGNATION: DK 3148 ESTABLISHED BY: NGS DATE: MAY 2008</p> <p>ELEVATION: 751.91 (PUBLISHED AND HELD) DATUM: NAVD88 DESCRIPTION: 3.5 INCHES BRASS DISK SET IN CONCRETE BASE FOR A LIGHT POLE, ABOUT 0.25 MI SOUTH OF 83RD STREET AND APPROXIMATELY 500 FT EAST OF JANES AVENUE IN THE PARKING LOT OF ORCHARD HILL PARK, 83.1 FT EAST NORTHEAST OF THE ENDS OF A FENCE LINE, 157.49 FT SOUTHEAST OF THE START OF A FENCE LINE, AND 92.25 FT SOUTH OF THE CENTER OF CONCRETE LIGHT POLE.</p>	<p>SITE:</p> <p>STATION DESIGNATION: SBM #1 ESTABLISHED BY: V3 DATE: 02/21/2014</p> <p>ELEVATION: 760.14 (MEASURED) DATUM: NAVD88 DESCRIPTION: NORTHWEST TAG BOLT ON FIRE HYDRANT AT THE NORTHEAST CORNER OF 83RD STREET AND JANES AVENUE.</p>
	<p>STATION DESIGNATION: SBM #2 ESTABLISHED BY: V3 DATE: 05/12/2014</p> <p>ELEVATION: 758.57 (MEASURED) DATUM: NAVD88 DESCRIPTION: SET CUT CROSS IN CURB, ON NORTH SIDE OF THE 83RD STREET AT EAST SIDE OF BRIDGE OVER VETERANS MEMORIAL TOLLWAY, LOCATED 27.6' W. OF CORNER SIDEWALK, 6.6' N. OF JERSEY BARRIER WALL.</p>



SEE ABOVE FOR CONTINUATION

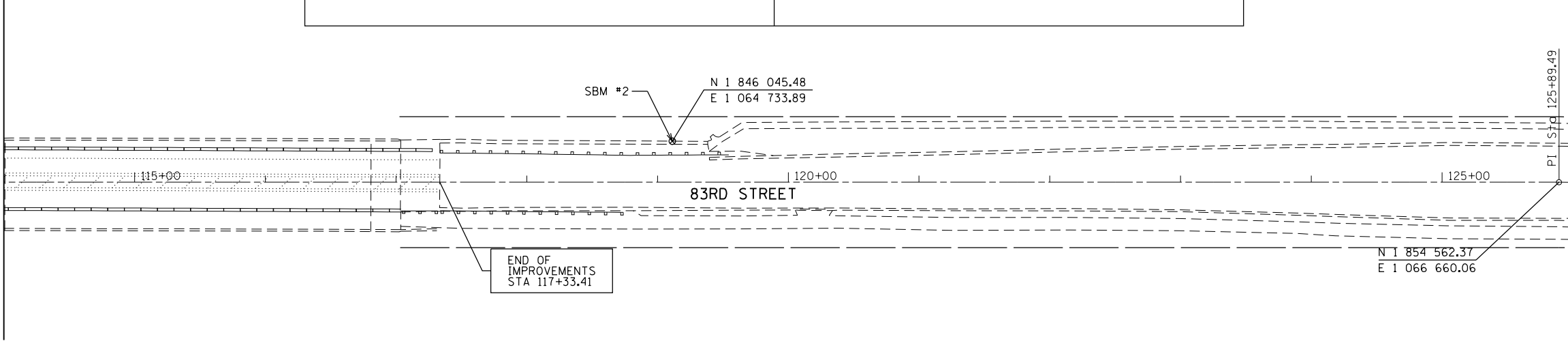

USER NAME = cfisus	DESIGNED - BMS	REVISED -
PLOT SCALE = 100.0000' / in.	DRAWN -	REVISED -
PLOT DATE = 3/29/2019	CHECKED - JDH	REVISED -
	DATE -	REVISED -

**STATE OF ILLINOIS
DEPARTMENT OF TRANSPORTATION**

ALIGNMENT, TIES, AND BENCHMARKS			
SCALE: 1" = 50'	SHEET 1 OF 1 SHEETS	STA.	TO STA.

F.A.U. RTE.	SECTION	COUNTY	TOTAL SHEETS	SHEET NO.
1551	17-00079-00-BR	DUPAGE	16	6
CONTRACT NO. 61F83				
ILLINOIS FED. AID PROJECT				

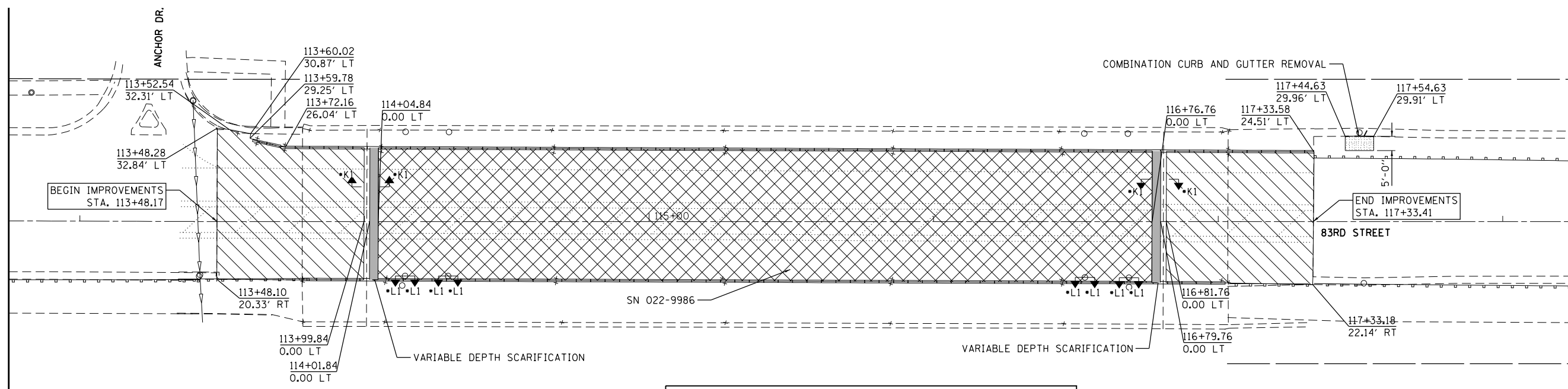

REMOVAL LEGEND

- BRIDGE DECK SCARIFICATION VARIABLE DEPTH
- BRIDGE DECK SCARIFICATION 3/4"
- BRIDGE SLAB SCARIFICATION 1 1/2"
- HMA SURFACE REMOVAL 1 1/2"
- LINEAR ITEM REMOVAL

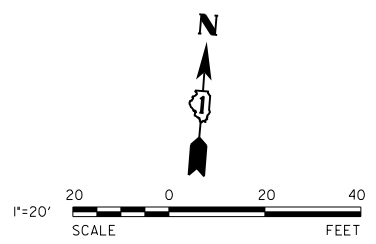

• SEE PLAN SHEET 12 FOR ADDITIONAL DETAILS

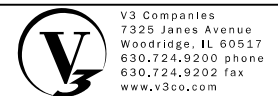

USER NAME = cfisus	DESIGNED - BMS	REVISED -
PLOT SCALE = 40.0000' / in.	CHECKED - JDH	REVISED -
PLOT DATE = 3/29/2019	DATE -	REVISED -

**STATE OF ILLINOIS
DEPARTMENT OF TRANSPORTATION**

REMOVAL PLAN	
SCALE: 1" = 20'	SHEET 1 OF 1 SHEETS
STA. 113+00.00	TO STA. 118+00.00

F.A.U. RTE.	SECTION	COUNTY	TOTAL SHEETS	SHEET NO.
1551	17-00079-00-BR	DUPAGE	16	7
CONTRACT NO. 61F83				
ILLINOIS FED. AID PROJECT				

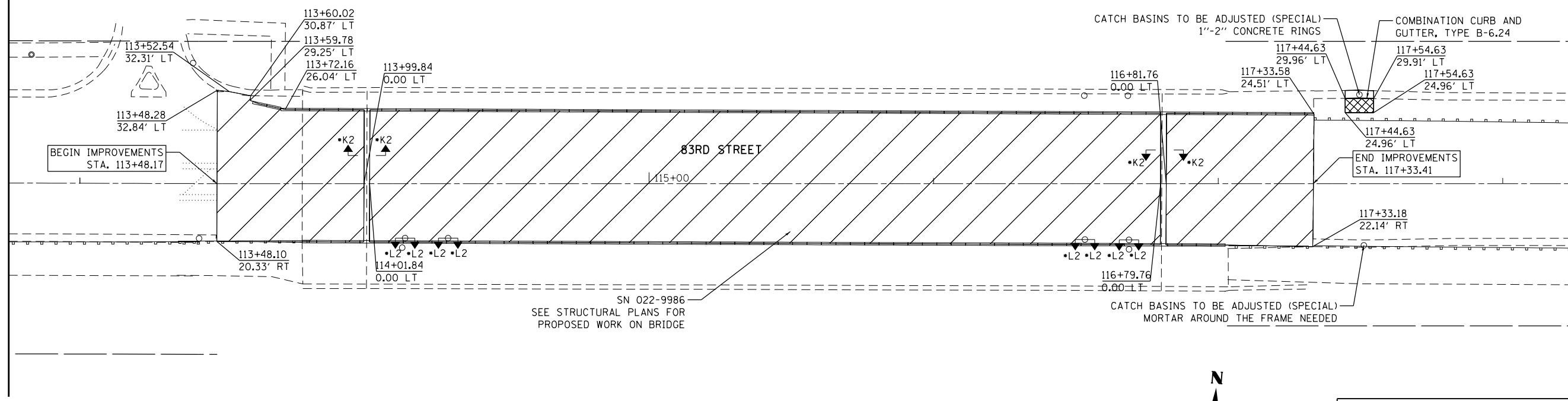

• SEE PLAN SHEET 12 FOR ADDITIONAL DETAILS

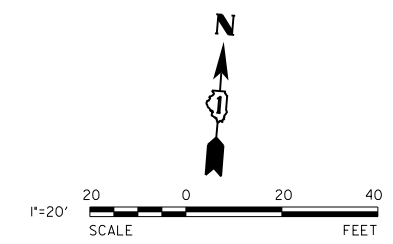

ROADWAY LEGEND	
	BRIDGE DECK LATEX CONCRETE OVERLAY, 1 1/2"
	HMA SURFACE COURSE, MIX "D", N50

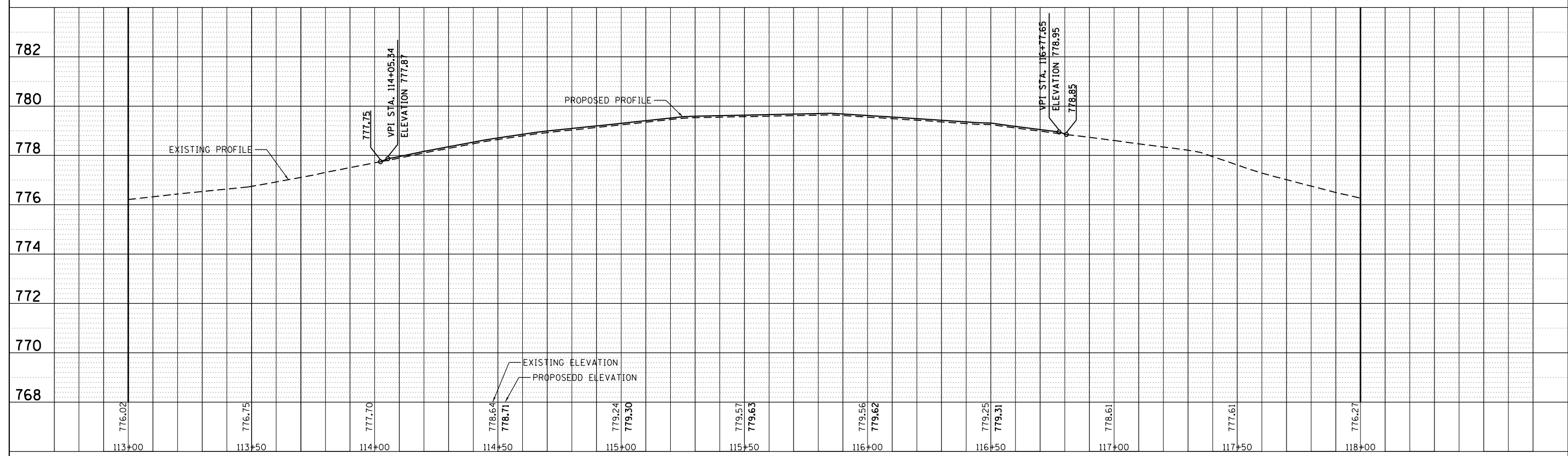

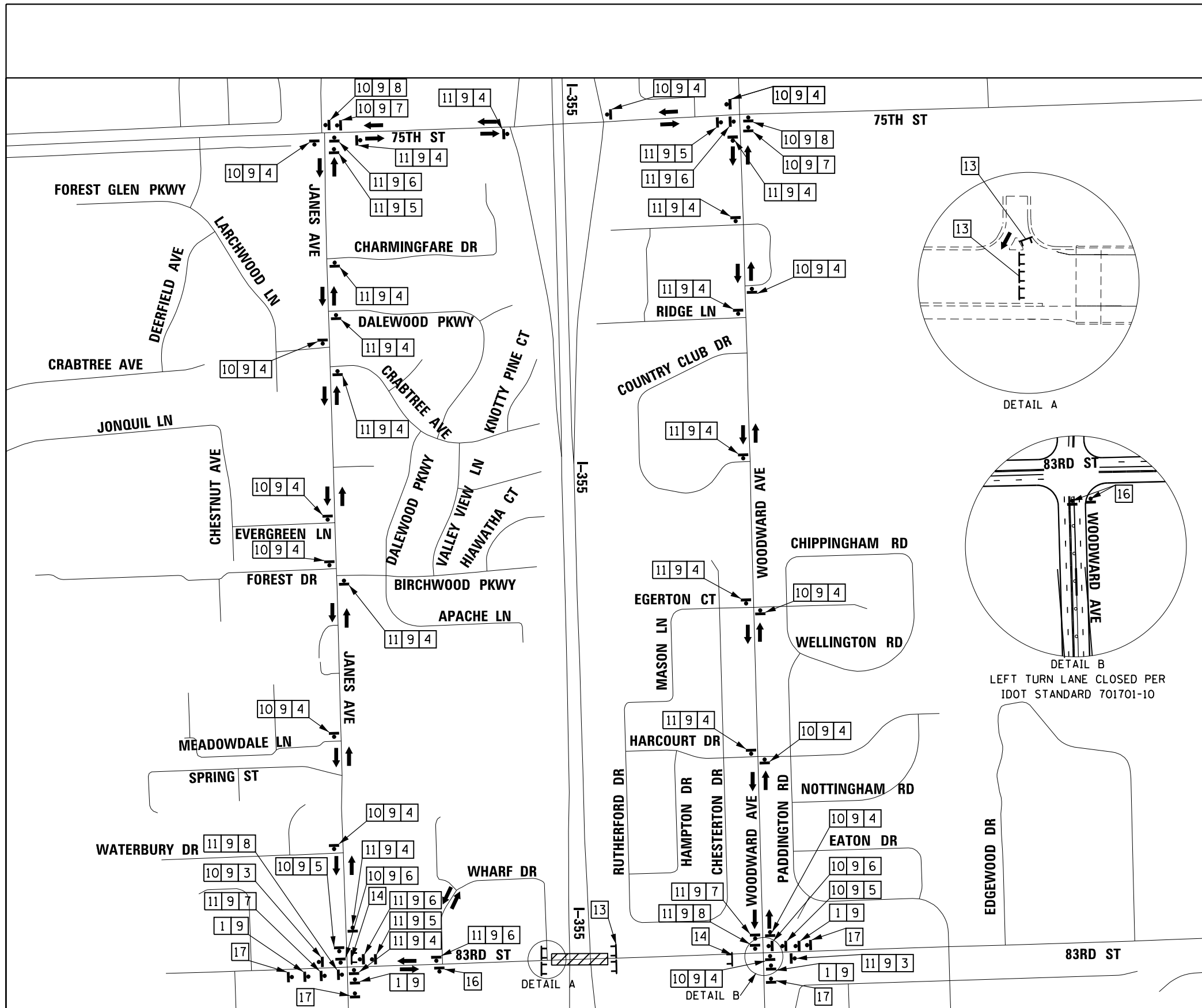

SIGN NUMBER	SIGN TYPE	WEST	EAST
1	DETOUR AHEAD	W20-2 (0) 48	10 M3-4 (0) 2412
2	ROAD CONSTRUCTION AHEAD	W20-1103 (0) 48	11 M3-2 (0) 2412
3	END DETOUR	M4-8a (0) 2412	13 BRIDGE CLOSED R11-2 48X30
4	DETOUR (UP)	M6-3 2115	14 BRIDGE CLOSED LOCAL TRAFFIC ONLY R11-3a 60X30
5	DETOUR (RIGHT)	M5-1R 2115	15 R3-1 2424
6	DETOUR (LEFT)	M6-1R 2115	16 R3-2 2424
7	DETOUR (LEFT)	M5-1L 2115	17 ROAD CLOSED AHEAD W20-3 (0) 48
8	DETOUR (LEFT)	M6-1L 2115	
9	83RD ST	SPECIAL SIGN(S): BLACK LEGEND ORANGE BACKGROUND (RETROREFLECTIVE) 6" C-SERIES TEXT 8" X 30"	

TYPICAL LAYOUT OF SIGNS

LEGEND

- DETOUR SIGN, NUMBER DENOTES TYPE
- TYPE III BARRICADE WITH AMBER FLASHING LIGHTS
- DETOUR ROUTE
- WORK ZONE

- NOTES:**
- THERE SHALL BE FOUR CHANGEABLE MESSAGE SIGNS AVAILABLE FOR RESIDENT ENGINEER TO OPERATE DETOUR PLAN
 - SPACING OF SIGNS SHALL BE SET AT 200' STARTING FROM THE CENTER OF THE INTERSECTION
 - CLOSE SIDEWALKS AND BIKE PATH AT WOODWARD AVENUE AND JANES AVENUE PER HWY STANDARD 701801



USER NAME = cfisus	DESIGNED - BMS	REVISED -
PLOT SCALE = 2.0000' / in.	DRAWN -	REVISED -
PLOT DATE = 3/29/2019	CHECKED - JDH	REVISED -
	DATE -	REVISED -

**STATE OF ILLINOIS
DEPARTMENT OF TRANSPORTATION**

DETOUR PLAN

SCALE: SHEET 1 OF 1 SHEETS STA. TO STA.

F.A.U. RTE.	SECTION	COUNTY	TOTAL SHEETS	SHEET NO.
1551	17-00079-00-BR	DUPAGE	16	9
CONTRACT NO. 61F83				

ILLINOIS FED. AID PROJECT

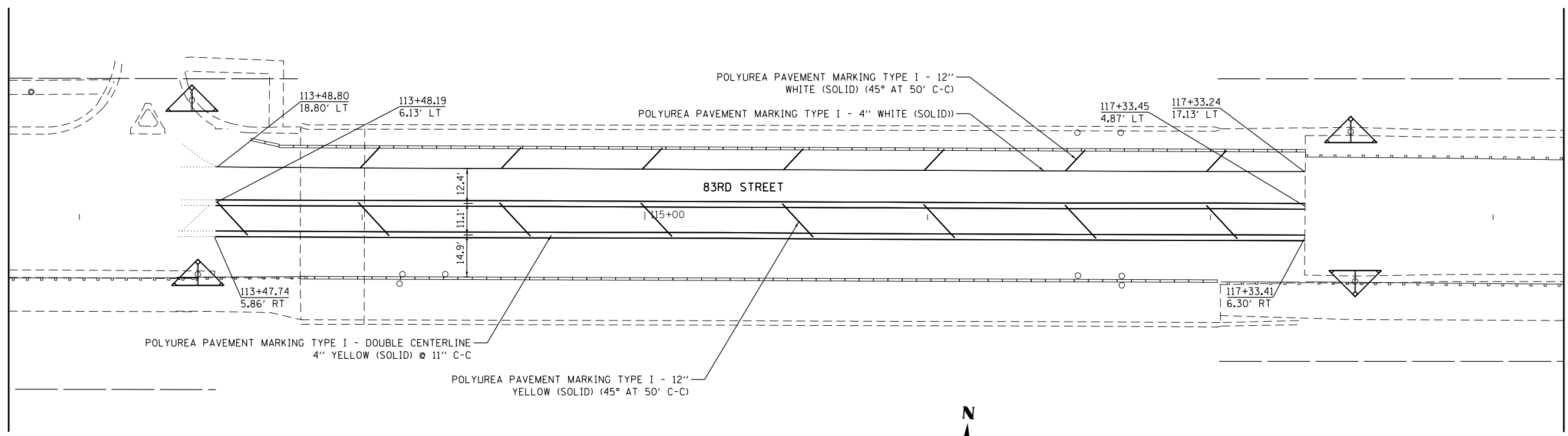

POLYUREA PAVEMENT MARKING TYPE I - DOUBLE CENTERLINE
4" YELLOW (SOLID) @ 11" C-C

POLYUREA PAVEMENT MARKING TYPE I - 12"
YELLOW (SOLID) (45° AT 50' C-C)

POLYUREA PAVEMENT MARKING TYPE I - 12"
WHITE (SOLID) (45° AT 50' C-C)

POLYUREA PAVEMENT MARKING TYPE I - 4" WHITE (SOLID)

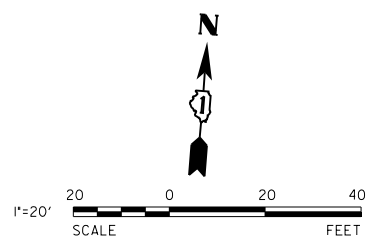

LANDSCAPE LEGEND

INLET FILTER

V3 Companies
7325 Janes Avenue
Woodridge, IL 60517
630.724.9200 phone
630.724.9202 fax
www.v3co.com

USER NAME = cfisus	DESIGNED - BMS	REVISED -
PLOT SCALE = 40.0000' / in.	DRAWN -	REVISED -
PLOT DATE = 3/29/2019	CHECKED - JDH	REVISED -
	DATE -	REVISED -

**STATE OF ILLINOIS
DEPARTMENT OF TRANSPORTATION**

**PAVEMENT MARKING AND
LANDSCAPING PLAN**

SCALE: 1" = 20' SHEET 1 OF 1 SHEETS STA. 113+00.00 TO STA. 118+00.00

F.A.U. RTE.	SECTION	COUNTY	TOTAL SHEETS	SHEET NO.
1551	17-00079-00-BR	DUPAGE	16	10
				CONTRACT NO. 61F83
ILLINOIS FED. AID PROJECT				

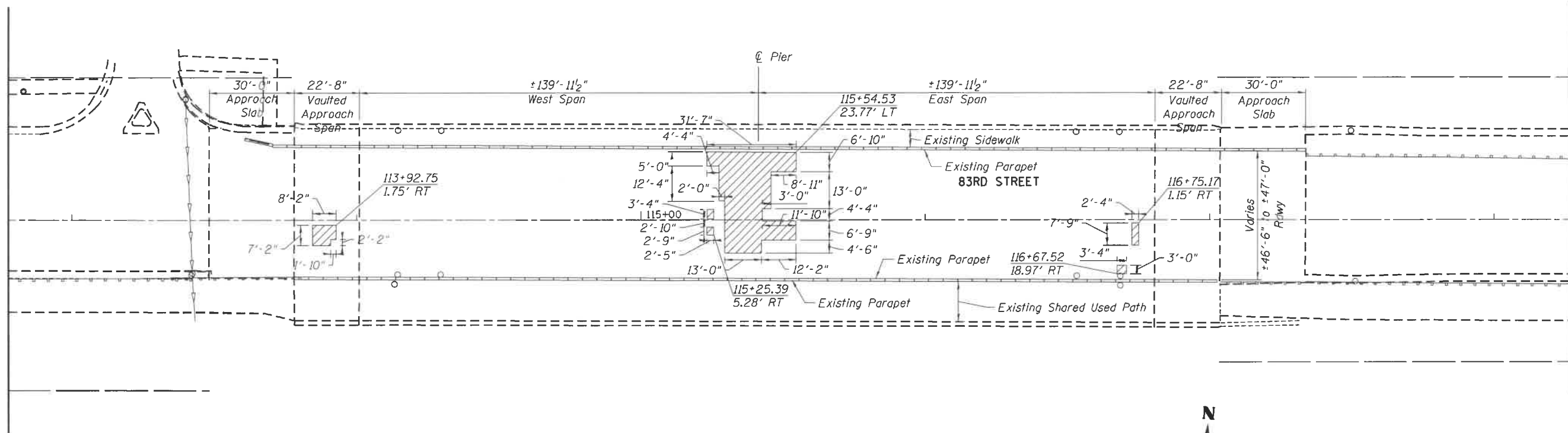

NOTES:

1. THE LOCATIONS OF THE PARTIAL DEPTH PATCHING THAT ARE SHOWN IN THIS PLAN IS FOR INFORMATIONAL USE ONLY. PER THE IDOT SPECIFICATIONS FOR A DECK OVERLAY LIKE THIS, THE QUANTITIES FOR THE ADDITIONAL MATERIAL TO FILL THE PATCH IS INCLUDED WITH THE OVERLAY MATERIAL.

PLAN VIEW
 83RD STREET OVER I-355
 SN 022-9986
 NTS

STRUCTURAL LEGEND

 POSSIBLE DECK PATCHING AREAS



V3 Companies
 7325 Jones Avenue
 Woodridge, IL 60517
 830.724.8200 phone
 830.724.8202 fax
 www.v3co.com

USER NAME : jholy	DESIGNED - BMS	REVISED -
PLOT SCALE = 40,0000' / in.	DRAWN -	REVISED -
PLOT DATE = 4/11/2019	CHECKED - JDH	REVISED -
	DATE -	REVISED -

STATE OF ILLINOIS
DEPARTMENT OF TRANSPORTATION

STRUCTURAL PLAN

SCALE: SHEET 1 OF 3 SHEETS STA. TO STA.

F.A.I. RTE.	SECTION	COUNTY	TOTAL SHEETS	SHEET NO.
1551	17-00079-00-BR	DUPAGE	16	11
CONTRACT NO. 61F83				
ILLINOIS FED. AID PROJECT				

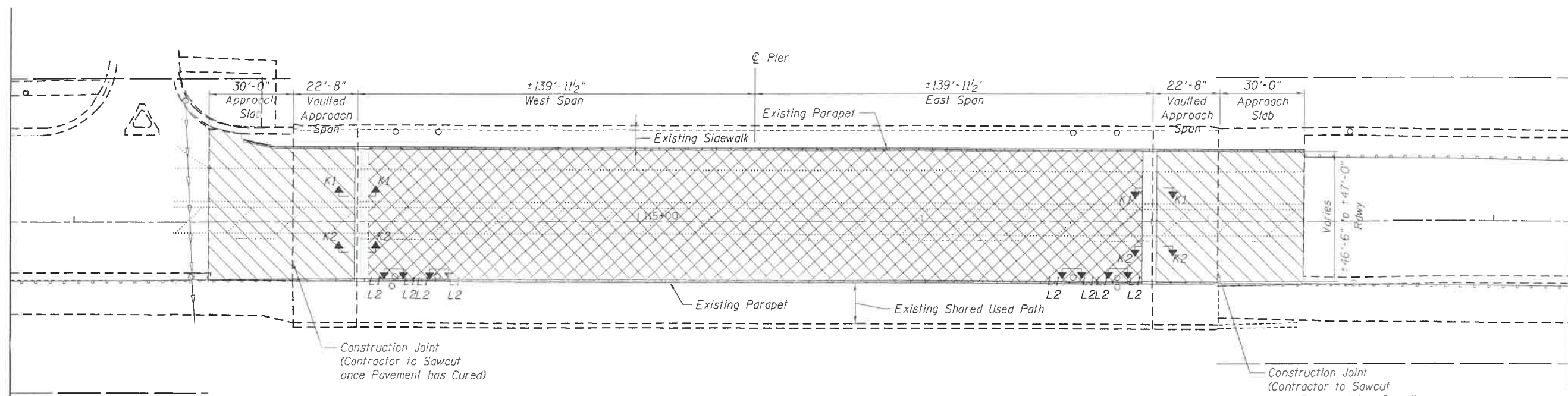

BILL OF MATERIAL

ITEM	UNIT	TOTAL
Bridge Deck Scarification 3/4"	Sq.Yd.	1402
Bridge Deck Scarification 1 1/2"	Sq.Yd.	542
Bridge Deck Scarification, Variable Depth	Sq.Yd.	31
Bridge Deck Latex Concrete Overlay 1 1/2"	Sq.Yd.	1975
Bridge Deck Grooving	Sq.Yd.	1975

PLAN VIEW
 83RD STREET OVER I-355
 SN 022-9986
 NTS

STRUCTURAL LEGEND

- 3/4" BRIDGE DECK SCARIFICATION
- 1 1/2" BRIDGE DECK LATEX CONCRETE OVERLAY AREA
- 1 1/2" BRIDGE DECK SCARIFICATION
- 1 1/2" BRIDGE DECK LATEX CONCRETE OVERLAY AREA
- BRIDGE DECK SCARIFICATION VARIABLE DEPTH
- 1 1/2" BRIDGE DECK LATEX CONCRETE OVERLAY AREA

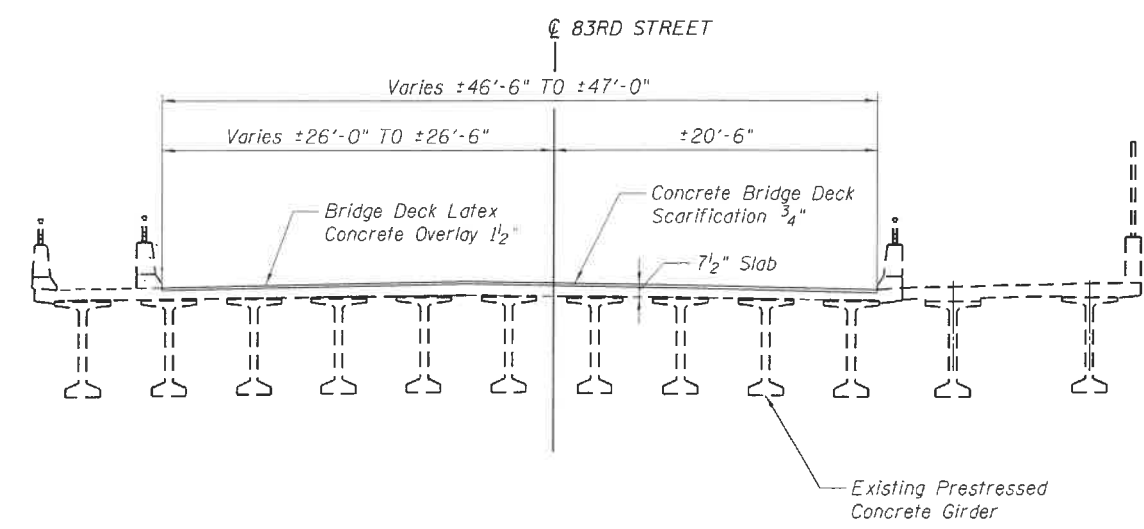

CROSS SECTION
 83RD STREET OVER I-355
 SN 022-9986
 NTS
 (Looking East)

STATE OF ILLINOIS
 CHRISTOPHER J. BURKE
 081-005134
 REGISTERED STRUCTURAL ENGINEER
 Exp. 11/30/2020
 Date 4/11/19

"I certify that to the best of my knowledge, information and belief, this bridge/box culvert design is structurally adequate for the design loading shown on the plans. The design is an economical one for the style of structure and complies with requirements of the current 'AASHTO Standard Specifications of Highway Bridges'."

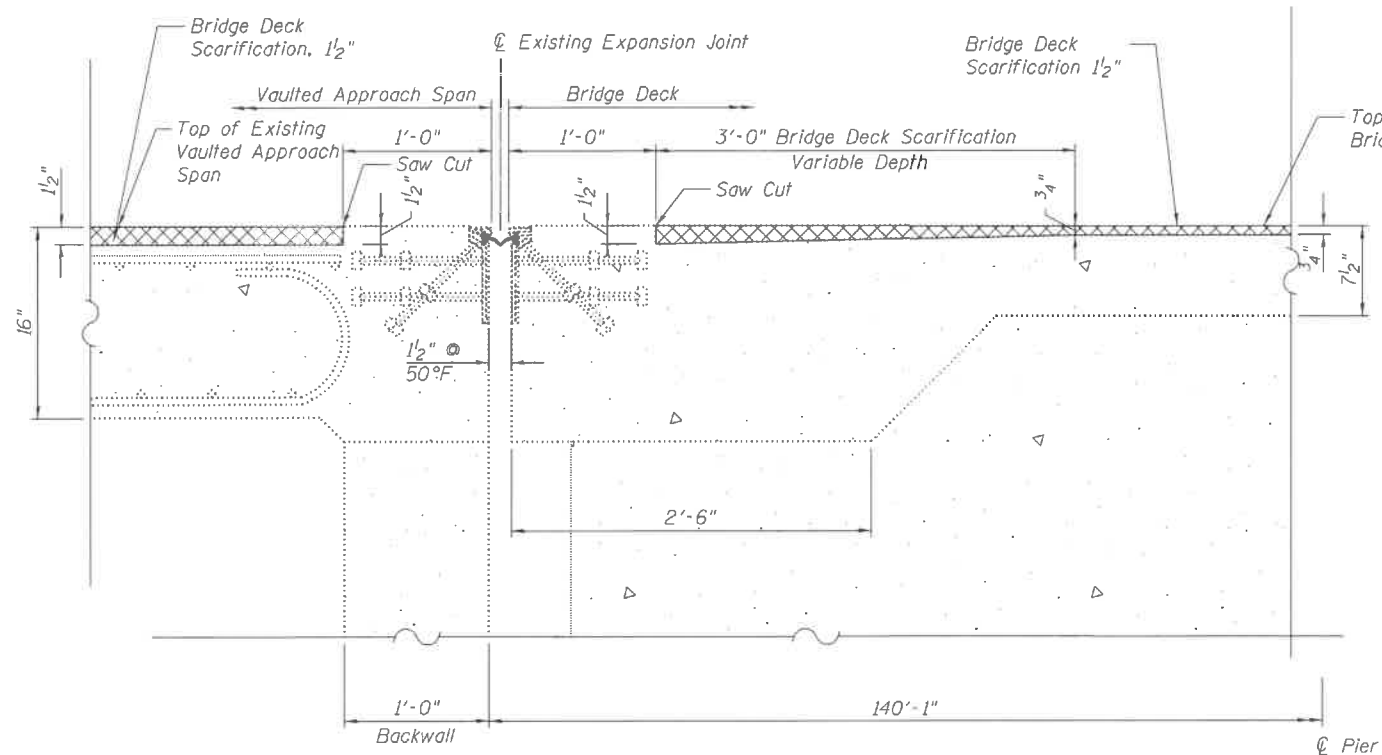

Note: Existing reinforcement not shown.

SECTION K1-K1
(Existing)

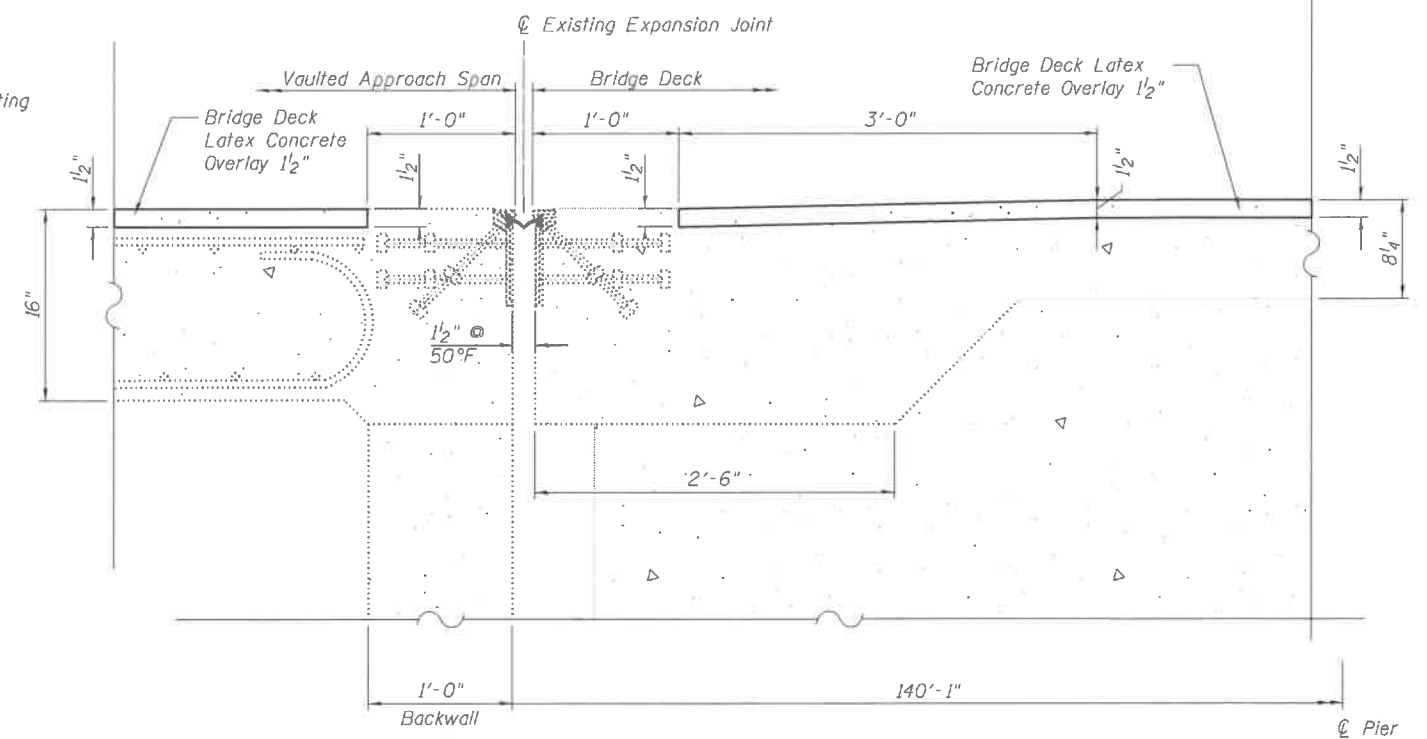

Note: Existing reinforcement not shown.

SECTION K2-K2
(Proposed)

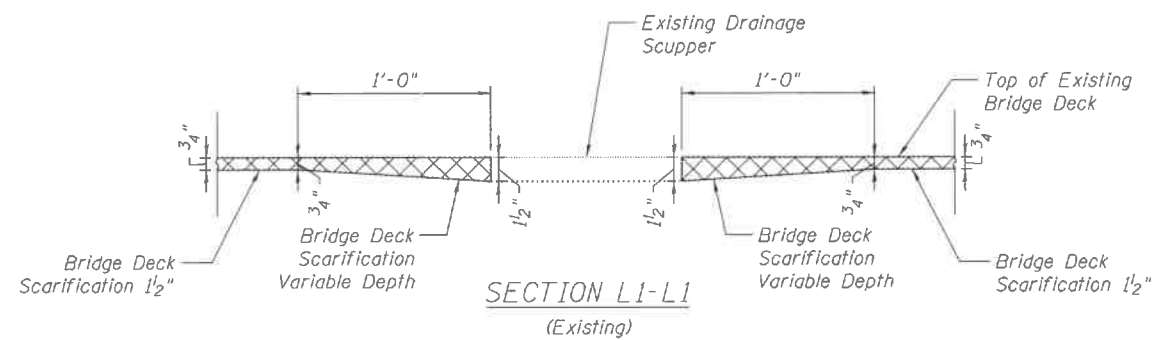

SECTION L1-L1
(Existing)

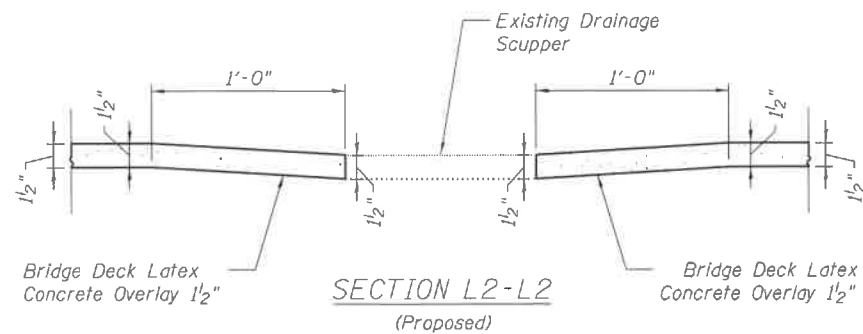

SECTION L2-L2
(Proposed)

GENERAL NOTES

Plan dimensions and details relative to existing structure have been taken from existing plans and are subject to nominal construction variations. It shall be the contractor's responsibility to verify such dimensions and details in the field and make necessary approved adjustments prior to construction or ordering of materials. Such variation shall not be cause for additional compensation for change in the scope of work, however, the Contractor will be paid for the quantity actually furnished at the unit price for the work.

All saw cuts performed during the construction process will not be paid for separately, but shall be included in the cost of the removal item adjacent to the saw cut.

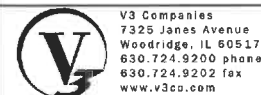
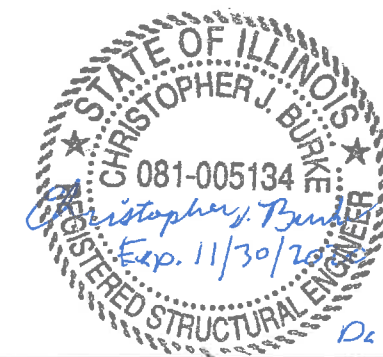

V3 Companies
7325 Janes Avenue
Woodridge, IL 60517
630.724.9200 phone
630.724.9202 fax
www.v3co.com

USER NAME = cfigus
PLOT SCALE = 40.0000' / in.
PLOT DATE = 3/29/2019

DESIGNED - BMS
DRAWN -
CHECKED - JDH
DATE -

REVISED -
REVISED -
REVISED -
REVISED -

**STATE OF ILLINOIS
DEPARTMENT OF TRANSPORTATION**

STRUCTURAL DETAILS

SCALE: SHEET 3 OF 3 SHEETS STA. TO STA.

F.A.U. RTE.	SECTION	COUNTY	TOTAL SHEETS	SHEET NO.
1551	17-00079-00-BR	DUPAGE	16	13
				CONTRACT NO. 61F83
ILLINOIS FED. AID PROJECT				

VARIABLE - TO MEET EXISTING DIMENSIONS AND FIELD CONDITIONS (SEE NOTE ②)

PROP. CONC. CURB OR CURB AND GUTTER REPLACEMENT IN ACCORDANCE WITH STATE STANDARD 606001. (SEE NOTE ②)

SAW CUT FULL DEPTH - INCLUDED IN THE COST OF SIDEWALK, DRIVEWAY OR MEDIAN SURFACE REMOVAL PAY ITEM.

SEE STATE STANDARD 606001
EXISTING OR PROPOSED HMA SURFACE (IF APPLICABLE)

18" (450) MAX.

1/4" (5) **

EXISTING SIDEWALK, DRIVEWAY, MEDIAN SURFACE, SOD OR GROUND.

PROPOSED SIDEWALK, DRIVEWAY PAVEMENT, MEDIAN SURFACE OR SODDING SALT TOLERANT WITH TOP SOIL, 4" (100) SOD RESTORATION (SEE NOTE ①).

EXISTING CONCRETE PAVEMENT, CONCRETE BASE COURSE OR FLEXIBLE PAVEMENT

3" (75) MIN.

SUITABLE BACKFILL MATERIAL (INCLUDED IN THE COST OF CURB OR CURB AND GUTTER REMOVAL AND REPLACEMENT)

PROPOSED 3/4" (20) PREFORMED EXPANSION JOINT AT CONCRETE SIDEWALKS, DRIVEWAYS, AND MEDIANS. (INCLUDED IN THE COST OF CURB OR CURB AND GUTTER REMOVAL AND REPLACEMENT.)

UNSUITABLE SUB-BASE MATERIAL TO BE REMOVED, IF DIRECTED BY THE ENGINEER, SHALL BE REPLACED WITH EITHER SUB-BASE GRANULAR MATERIAL, TYPE B OR ADDITIONAL THICKNESS OF CONCRETE.

REMOVAL AND REPLACEMENT 4" (100) OR LESS IS INCLUDED IN THE COST OF CURB OR CURB AND GUTTER REMOVAL AND REPLACEMENT.

REMOVAL AND REPLACEMENT IN EXCESS OF 4" (100) WILL BE PAID FOR IN ACCORDANCE WITH ARTICLE 109.04 OF THE STANDARD SPECIFICATIONS.

PROPOSED #6 (20) EPOXY COATED TIE BARS 24" (600) LONG AT 24" (600) CENTERS WILL NOT BE PAID FOR SEPARATELY. DELETE EPOXY COATED TIE BARS IF EXISTING TIE BARS ARE USABLE AS DETERMINED BY THE ENGINEER. (SEE NOTE ③).

BASIS OF PAYMENT:
THIS WORK WILL BE PAID FOR AT THE CONTRACT UNIT PRICE PER FOOT (METER) FOR "CURB REMOVAL AND REPLACEMENT" OR "COMBINATION CONCRETE CURB AND GUTTER REMOVAL AND REPLACEMENT".

- * 3" (75) MINIMUM FROM TOP AND BOTTOM OF THE CONCRETE PAVEMENT OR BASE COURSE.
- ** IF THE FINAL SURFACE OF THE PAVEMENT IS CONCRETE, THE GUTTER IS TO BE FLUSH WITH THE PAVEMENT.

NOTE: ① SIDEWALK, DRIVEWAY PAVEMENT OR MEDIAN SURFACE SHALL BE SIMILAR TO THE MATERIAL BEING REMOVED AND WILL BE PAID FOR SEPARATELY.

SODDING, SALT TOLERANT AND TOP SOIL, FURNISH AND PLACE 4" WILL BE PAID FOR SEPARATELY.

- ② FERTILIZER FOR THE PLACEMENT OF THE SOD IS NOT REQUIRED
- ③ CURB OR CURB AND GUTTER REPLACEMENT SHALL MATCH THE SHAPE OF THE EXISTING CURB OR CURB AND GUTTER UNLESS OTHERWISE SPECIFIED.
- ④ FOR CURB OR CURB AND GUTTER REMOVAL AND REPLACEMENT ADJACENT TO FLEXIBLE PAVEMENT DELETE EPOXY COATED TIE BARS.
- ⑤ LONGITUDINAL BARS, IF ENCOUNTERED IN THE EXISTING CURB OR CURB AND GUTTER, ARE NOT TO BE REPLACED. CUTTING AND REMOVING LONGITUDINAL BARS SHALL BE INCLUDED IN THE COST OF CURB OR CURB AND GUTTER REMOVAL AND REPLACEMENT.
- ⑥ THE COST OF HMA SURFACE REMOVAL IN THE EXISTING GUTTER FLAG SHALL BE INCLUDED IN THE COST OF THE CURB AND GUTTER REMOVAL AND REPLACEMENT.
- ⑦ THE REMOVAL AND REPLACEMENT OF THE EXISTING CURB OR CURB AND GUTTER SHALL BE DONE IN ACCORDANCE WITH THE APPLICABLE PORTIONS OF SECTION 440 AND 606 OF THE STANDARD SPECIFICATIONS.
- ⑧ THE LOCATIONS OF REMOVAL AND REPLACEMENT OF EXISTING CURB OR CURB AND GUTTER SHALL BE DETERMINED BY THE RESIDENT ENGINEER AT THE TIME OF CONSTRUCTION.

CURB OR CURB AND GUTTER REMOVAL AND REPLACEMENT

ALL DIMENSIONS ARE IN INCHES (MILLIMETERS) UNLESS OTHERWISE SHOWN.

FILE NAME =	USER NAME = drivakosgn	DESIGNED - A. HOUSEH	REVISED - R. SHAH 10-03-96	STATE OF ILLINOIS DEPARTMENT OF TRANSPORTATION	CURB OR CURB AND GUTTER REMOVAL AND REPLACEMENT	F.A. RTE.	SECTION	COUNTY	TOTAL SHEETS	SHEET NO.	
ei:\pwork\pwi\dot\drivakosgn\d0108315\bc24.dgn	DRAWN -	REVISED - A. ABBAS 03-21-97	REVISED - M. GOMEZ 01-22-01			1551	17-00079-00-BR	DUPAGE	16	14	
PLOT SCALE = 50,000' / IN.	CHECKED -	REVISED - M. GOMEZ 01-22-01	REVISED - R. BORO 12-15-09			BD600-06 (BD-24)		CONTRACT NO. 61F83			
PLOT DATE = 12/15/2009	DATE - 03-11-94	REVISED - R. BORO 12-15-09	SCALE: NONE			SHEET NO. 1 OF 1 SHEETS	STA.	TO STA.		FED. ROAD DIST. NO. 1 ILLINOIS FED. AID PROJECT	

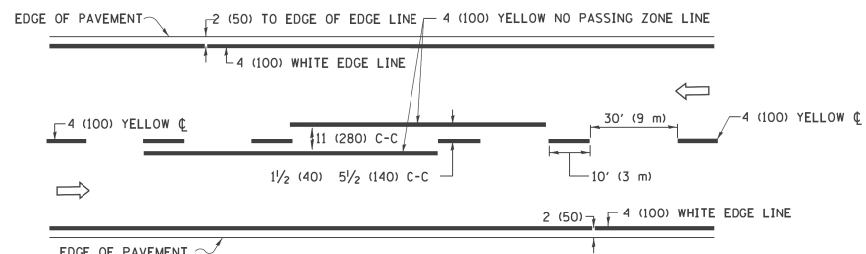

2-LANE ROADWAY

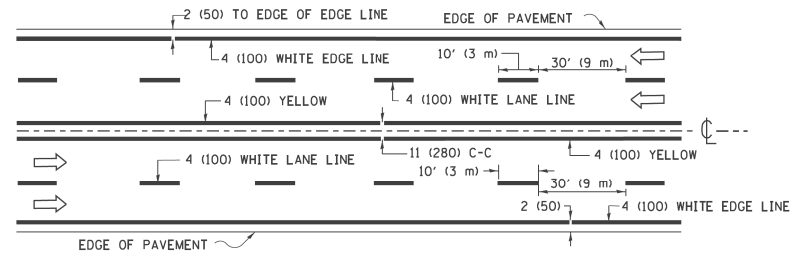

MULTI-LANE UNDIVIDED

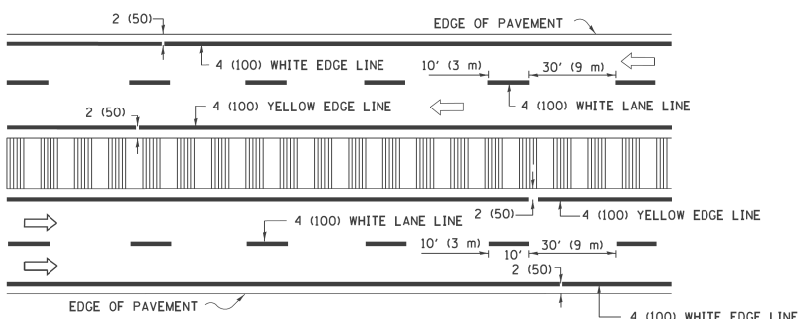

MULTI-LANE DIVIDED WITH MEDIAN

TYPICAL LANE AND EDGE LINE MARKING

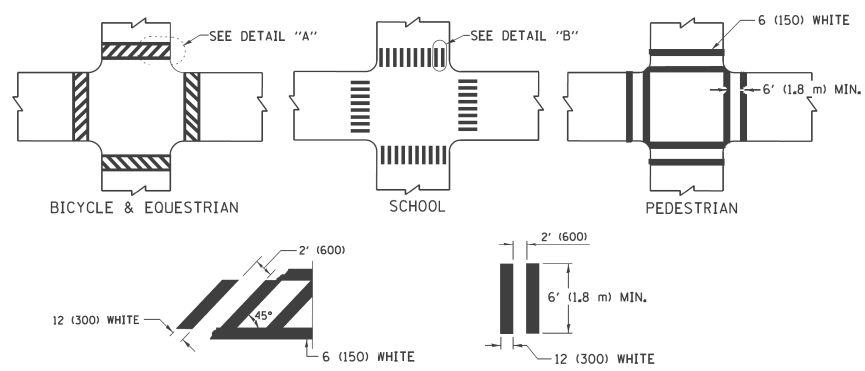

DETAIL "A"

DETAIL "B"

TYPICAL CROSSWALK MARKING

* MARKINGS SHALL BE INSTALLED PARALLEL TO THE CENTERLINE OF THE ROAD WHICH IT CROSSES

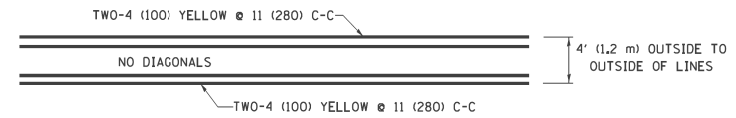

4' (1.2 m) WIDE MEDIANS ONLY

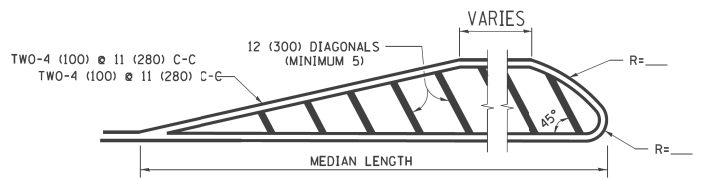

FOR MEDIAN LENGTHS WHERE DIAGONAL SPACING CANNOT BE ATTAINED, USE 5 (FIVE) EQUALLY SPACED DIAGONAL LINES.

DIAGONAL LINE SPACING: 50' (15 m) C-C (LESS THAN 30MPH (50 km/h))
75' (25 m) C-C 30MPH (50 km/h) TO 45MPH (70 km/h)
150' (45 m) C-C (MORE THAN 45MPH (70 km/h))

MEDIANS OVER 4' (1.2 m) WIDE

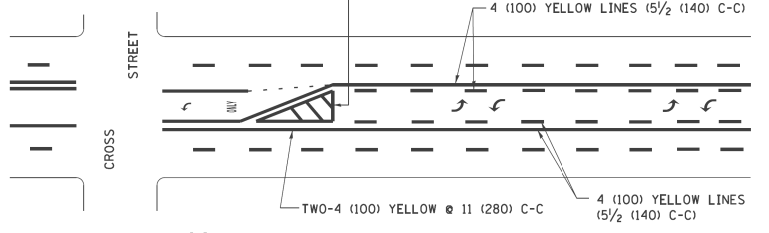

A MINIMUM OF TWO PAIRS OF TURN ARROWS SHALL BE USED, WHITE IN COLOR. ADDITIONAL PAIRS SHALL BE PLACED AT 200' (60 m) TO 300' (90 m) INTERVALS.

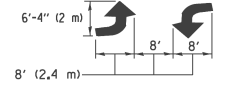

MEDIAN WITH TWO-WAY LEFT TURN LANE

TYPICAL PAINTED MEDIAN MARKING

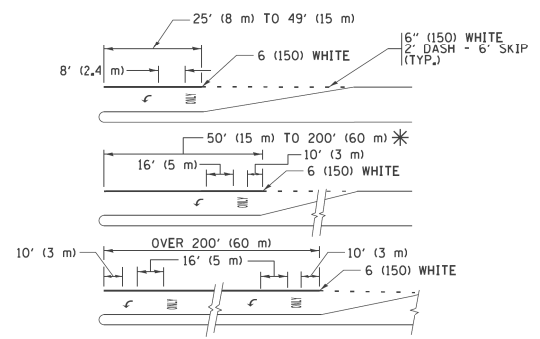

FULL SIZE LETTERS 8' (2.4 m) AND ARROWS SHALL BE USED. * AREA = 15.6 SQ. FT. (1.5 m²) ONLY AREA = 20.8 SQ. FT. (1.9 m²)

* TURN LANES IN EXCESS OF 400' (120 m) IN LENGTH MAY HAVE AN ADDITIONAL SET OF ARROW - "ONLY" INSTALLED MIDWAY BETWEEN THE OTHER TWO SETS OF ARROW - "ONLY".

TYPICAL LEFT (OR RIGHT) TURN LANE

TYPICAL TURN LANE MARKING

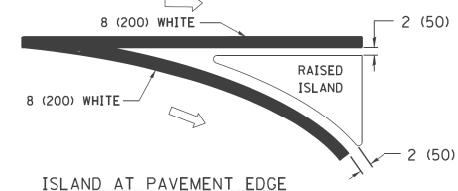
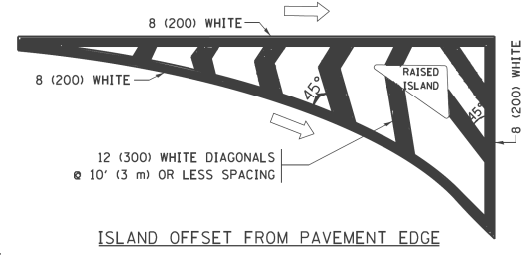

TYPICAL ISLAND MARKING

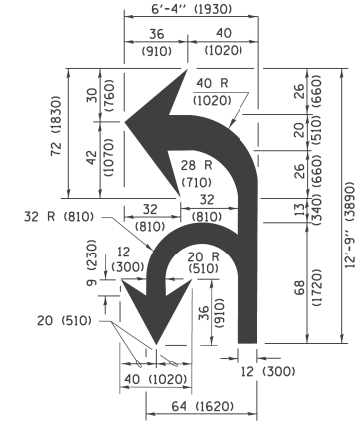

COMBINATION LEFT AND U-TURN

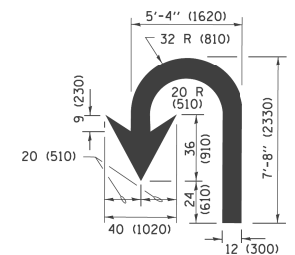

U-TURN

LANE REDUCTION TRANSITION

* LANE REDUCTION ARROWS REQUIRED AT SPEEDS OF 45 MPH OR GREATER OR WHEN SPECIFIED IN PLANS.

D(FT)	SPEED LIMIT
345	30
425	35
500	40
580	45
665	50
750	55

TYPE OF MARKING	WIDTH OF LINE	PATTERN	COLOR	SPACING /REMARKS
CENTERLINE ON 2 LANE PAVEMENT	4 (100)	SKIP-DASH	YELLOW	10' (3 m) LINE WITH 30' (9 m) SPACE
CENTERLINE ON MULTI-LANE UNDIVIDED PAVEMENT	2 @ 4 (100)	SOLID	YELLOW	11 (280) C-C
NO PASSING ZONE LINES FOR ONE DIRECTION FOR BOTH DIRECTIONS	4 (100) 2 @ 4 (100)	SOLID SOLID	YELLOW YELLOW	5 1/2 (140) C-C FROM SKIP-DASH CENTERLINE 11 (280) C-C OMIT SKIP-DASH CENTERLINE BETWEEN
LANE LINES	4 (100) 5 (125) ON FREEWAYS	SKIP-DASH SKIP-DASH	WHITE WHITE	10' (3 m) LINE WITH 30' (9 m) SPACE
DOTTED LINES (EXTENSIONS OF CENTER, LANE OR TURN LANE MARKINGS)	SAME AS LINE BEING EXTENDED	SKIP-DASH	SAME AS LINE BEING EXTENDED	2' (600) LINE WITH 6' (1.8 m) SPACE
EDGE LINES	4 (100)	SOLID	YELLOW-LEFT WHITE-RIGHT	OUTLINE MEDIANS IN YELLOW
TURN LANE MARKINGS	6 (150) LINE; FULL SIZE LETTERS & SYMBOLS (8' (2.4m))	SOLID	WHITE	SEE TYPICAL TURN LANE MARKING DETAIL
TWO WAY LEFT TURN MARKING	2 @ 4 (100) EACH DIRECTION 8' (2.4m) LEFT ARROW	SKIP-DASH AND SOLID IN PAIRS	YELLOW WHITE	10' (3 m) LINE WITH 30' (9 m) SPACE FOR SKIP-DASH 5 1/2 (140) C-C BETWEEN SOLID LINE AND SKIP-DASH LINE SEE TYPICAL TWO-WAY LEFT TURN MARKING DETAIL
CROSSWALK LINES (PEDESTRIAN) A. DIAGONALS (BIKE & EQUESTRIAN) B. LONGITUDINAL BARS (SCHOOL)	2 @ 6 (150) 12 (300) @ 45° 12 (300) @ 90°	SOLID SOLID SOLID	WHITE WHITE WHITE	NOT LESS THAN 6' (1.8 m) APART 2' (600) APART 2' (600) APART SEE TYPICAL CROSSWALK MARKING DETAILS.
STOP LINES	24 (600)	SOLID	WHITE	PLACE 4' (1.2 m) IN ADVANCE OF AND PARALLEL TO CROSSWALK, IF PRESENT, OTHERWISE, PLACE AT DESIRED STOPPING POINT, PARALLEL TO CROSSROAD CENTERLINE, WHERE POSSIBLE.
PAINTED MEDIANS	2 @ 4 (100) WITH 12 (300) DIAGONALS @ 45° NO DIAGONALS USED FOR 4' (1.2 m) WIDE MEDIANS	SOLID	YELLOW; TWO WAY TRAFFIC WHITE; ONE WAY TRAFFIC	11 (280) C-C FOR THE DOUBLE LINE SEE TYPICAL PAINTED MEDIAN MARKING.
GORE MARKING AND CHANNELIZING LINES	8 (200) WITH 12 (300) DIAGONALS @ 45°	SOLID	WHITE	DIAGONALS: 15' (4.5 m) C-C (LESS THAN 30MPH (50 km/h)) 20' (6 m) C-C 30MPH (50 km/h) TO 45MPH (70 km/h) 30' (9 m) C-C (OVER 45MPH (70 km/h))
RAILROAD CROSSING	24 (600) TRANSVERSE LINES; "RR" IS 6' (1.8 m) LETTERS; 16 (400) LINE FOR "X"	SOLID	WHITE	SEE STATE STANDARD 780001 AREA OF: "R"=3.6 SQ. FT. (0.33 m ²) EACH "X"=54.0 SQ. FT. (5.0 m ²)
SHOULDER DIAGONALS (REQUIRED FOR SHOULDERS ≥ 8')	12 (300) @ 45°	SOLID	WHITE - RIGHT YELLOW - LEFT	50' (15 m) C-C (LESS THAN 30MPH (50 km/h)) 75' (25 m) C-C 30 MPH (50 km/h) TO 45MPH (70 km/h) 150' (45 m) C-C (OVER 45MPH (70 km/h))
U TURN ARROW	SEE DETAIL	SOLID	WHITE	16.3 SF
2 ARROW COMBINATION LEFT AND U TURN	SEE DETAIL	SOLID	WHITE	30.4 SF

FOR FURTHER DETAILS ON PAVEMENT MARKING REFER TO STANDARD SPECIFICATIONS FOR ROAD AND BRIDGE CONSTRUCTION AND STATE STANDARD 780001.

All dimensions are in inches (millimeters) unless otherwise shown.

FILE NAME =	USER NAME = lryso	DESIGNED - EVERS	REVISED - C. JUCIUS 09-09-09
W:\dststd\22x34\to13.dgn		DRAWN -	REVISED - C. JUCIUS 07-01-13
Default	PLOT SCALE = 50.000' / in.	CHECKED -	REVISED - C. JUCIUS 12-21-15
	PLOT DATE = 6/23/2017	DATE - 03-19-90	REVISED - C. JUCIUS 04-12-16

**STATE OF ILLINOIS
DEPARTMENT OF TRANSPORTATION**

**DISTRICT ONE
TYPICAL PAVEMENT MARKINGS**

SCALE: NONE SHEET 1 OF 1 SHEETS STA. TO STA.

F.A. RTE.	SECTION	COUNTY	TOTAL SHEETS	SHEET NO.
1551	17-00079-00-BR	DUPAGE	16	15
TC-13			CONTRACT NO. 61F83	
ILLINOIS FED. AID PROJECT				

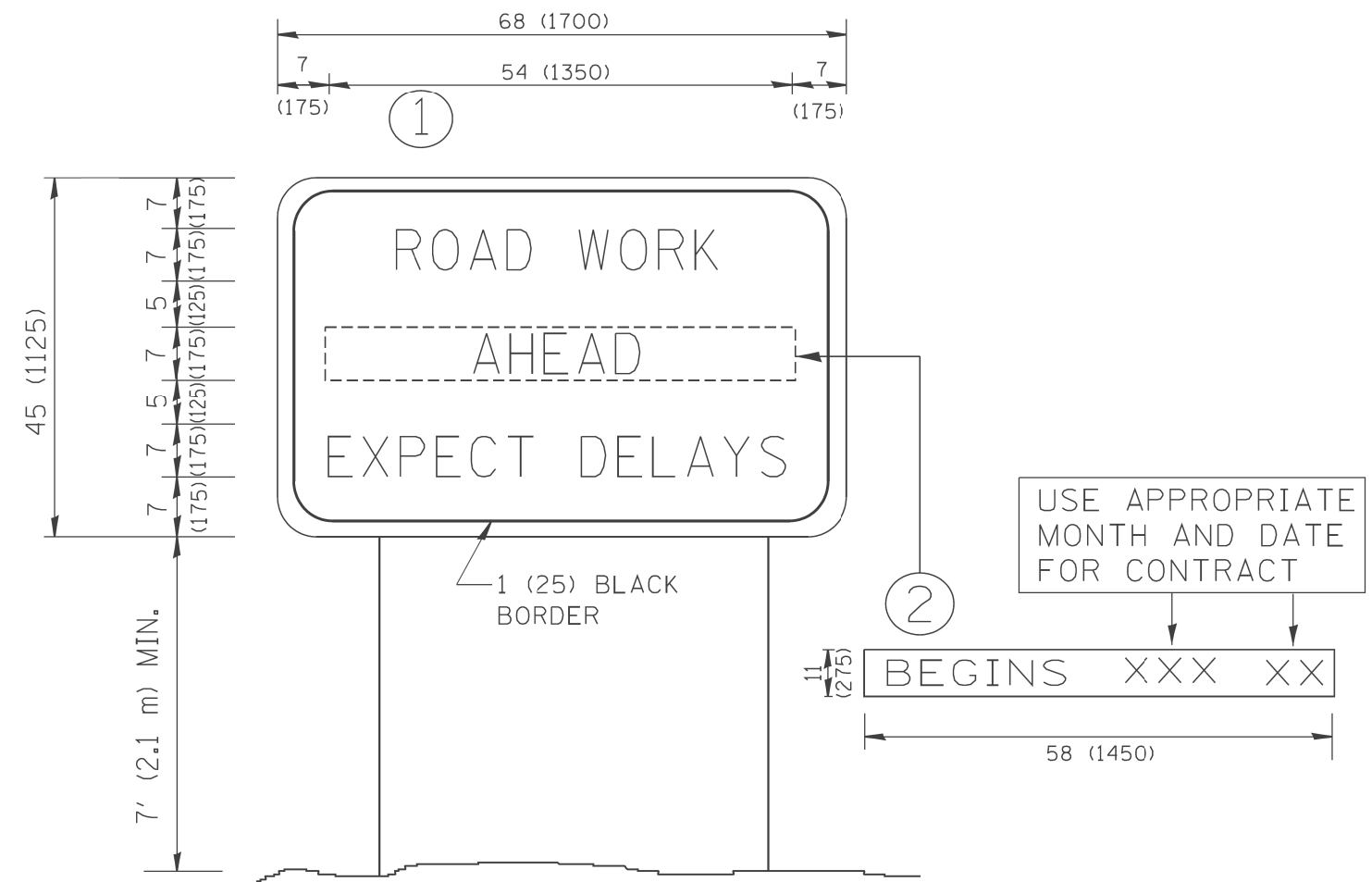

NOTES:

1. USE BLACK LETTERING ON ORANGE BACKGROUND.
2. ERECT SIGNS IN ADVANCE OF THE LOCATION FOR THE "ROAD CONSTRUCTION AHEAD" SIGN AT LOCATIONS AS DIRECTED BY THE ENGINEER.
3. ERECT SIGN ① WITH INSTALLED PANEL ② ONE WEEK PRIOR TO THE START OF CONSTRUCTION.
4. REMOVE PANEL ② SOON AFTER THE START OF CONSTRUCTION.
5. SEE SPECIAL PROVISION FOR "TEMPORARY INFORMATION SIGNING" FOR ADDITIONAL INFORMATION.
6. ONE SIGN ASSEMBLY EQUALS 25.70 SQ. FT. (2.3 SQ. M.)
7. SHALL BE PAID FOR AS TEMPORARY INFORMATION SIGNING.

ALL DIMENSIONS ARE IN INCHES (MILLIMETERS) UNLESS OTHERWISE SHOWN.

FILE NAME = W:\diststd\22x34\tc22.dgn	USER NAME = gegl1enobt	DESIGNED -	REVISED - R. MIRS 09-15-97
		DRAWN -	REVISED - R. MIRS 12-11-97
	PLOT SCALE = 50,000' / IN.	CHECKED -	REVISED - T. RAMMACHER 02-02-99
	PLOT DATE = 1/4/2008	DATE -	REVISED - C. JUCIUS 01-31-07

**STATE OF ILLINOIS
DEPARTMENT OF TRANSPORTATION**

**ARTERIAL ROAD
INFORMATION SIGN**

SCALE: NONE SHEET NO. 1 OF 1 SHEETS STA. TO STA.

F.A. RTE.	SECTION	COUNTY	TOTAL SHEETS	SHEET NO.
1551	17-00079-00-BR	DUPAGE	16	16
TC-22			CONTRACT NO. 61F83	
FED. ROAD DIST. NO. 1 ILLINOIS FED. AID PROJECT				