

06-14-2019 LETTING ITEM 097

STATE OF ILLINOIS
DEPARTMENT OF TRANSPORTATION

PROPOSED HIGHWAY PLANS

ROUTE FAI 57, FAI 74 (I-57, I-74)
SECTION D5 POLLINATOR REHAB 2019-1
DOUGLAS, CHAMPAIGN COUNTY

1.0 MI N OF TUSCOLA TO 1.5 MI S OF CHAMPAIGN CO LINE
AT CURTIS RD. INTERCHANGE
AT LINCOLN AVE. INTERCHANGE

C-95-040-19

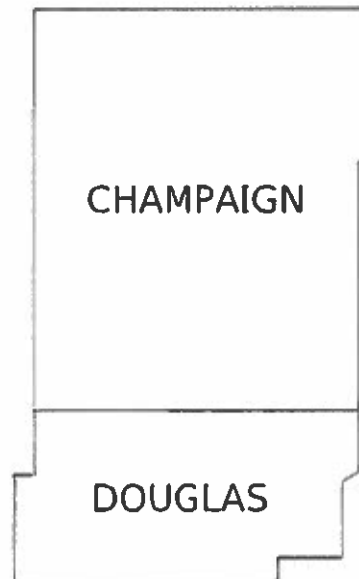

F.A.I. RTE.	SECTION	COUNTY	TOTAL SHEETS	SHEET NO.
57&74	D5 POLLINATOR REHAB 2019-1	DOUGLAS & CHAMPAIGN	12	1
ILLINOIS			CONTRACT NO. 70D90	

D-95-035-19

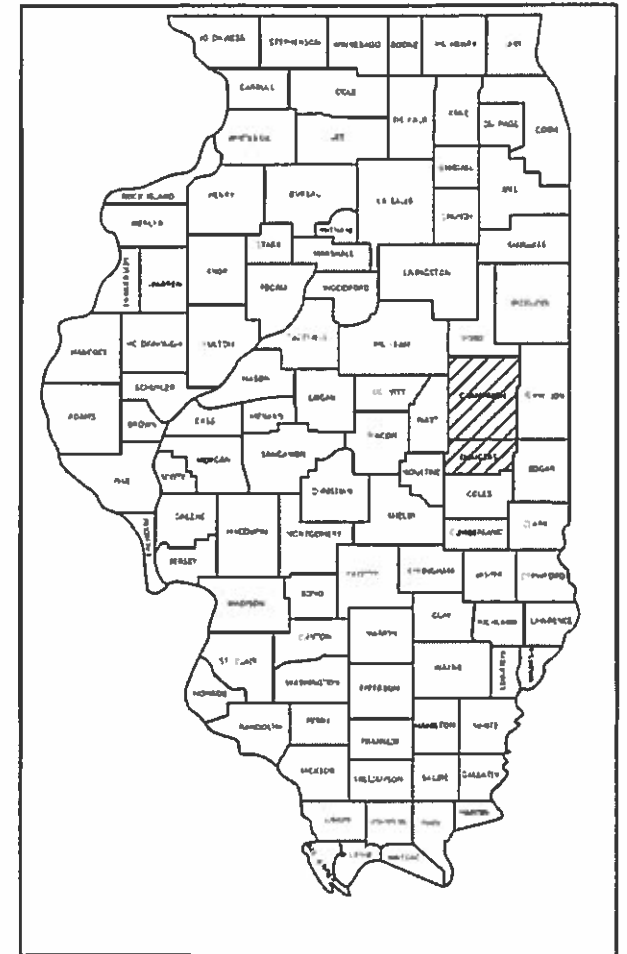

FOR INDEX OF SHEETS, SEE SHEET NO. 2
FOR LOCATION MAPS, SEE SHEET NO. 3
FOR SUMMARY OF QUANTITIES, SEE SHEET NO. 4



FULL SIZE PLANS HAVE BEEN PREPARED USING STANDARD ENGINEERING SCALES. REDUCED SIZED PLANS WILL NOT CONFORM TO STANDARD SCALES. IN MAKING MEASUREMENTS ON REDUCED PLANS, THE ABOVE SCALES MAY BE USED.

J.U.L.I.E.
JOINT UTILITY LOCATION INFORMATION FOR EXCAVATORS
1-800-892-0123
OR 811

PROJECT ENGINEER: JASON STULTS
PROJECT MANAGER: JOSEPH GRAZIANO
DESIGNERS: BRANDON SCHULTZ & XINYU SUN
PHONE NUMBER: (217)-465-4181
CONTRACT NO. 70D90

GROSS LENGTH = 22,702.61 FT. = 4.300 MILE
NET LENGTH = 21,376.59 FT. = 4.048 MILE

STATE OF ILLINOIS
DEPARTMENT OF TRANSPORTATION

SUBMITTED 03/20 2019
Kensha Barnett
REGIONAL ENGINEER

May 10 2019
E.A. ETK
ENGINEER OF DESIGN AND ENVIRONMENT

May 10 2019
DIRECTOR OF HIGHWAYS PROJECT IMPLEMENTATION

PRINTED BY THE AUTHORITY
OF THE STATE OF ILLINOIS

INDEX OF SHEETS

SHEET NO.	DESCRIPTION
1	COVER SHEET
2	INDEX OF SHEETS, HIGHWAY STANDARDS, and GENERAL NOTES
3	LOCATION MAPS
4	SUMARY OF QUANTITIES
5-8	SCHEDULE OF QUANTITIES
9-10	PLAN SHEETS
11-12	SIGN DETAILS

HIGHWAY STANDARDS

STANDARD	DESCRIPTION
000001-07	STANDARD SYMBOLS, ABBREVIATIONS AND PATTERNS
001006	DECIMAL OF AN INCH AND OF A FOOT
701101-05	OFF-RD OPERATIONS, MULTILANE, 15' (4.5m) TO 24" (600mm) FROM PAVEMENT EDGE
701106-02	OFF-RD OPERATIONS, MULTILANE, MORE THAN 15' (4.5) AWAY
701901-08	TRAFFIC CONTROL DEVICES
720001-01	SIGN PANEL MOUNTING DETAILS
720011-01	METAL POST FOR SIGNS, MARKERS & DELINEATORS
728001-01	TELESCOPING STEEL SIGN SUPPORT
729001-01	APPLICATIONS OF TYPES A & B METAL POSTS (FOR SIGNS & MARKERS)
731001-01	BASE FOR TELESCOPING STEEL SIGN SUPPORT

GENERAL NOTES

G.N.-100
ENGLISH UNITS OF MEASUREMENT SHALL GOVERN OVER AND SUPERSEDE ANY METRIC UNITS SHOWN IN THIS CONTRACT. WHERE INCLUDED, METRIC UNITS ARE FOR INFORMATION ONLY.

G.N.-100A
ELECTRONIC FILES AND/OR ELECTRONIC SURVEY INFORMATION INCLUDING CADD FILES WILL NOT BE AVAILABLE TO THE CONTRACTOR.

G.N.-105.07C
EXISTING STATE-OWNED AND MAINTAINED UNDERGROUND UTILITY FACILITIES EXIST WITHIN THE ROW. THE DEPARTMENT IS NOT A MEMBER OF JULIE AND DOES NOT LOCATE IT'S OWN FACILITIES. THE CONTRACTOR SHALL BE RESPONSIBLE AT THEIR OWN EXPENSE FOR SECURING AN APPROVED LOCATING FIRM TO LOCATE ALL EXISTING IDOT UNDERGROUND FACILITIES PRIOR TO COMMENCING ANY EXCAVATION, PER THE REQUIREMENTS OF ARTICLE 803 OF THE STANDARD SPECIFICATIONS. UTILITY LOCATES MAY ALSO BE REQUIRED OUTSIDE THE PROJECT LIMITS, SUCH AS FOR TRAFFIC CONTROL SIGNING AND OTHER ITEMS. THE CONTRACTOR MAY OBTAIN, ON REQUEST, PLANS OF EXISTING ELECTRICAL FACILITIES FROM THE DEPARTMENT. FOR FURTHER INFORMATION, THE CONTRACTOR MAY CONTACT THE DISTRICT TRAFFIC OPERATIONS ENGINEER, GARY SIMS, AT 217-251-4859.

G.N.-107-SPL
A J.U.L.I.E LOCATE WILL BE REQUIRED PRIOR TO ANY EXCAVATION TO INCLUDE STUMP GRINDING AND SIGN INSTALLATIONS. IDOT CONSTRUCTION PERSONNEL WILL BE RESPONSIBLE FOR LAYOUT OF ALL PROPOSED SIGN LOCATIONS PRIOR TO A J.U.L.I.E. LOCATE. THE CONTRACTOR SHALL NOTIFY THE RESIDENT ENGINEER ONE WEEK PRIOR TO CONTACTING J.U.L.I.E.

G.N.-202-SPL
GRADING SHALL BE DONE BY HAND AROUND LIGHT POLES, UTILITY POLES, SIGN POSTS, SHRUBS, TREES OR OTHER NATURAL OR MAN-MADE OBJECTS WHERE SHALLOW FILLS OR CUTS ARE ADJACENT TO THE ITEMS. THE DECISION AS TO ITEMS TO REMAIN IN PLACE SHALL BE AS DIRECTED BY THE ENGINEER.

THIS WORK WILL NOT BE PAID FOR SEPARATELY, BUT SHALL BE CONSIDERED INCLUDED IN THE CONTRACT UNIT PRICE PER ACRE FOR SELECTIVE CLEARING AND NO ADDITIONAL COMPENSATION WILL BE ALLOWED

MODEL: \\MODEL\MAT\... FILE NAME: ...

* DOUGLAS & CHAMPAIGN

USER NAME = piersonbr PLOT SCALE = 40.0000 ' / in. PLOT DATE = 3/21/2019	DESIGNED - DRAWN - CHECKED - DATE -	REVISED - REVISED - REVISED - REVISED -	STATE OF ILLINOIS DEPARTMENT OF TRANSPORTATION	INDEX OF SHEETS, HIGHWAY STANDARDS, & GENERAL NOTES	F.A.I. RTE. 57&74 SECTION D5 POLLINATOR REHAB 2019-1 COUNTY * TOTAL SHEETS 12 SHEET NO. 2 CONTRACT NO. 70D90 ILLINOIS FED. AID PROJECT
			SCALE:	SHEET 1 OF 1 SHEETS	STA. TO STA.

LOCATION MAPS

DOUGLAS COUNTY

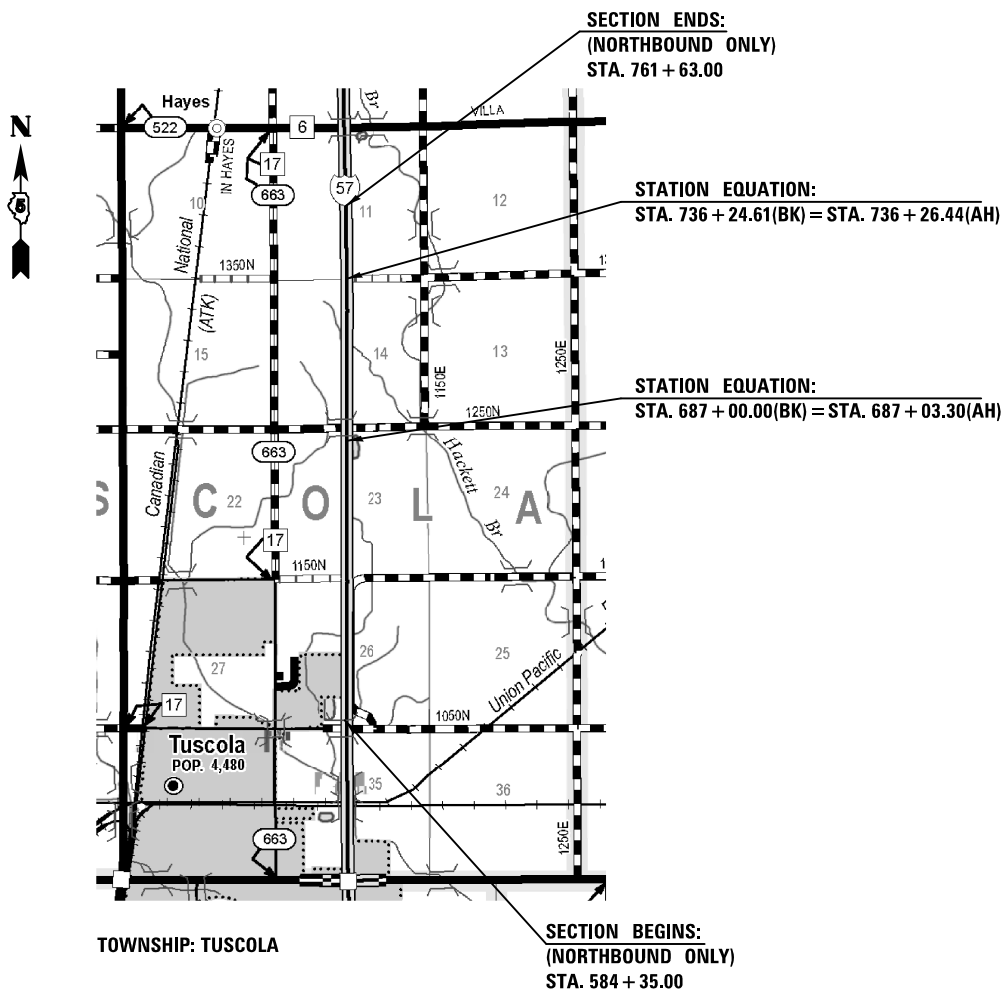

CHAMPAIGN COUNTY

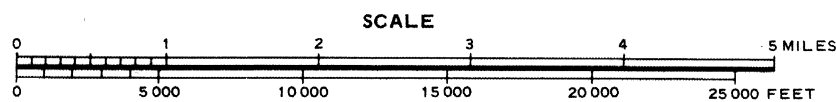
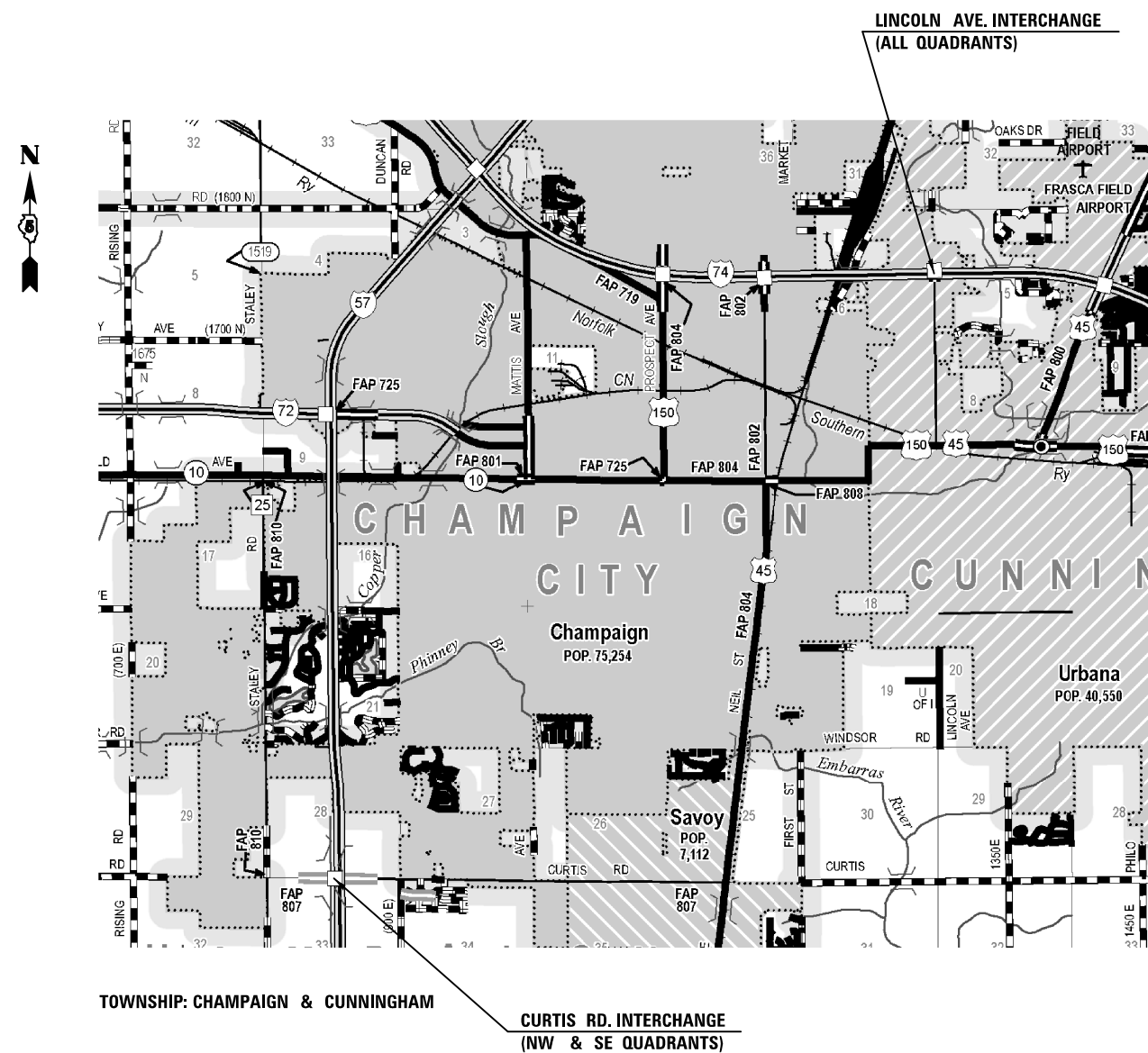

MODEL: S:\MODEL\MAPS
FILE: Maps: 70D90\70D90\DOT\Documents\DOT_Offices\Drawings\Projects\70D90\CADD\Drawings\CADD\Drawings\70D90\LOCATION\MAPS.dgn

USER NAME = ppersonbr	DESIGNED -	REVISED -
	DRAWN -	REVISED -
PLOT SCALE = 40,0000' / in.	CHECKED -	REVISED -
PLOT DATE = 3/21/2019	DATE -	REVISED -

**STATE OF ILLINOIS
DEPARTMENT OF TRANSPORTATION**

LOCATION MAPS

SCALE: SHEET 1 OF 1 SHEETS STA. TO STA.

F.A.I. RTE.	SECTION	COUNTY	TOTAL SHEETS	SHEET NO.
57&74	D5 POLLINATOR REHAB 2019-1	*	12	3
CONTRACT NO. 70D90				
ILLINOIS FED. AID PROJECT				

* DOUGLAS & CHAMPAIGN

SCHEDULE OF QUANTITIES

I - 57 NORTHBOUND ONLY					
STATION (I - 57)	TREE REMOVAL (6 to 15 UNITS DIAMETER)	TREE REMOVAL (OVER 15 UNITS DIAMETER)	STATION (I - 57)	TREE REMOVAL (6 to 15 UNITS DIAMETER)	TREE REMOVAL (OVER 15 UNITS DIAMETER)
	20100110	20100210		20100110	20100210
	UNIT	UNIT		UNIT	UNIT
587+54		21	659+49		20
588+73	12		650+99		22
590+38	7		660+31	15	
590+54		21	660+58		19
601+02		18	660+83		19
608+98	6			8	
611+26		19		7	
632+29	6		669+73		18
632+80	6		672+54		20
633+00	8		673+12		17
633+10	12			9	
633+80	9		675+25	8	
634+39	7			9	
649+55		17	675+28	7	
650+62	13		675+30	8	
		17	675+37	10	
650+93	6		675+50	7	
	10		675+64		18
651+42	10		675+66	8	
	10		675+72	6	
	9		675+76	7	
657+64	10		675+85	15	
	9		676+00	14	
	11		676+06	6	
	9		676+15	7	
		19	676+19	7	
651+90	6		676+28	6	
	7		676+40	6	
	8		676+42	6	
		25	676+49	7	
652+11	8		676+66 to 684+90 omitted due to Wetlands		
	7			10	
	14		685+37	10	
652+42	11			6	
653+91		20		11	
654+76	15		686+05		18
655+02		24		10	
655+70		24		8	
656+12		20	711+19	6	
658+06	12			10	
658+41	7		715+60		23
		17	715+95		17
658+90	11		752+34 to 753+47 omitted due to Wetlands		
	10				
	10				

I - 57 NORTHBOUND SUMMARY	TREE REMOVAL (6 to 15 UNITS DIAMETER)	TREE REMOVAL (OVER 15 UNITS DIAMETER)
RURAL SUBTOTAL	550	473

LINCOLN AVE. INTERCHANGE (NW QUADRANT)		
STATION (I - 74)	TREE REMOVAL (6 to 15 UNITS DIAMETER)	TREE REMOVAL (OVER 15 UNITS DIAMETER)
	20100110	20100210
	UNIT	UNIT
1252+41	8	
1252+83	8	
	6	
1252+94	10	
1253+21	9	
1253+33	11	
1253+46	8	
	7	
1253+52	9	
	6	
	7	
1253+57	12	
URBAN SUBTOTAL (6 to 15 UNITS DIAMETER)		101

LINCOLN AVE. INTERCHANGE (SW QUADRANT)		
STATION (I - 57)	TREE REMOVAL (6 to 15 UNITS DIAMETER)	TREE REMOVAL (OVER 15 UNITS DIAMETER)
	20100110	20100210
	UNIT	UNIT
1250+10	7	
1250+33	11	
1251+59	7	
1252+64	10	
1252+96	11	
	10	
1253+03	13	
1253+03	11	
	8	
1253+34	6	
1253+54	7	
URBAN SUBTOTAL (6 to 15 UNITS DIAMETER)		101

LINCOLN AVE. INTERCHANGE (NE QUADRANT)		
STATION (I - 74)	TREE REMOVAL (6 to 15 UNITS DIAMETER)	TREE REMOVAL (OVER 15 UNITS DIAMETER)
	20100110	20100210
	UNIT	UNIT
1255+30	7	
1255+32	8	
1255+38	14	
1255+67	13	
1255+75	14	
1255+87	12	
	11	
	6	
1255+96	6	
	6	
URBAN SUBTOTAL (6 to 15 UNITS DIAMETER)		97

LINCOLN AVE. INTERCHANGE (SE QUADRANT)		
STATION (I - 74)	TREE REMOVAL (6 to 15 UNITS DIAMETER)	TREE REMOVAL (OVER 15 UNITS DIAMETER)
	20100110	20100210
	UNIT	UNIT
1254+87	6	
	6	
1254+95	8	
1255+21	8	
1258+40	8	
URBAN SUBTOTAL (6 to 15 UNITS DIAMETER)		36

CURTIS RD. INTERCHANGE (NW QUADRANT)		
STATION (I - 57)	TREE REMOVAL (6 to 15 UNITS DIAMETER)	TREE REMOVAL (OVER 15 UNITS DIAMETER)
	20100110	20100210
	UNIT	UNIT
	7	
300+76	6	
	6	
	13	
302+95	9	
	9	
303+52	6	
	7	
303+83	14	
	9	
	13	
URBAN SUBTOTAL (6 to 15 UNITS DIAMETER)		99

TREE REMOVAL SUMMARY	URBAN/RURAL	TREE REMOVAL (6 to 15 UNITS DIAMETER)	TREE REMOVAL (OVER 15 UNITS DIAMETER)
		20100110	20100210
		UNIT	UNIT
I - 57 NORTHBOUND ONLY	RURAL	550	473
LINCOLN NW QUADRANT	URBAN	101	
LINCOLN SW QUADRANT	URBAN	101	
LINCOLN NE QUADRANT	URBAN	97	
LINCOLN SE QUADRANT	URBAN	36	
CURTIS NW QUADRANT	URBAN	99	
URBAN TOTAL		434	
RURAL TOTAL		550	473
PROJECT TOTAL		984	473

MODEL: I:\MODEL\MARIS
 FILE: MARIS_Pollinator\GIS\MapDocs\Documents\DOT_Office\I-57\I-57_NORTHBOUND_QUANT.dgn

* DOUGLAS & CHAMPAIGN

USER NAME = piersonbr	DESIGNED -	REVISED -
	DRAWN -	REVISED -
PLOT SCALE = 40,0000 ' / in.	CHECKED -	REVISED -
PLOT DATE = 3/21/2019	DATE -	REVISED -

**STATE OF ILLINOIS
DEPARTMENT OF TRANSPORTATION**

SCHEDULE OF QUANTITIES

SCALE: SHEET 1 OF 4 SHEETS STA. TO STA.

F.A.J. RTE.	SECTION	COUNTY	TOTAL SHEETS	SHEET NO.
57&74	D5 POLLINATOR REHAB 2019-1	*	12	5
CONTRACT NO. 70D90				
ILLINOIS		FED. AID PROJECT		

SCHEDULE OF QUANTITIES

I - 57 SIGN LOCATIONS						SIGN PANEL TYPE 1 (I2-I101)	SIGN PANEL TYPE 1 (I2-I104)	TELESCOPING STEEL SIGN SUPPORT	BASE FOR TELESCOPING STEEL SIGN SUPPORT
STATION	DIRECTION	COUNTY	URBAN/ RURAL	# OF SIGNS	# OF POSTS	72000100		72800100	73100100
						SQ FT		FOOT	EACH
590+00	NB	DOUGLAS	RURAL	2	1	1.5	0.5	10.0	1
600+00	NB	DOUGLAS	RURAL	2	1	1.5	0.5	10.0	1
610+00	NB	DOUGLAS	RURAL	2	1	1.5	0.5	10.0	1
620+00	NB	DOUGLAS	RURAL	2	1	1.5	0.5	10.0	1
630+00	NB	DOUGLAS	RURAL	2	1	1.5	0.5	10.0	1
640+00	NB	DOUGLAS	RURAL	2	1	1.5	0.5	10.0	1
650+00	NB	DOUGLAS	RURAL	2	1	1.5	0.5	10.0	1
660+00	NB	DOUGLAS	RURAL	2	1	1.5	0.5	10.0	1
670+00	NB	DOUGLAS	RURAL	2	1	1.5	0.5	10.0	1
680+00	NB	DOUGLAS	RURAL	2	1	1.5	0.5	10.0	1
690+00	NB	DOUGLAS	RURAL	2	1	1.5	0.5	10.0	1
700+00	NB	DOUGLAS	RURAL	2	1	1.5	0.5	10.0	1
710+00	NB	DOUGLAS	RURAL	2	1	1.5	0.5	10.0	1
720+00	NB	DOUGLAS	RURAL	2	1	1.5	0.5	10.0	1
730+00	NB	DOUGLAS	RURAL	2	1	1.5	0.5	10.0	1
740+00	NB	DOUGLAS	RURAL	2	1	1.5	0.5	10.0	1
750+00	NB	DOUGLAS	RURAL	2	1	1.5	0.5	10.0	1
760+00	NB	DOUGLAS	RURAL	2	1	1.5	0.5	10.0	1
RURAL TOTAL						36.0	180.0	18	

INTERCHANGE SIGN LOCATIONS						SIGN PANEL TYPE 1 (I2-I101)	SIGN PANEL TYPE 1 (I2-I104)	TELESCOPING STEEL SIGN SUPPORT	BASE FOR TELESCOPING STEEL SIGN SUPPORT
LOCATION DESCRIPTION	COUNTY	URBAN/ RURAL	# OF SIGNS	# OF POSTS	72000100		72800100	73100100	
					SQ FT		FOOT	EACH	
LINCOLN AVE. INTERCHANGE (NE QUADRANT)	CHAMPAIGN	URBAN	6	3	4.5	1.5	30.0	3.0	
LINCOLN AVE. INTERCHANGE (NW QUADRANT)	CHAMPAIGN	URBAN	6	3	4.5	1.5	30.0	3.0	
LINCOLN AVE. INTERCHANGE (SE QUADRANT)	CHAMPAIGN	URBAN	6	3	4.5	1.5	30.0	3.0	
LINCOLN AVE. INTERCHANGE (SW QUADRANT)	CHAMPAIGN	URBAN	6	3	4.5	1.5	30.0	3.0	
CURTIS RD. INTERCHANGE (NW QUADRANT)	CHAMPAIGN	URBAN	6	3	4.5	1.5	30.0	3.0	
CURTIS RD. INTERCHANGE (SE QUADRANT)	CHAMPAIGN	URBAN	6	3	4.5	1.5	30.0	3.0	
URBAN TOTAL						36.0	180.0	18	

SIGN SCHEDULE SUMMARY					SIGN PANEL TYPE 1 (I2-I101)	SIGN PANEL TYPE 1 (I2-I104)	TELESCOPING STEEL SIGN SUPPORT	BASE FOR TELESCOPING STEEL SIGN SUPPORT
SIGN LOCATIONS	URBAN/ RURAL	# OF SIGNS	# OF POSTS	72000100		72800100	73100100	
				SQ FT		FOOT	EACH	
URBAN TOTAL		36	18	36.0		180.0	18	
RURAL TOTAL		36	18	36.0		180.0	18	
PROJECT TOTAL		72	36	72.0		360.0	36	

MODEL: I:\MODEL\NAMES
 FILE: N:\names_2019\Illinois\pwr\DOT\Documents\DOT_Offices\I11\dot_5\Projects\I57\70D90\CADD\DATA\CAD\Sheet\I57_70D90_S1\I57-QUANT.dgn

* DOUGLAS & CHAMPAIGN

USER NAME = ppersonbr	DESIGNED -	REVISED -	STATE OF ILLINOIS DEPARTMENT OF TRANSPORTATION	SCHEDULE OF QUANTITIES	F.A.J. RTE.	SECTION	COUNTY	TOTAL SHEETS	SHEET NO.	
	DRAWN -	REVISED -			57&74	D5 POLLINATOR REHAB 2019-1	*	12	7	
PLOT SCALE = 40.0000 ' / in.	CHECKED -	REVISED -			CONTRACT NO. 70D90					
PLOT DATE = 3/21/2019	DATE -	REVISED -			SCALE:	SHEET 3 OF 4 SHEETS	STA.	TO STA.	ILLINOIS FED. AID PROJECT	

SCHEDULE OF QUANTITIES

I - 57 NORTHBOUND (DOUGLAS COUNTY)									NUMBER OF APPLICATIONS	WEED CONTROL, NON-SELECTIVE AND NON-RESIDUAL	
STATION	WIDTH* (FT)	TO	STATION	WIDTH* (FT)	LENGTH (FT)	AVERAGE WIDTH (FT)	AREA (SQ.FT)	AREA (ACRE)		K0029632	
										GALLON	
584+35	37		585+00	39	65.0	38	2,470.00	0.057	2	0.028	
585+00	39		590+00	51	500.0	45	22,500.00	0.517	2	0.258	
590+00	51		595+00	49.5	500.0	50.25	25,125.00	0.577	2	0.288	
595+00	49.5		600+00	50	500.0	49.75	24,875.00	0.571	2	0.286	
600+00	50		605+00	50	500.0	50	25,000.00	0.574	2	0.287	
605+00	50		610+00	50	500.0	50	25,000.00	0.574	2	0.287	
610+00	50		614+99	50	499.0	50	24,950.00	0.573	2	0.286	
614+99 to 615+23 omitted due to Waterway											
615+23	50		620+00	50	477.0	50	23,850.00	0.548	2	0.274	
620+00	50		625+00	50	500.0	50	25,000.00	0.574	2	0.287	
625+00	50		630+00	50	500.0	50	25,000.00	0.574	2	0.287	
630+00	50		632+10	48.5	210.0	49.25	10,342.50	0.237	2	0.119	
632+10	48.5		635+00	35	290.0	41.75	12,107.50	0.278	2	0.139	
635+00	35		640+00	34	500.0	34.5	17,250.00	0.396	2	0.198	
640+00	34		645+00	34	500.0	34	17,000.00	0.390	2	0.195	
645+00	34		649+24	34	424.0	34	14,416.00	0.331	2	0.165	
649+24	91		650+00	91	76.0	91	6,916.00	0.159	2	0.079	
650+00	91		655+00	87	500.0	89	44,500.00	1.022	2	0.511	
655+00	87		655+82	86	82.0	86.5	7,093.00	0.163	2	0.081	
655+82	60		660+00	56	418.0	58	24,244.00	0.557	2	0.278	
660+00	56		665+00	51	500.0	53.5	26,750.00	0.614	2	0.307	
665+00	51		670+00	49	500.0	50	25,000.00	0.574	2	0.287	
670+00	49		675+00	46	500.0	47.5	23,750.00	0.545	2	0.273	
675+00	46		676+66	45	166.0	45.5	7,553.00	0.173	2	0.087	
676+66 to 684+90 omitted due to Wetlands											
684+90	56.5		685+00	56.5	10.0	56.5	565.00	0.013	2	0.006	
685+00	56.5		687+00	45	200.0	50.75	10,150.00	0.233	2	0.117	
687+03.3	45		687+85.7	32	82.4	38.5	3,172.40	0.073	2	0.036	
Bridge omission											
688+19.6	30		689+25	33.5	105.4	31.75	3,346.45	0.077	2	0.038	
689+25	33.5		690+00	38	75.0	35.75	2,681.25	0.062	2	0.031	
690+00	38		695+00	38	500.0	38	19,000.00	0.436	2	0.218	
695+00	38		700+00	38	500.0	38	19,000.00	0.436	2	0.218	
700+00	38		705+00	38	500.0	38	19,000.00	0.436	2	0.218	
705+00	38		710+00	38	500.0	38	19,000.00	0.436	2	0.218	
710+00	38		715+00	45	500.0	41.5	20,750.00	0.476	2	0.238	
715+00	45		717+38	48.5	238.0	46.75	11,126.50	0.255	2	0.128	
717+38 to 717+60 omitted due to Waterway											
717+60	48.5		720+00	52	240.0	50.25	12,060.00	0.277	2	0.138	
720+00	52		725+00	52	500.0	52	26,000.00	0.597	2	0.298	
725+00	52		730+00	52	500.0	52	26,000.00	0.597	2	0.298	
730+00	52		735+00	51.5	500.0	51.75	25,875.00	0.594	2	0.297	
735+00	51.5		736+24.61	51	124.6	51.25	6,386.26	0.147	2	0.073	
736+24.61	51		740+00	52.5	373.6	51.75	19,331.73	0.444	2	0.222	
740+00	52.5		745+00	56.5	500.0	54.5	27,250.00	0.626	2	0.313	
745+00	56.5		750+00	62	500.0	59.25	29,625.00	0.680	2	0.340	
750+00	62		752+34	65.5	234.0	63.75	14,917.50	0.342	2	0.171	
752+34 to 753+47 omitted due to Wetlands											
753+47	23		755+00	23	153.0	23	3,519.00	0.081	2	0.040	
755+00	23		760+00	24	500.0	23.5	11,750.00	0.270	2	0.135	
760+00	24		761+63	23	163.0	23.5	3,830.50	0.088	2	0.044	
RURAL TOTAL										9.126	

INTERCHANGE (CHAMPAIGN COUNTY)	AREA (ACRE)	NUMBER OF APPLICATIONS	WEED CONTROL, NON-SELECTIVE AND NON-RESIDUAL	
			K0029632	
			GALLON	
LINCOLN AVE. INTERCHANGE (NE QUADRANT)	1.476	2	0.738	
LINCOLN AVE. INTERCHANGE (NW QUADRANT)	1.658	2	0.829	
LINCOLN AVE. INTERCHANGE (SE QUADRANT)	1.202	2	0.601	
LINCOLN AVE. INTERCHANGE (SW QUADRANT)	1.401	2	0.701	
CURTIS RD. INTERCHANGE (NW QUADRANT)	7.523	2	3.762	
CURTIS RD. INTERCHANGE (SE QUADRANT)	8.191	2	4.096	
URBAN TOTAL			10.726	

WEED CONTROL SUMMARY	WEED CONTROL, NON-SELECTIVE AND NON-RESIDUAL	
	K0029632	
GALLON		
URBAN TOTAL ROUNDED		
11.0		
RURAL TOTAL ROUNDED		
10.0		
PROJECT TOTAL ROUNDED		
21.0		

Notes:
 * Width measured 16.0 feet from edge of paved shoulder to R.O.W. (wire woven fence).
 655+82 to 676+66: Width measured 10.0 feet from edge of waterway to R.O.W. (wire woven fence).
 Weed Control Application Rate: 32.0 ounces(liquid)/acre.

MODEL: I:\MODEL\NAMES
 FILE: N:\MISC\PROJECTS\70D90\CADD\DATA\CADD\INRES\0570D90-5\HUBLE-QUANT.dgn

* DOUGLAS & CHAMPAIGN

USER NAME = piersonbr	DESIGNED -	REVISED -
	DRAWN -	REVISED -
PLOT SCALE = 40.0000 ' / in.	CHECKED -	REVISED -
PLOT DATE = 3/21/2019	DATE -	REVISED -

**STATE OF ILLINOIS
DEPARTMENT OF TRANSPORTATION**

SCHEDULE OF QUANTITIES	
SCALE:	SHEET 4 OF 4 SHEETS STA. TO STA.

F.A.J. RTE.	SECTION	COUNTY	TOTAL SHEETS	SHEET NO.
57&74	D5 POLLINATOR REHAB 2019-1	*	12	8
CONTRACT NO. 70D90				
ILLINOIS FED. AID PROJECT				

