

FOR INDEX OF SHEETS, SEE SHEET NO. 2 06-14-2019 LETTING ITEM 101
 FOR SUMMARY OF QUANTITIES, SEE SHEET NO. 4-5

STATE OF ILLINOIS
 DEPARTMENT OF TRANSPORTATION

F.A.I. RTE.	SECTION	COUNTY	TOTAL SHEETS	SHEET NO.
74	14 MICRO 2020-1	CHAMPAIGN	21	1
		ILLINOIS	CONTRACT NO. 70D98	

CURRENT ADT:

(PROSPECT AVE.) STA. 1143+00.00	(NEIL ST.) TO STA. 1186+69.00	(ADT) = 53,300	(PU) 45,251	(SU) 1,576	(MU) 6,503
(NEIL ST.) STA. 1186+69.00	(LINCOLN AVE.) TO STA. 1254+18.00	= 63,100	54,644	1,830	6,626
(LINCOLN AVE.) STA. 1254+18.00	(CUNNINGHAM AVE.) TO STA. 1321+65.00	= 53,500	45,475	1,551	6,474
(CUNNINGHAM AVE.) STA. 1321+65.00	(UNIVERSITY AVE.) TO STA. 1427+50.00	= 36,500	1,241	28,944	6,315

**PROPOSED
 HIGHWAY PLANS**

F.A.I. ROUTE 74 / (I-74)
 SECTION: 14 MICRO 2020-1
 PROJECT: NHPP-T54V(966)
 MICRO-SURFACING 2 PASS & RESURFACING (SMART)
 CHAMPAIGN COUNTY

C-95-051-19

PROSPECT AVE IN CHAMPAIGN TO UNIVERSITY AVE IN URBANA



STRUCTURE OMISSIONS:

- S.N. 010-0022/0023
 STA. 1279+20.00 TO 1280+70.00 (EB)
 STA. 1279+10.00 TO 1280+60.00 (WB)
- S.N. 010-0024
 STA. 1320+35.74 TO 1322+80.08 (EB)
 STA. 1320+43.38 TO 1322+86.74 (WB)
- S.N. 010-0025/0026
 STA. 1372+04.45 TO 1374+26.36 (EB)
 STA. 1372+21.57 TO 1374+43.88 (WB)

**MICRO-SURFACING
 OMISSION:**

- STA. 1189+60.00 TO 1231+55.00 (EB)
- STA. 1188+60.00 TO 1231+55.00 (WB)

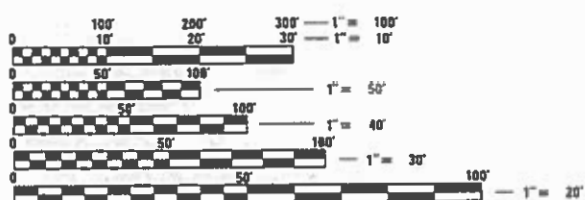

FULL SIZE PLANS HAVE BEEN PREPARED USING STANDARD ENGINEERING SCALES. REDUCED SIZED PLANS WILL NOT CONFORM TO STANDARD SCALES. IN MAKING MEASUREMENTS ON REDUCED PLANS, THE ABOVE SCALES MAY BE USED.

J.U.L.I.E.
 JOINT UTILITY LOCATION INFORMATION FOR EXCAVATION
 1-800-892-0123
 OR 811

TOWNSHIPS: CHAMPAIGN CITY, URBANA, CUNNINGHAM

PROJECT ENGINEER: JASON STULTS
 SQUAD LEADER: GREG EAGLIN
 DESIGNER: CARL BAKER
 PHONE NUMBER: (217)-465-4181

CONTRACT NO. 70D98

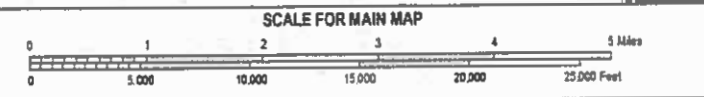
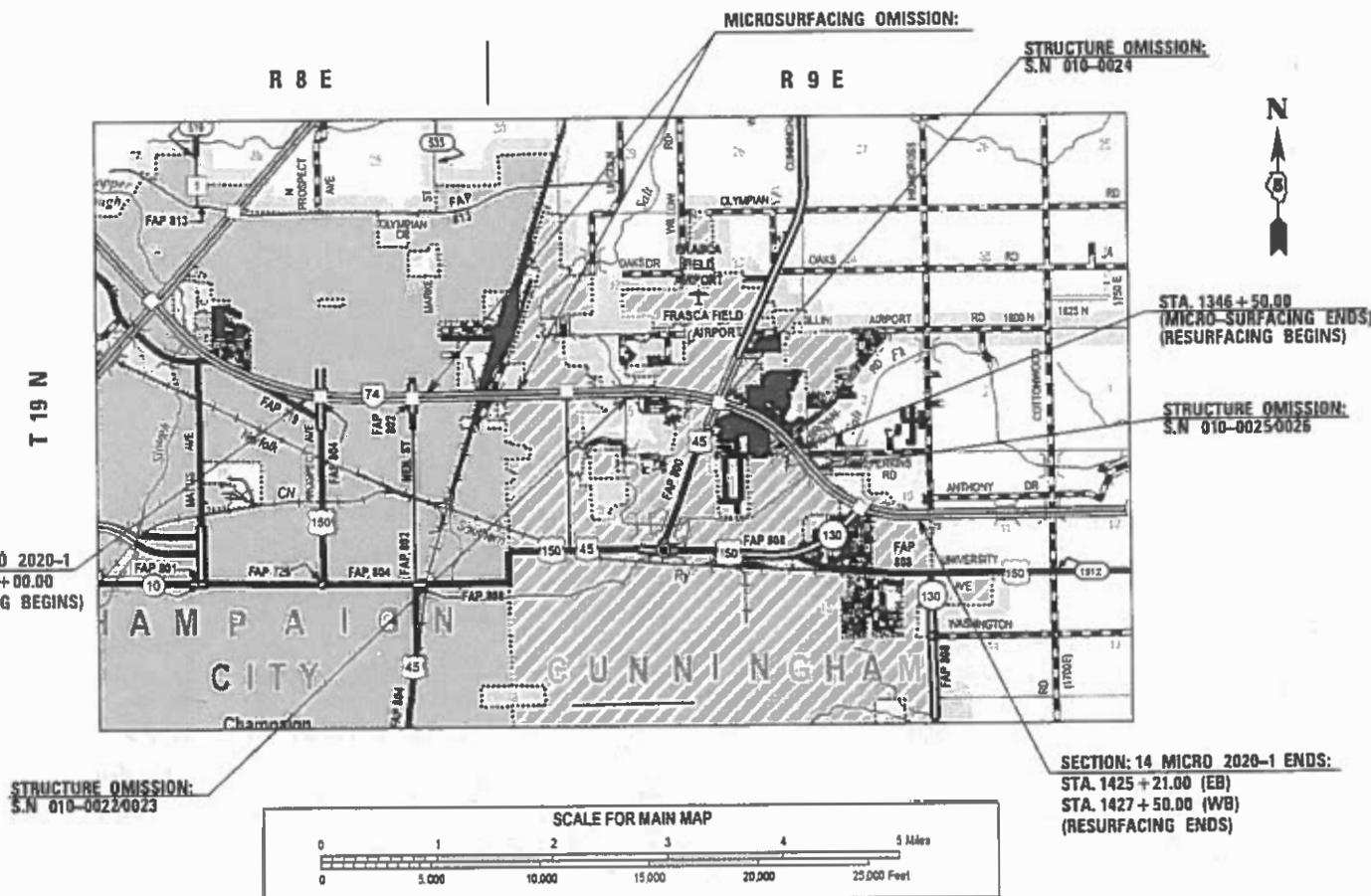

TOTAL LENGTH OF SECTION & PROJECT = 28,450.00 FT. = 5.388 MILES
 NET LENGTH OF SECTION & PROJECT = 23,539.33 FT. = 4.458 MILES
 (NOTE: LENGTH IS CALCULATED ALONG THE WESTBOUND LANE)

STATE OF ILLINOIS
 DEPARTMENT OF TRANSPORTATION

SUBMITTED 03/20/2019
Kensil A. Barnett
 REGION THREE ENGINEER

May 10 2019
[Signature]
 ENGINEER OF DESIGN AND ENVIRONMENT

May 10 2019
[Signature]
 DIRECTOR OF HIGHWAYS PROJECT IMPLEMENTATION

PRINTED BY THE AUTHORITY
 OF THE STATE OF ILLINOIS

INDEX OF SHEETS

1	COVER SHEET
2	INDEX OF SHEETS
2	HIGHWAY STANDARDS
3	GENERAL NOTES
4-5	SUMMARY OF QUANTITIES
6-10	EXISTING AND PROPOSED TYPICALS
11-19	SCHEDULE OF QUANTITIES
20	PAVEMENT MARKING (INTERSTATE & MULTI-LANE APPLICATIONS)
21	DETAIL FOR TEMPORARY PORTABLE RUMBLE STRIPS

LIST OF HIGHWAY STANDARDS

000001-07	STANDARD SYMBOLS, ABBREVIATIONS AND PATTERNS
001006	DECIMAL OF AN INCH AND OF A FOOT
630001-12	STEEL PLATE BEAM GUARDRAIL
630301-09	SHOULDER WIDENING FOR TYPE 1, (SPECIAL) GUARDRAIL TERMINALS
631011-10	TRAFFIC BARRIER TERMINAL, TYPE 2
631031-15	TRAFFIC BARRIER TERMINAL, TYPE 6
701101-05	OFF-RD OPERATIONS, MULTILANE, 15' (4.5m) TO 24" (600mm) FROM PAVEMENT EDGE
701400-09	APPROACH TO LANE CLOSURE, FREEWAY/EXPRESSWAY
701401-12	LANE CLOSURE, FREEWAY / EXPRESSWAY
701411-09	LANE CLOSURE, MULTILANE, AT ENTRANCE OR EXIT RAMP, FOR SPEEDS ≥ 45 MPH
701426-09	LANE CLOSURE, MULTILANE, INTERMITTENT OR MOVING OPER., FOR SPEEDS ≥ 45 MPH
701428-01	TRAFFIC CONTROL SETUP AND REMOVAL FREEWAY / EXPRESSWAY
701901-08	TRAFFIC CONTROL DEVICES
725001-01	OBJECT AND TERMINAL MARKERS
780001-05	TYPICAL PAVEMENT MARKINGS
781001-04	TYPICAL APPLICATIONS RAISED REFLECTIVE PAVEMENT MARKERS
782006	GUARDRAIL AND BARRIER WALL REFLECTOR MOUNTING DETAILS

MODEL: I:\MODEL\NAMES
 FILE: Names: P:\pub\mcomas\data\illinois.gov\RWIDOT\Documents\DOT_Offices\District 5\Projects\ID570D98\CADD\Drawings\ID570D98-01-01.dwg

USER NAME = BakerCR	DESIGNED -	REVISED -
	DRAWN -	REVISED -
PLOT SCALE = 40,0000 ' / in.	CHECKED -	REVISED -
PLOT DATE = 3/21/2019	DATE -	REVISED -

**STATE OF ILLINOIS
DEPARTMENT OF TRANSPORTATION**

**INDEX OF SHEETS
LIST OF HIGHWAY STANDARDS**

SCALE: SHEET OF SHEETS STA. TO STA.

F.A.J. RTE.	SECTION	COUNTY	TOTAL SHEETS	SHEET NO.
74	14 MICRO 2020-1	CHAMPAIGN	21	2
CONTRACT NO. 70D98				
ILLINOIS FED. AID PROJECT				

GENERAL NOTES

G.N.-100A
ELECTRONIC FILES AND/OR SURVEY INFORMATION INCLUDING CADD FILES WILL NOT BE AVAILABLE TO THE CONTRACTOR.

G.N.-406
THE QUANTITIES INCLUDED IN THE PLANS FOR HOT-MIX ASPHALT RESURFACING ARE INTENDED TO GIVE THE COVERAGE SHOWN ON THE TYPICAL CROSS SECTIONS. IT IS NOT INTENDED TO INCREASE THE THICKNESS OF THE HOT-MIX ASPHALT MIXTURE IN ORDER TO USE ALL THE QUANTITIES INCLUDED IN THE CONTRACT.

G.N.-406.10
FOR MULTILANE RESURFACING

WHEN BEGINNING THE RESURFACING WITH NEW MIXTURES FOR LEVELING BINDER, BINDER COURSE AND SURFACE COURSE MIXTURES, THE WORK WILL BE CONFINED TO THE INSIDE TRAFFIC LANE (PASSING LANE) FIRST. THE WORK WILL REMAIN ON THE INSIDE LANE UNTIL THE MIX HAS BEEN ADJUSTED AND APPROVED BY THE ENGINEER BEFORE ANY RESURFACING IS ALLOWED ON THE OUTSIDE (DRIVING) TRAFFIC LANE(S).

ANY DELAYS OR INCONVENIENCES CAUSED THE CONTRACTOR IN COMPLYING WITH THIS REQUIREMENT WILL BE CONSIDERED INCIDENTAL TO THE VARIOUS HOT-MIX ASPHALT PAY ITEMS, AS SHOWN IN THE CONTRACT, AND NO ADDITIONAL COMPENSATION WILL BE ALLOWED.

G.N.-406H
MIXTURE REQUIREMENTS

THE FOLLOWING MIXTURE REQUIREMENTS ARE APPLICABLE FOR THIS PROJECT:

CONTRACT: 70D98

Location	I-74
Mixture Use	Polymer Surface
AC/PG	SBS PG 70-22
Design Air Voids	4.0% @ Ndes=90
Mix Comp(Gradation)	IL 9.5
Friction Aggregate	Mix E
Mixture Weight	112
Quality Management Program	QCP
Sublot Size	1000

G.N.-609
PRIOR TO ROUTING TRAFFIC ONTO THE SHOULDERS AS SHOWN IN THE STAGING PLANS. THE CONTRACTOR SHALL SECURE THE GRATINGS ON THE SHOULDER INLETS AS DIRECTED BY THE ENGINEER. THIS WORK WILL BE PAID FOR ACCORDING TO ARTICLE 109.04

G.N.-703A
SHORT TERM PAVEMENT MARKING SHALL BE APPLIED TO THE PAVEMENT AFTER ANY OF THE FOLLOWING: COLD MILLING AND / OR PLACING BITUMINOUS MATERIALS (TACK COAT), LEVELING BINDER (MACHINE METHOD), BINDER AND SURFACE COURSES. SHORT TERM PAVEMENT MARKING PLACED ON THE SURFACE, SHALL COINCIDE WITH THE FINAL PAVEMENT STRIPING, SHORT TERM PAVEMENT MARKING PLACED PRIOR TO THE SURFACE SHALL COINCIDE WITH THE EXISTING PAVEMENT MARKINGS. USE 4 FEET PER 40 FEET (OR 10% PER STATION).

G.N.-781
THE FINAL PAVEMENT MARKINGS SHALL BE IN PLACE PRIOR TO PLACING THE RAISED REFLECTIVE PAVEMENT MARKERS.

MATERIAL TRANSFER DEVICE (MTD) INFORMATION:
BASED ON STRUCTURAL ANALYSIS, THE FOLLOWING SHOULD BE NOTED WITH REGARDS TO MATERIAL TRANSFER DEVICES (MTD) TRAVELING OVER EXISTING STRUCTURES:

ONLY AN EMPTY MATERIAL DEVICE MAY PASS OVER THE FOLLOWING STRUCTRES:
S.N. 010-0025
S.N. 010-0026
S.N. 010-0194

COMMITMENTS
THERE ARE NO COMMITMENTS FOR THIS CONTRACT

MODEL: \\MODEL\NAMES
FILE: \\MODEL\NAMES\70D98\70D98\70D98\CADD\Design\70D98-ht-generate

USER NAME = BakerCR	DESIGNED -	REVISED -	STATE OF ILLINOIS DEPARTMENT OF TRANSPORTATION	GENERAL NOTES		F.A.J RTE.	SECTION	COUNTY	TOTAL SHEETS	SHEET NO.
PLOT SCALE = 40,0000 ' / in.	DRAWN -	REVISED -				74	14 MICRO 2020-1	CHAMPAIGN	21	3
PLOT DATE = 3/21/2019	CHECKED -	REVISED -		SCALE: SHEET OF SHEETS STA. TO STA.		CONTRACT NO. 70D98				
	DATE -	REVISED -		ILLINOIS FED. AID PROJECT						

SUMMARY OF QUANTITIES

LOCATION OF WORK:	F.A.I. ROUTE 74 URBAN INTERSTATE STA. 1143+00.00 TO STA. 1427+50.00 CHAMPAIGN COUNTY
FUNDING BREAK OUT:	90% FED 10% STATE
CONSTRUCTION TYPE CODE:	0005

CODE NO.	ITEM	UNIT	TOTAL QUANTITY
40400001	FIBER - MODIFIED ASPHALT CRACK SEALING	FOOT	74507.0
40400020	BUMP REMOVAL	EACH	150.0
40400122	MICRO-SURFACING, SINGLE PASS, MIXTURE E	SQ YD	322.0
40600290	BITUMINOUS MATERIALS (TACK COAT)	POUND	41576.0
40603570	POLYMERIZED HOT-MIX ASPHALT SURFACE COURSE, MIX "E",N90	TON	4714.0
44000157	HOT-MIX ASPHALT SURFACE REMOVAL, 2"	SQ YD	42082.0
* 63000001	STEEL PLATE BEAM GUARDRAIL, TYPE A, 6 FOOT POSTS	FOOT	4437.5
* 63100045	TRAFFIC BARRIER TERMINAL, TYPE 2	EACH	1.0
* 63100085	TRAFFIC BARRIER TERMINAL, TYPE 6	EACH	17.0
* 63100167	TRAFFIC BARRIER TERMINAL, TYPE 1 (SPECIAL) TANGENT	EACH	18.0
63200310	GUARDRAIL REMOVAL	FOOT	4731.0
67100100	MOBILIZATION	L SUM	1.0
70100420	TRAFFIC CONTROL AND PROTECTION, STANDARD 701411	EACH	19.0
70100800	TRAFFIC CONTROL AND PROTECTION, STANDARD 701401	L SUM	1.0

* SPECIALTY ITEM

LOCATION OF WORK:	F.A.I. ROUTE 74 URBAN INTERSTATE STA. 1143+00.00 TO STA. 1427+50.00 CHAMPAIGN COUNTY
FUNDING BREAK OUT:	90% FED 10% STATE
CONSTRUCTION TYPE CODE:	0005

CODE NO.	ITEM	UNIT	TOTAL QUANTITY
70107025	CHANGEABLE MESSAGE SIGN	CAL DA	84.0
70200100	NIGHTTIME WORK ZONE LIGHTING	L SUM	1.0
70300100	SHORT TERM PAVEMENT MARKING	FOOT	18676.0
70300150	SHORT TERM PAVEMENT MARKING REMOVAL	SQ FT	9221.0
* 72501000	TERMINAL MARKER - DIRECT APPLIED	EACH	19.0
* 78000200	THERMOPLASTIC PAVEMENT MARKING - LINE 4"	FOOT	29836.0
* 78000500	THERMOPLASTIC PAVEMENT MARKING - LINE 8"	FOOT	1440.0
* 78004210	PREFORMED PLASTIC PAVEMENT MARKING, TYPE B - INLAID - LINE 4"	FOOT	3882.0
* 78009004	MODIFIED URETHANE PAVEMENT MARKING - LINE 4"	FOOT	67529.0
* 78009008	MODIFIED URETHANE PAVEMENT MARKING - LINE 8"	FOOT	5507.0
* 78100100	RAISED REFLECTIVE PAVEMENT MARKER	EACH	1374.0
* 78200005	GUARDRAIL REFLECTORS, TYPE A	EACH	78.0
78300200	RAISED REFLECTIVE PAVEMENT MARKER REMOVAL	EACH	1374.0
X0327980	PAVEMENT MARKING REMOVAL - WATER BLASTING	SQ FT	25869.0

* SPECIALTY ITEM

MODEL: I:\MODEL\NAME: FILE: NAME: PROJECT: I:\PROJECTS\0570D98\CADD\DATA\Design\0570D98.dwg

USER NAME = BakerCR	DESIGNED -	REVISED -
	DRAWN -	REVISED -
PLOT SCALE = 40.0000 ' / in.	CHECKED -	REVISED -
PLOT DATE = 3/21/2019	DATE -	REVISED -

**STATE OF ILLINOIS
DEPARTMENT OF TRANSPORTATION**

SUMMARY OF QUANTITIES

SCALE:	SHEET 1 OF 2 SHEETS	STA. _____ TO STA. _____	F.A.I. RTE. 74	SECTION 14 MICRO 2020-1	COUNTY CHAMPAIGN	TOTAL SHEETS 21	SHEET NO. 4
						CONTRACT NO. 70D98	
						ILLINOIS FED. AID PROJECT	

SUMMARY OF QUANTITIES

LOCATION OF WORK: FUNDING BREAK OUT: CONSTRUCTION TYPE CODE:	F.A.I. ROUTE 74 URBAN INTERSTATE STA. 1143+00.00 TO STA. 1427+50.00 CHAMPAIGN COUNTY 90% FED 10% STATE 0005
--	---

CODE NO.	ITEM	UNIT	TOTAL QUANTITY
X1600003	MICRO-SURFACING, 2 PASSES, MIXTURE E	SQ YD	100291.0
* X7830070	GROOVING FOR RECESSED PAVEMENT MARKING 5"	FOOT	29836.0
* X7830076	GROOVING FOR RECESSED PAVEMENT MARKING 9"	FOOT	1440.0
X9700016	TEMPORARY PORTABLE RUMBLE STRIPS	EACH	8.0
Z0033700	LONGITUDINAL JOINT SEALANT	FOOT	31054.0
Z0034105	MATERIAL TRANSFER DEVICE	TON	4666.0

* SPECIALTY ITEM

MODEL: \\MODEL\MRFE
 FILE NAME: P:\pub\mcom\ma\data\illinois.gov\RWIDOT\Documents\DOT_Offices\District 5\Projects\ID570D98\CADD\Drawn\ID570D98.rvt-500

A

EXISTING TYPICAL CROSS SECTION

STRUCTURE OMISSION:
 S. N. 010-0024
 EB STA. 1320+35.74 TO STA. 1322+80.08
 WB STA. 1320+43.38 TO STA. 1322+86.74

AUXILIARY LANE

• WESTBOUND LANE
 1160+80.00 TO 1174+60.00
 1231+55.00 TO 1240+00.00
 1266+78.00 TO 1306+40.00

•• EASTBOUND LANE
 1159+54.00 TO 1173+80.00
 1231+55.00 TO 1241+25.00
 1267+10.00 TO 1308+00.00

STATION TO STATION

1143+00.00 TO 1161+60.00 (B)
 (C) 1231+55.00 TO 1272+00.00 (B)
 (B) 1296+00.00 TO 1350+00.00 (E)

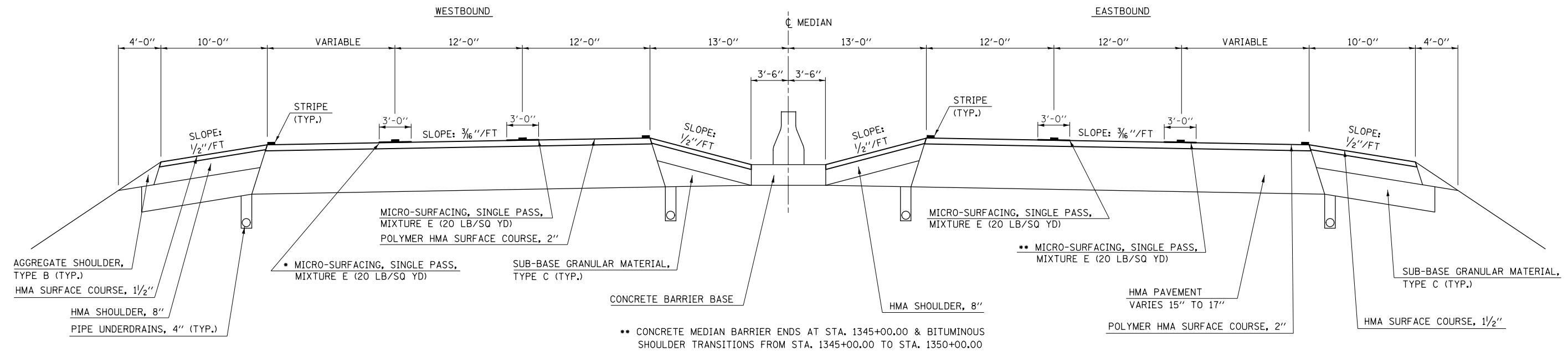

1

PROPOSED TYPICAL CROSS SECTION

STRUCTURE OMISSION:
 S. N. 010-0024
 EB STA. 1320+35.74 TO STA. 1322+80.08
 WB STA. 1320+43.38 TO STA. 1322+86.74

AUXILIARY LANE

• WESTBOUND LANE
 1160+80.00 TO 1174+60.00
 1231+55.00 TO 1240+00.00
 1266+78.00 TO 1306+40.00

•• EASTBOUND LANE
 1159+54.00 TO 1173+80.00
 1231+55.00 TO 1241+25.00
 1267+10.00 TO 1308+00.00

STATION TO STATION

1143+00.00 TO 1161+60.00 (2)
 (3) 1231+55.00 TO 1272+00.00 (2)
 (2) 1296+00.00 TO 1346+50.00 (5)

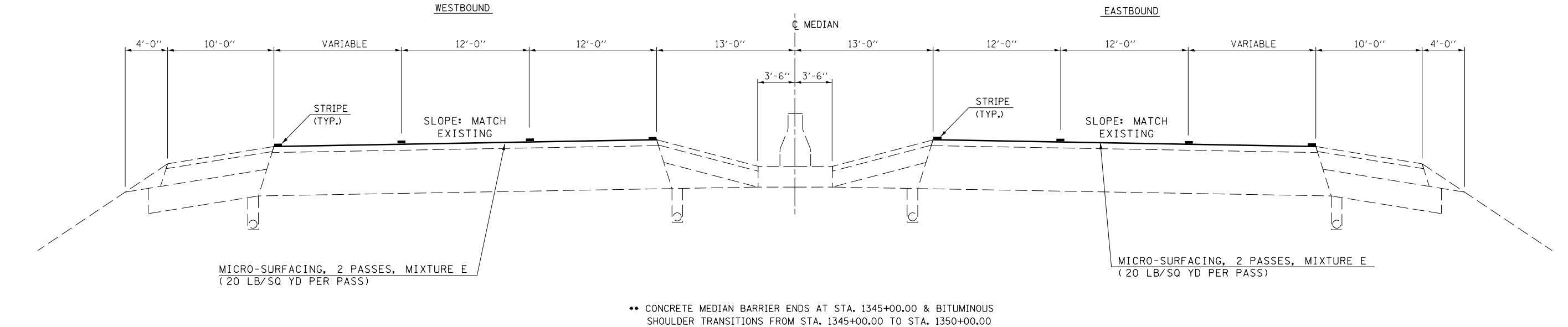

FILE NAME =	USER NAME = BakerCR	DESIGNED -	REVISED -	STATE OF ILLINOIS DEPARTMENT OF TRANSPORTATION	TYPICAL CROSS SECTION			F.A.I. RTE.	SECTION	COUNTY	TOTAL SHEETS	SHEET NO.		
pw:\planroom.dot.illinois.gov\PIDOT\Documents\IDOT Offices\District 5\Projects\05700\DRAWING\Design\05700-98-shr-Typicals		CHECKED -	REVISED -		SCALE:	SHEET 1	OF 5 SHEETS	STA.	TO STA.	74	14 MICRO 2020-1	CHAMPAIGN	21	6
#MODELNAME#	PLOT DATE = 3/21/2019	DATE -	REVISED -		CONTRACT NO. 70D98									
ILLINOIS FED. AID PROJECT														

(B) EXISTING TYPICAL CROSS SECTION

STRUCTURE OMISSIONS:
 S. N. 010-0022/23
 EB STA. 1279+20.00 TO STA. 1280+70.00
 WB STA. 1279+10.00 TO STA. 1280+60.00

AUXILIARY LANE

• WESTBOUND LANE
 1160+80.00 TO 1174+60.00
 1266+78.00 TO 1306+40.00

•• EASTBOUND LANE
 1159+54.00 TO 1173+80.00
 1267+10.00 TO 1308+00.00

STATION TO STATION

(A) 1161+60.00 1167+00.00 (C)

(A) 1272+00.00 1296+00.00 (A)

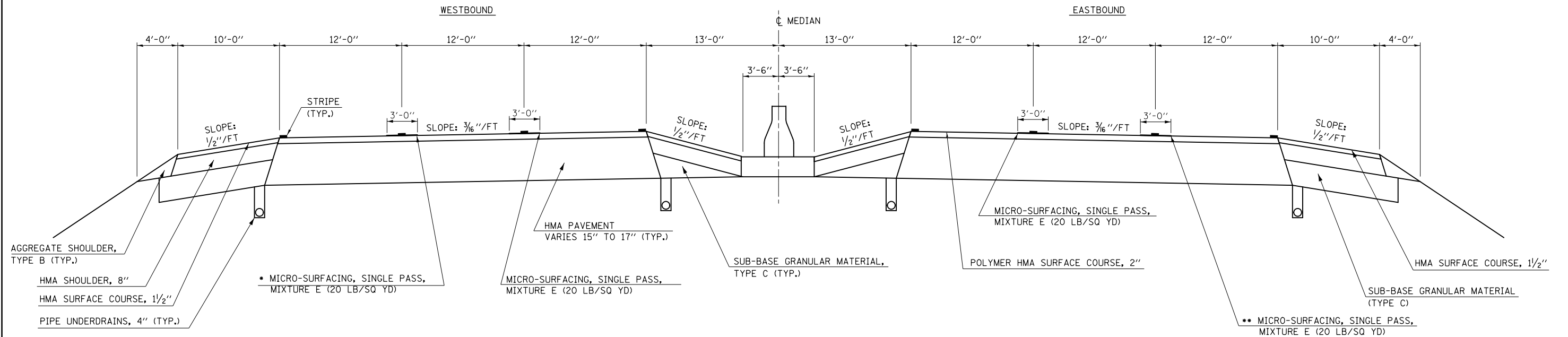

(2) PROPOSED TYPICAL CROSS SECTION

STRUCTURE OMISSIONS:
 S. N. 010-0022/23
 EB STA. 1279+20.00 TO STA. 1280+70.00
 WB STA. 1279+10.00 TO STA. 1280+60.00

AUXILIARY LANE

• WESTBOUND LANE
 1160+80.00 TO 1174+60.00
 1266+78.00 TO 1306+40.00

•• EASTBOUND LANE
 1159+54.00 TO 1173+80.00
 1267+10.00 TO 1308+00.00

STATION TO STATION

(1) 1161+60.00 1167+00.00 (3)

(1) 1272+00.00 1296+00.00 (1)

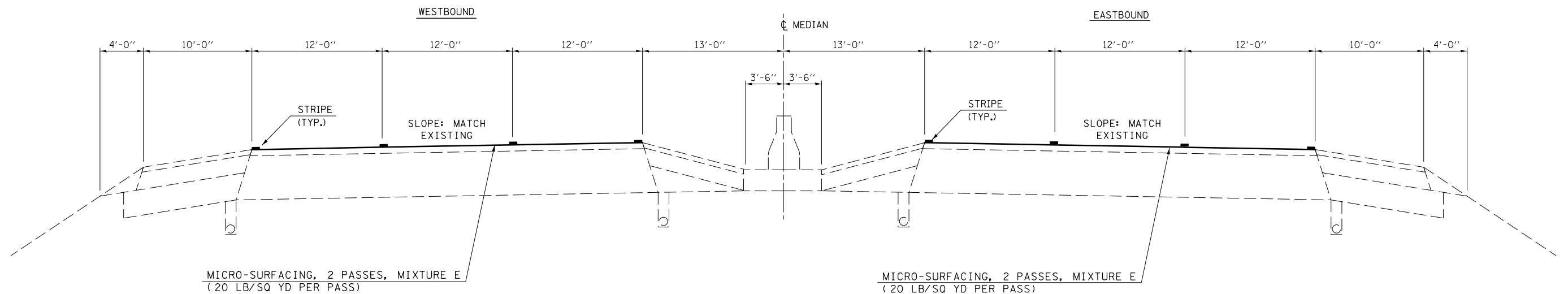

FILE NAME =	USER NAME = BakerCR	DESIGNED -	REVISED -	STATE OF ILLINOIS DEPARTMENT OF TRANSPORTATION	TYPICAL CROSS SECTION				F.A.I. RTE.	SECTION	COUNTY	TOTAL SHEETS	SHEET NO.
pw:\planroom.dot.illinois.gov\PIWIDOT\Documents\IDOT Offices\District 5\Projects\05700\BDR\to\Design\05700\98-sh-typicals									74	14 MICRO 2020-1	CHAMPAIGN	21	7
PLOT SCALE = 48.0000' / in.					CHECKED -				CONTRACT NO. 70D98				
#MODELNAME#					DATE -				ILLINOIS FED. AID PROJECT				
					SCALE:	SHEET 2	OF 5	SHEETS	STA.	TO STA.			

AUXILIARY LANE

• WESTBOUND LANE
1160+80.00 TO 1174+60.00

•• EASTBOUND LANE
1159+54.00 TO 1173+80.00

Ⓒ EXISTING TYPICAL CROSS SECTION

STATION TO STATION
Ⓑ 1167+00.00 TO 1231+55.00 Ⓐ

MICROSURFACING OMISSIONS:
EB STA. 1189+60 TO STA. 1231+55.00
WB STA. 1188+60 TO STA. 1231+55.00

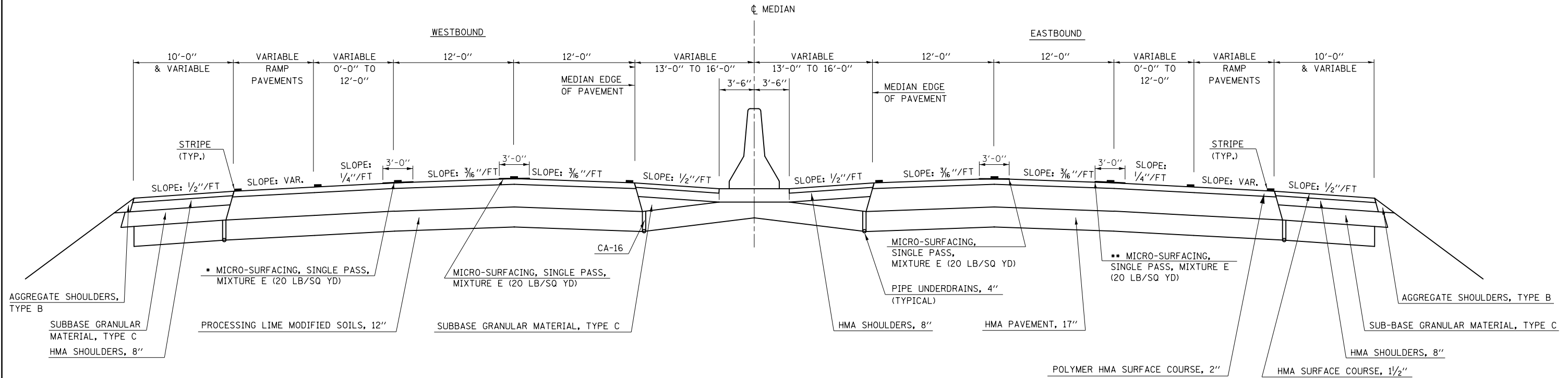

AUXILIARY LANE

• WESTBOUND LANE
1160+80.00 TO 1174+60.00

•• EASTBOUND LANE
1159+54.00 TO 1173+80.00

Ⓓ PROPOSED TYPICAL CROSS SECTION

STATION TO STATION
Ⓔ 1167+00.00 TO 1231+55.00 Ⓛ

MICROSURFACING OMISSIONS:
EB STA. 1189+60 TO STA. 1231+55.00
WB STA. 1188+60 TO STA. 1231+55.00

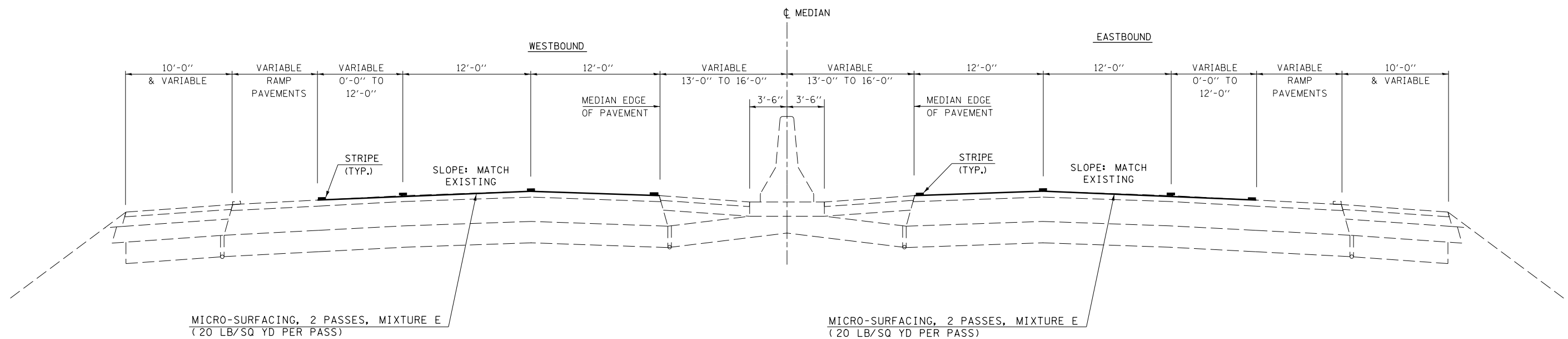

FILE NAME =	USER NAME = BakerCR	DESIGNED -	REVISED -	STATE OF ILLINOIS DEPARTMENT OF TRANSPORTATION	TYPICAL CROSS SECTION			F.A.I. RTE.	SECTION	COUNTY	TOTAL SHEETS	SHEET NO.
p:\planroom\dot.illinois.gov\PIDOT\Documents\IDOT Offices\District 5\Projects\05700\DRAWING\Design\05700\98-shr-Typicals	DRAWN -	REVISED -	74					14 MICRO 2020-1	CHAMPAIGN	21	8	
MODELNAME	PLOT SCALE = 40.0000' / in.	CHECKED -	REVISED -		SCALE: SHEET 3 OF 5 SHEETS STA. TO STA.			CONTRACT NO. 70D98				
	PLOT DATE = 3/21/2019	DATE -	REVISED -		ILLINOIS FED. AID PROJECT							

(D) EXISTING TYPICAL CROSS SECTION

STATION TO STATION
 (E) 1374+00.00 1421+00.00 (E)

STRUCTURE OMISSIONS:
 S. N. 010-0025/26
 EB STA. 1372+04.45 TO STA. 1374+26.36
 WB STA. 1372+21.57 TO STA. 1374+43.88

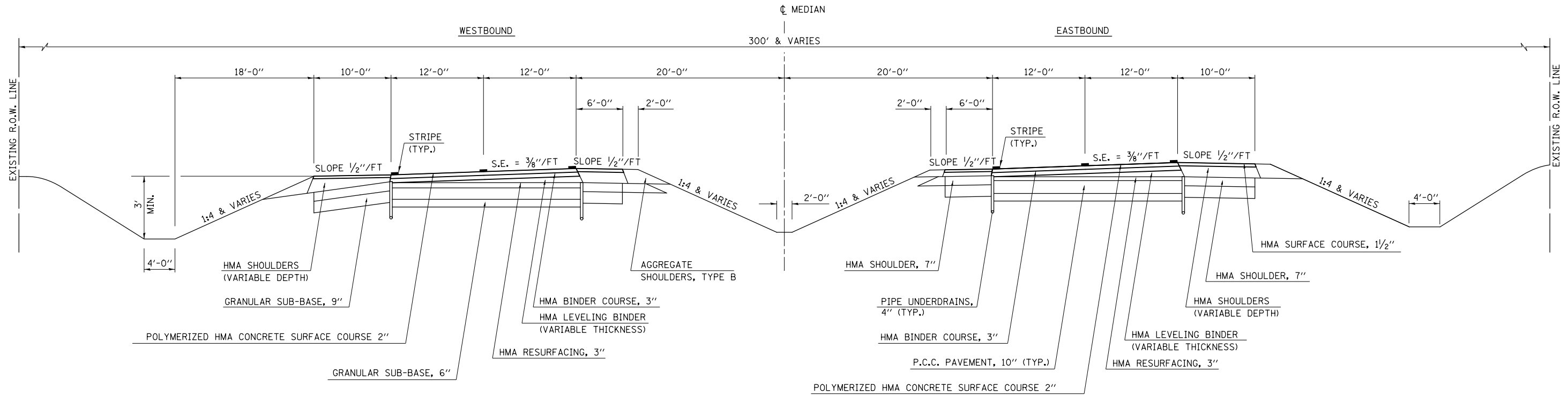

(4) PROPOSED TYPICAL CROSS SECTION

STATION TO STATION
 (5) 1374+00.00 1421+00.00 (5)

STRUCTURE OMISSIONS:
 S. N. 010-0025/26
 EB STA. 1372+04.45 TO STA. 1374+26.36
 WB STA. 1372+21.57 TO STA. 1374+43.88

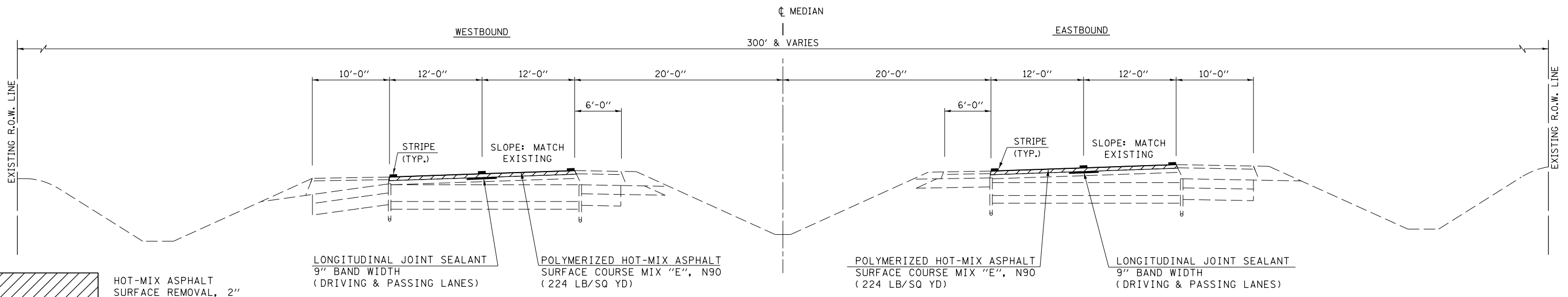

FILE NAME =	USER NAME = BakerCR	DESIGNED -	REVISED -	STATE OF ILLINOIS DEPARTMENT OF TRANSPORTATION	TYPICAL CROSS SECTION	F.A.I. RTE.	SECTION	COUNTY	TOTAL SHEETS	SHEET NO.	
DRAWN to Design\0570098-sh1-Typicals						74	14 MICRO 2020-1	CHAMPAIGN	21	9	
PLOT SCALE = 40.0000' / in.						CHECKED -	CONTRACT NO. 70D98				
DATE -						REVISIED -	ILLINOIS FED. AID PROJECT				
SCALE:		SHEET 4 OF 5 SHEETS		STA. TO STA.							

E EXISTING TYPICAL CROSS SECTION

STRUCTURE OMISSIONS:
 S. N. 010-0025/26
 EB STA. 1372+04.45 TO STA. 1374+26.36
 WB STA. 1372+21.57 TO STA. 1374+43.88

STATION TO STATION
 A 1350+00.00 1374+00.00 D
 D 1421+00.00 1425+21.00 (EB)
 1427+50.00 (WB)

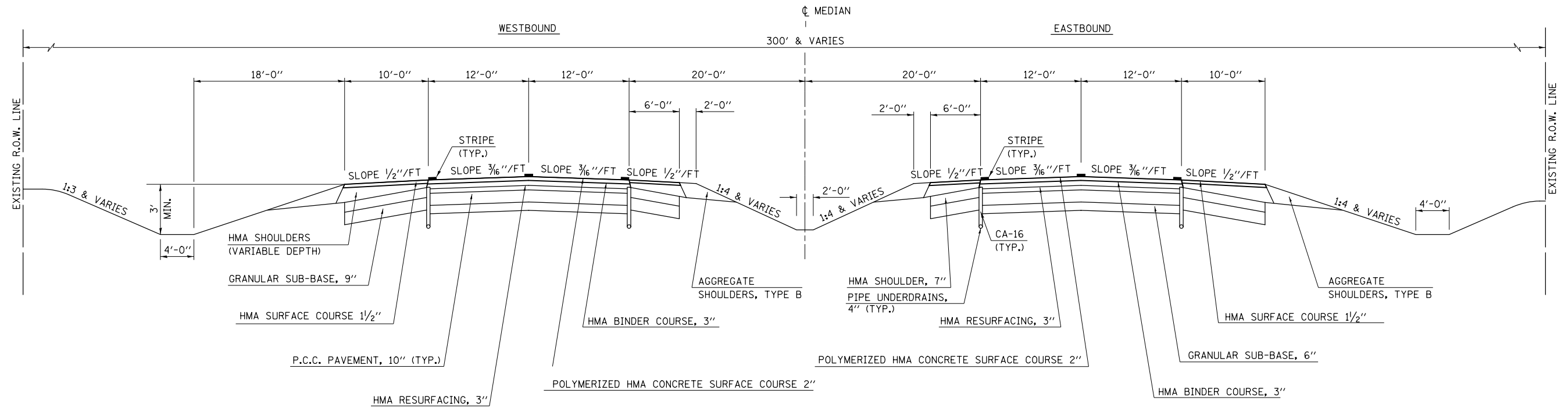

5 PROPOSED TYPICAL CROSS SECTION

STRUCTURE OMISSIONS:
 S. N. 010-0025/26
 EB STA. 1372+04.45 TO STA. 1374+26.36
 WB STA. 1372+21.57 TO STA. 1374+43.88

STATION TO STATION
 1 1346+50.00 1374+00.00 4
 4 1421+00.00 1425+21.00 (EB)
 1427+50.00 (WB)

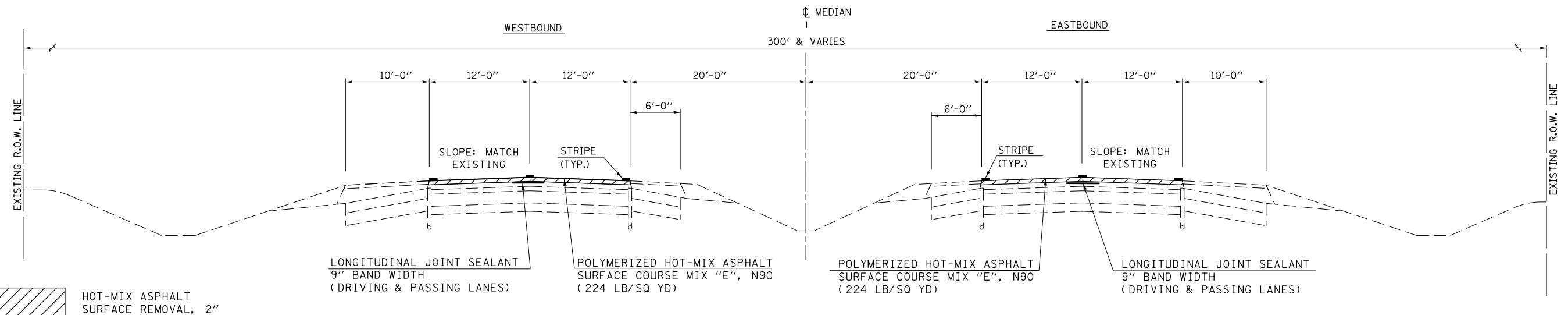

FILE NAME =	USER NAME = BakerCR	DESIGNED -	REVISED -	STATE OF ILLINOIS DEPARTMENT OF TRANSPORTATION	TYPICAL CROSS SECTION	F.A.I. RTE.	SECTION	COUNTY	TOTAL SHEETS	SHEET NO.
pw:\planroom.dot.illinois.gov\PWIDOT\Documents\IDOT Offices\District 5\Projects\05780\05780-Design\05780-98-shr-Typicals	DESIGNED -	REVISED -	74			14 MICRO 2020-1	CHAMPAIGN	21	10	
PLT SCALE = 40.0000' / in.	CHECKED -	REVISED -	CONTRACT NO. 70D98							
MODELNAME	DATE -	REVISED -	ILLINOIS FED. AID PROJECT							

SCHEDULE OF QUANTITIES

40400020 BUMP REMOVAL							40400020 BUMP REMOVAL EACH
LOCATION	DIRECTION	STATION	TO	STATION	LENGTH	WIDTH	
DRIVING LANE	E.B.	1143+00.00		1189+60.00	4660.00	12.0	6.0
MICRO-SURFACING OMISSION: (STA. 1189+60.00 TO STA. 1231+55.00)							
DRIVING LANE	E.B.	1231+55.00		1279+20.00	4765.00	12.0	8.0
STRUCTURE OMISSION: S.N. 010-0022/23 (STA. 1279+20.00 TO STA. 1280+70.00)							
DRIVING LANE	E.B.	1280+70.00		1320+35.74	3965.74	12.0	4.0
STRUCTURE OMISSION: S.N. 010-0024 (STA. 1320+35.74 TO STA. 1322+80.08)							
DRIVING LANE	E.B.	1322+80.08		1346+50.00	2369.92	12.0	4.0
AUXILIARY LANE	E.B.	1159+54.00		1173+80.00	1426.00	12.0	6.0
AUXILIARY LANE	E.B.	1231+55.00		1241+25.00	970.00	12.0	12.0
AUXILIARY LANE		1267+10.00		1279+20.00	1210.00	12.0	6.0
STRUCTURE OMISSION: S.N. 010-0022/23 (STA. 1279+20.00 TO STA. 1280+70.00)							
AUXILIARY LANE	E.B.	1280+70.00		1308+00.00	2730.00	12.0	8.0
PASSING LANE	E.B.	1143+00.00		1189+60.00	4660.00	12.0	6.0
MICRO-SURFACING OMISSION: (STA. 1189+60.00 TO STA. 1231+55.00)							
PASSING LANE	E.B.	1231+55.00		1279+20.00	4765.00	12.0	8.0
STRUCTURE OMISSION: S.N. 010-0022/23 (STA. 1279+20.00 TO STA. 1280+70.00)							
PASSING LANE	E.B.	1280+70.00		1320+35.74	3965.74	12.0	4.0
STRUCTURE OMISSION: S.N. 010-0024 (STA. 1320+35.74 TO STA. 1322+80.08)							
PASSING LANE	E.B.	1322+80.08		1346+50.00	2369.92	12.0	4.0
SUB-TOTAL =							76.0
DRIVING LANE	W.B.	1143+00.00		1188+60.00	4560.00	12.0	12.0
MICRO-SURFACING OMISSION: (STA. 1188+60.00 TO STA. 1231+55.00)							
DRIVING LANE	W.B.	1231+55.00		1279+10.00	4755.00	12.0	6.0
STRUCTURE OMISSION: S.N. 010-0022/23 (STA. 1279+10.00 TO 1280+60.00)							
DRIVING LANE	W.B.	1280+60.00		1320+43.38	3983.38	12.0	6.0
STRUCTURE OMISSION: S.N. 010-0024 (STA. 1320+43.38 TO STA. 1322+86.74)							
DRIVING LANE	W.B.	1322+86.74		1346+50.00	2363.26	12.0	4.0
AUXILIARY LANE	W.B.	1160+80.00		1174+60.00	1380.00	12.0	6.0
AUXILIARY LANE	W.B.	1231+55.00		1240+00.00	845.00	12.0	4.0
AUXILIARY LANE	W.B.	1266+78.00		1278+10.00	1132.00	12.0	4.0
STRUCTURE OMISSION: S.N. 010-0022/23 (STA. 1279+10.00 TO 1280+60.00)							
AUXILIARY LANE	W.B.	1280+60.00		1306+40.00	2580.00	12.0	8.0
PASSING LANE	W.B.	1143+00.00		1188+60.00	4560.00	12.0	12.0
MICRO-SURFACING OMISSION: (STA. 1188+60.00 TO STA. 1231+55.00)							
PASSING LANE	W.B.	1231+55.00		1279+10.00	4755.00	12.0	6.0
STRUCTURE OMISSION: S.N. 010-0022/23 (STA. 1279+10.00 TO 1280+60.00)							
PASSING LANE	W.B.	1280+60.00		1320+43.38	3983.38	12.0	4.0
STRUCTURE OMISSION: S.N. 010-0024 (STA. 1320+43.38 TO STA. 1322+86.74)							
PASSING LANE	W.B.	1322+86.74		1346+50.00	2363.26	12.0	2.0
SUB-TOTAL =							74.0
TOTAL =							150.0

40400001 FIBER-MODIFIED ASPHALT CRACK SEALING								
LOCATION	DIRECTION	STATION	TO	STATION	LENGTH	WIDTH	40400001	40400001
							FIBER-MODIFIED ASPHALT CRACK SEALING (LONGITUDINAL) FOOT	FIBER-MODIFIED ASPHALT CRACK SEALING (TRANSVERSE) FOOT
DRIVING & PASSING LANE	E.B.	1143+00.00		1189+60.00	4660.00	12.0	6990.0	240.0
MICRO-SURFACING OMISSION: (STA. 1189+60.00 TO 1231+55.00)								
DRIVING & PASSING LANE	E.B.	1231+55.00		1279+20.00	4765.00	12.0	7148.0	168.0
STRUCTURE OMISSION: S.N. 010-0022/23 (STA. 1279+20.00 TO 1280+70.00)								
DRIVING & PASSING LANE	E.B.	1280+70.00		1320+35.74	3965.74	12.0	5949.0	276.0
STRUCTURE OMISSION: S.N. 010-0024 (STA. 1320+35.74 TO 1322+80.08)								
DRIVING & PASSING LANE	E.B.	1322+80.08		1346+50.00	2369.92	12.0	3555.0	312.0
AUXILIARY LANE	E.B.	1159+54.00		1173+80.00	1426.00	12.0	2852.0	480.0
AUXILIARY LANE	E.B.	1231+55.00		1241+25.00	970.00	12.0	1940.0	300.0
AUXILIARY LANE	E.B.	1267+10.00		1279+20.00	1210.00	12.0	2420.0	360.0
STRUCTURE OMISSION: S.N. 010-0022/23 (STA. 1279+20.00 TO 1280+70.00)								
AUXILIARY LANE	E.B.	1280+70.00		1308+00.00	2730.00	12.0	4095.0	360.0
SUB-TOTAL =							34949.0	2496.0
DRIVING & PASSING LANE	W.B.	1143+00.00		1188+60.00	4560.00	12.0	6840.0	300.0
MICRO-SURFACING OMISSION: (STA. 1189+60.00 TO 1231+55.00)								
DRIVING & PASSING LANE	W.B.	1231+55.00		1279+10.00	4755.00	12.0	7132.0	348.0
STRUCTURE OMISSION: S.N. 010-0022/23 (STA. 1279+10.00 TO 1280+60.00)								
DRIVING & PASSING LANE	W.B.	1280+60.00		1320+43.38	3983.38	12.0	5976.0	216.0
STRUCTURE OMISSION: S.N. 010-0024 (STA. 1320+43.38 TO 1322+86.74)								
DRIVING & PASSING LANE	W.B.	1322+86.74		1346+50.00	2363.26	12.0	3546.0	360.0
AUXILIARY LANE	W.B.	1160+80.00		1174+60.00	1380.00	12.0	2070.0	216.0
AUXILIARY LANE	W.B.	1231+55.00		1240+00.00	845.00	12.0	1690.0	480.0
AUXILIARY LANE	W.B.	1266+78.00		1279+10.00	1232.00	12.0	2464.0	24.0
STRUCTURE OMISSION: S.N. 010-0022/23 (STA. 1279+10.00 TO 1280+60.00)								
AUXILIARY LANE	W.B.	1280+60.00		1306+40.00	2580.00	12.0	5160.0	240.0
SUB-TOTAL =							34878.0	2184.0
TOTAL =							69827.0	4680.0
USE =							74507.00	

70107025 CHANGEABLE MESSAGE SIGN			
	DAYS	LOCATION	QUANTITY
CMS ADVANCE WARNING	7.0	E.B. & W.B.	14.0
CMS USED DURING CONSTRUCTION	35.0	E.B. & W.B.	70.0
TOTAL =			84.0

MODEL: I:\MODEL\MHFS
 FILE: MHFS_Plan\Illumination.dwg
 PROJECT: 0570098\CADD\Drawings\DOT - Office\Drawings\70107025 - Schedule

USER NAME = BakerCR	DESIGNED -	REVISED -
PLOT SCALE = 40,0000 ' / in.	CHECKED -	REVISED -
PLOT DATE = 3/21/2019	DATE -	REVISED -

**STATE OF ILLINOIS
DEPARTMENT OF TRANSPORTATION**

SCHEDULE OF QUANTITIES

SCALE: SHEET 1 OF 9 SHEETS STA. TO STA.

F.A.J. RTE.	SECTION	COUNTY	TOTAL SHEETS	SHEET NO.
74	14 MICRO 2020-1	CHAMPAIGN	21	11
ILLINOIS FED. AID PROJECT			CONTRACT NO. 70D98	

SCHEDULE OF QUANTITIES

78100100 RAISED REFLECTIVE PAVEMENT MARKER							78300200 RAISED REFLECTIVE PAVEMENT MARKER REMOVAL	
LOCATION	DIRECTION	STATION	TO	STATION	LENGTH	78100100 RAISED REFLECTIVE PAVEMENT MARKER EACH	78300200 RAISED REFLECTIVE PAVEMENT MARKER REMOVAL EACH	
DRIVING LANE	E.B.	1143+00.00		1159+54.00	1654.00	0.0	0.0	
DRIVING LANE	E.B.	1174+18.00		1189+60.00	1542.00	0.0	0.0	
MICRO-SURFACING OMISSION: (STA. 1189+60.00 TO 1231+55.00)								
DRIVING LANE	E.B.	1241+25.00		1266+40.00	2515.00	0.0	0.0	
SEE AUXILIARY LANE								
DRIVING LANE	E.B.	1307+82.00		1320+35.74	1253.74	0.0	0.0	
STRUCTURE OMISSION: S.N. 010-024 (STA. 1320+35.74 TO 1322+80.08)								
		1322+80.08		1372+04.45	4924.37	0.0	0.0	
STRUCTURE OMISSION: S.N. 010-025/26 (STA. 1372+04.45 TO 1374+26.36)								
DRIVING LANE	E.B.	1374+26.36		1384+00.00	973.64	0.0	0.0	
RAMP		1384+00.00		1387+00.00				
DRIVING LANE	E.B.	1387+00.00		1409+50.00	2250.00	0.0	0.0	
RAMP		1409+50.00		1417+50.00				
DRIVING LANE	E.B.	1417+50.00		1425+21.00	771.00	0.0	0.0	
AUXILIARY LANE	E.B.	1159+54.00		1173+80.00	1426.00	36.0	36.0	
AUXILIARY LANE	E.B.	1231+55.00		1241+25.00	970.00	26.0	26.0	
AUXILIARY LANE	E.B.	1267+10.00		1279+20.00	1210.00	32.0	32.0	
STRUCTURE OMISSION: S.N. 010-0022/23 (STA. 1279+20.00 TO 1280+70.00)								
AUXILIARY LANE	E.B.	1280+70.00		1308+00.00	2730.00	70.0	70.0	
PASSING LANE	E.B.	1143+00.00		1189+60.00	4660.00	118.0	118.0	
MICRO-SURFACING OMISSION: (STA. 1189+60.00 TO 1231+55.00)								
PASSING LANE	E.B.	1231+55.00		1279+20.00	4765.00	120.0	120.0	
STRUCTURE OMISSION: S.N. 010-0022/23 (STA. 1279+20.00 TO 1280+70.00)								
PASSING LANE	E.B.	1280+70.00		1320+35.74	3965.74	100.0	100.0	
STRUCTURE OMISSION: S.N. 010-0024 (STA. 1320+35.74 TO 1322+80.08)								
PASSING LANE	E.B.	1322+80.08		1372+04.45	4924.37	124.0	124.0	
STRUCTURE OMISSION: S.N. 010-0025/26 (STA. 1372+04.45 TO 1374+26.36)								
PASSING LANE	E.B.	1374+26.36		1425+21.00	5094.64	128.0	128.0	
							SUB-TOTAL =	626.0

CONTINUED \longrightarrow

78100100 RAISED REFLECTIVE PAVEMENT MARKER							78300200 RAISED REFLECTIVE PAVEMENT MARKER REMOVAL	
LOCATION	DIRECTION	STATION	TO	STATION	LENGTH	78100100 RAISED REFLECTIVE PAVEMENT MARKER EACH	78300200 RAISED REFLECTIVE PAVEMENT MARKER REMOVAL EACH	
DRIVING LANE	W.B.	1143+00.00		1160+80.00	1780.00	0.0	0.0	
DRIVING LANE	W.B.	1174+60.00		1188+60.00	1400.00			
MICRO-SURFACING OMISSION: (STA. 1188+60.00 TO 1231+55.00)								
DRIVING LANE	W.B.	1240+00.00		1266+78.00	2678.00	0.0	0.0	
SEE AUXILIARY LANE								
DRIVING LANE	W.B.	1306+40.00		1320+43.38	1403.38	0.0	0.0	
STRUCTURE OMISSION: S.N.010-0024 (STA. 1320+43.38 TO 1322+86.74)								
DRIVING LANE	W.B.	1322+86.74		1372+21.57	4934.83	0.0	0.0	
STRUCTURE OMISSION: S.N. 010-0025/26 (STA. 1372+21.57 TO 1374+43.88)								
DRIVING LANE	W.B.	1374+43.88		1397+28.00	2284.12	0.0	0.0	
RAMP		1397+28.00		1403+00.00				
DRIVING LANE		1403+00.00		1421+72.00	1872.00	0.0	0.0	
RAMP		1421+72.00		1425+31.00				
DRIVING LANE		1425+31.00		1427+50.00	219.00	0.0	0.0	
AUXILIARY LANE	W.B.	1160+80.00		1174+60.00	1380.00	36.0	36.0	
AUXILIARY LANE	W.B.	1231+55.00		1240+00.00	845.00	22.0	22.0	
AUXILIARY LANE	W.B.	1266+78.00		1279+10.00	1232.00	32.0	32.0	
STRUCTURE OMISSION: S.N. 010-0022/23 (STA. 1279+10.00 TO 1280+60.00)								
AUXILIARY LANE	W.B.	1280+60.00		1306+40.00	2580.00	66.0	66.0	
PASSING LANE	W.B.	1143+00.00		1188+60.00	4560.00	114.0	114.0	
MICRO-SURFACING OMISSION: (STA. 1188+60.00 TO 1231+55.00)								
PASSING LANE	W.B.	1231+55.00		1279+10.00	4755.00	120.0	120.0	
STRUCTURE OMISSION: S.N. 010-0022/23 (STA. 1279+10.00 TO 1280+60.00)								
PASSING LANE	W.B.	1280+60.00		1320+43.38	3983.38	100.0	100.0	
STRUCTURE OMISSION: S.N. S.N.010-0024 (STA. 1320+43.38 TO 1322+86.74)								
PASSING LANE	W.B.	1322+86.74		1372+21.57	4934.83	124.0	124.0	
STRUCTURE OMISSION: S.N. 010-0025/26 (STA. 1372+21.57 TO 1374+43.88)								
PASSING LANE	W.B.	1374+43.88		1427+50.00	5306.12	134.0	134.0	
							SUB-TOTAL =	748.0
							TOTAL =	1374.0

40600290 BITUMINOUS MATERIALS (TACK COAT)								40400122 MICRO-SURFACING, SINGLE PASS, MIXTURE E	
LOCATION	DIRECTION	STATION	TO	STATION	LENGTH	WIDTH	40600290 BITUMINOUS MATERIALS (TACK COAT) 0.025 LB/SQ FT POUND	40400122 MICRO-SURFACING SINGLE PASS MIXTURE E SQ YD	
U.S. RTE. 45 ON-RAMP	E.B.	1333+42.00		1340+32.00	690.00	3.0	51.8	230.0	
U.S. RTE. 45 OFF-RAMP	W.B.	1334+72.00		1337+47.00	275.00	3.0	20.6	91.7	
							TOTAL =	321.7	
							USE =	322.0	

MODEL: I:\MODEL\MHFS FILE: Mhfs_Plan\Illinois\g04\Illinois.g04\Illinois\DOT Documents\DOT Office\Drawings\Project\0570098-RT-Schedule

USER NAME = BakerCR	DESIGNED -	REVISED -
	DRAWN -	REVISED -
PLOT SCALE = 40,0000' / in.	CHECKED -	REVISED -
PLOT DATE = 3/21/2019	DATE -	REVISED -

**STATE OF ILLINOIS
DEPARTMENT OF TRANSPORTATION**

SCHEDULE OF QUANTITIES

SCALE: SHEET 2 OF 9 SHEETS STA. TO STA.

F.A.J. RTE.	SECTION	COUNTY	TOTAL SHEETS	SHEET NO.
74	14 MICRO 2020-1	CHAMPAIGN	21	12
CONTRACT NO. 70D98				
ILLINOIS FED. AID PROJECT				

SCHEDULE OF QUANTITIES

							44000157	40600290	40603570	Z0033700	Z003450	
							HMA SURFACE REMOVAL, 2"	BITUMINOUS MATERIALS (TACK COAT) 0.05 LB/SQ FT	POLY HMA SURFACE COURSE MIX "E", N90	LONGITUDINAL JOINT SEALANT	MATERIAL TRANSFER DEVICE	
LOCATION	DIRECTION	STATION	TO	STATION	LENGTH	WIDTH	SQ YD	POUND	TON	FOOT	TON	
** DRIVING LANE	E.B.	1182+60.00		1184+20.00	160.00	12.0	213.3	96.0	23.9	0.0	0.0	
** PASSING LANE	E.B.	1182+60.00		1184+20.00	160.00	12.0	213.3	96.0	23.9	0.0	0.0	
DRIVING LANE	E.B.	1346+50.00		1372+04.45	2554.45	12.0	3405.9	1532.7	381.5	2554.5	381.5	
STRUCTURE OMISSION: S.N. 010-0025/26 (STA. 1372+04.45 TO 1374+26.36)												
DRIVING LANE	E.B.	1374+26.36		1384+00.00	973.64	12.0	1298.2	584.2	145.4	973.6	145.4	
DRIVING LANE	E.B.	1384+00.00		1387+00.00	300.00	13.0	433.3	195.0	48.5	300.0	48.5	
DRIVING LANE	E.B.	1387+00.00		1409+50.00	2250.00	12.0	3000.0	1350.0	336.0	2250.0	336.0	
DRIVING LANE	E.B.	1409+50.00		1417+50.00	800.00	13.0	1155.6	520.0	129.4	800.0	129.4	
DRIVING LANE	E.B.	1417+50.00		1425+21.00	771.00	12.0	1028.0	462.6	115.1	771.0	115.1	
PASSING LANE	E.B.	1346+50.00		1372+04.45	2554.45	12.0	3405.9	1532.7	381.5	2554.5	381.5	
STRUCTURE OMISSION: S.N. 010-0025/26 (STA. 1372+04.45 TO 1374+26.36)												
PASSING LANE	E.B.	1374+26.36		1425+21.00	5094.64	12.0	6792.9	3056.8	760.8	5094.6	760.8	
							SUB-TOTAL =	20946.5	9425.9	2346.0	15298.2	2298.2
DRIVING LANE	W.B.	1346+50.00		1372+21.57	2571.57	12.0	3428.8	1542.9	384.0	2571.6	384.0	
STRUCTURE OMISSION: S.N. 010-0025/26 (STA. 1372+21.57 TO 1374+43.88)												
DRIVING LANE	W.B.	1374+43.88		1398+00.00	2356.12	12.0	3141.5	1413.7	351.8	2356.1	351.8	
DRIVING LANE		1398+00.00		1403+00.00	500.00	13.0	722.2	325.0	80.9	500.0	80.9	
DRIVING LANE		1403+00.00		1421+00.00	1800.00	12.0	2400.0	1080.0	268.8	1800.0	268.8	
DRIVING LANE		1421+00.00		1427+50.00	650.00	13.0	938.9	422.5	105.2	650.0	105.2	
PASSING LANE	W.B.	1346+50.00		1372+21.57	2571.57	12.0	3428.8	1542.9	384.0	2571.6	384.0	
STRUCTURE OMISSION: S.N. 010-0025/26 (STA. 1372+21.57 TO 1374+43.88)												
PASSING LANE	W.B.	1374+43.88		1427+50.00	5306.12	12.0	7074.8	3183.7	792.4	5306.1	792.4	
							SUB-TOTAL =	21135.0	9510.7	2367.1	15755.4	2367.1
							TOTAL =	42081.4	18936.6	4713.1	31053.6	4665.3
** NOTE:							USE =	42082.0	18937.0	4714.0	31054.0	4666.0
QUANTITY IS FOR HMA INLAY WEST OF NEIL ST. OVERHEAD STRUCTURE												

MODEL: \\MODEL\MATF
 FILE: MATF: \\p1\hmm\com\data\illinois.gov\p1\DOT\Documents\DOT_Offices\Illinet 5\Projects\0570098\CADD\Drawings\0570098-ht-schedule

USER NAME = BakerCR	DESIGNED -	REVISED -
	DRAWN -	REVISED -
PLOT SCALE = 40.0000 ' / in.	CHECKED -	REVISED -
PLOT DATE = 3/21/2019	DATE -	REVISED -

**STATE OF ILLINOIS
DEPARTMENT OF TRANSPORTATION**

SCHEDULE OF QUANTITIES

SCALE: SHEET 4 OF 9 SHEETS STA. TO STA.

F.A.J. RTE.	SECTION	COUNTY	TOTAL SHEETS	SHEET NO.
74	14 MICRO 2020-1	CHAMPAIGN	21	14
CONTRACT NO. 70D98				
ILLINOIS FED. AID PROJECT				

SCHEDULE OF QUANTITIES

70300100	SHORT TERM PAVEMENT MARKING
70300150	SHORT TERM PAVEMENT MARKING REMOVAL
78009004	MODIFIED URETHANE PAVEMENT MARKING - LINE 4"
78009008	MODIFIED URETHANE PAVEMENT MARKING - LINE 8"
X0327980	PAVEMENT MARKING REMOVAL - WATER BLASTING

70300100	70300100	70300150	70300150	78009004	78009004	78009008	X0327980	X0327980
SHORT TERM PAVEMENT MARKING EDGE LINE	SHORT TERM PAVEMENT MARKING (2 APP)	SHORT TERM PAVEMENT MRK REM EDGE LINE	SHORT TERM PAVEMENT MRK REM (2 APP)	MOD URETH PM LINE 4" (CENTER DASH)	MOD URETH PM LINE 4" (EDGE LINE)	MOD URETH PM LINE 8"	PAVMT MRKG REM WTR BL EDGE LINE	PAVMT MRKG REM WTR BL CENTER LINE

LOCATION	DIRECTION	STATION	TO	STATION	LENGTH	FOOT	FOOT	SQ FT	SQ FT	FOOT	FOOT	FOOT	SQ FT	SQ FT
DRIVING LANE	E.B.	1143+00.00		1155+22.00	1222.00	48.9	0.0	16.3	0.0	0.0	1222.0	0.0	407.3	0.0
DRIVING LANE	E.B.	1155+22.00		1159+40.00	418.00	16.7	0.0	5.6	0.0	0.0	0.0	448.0	139.3	0.0
SEE AUXILIARY LANE														
DRIVING LANE	E.B.	1174+25.00		1178+65.00	440.00	17.6	0.0	5.9	0.0	0.0	0.0	440.0	293.3	0.0
DRIVING LANE	E.B.	1178+65.00		1189+60.00	1095.00	43.8	0.0	14.6	0.0	0.0	1095.0	0.0	365.0	0.0
MICRO-SURFACING OMISSION: (STA. 1189+60.00 TO 1231+55.00)														
SEE AUXILIARY LANE														
DRIVING LANE	E.B.	1241+25.00		1245+25.00	400.00	16.0	0.0	5.3	0.0	0.0	0.0	400.0	266.7	0.0
DRIVING LANE	E.B.	1245+25.00		1261+50.00	1625.00	65.0	0.0	21.7	0.0	0.0	1625.0	0.0	541.7	0.0
DRIVING LANE	E.B.	1261+50.00		1267+10.00	560.00	22.4	0.0	7.5	0.0	0.0	0.0	480.0	373.3	0.0
SEE AUXILIARY LANE														
STRUCTURE OMISSION: S.N. 010-0022/23 (STA. 1279+20.00 TO 1280+70.00)														
SEE AUXILIARY LANE														
DRIVING LANE	E.B.	1307+81.00		1312+00.00	419.00	16.8	0.0	5.6	0.0	0.0	0.0	419.0	279.3	0.0
DRIVING LANE	E.B.	1312+00.00		1320+35.74	835.74	33.4	0.0	11.1	0.0	0.0	835.7	0.0	278.6	0.0
STRUCTURE OMISSION: S.N. 010-0024 (STA. 1320+35.74 TO 1322+80.08)														
DRIVING LANE	E.B.	1322+80.08		1330+00.00	719.92	28.8	0.0	9.6	0.0	0.0	719.9	0.0	240.0	0.0
DRIVING LANE	E.B.	1330+00.00		1335+20.00	520	20.8	0.0	6.9	0.0	0.0	0.0	520.0	346.7	0.0
DRIVING LANE	E.B.	1335+20.00		1342+72.00	752	0.0	150.4	0.0	100.3	190.0	0.0	0.0	0.0	62.7
DRIVING LANE	E.B.	1342+72.00		1346+50.00	378	15.1	0.0	5.0	0.0	0.0	378.0	0.0	126.0	0.0
AUXILIARY LANE	E.B.	1159+40.00		1173+80.00	1440.00	57.6	288.0	19.2	192.0	360.0	1440.0	0.0	480.0	120.0
AUXILIARY LANE	E.B.	1231+55.00		1241+25.00	970.00	38.8	194.0	12.9	129.3	250.0	970.0	0.0	323.3	80.8
AUXILIARY LANE	E.B.	1267+10.00		1279+20.00	1210.00	48.4	242.0	16.1	161.3	310.0	1210.0	0.0	403.3	100.8
STRUCTURE OMISSION: S.N. 010-0022/23 (STA. 1279+20.00 TO 1280+70.00)														
AUXILIARY LANE	E.B.	1280+70.00		1308+00.00	2730.00	109.2	546.0	36.4	364.0	690.0	2730.0	0.0	910.0	227.5
PASSING LANE	E.B.	1143+00.00		1189+60.00	4660.00	186.4	932.0	62.1	621.3	1170.0	4660.0	0.0	1553.3	388.3
MICRO-SURFACING OMISSION: (STA. 1189+60.00 TO 1231+55.00)														
PASSING LANE	E.B.	1231+55.00		1279+20.00	4765.00	190.6	953.0	63.5	635.3	1200.0	4765.0	0.0	1588.3	397.1
STRUCTURE OMISSION: S.N. 010-0022/23 (STA. 1279+20.00 TO 1280+70.00)														
PASSING LANE	E.B.	1280+70.00		1320+35.74	3965.74	158.6	793.1	52.9	528.8	1000.0	3965.7	0.0	1321.9	330.5
STRUCTURE OMISSION: S.N. 010-0024 (STA. 1320+35.74 TO 1322+80.08)														
PASSING LANE	E.B.	1322+80.08		1346+50.00	2369.92	94.8	474.0	31.6	316.0	600.0	2369.9	0.0	790.0	197.5
SUB-TOTAL =						1229.7	4572.5	409.9	3048.4	5770.0	27986.3	2707.0	11027.4	1905.2

CONTINUED SHEET 6 OF 9

MODEL: I:\MODEL\MHFS
 FILE: MHFS_Plan\Illinois\GIS\Projects\0570098\CADD\Drawings\0570098-01-Schedule

USER NAME = BakerCR	DESIGNED -	REVISED -	STATE OF ILLINOIS DEPARTMENT OF TRANSPORTATION	SCHEDULE OF QUANTITIES				F.A.J. RTE.	SECTION	COUNTY	TOTAL SHEETS	SHEET NO.		
	DRAWN -	REVISED -		SCALE:	SHEET 5	OF 9	SHEETS	STA.	TO STA.	74	14 MICRO 2020-1	CHAMPAIGN	21	15
PLOT SCALE = 40.0000 ' / in.	CHECKED -	REVISED -						CONTRACT NO. 70D98						
PLOT DATE = 3/21/2019	DATE -	REVISED -		ILLINOIS FED. AID PROJECT										

SCHEDULE OF QUANTITIES

70300100 SHORT TERM PAVEMENT MARKING					70300150 SHORT TERM PAVEMENT MARKING REMOVAL					78009004 MODIFIED URETHANE PAVEMENT MARKING - LINE 4"			78009008 MODIFIED URETHANE PAVEMENT MARKING - LINE 8"			X0327980 PAVEMENT MARKING REMOVAL - WATER BLASTING	
					70300100	70300100	70300150	70300150	78009004	78009004	78009008	X0327980	X0327980				
					SHORT TERM PAVEMENT MARKING EDGE LINE	SHORT TERM PAVEMENT MARKING (2 APP)	SHORT TERM PAVEMENT MRK REM EDGE LINE	SHORT TERM PAVEMENT MRK REM (2 APP)	MOD URETH 4" (CENTER DASH)	MOD URETH 4" (EDGE LINE)	MOD URETH 8"	PAVMT MRKG REM WTR BL EDGE LINE	PAVMT MRKG REM WTR BL CENTER LINE				
DRIVING LANE	W.B.	1143+00.00	1156+00.00	1300.00	52.0	0.0	17.3	0.0	0.0	1300.0	0.0	433.3	0.0				
DRIVING LANE	W.B.	1156+00.00	1161+20.00	520.00	20.8	0.0	6.9	0.0	0.0	0.0	520.0	173.3	0.0				
SEE AUXILIARY LANE																	
DRIVING LANE	W.B.	1174+75.00	1179+55.00	480.00	19.2	0.0	6.4	0.0	0.0	0.0	480.0	320.0	0.0				
DRIVING LANE	W.B.	1179+55.00	1188+60.00	905.00	36.2	0.0	12.1	0.0	0.0	905.0	0.0	301.7	0.0				
MICRO-SURFACING OMISSION: (STA. 1188+60.00 TO 1231+55.00)																	
SEE AUXILIARY LANE																	
DRIVING LANE	W.B.	1239+80.00	1245+00.00	520.00	20.8	0.0	6.9	0.0	0.0	0.0	520.0	346.7	0.0				
DRIVING LANE	W.B.	1245+00.00	1263+00.00	1800.00	72.0	0.0	24.0	0.0	0.0	1800.0	0.0	600.0	0.0				
DRIVING LANE	W.B.	1263+00.00	1267+00.00	400.00	16.0	0.0	5.3	0.0	0.0	0.0	400.0	266.7	0.0				
SEE AUXILIARY LANE																	
STRUCTURE OMISSION: S.N. 010-0022/23 (STA. 1279+10.00 TO 1280+60.00)																	
SEE AUXILIARY LANE																	
DRIVING LANE	W.B.	1306+50.00	1311+30.00	480.00	19.2	0.0	6.4	0.0	0.0	0.0	480.0	320.0	0.0				
DRIVING LANE	W.B.	1311+30.00	1320+43.38	913.38	36.5	0.0	12.2	0.0	0.0	913.4	0.0	304.5	0.0				
STRUCTURE OMISSION: S.N.010-0024 (STA. 1320+43.38 TO 1322+86.74)																	
DRIVING LANE	W.B.	1322+86.74	1330+75.00	788.26	31.5	0.0	10.5	0.0	0.0	788.3	0.0	262.8	0.0				
DRIVING LANE	W.B.	1330+75.00	1334+75.00	400.00	16.0	0.0	5.3	0.0	0.0	0.0	400.0	266.7	0.0				
DRIVING LANE	W.B.	1334+75.00	1338+43.00	368.00	0.0	73.6	0.0	49.1	100.0	0.0	0.0	0.0	30.7				
DRIVING LANE	W.B.	1338+43.00	1346+50.00	807.00	32.3	0.0	10.8		0.0	807.0	0.0	269.0	0.0				
AUXILIARY LANE	W.B.	1160+80.00	1174+60.00	1380.00	55.2	276.0	18.4	184.0	350.0	1380.0	0.0	460.0	115.0				
AUXILIARY LANE	W.B.	1231+55.00	1240+00.00	845.00	33.8	169.0	11.3	112.7	220.0	845.0	0.0	281.7	70.4				
AUXILIARY LANE	W.B.	1266+78.00	1279+10.00	1232.00	49.3	246.4	16.4	164.3	310.0	1232.0	0.0	410.7	102.7				
STRUCTURE OMISSION: S.N. 010-0022/23 (STA. 1279+10.00 TO 1280+60.00)																	
AUXILIARY LANE	W.B.	1280+60.00	1306+40.00	2580.00	103.2	516.0	34.4	344.0	650.0	2580.0	0.0	860.0	215.0				
PASSING LANE	W.B.	1143+00.00	1188+60.00	4560.00	182.4	912.0	60.8	608.0	1140.0	4560.0	0.0	1520.0	380.0				
MICRO-SURFACING OMISSION: (STA. 1188+60.00 TO 1231+55.00)																	
PASSING LANE	W.B.	1231+55.00	1279+10.00	4755.00	190.2	951.0	63.4	634.0	1190.0	4755.0	0.0	1585.0	396.3				
STRUCTURE OMISSION: S.N. 010-0022/23 (STA. 1279+10.00 TO 1280+60.00)																	
PASSING LANE	W.B.	1280+60.00	1320+43.38	3983.38	159.3	796.7	53.1	531.1	1000.0	3983.4	0.0	1327.8	331.9				
STRUCTURE OMISSION: S.N.010-0024 (STA. 1320+43.38 TO 1322+86.74)																	
PASSING LANE	W.B.	1322+86.74	1346+50.00	2363.26	94.5	472.7	31.5	315.1	600.0	2363.3	0.0	787.8	196.9				
SUB-TOTAL =					1240.5	4413.3	413.5	2942.2	5560.0	28212.3	2800.0	11097.4	1838.9				
TOTAL =					2470.2	8985.9	823.4	5990.6	11330.0	56198.6	5507.0	22124.9	3744.1				
USE =					11457.0		6814.0		67529.0		5507.0	25869.0					

** NOTE:
ADDITIONAL QUANTITIES FOR SHORT TERM PAVEMENT MARKING AND SHORT TERM PAVEMENT MARKING REMOVAL IS LOCATED ON SHEET 7 OF 9

MODEL: 4-MODEL\MAR15
FILE: MAR15_PAV\MAR15\0570D98\CADD\DATA\Design\0570D98-PH-Schedule

USER NAME = BakerCR	DESIGNED -	REVISED -	STATE OF ILLINOIS DEPARTMENT OF TRANSPORTATION	SCHEDULE OF QUANTITIES	F.A.J RTE.	SECTION	COUNTY	TOTAL SHEETS	SHEET NO.	
	DRAWN -	REVISED -			74	14 MICRO 2020-1	CHAMPAIGN	21	16	
PLOT SCALE = 40.0000 ' / in.	CHECKED -	REVISED -			CONTRACT NO. 70D98					
PLOT DATE = 3/21/2019	DATE -	REVISED -			SCALE:	SHEET 6 OF 9 SHEETS	STA.	TO STA.	ILLINOIS FED. AID PROJECT	

SCHEDULE OF QUANTITIES

70300100	SHORT TERM PAVEMENT MARKING													
70300150	SHORT TERM PAVEMENT MARKING REMOVAL													
78000200	THERMOPLASTIC PAVEMENT MARKING - LINE 4"													
78000500	THERMOPLASTIC PAVEMENT MARKING - LINE 8"													
78004210	PREFORMED PLASTIC PAVEMENT MARKING, TYPE B - INLAID - LINE 4"													
X7830070	GROOVING FOR RECESSED PAVEMENT MARKING 5"													
X7830076	GROOVING FOR RECESSED PAVEMENT MARKING 9"													
						70300100	70300100	70300150	70300150	78000200	78000500	78004210	X7830070	X7830076
						SHORT TERM PAVEMENT MARKING EDGE	SHORT TERM PAVEMENT MARKING CENTER (2)	SHORT TERM PAVEMENT MRK REM EDGE	SHORT TERM PAVEMENT MRK REM CENTER	THPL PVT MK LINE 4	THPL PVT MK LINE 8	PREF PL PM TB INL L4	GRV RCSD PVT MRKG 5	GRV RCSD PVT MRKG 9
LOCATION	DIRECTION	STATION	TO	STATION	LENGTH	FOOT	FOOT	SQ FT	SQ FT	FOOT	FOOT	FOOT	FOOT	FOOT
DRIVING LANE		1346+50.00		1374+26.36	2776.36	111.1	555.3	37.0	185.1	2776.4	0.0	0.0	2776.4	0.0
STRUCTURE OMISSION: S.N. 010-0025/26 (STA. 1372+04.45 TO 1374+26.36)														
DRIVING LANE	E.B.	1374+26.36		1384+00.00	973.64	38.9	194.7	13.0	64.9	973.6	0.0	0.0	973.6	0.0
RAMP	E.B.	1384+00.00		1387+56.00	356.00	14.2	0.0	4.7	0.0	0.0	356.0	0.0	0.0	356.0
DRIVING LANE	E.B.	1387+56.00		1406+46.00	1890.00	75.6	378.0	25.2	126.0	1890.0	0.0	0.0	1890.0	0.0
RAMP	E.B.	1406+46.00		1410+10.00	364.00	14.6	0.0	4.9	0.0	0.0	364.0	0.0	0.0	364.0
DRIVING LANE	E.B.	1410+10.00		1425+21.00	1511.00	60.4	302.2	20.1	100.7	1511.0	0.0	0.0	1511.0	0.0
PASSING LANE	E.B.	1346+50.00		1372+04.45	2554.45	102.2	510.9	34.1	170.3	2554.5	0.0	638.6	2554.5	0.0
STRUCTURE OMISSION: S.N. 010-0025/26 (STA. 1372+04.45 TO 1374+26.36)														
PASSING LANE	E.B.	1374+26.36		1425+21.00	5094.64	203.8	1018.9	67.9	339.6	5094.6	0.0	1273.7	5094.6	0.0
SUB-TOTAL =						620.8	2960.0	206.9	986.7	14800.1	720.0	1912.3	14800.1	720.0
DRIVING LANE	W.B.	1346+50.00		1372+21.57	2571.57	102.9	514.3	34.3	171.4	2571.6	0.0	0.0	2571.6	0.0
STRUCTURE OMISSION: S.N. 010-0025/26 (STA. 1372+21.57 TO 1374+43.88)														
DRIVING LANE	W.B.	1374+43.88		1403+05.00	2861.12	114.4	572.2	38.1	190.7	2861.1	0.0	0.0	2861.1	0.0
RAMP	W.B.	1403+05.00		1406+65.00	360.00	14.4	0.0	4.8	0.0	0.0	360.0	0.0		360.0
DRIVING LANE	W.B.	1406+65.00		1421+70.00	1505.00	60.2	301.0	20.1	100.3	1505.0	0.0	0.0	1505.0	0.0
RAMP	W.B.	1421+70.00		1425+30.00	360.00	14.4	0.0	4.8	0.0	0.0	360.0	0.0		360.0
DRIVING LANE	W.B.	1425+30.00		1427+50.00	220.00	8.8	44.0	2.9	14.7	220.0	0.0	0.0	220.0	0.0
PASSING LANE	W.B.	1346+50.00		1372+21.57	2571.57	102.9	514.3	34.3	171.4	2571.6	0.0	642.9	2571.6	0.0
STRUCTURE OMISSION: S.N. 010-0025/26 (STA. 1372+21.57 TO 1374+43.88)														
PASSING LANE	W.B.	1374+43.88		1427+50.00	5306.12	212.2	1061.2	70.7	353.7	5306.1	0.0	1326.5	5306.1	0.0
SUB-TOTAL =						630.2	3007.1	210.1	1002.4	15035.4	720.0	1969.4	15035.4	720.0
TOTAL =						1251.0	5967.1	417.0	1989.0	29835.5	1440.0	3881.7	29835.5	1440.0
USE =						7219.0		2407.0		29836.0	1440.0	3882.0	29836.0	1440.0

MODEL: 4\MODEL\MAR18
FILE: MAR18_Plot\Illinois\gov\PI\DOT\Documents\DOT_Offices\Illinet 5\Projects\0570D98\CADD\Design\0570D98-Plt-schedule

SCHEDULE OF QUANTITIES

DIRECTION	LOCATION	STA.	TO	STA.	LENGTH OF NEED SEE NOTE (1)	63000001	63100045	63100085	63100167	63200310	72501000	78200005
						SPBGR TY A 6FT POSTS FOOT	TRAF BAR TERM T2 EACH	TRAF BAR TERM T6 EACH	TR BAR TRM T1 SPL TAN EACH	GUARDRAIL REMOVAL FOOT	TERMINAL MARKER - DA EACH	GRDRAIL REF TYPE A EACH
E.B.	PROSPECT AVE. OVERPASS BRIDGE	1146+43.00		1146+05.50	238.6	0.0	0.0	1.0	0.0	86.0	1.0	4.0
		1146+05.50		1144+43.00		162.5	0.0	0.0	0.0			
		1144+43.00		1144+05.50		0.0	0.0	0.0	1.0			
	NEIL ST. SIGN EXIT 182	MEETS REQUIREMENTS			0.0					0.0	0.0	0.0
	NEIL ST. OFF RAMP	1174+48.00		1174+10.50	SEE NOTE (2)	0.0	0.0	1.0	0.0	314.0	1.0	4.0
		1174+10.50		1171+73.00		237.5	0.0	0.0	0.0			
		1171+73.00		1171+35.50		0.0	0.0	0.0	1.0			
	NEIL ST. OVERPASS BRIDGE	1186+26.00		1185+88.50	238.6	0.0	0.0	1.0	0.0	84.0	1.0	4.0
		1185+88.50		1184+26.00		162.5	0.0	0.0	0.0			
		1184+26.00		1183+88.50		0.0	0.0	0.0	1.0			
	LINCOLN OFF RAMP	MEETS REQUIREMENTS			0.0					0	0	0
	LINCOLN OVERPASS BRIDGE	1253+74.00		1253+36.50	238.6	0.0	0.0	1.0	0.0	141.0	1.0	4.0
		1253+36.50		1251+74.00		162.5	0.0	0.0	0.0			
		1251+74.00		1251+36.50		0.0	0.0	0.0	1.0			
	EXIT SIGN 184	1279+51.00		1279+13.50	341.3	0.0	0.0	1.0	0.0	153.0	1.0	5.0
		1279+13.50		1276+51.00		262.5	0.0	0.0	0.0			
		1276+51.00		1276+13.50		0.0	0.0	0.0	1.0			
	EXIT 184 TO 45 SIGN	MEETS REQUIREMENT			0.0					0.0	0.0	0.0
	EXIT ON RAMP SIGN TO 45	MEETS REQUIREMENTS			0.0					0.0	0.0	0.0
	I-74 OVERPASS BRIDGE	1320+50.00		1320+12.50	322	0.0	0.0	1.0	0.0	300.0	1.0	4.0
		1320+12.50		1317+62.50		250.0	0.0	0.0	0.0			
		1317+62.50		1317+25.00		0.0	0.0	0.0	1.0			
	STRUCTURE NEAR BROWN FIELD OVERPASS	MEETS REQUIREMENTS			0.0					0	0	0
	BROWN FIELD OVERPASS	1356+10.00		1355+72.50	266.3	0.0	0.0	1.0	0.0	276.0	1.0	4.0
		1355+72.50		1353+85.00		187.5	0.0	0.0	0.0			
		1353+85.00		1353+47.50		0.0	0.0	0.0	1.0			
	STRUCTURE NEAR 185 EXIT SIGN	1372+17.00		1371+79.50	422.7	0.0	0.0	1.0	0.0	410.0	1.0	4.0
		1371+79.50		1368+29.50		350.0	0.0	0.0	0.0			
		1368+29.50		1367+92.00		0.0	0.0	0.0	1.0			
	URBANA SPUR OVERPASS BRIDGE	1399+22.00		1398+84.50	SEE NOTE (2)	0.0	0.0	1.0	0.0	373.0	1.0	5.0
		1398+84.50		1395+97.00		287.5	0.0	0.0	0.0			
		1395+97.00		1395+59.50		0.0	0.0	0.0	1.0			
SUB-TOTAL						2062.5	0.0	9.0	9.0	2137.0	9.0	38.0

CONTINUED SHEET 9 OF 9

MODEL: \\MODEL\MRFS
FILE: \\mrfs\p\14181\14181.dwg
PROJECT: \\PROJECTS\DOT\Office\14181\14181.dwg
SHEET: 9 OF 9

USER NAME = BakerCR	DESIGNED -	REVISED -
	DRAWN -	REVISED -
PLOT SCALE = 40,0000 ' / in.	CHECKED -	REVISED -
PLOT DATE = 3/21/2019	DATE -	REVISED -

**STATE OF ILLINOIS
DEPARTMENT OF TRANSPORTATION**

SCHEDULE OF QUANTITIES

SCALE: SHEET 8 OF 9 SHEETS STA. TO STA.

F.A.J. RTE.	SECTION	COUNTY	TOTAL SHEETS	SHEET NO.
74	14 MICRO 2020-1	CHAMPAIGN	21	18
CONTRACT NO. 70D98				
		ILLINOIS	FED. AID PROJECT	

SCHEDULE OF QUANTITIES

DIRECTION	LOCATION	STA.	TO	STA.	LENGTH OF NEED SEE NOTE (1)	63000001	63100045	63100085	63100167	63200310	72501000	78200005
						SPBGR TY A 6FT POSTS FOOT	TRAF BAR TERM T2 EACH	TRAF BAR TERM T6 EACH	TR BAR TRM T1 SPL TAN EACH	GUARDRAIL REMOVAL FOOT	TERMINAL MARKER - DA EACH	GRDRAIL REF TYPE A EACH
W.B	PROSPECT AVE. OVERPASS BRIDGE	1147+04.00		1147+41.50	238.6	0.0	0.0	1.0	0.0	86.0	1.0	4.0
		1147+41.50		1149+04.00		162.5	0.0	0.0	0.0			
		1149+04.00		1149+41.50		0.0	0.0	0.0	1.0			
	PROSPECT EXIT SIGN	MEET REQUIREMENTS		0.0						0.0	0.0	0.0
	NEIL ST OVERPASS BRIDGE	1187+99.00		1188+36.50	238.6	0.0	0.0	1.0	0.0	86.0	1.0	4.0
		1188+36.50		1189+99.00		162.5	0.0	0.0	0.0			
		1188+99.00		1190+36.50		0.0	0.0	0.0	1.0			
	LINCOLN ST. OVERPASS BRIDGE	1254+64.00		1255+26.50	238.6	0.0	0.0	1.0	0.0	154.0	1.0	4.0
		1255+26.50		1256+89.00		162.5	0.0	0.0	0.0			
		1256+89.00		1257+26.50		0.0	0.0	0.0	1.0			
	LINCOLN ON RAMP	1265+89.00		1271+64.00	SEE NOTE (2)	575.0	1.0	0.0	0.0	654.0	2.0	8.0
		1271+64.00		1272+01.50		0.0	0.0	0.0	1.0			
						0.0	0.0	0.0	0.0			
	LINCOLN AVE EXIT SIGN	1280+36.00		1280+73.50	SEE NOTE (2)	0.0	0.0	1.0	0.0	416.0	1.0	4.0
		1280+73.50		1283+98.50		325.0	0.0	0.0	0.0			
		1283+98.50		1284+36.00		0.0	0.0	0.0	1.0			
	I-74 OVERPASS (DEP)	MEETS REQUIREMENTS		0						0.0	0.0	0.0
	I-74 OVERPASS (APP)	1221+32.00		122169.5	SEE NOTE (2)	0.0	0.0	1.0	0.0	296.0	1.0	4.0
		1221+69.50		1323+82.00		212.5	0.0	0.0	0.0			
		1323+82.00		1324+19.50		0.0	0.0	0.0	1.0			
	EXIT 184 GAS SIGN	MEETS REQUIREMENTS		0						0.0	0.0	0.0
	BROWNFIELD OVERPASS	1356+75.00		1357+12.50	SEE NOTE (2)	0.0	0.0	1.0	0.0	283.0	1.0	4.0
		1357+12.50		1359+37.50		225.0	0.0	0.0	0.0			
		1359+37.50		1359+74.50		0.0	0.0	0.0	1.0			
	FOOD EXIT SIGN 184	1374+00.00		1374+37.50	SEE NOTE (2)	0.0	0.0	1.0	0.0	300.0	1.0	4.0
		1374+37.50		1377+25.00		287.5	0.0	0.0	0.0			
		1377+25.00		1377+62.50		0.0	0.0	0.0	1.0			
	URBANA SPUR BRIDGE	1400+32.00		1400+69.50	SEE NOTE (2)	0.0	0.0	1.0	0.0	319.0	1.0	4.0
		1400+69.50		1403+32.00		262.5	0.0	0.0	0.0			
		1403+32.00		1403+69.50		0.0	0.0	0.0	1.0			
SUB-TOTAL						2375.0	1.0	8.0	9.0	2594.0	10.0	40.0
TOTAL						4437.5	1.0	17.0	18.0	4731.0	19.0	78.0

NOTE (1):
 THE ENDS OF SOME GUARDRAIL TERMINAL PRODUCTS HAVE REDIRECTIVE ABILITIES BEGINNING AT THE FIRST POST, BUT FOR DESIGN PURPOSES, ASSUME THE LENGTH OF NEED BEGINS AT THE THIRD POST, 12 FT 6 IN FROM THE FREE END. THE TRAFFIC BARRIER TERMINAL TYPE 1, SPECIAL (TBT TI) MUST PROVIDE 37.5 FT TO THE LENGTH OF NEED (LON).

NOTE (2):
 THE LOCATION AND QUANTITY OF THE PROPOSED GUARDRAIL IS TO REPLACE THE EXISTING GUARDRAIL AT ITS CURRENT LOCATION.

MODEL: \\MODEL\NAME FILE: NAME: \\path\to\file\name.dwg Project: 0570098\CADD\Drawings\0570098-ht-schedule

USER NAME = BakerCR	DESIGNED -	REVISED -
	DRAWN -	REVISED -
PLOT SCALE = 40,0000 ' / in.	CHECKED -	REVISED -
PLOT DATE = 3/21/2019	DATE -	REVISED -

**STATE OF ILLINOIS
 DEPARTMENT OF TRANSPORTATION**

SCHEDULE OF QUANTITIES

SCALE: SHEET 9 OF 9 SHEETS STA. TO STA.

F.A.J. RTE.	SECTION	COUNTY	TOTAL SHEETS	SHEET NO.
74	14 MICRO 2020-1	CHAMPAIGN	21	19
CONTRACT NO. 70D98				
ILLINOIS FED. AID PROJECT				

CENTERLINE INTERSTATE OR MULTI-LANE TWO WAY DIVIDED HIGHWAY

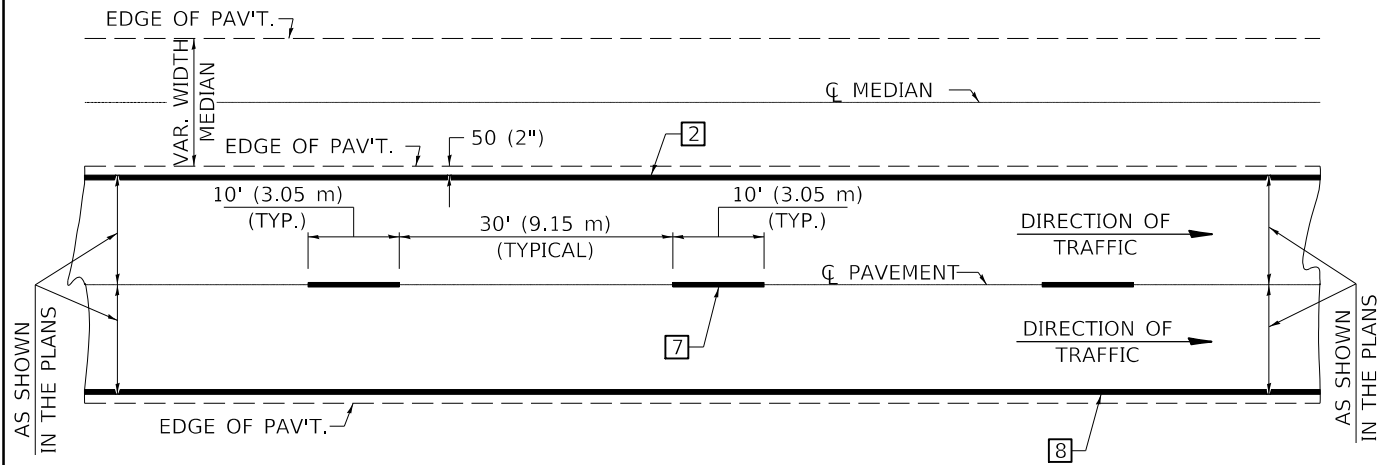

NOTE: PAVEMENT MARKINGS ARE TO BE EXTENDED THROUGH OMISSIONS WHEN APPLICABLE.

NOTE: SEE ARTICLES 780.04 & 781.03 FOR LOCATION OF STRIPES AND MARKERS RELATIVE TO EDGES OR JOINTS.

FOR RAISED REFLECTIVE PAVEMENT MARKERS, REFER TO STANDARD 781001.

TYPICAL PAVEMENT MARKING LEGEND

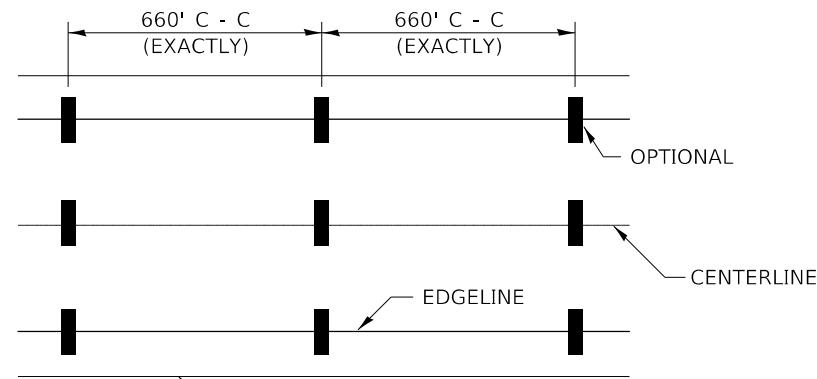

- 1 4" (100) SKIP-DASH (YELLOW)
- 2 4" (100) SOLID (YELLOW)
- 3 12" (300) DIAGONAL (YELLOW)
- 4 4" (100) DOUBLE YELLOW (NARROW)
- 5 RESERVED
- 6 RESERVED
- 7 4" (100) SKIP-DASH (WHITE)
- 8 4" (100) SOLID (WHITE)
- 9 12" (300) DIAGONAL (WHITE)
- 10 6" (150) SOLID (WHITE)
- 11 24" (600) STOP BAR (WHITE)
- 12 8" (200) SOLID (WHITE)
- 13 4" (100) LANE LINE EXTENSIONS (WHITE)

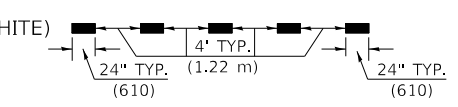
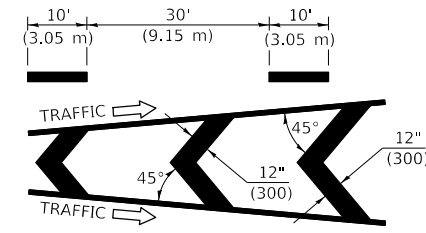
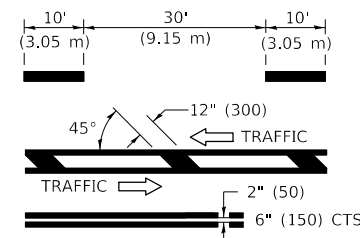

TYPICAL EXIT RAMP TERMINAL

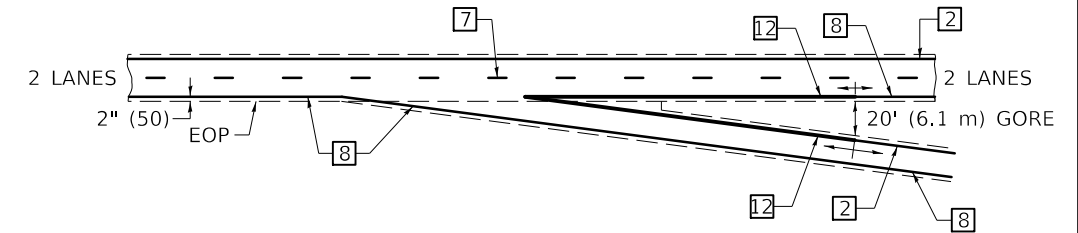

EXIT RAMP TERMINAL with EXCLUSIVE (auxiliary) LANE

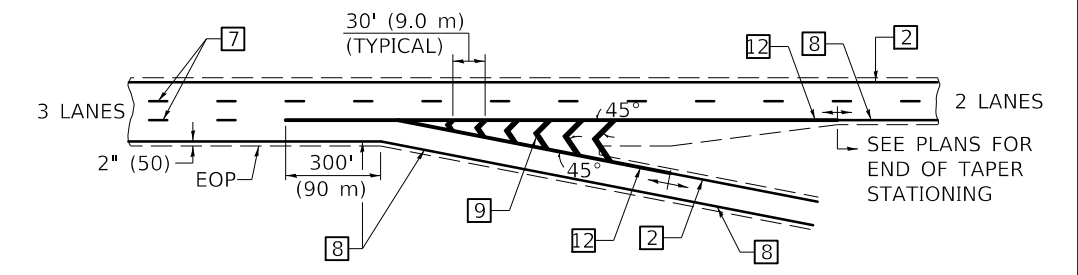

TYPICAL ENTRANCE RAMP TERMINAL

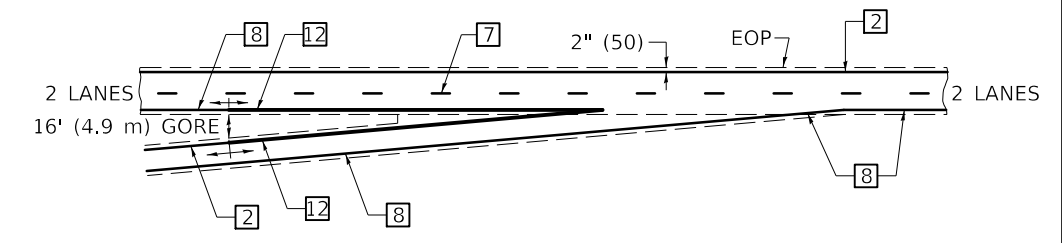

ENTRANCE RAMP TERMINAL with EXCLUSIVE LANE

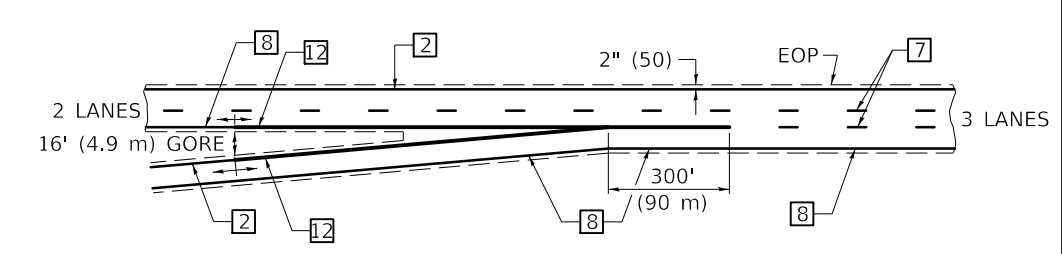

EDGE OF PAVED SHOULDER
 CENTERLINE OR EDGELINE
 IT WILL BE NECESSARY TO HAVE A REPRESENTATIVE OF THE STATE POLICE PRESENT SO THAT THE ACCURACY OF MEASUREMENT CAN BE ATTESTED TO IN COURT.

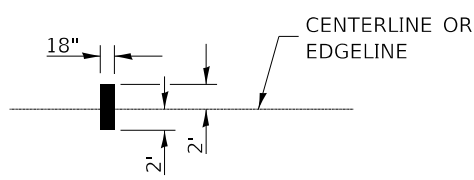

AERIAL SPEED CHECK ZONES

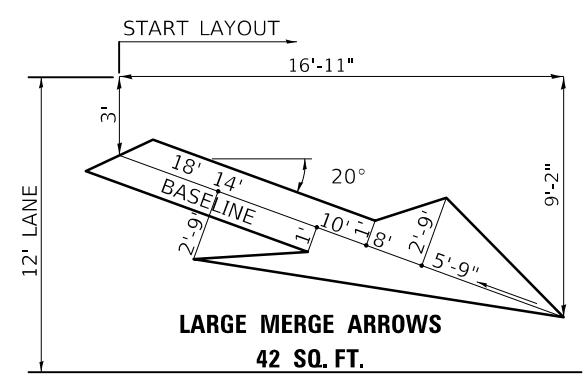

LARGE MERGE ARROWS
 42 SQ. FT.

Note: All dimensions are in INCHES (millimeters) unless otherwise shown.

DISTRICT 5 DETAIL NO. 7800BBBB

USER NAME = BakerCR	DESIGNED -	REVISED - 11/06
DRAWN -	CHECKED -	REVISED -
PLOT SCALE = 40,0000 ' / in.	DATE -	REVISED -
PLOT DATE = 3/21/2019		

STATE OF ILLINOIS
DEPARTMENT OF TRANSPORTATION

PAVEMENT MARKING (INTERSTATE & MULTI-LANE APPLICATIONS)

SCALE: SHEET 1 OF 1 SHEETS STA. TO STA.

F.A.J. RTE.	SECTION	COUNTY	TOTAL SHEETS	SHEET NO.
74	14 MICRO 2020-1	CHAMPAIGN	21	20
CONTRACT NO. 70D98				
ILLINOIS FED. AID PROJECT				

MODEL: s:\MODEL\MAR15
 FILE: MAR15 - PavementMarking.dwg
 PROJECT: 70D98
 DRAWN: BakerCR
 CHECKED: BakerCR
 DATE: 3/21/2019
 SCALE: 40,0000 ' / in.
 PLOT DATE: 3/21/2019

DETAIL FOR TEMPORARY PORTABLE RUMBLE STRIPS

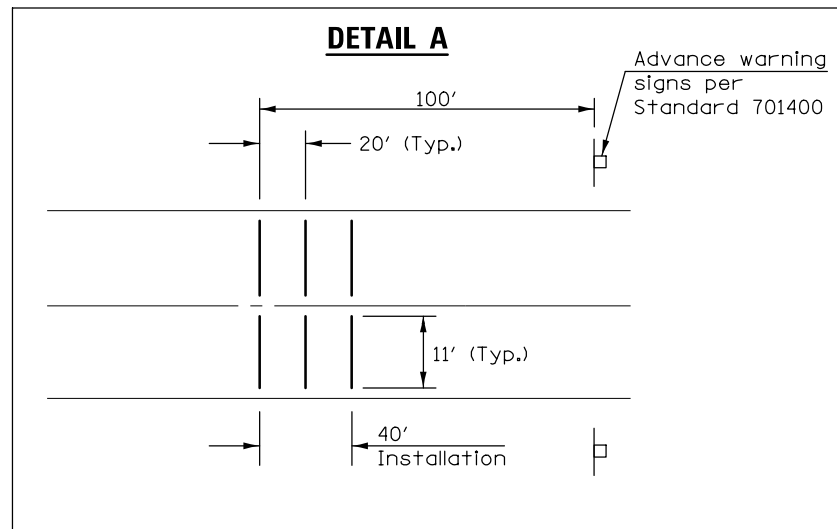
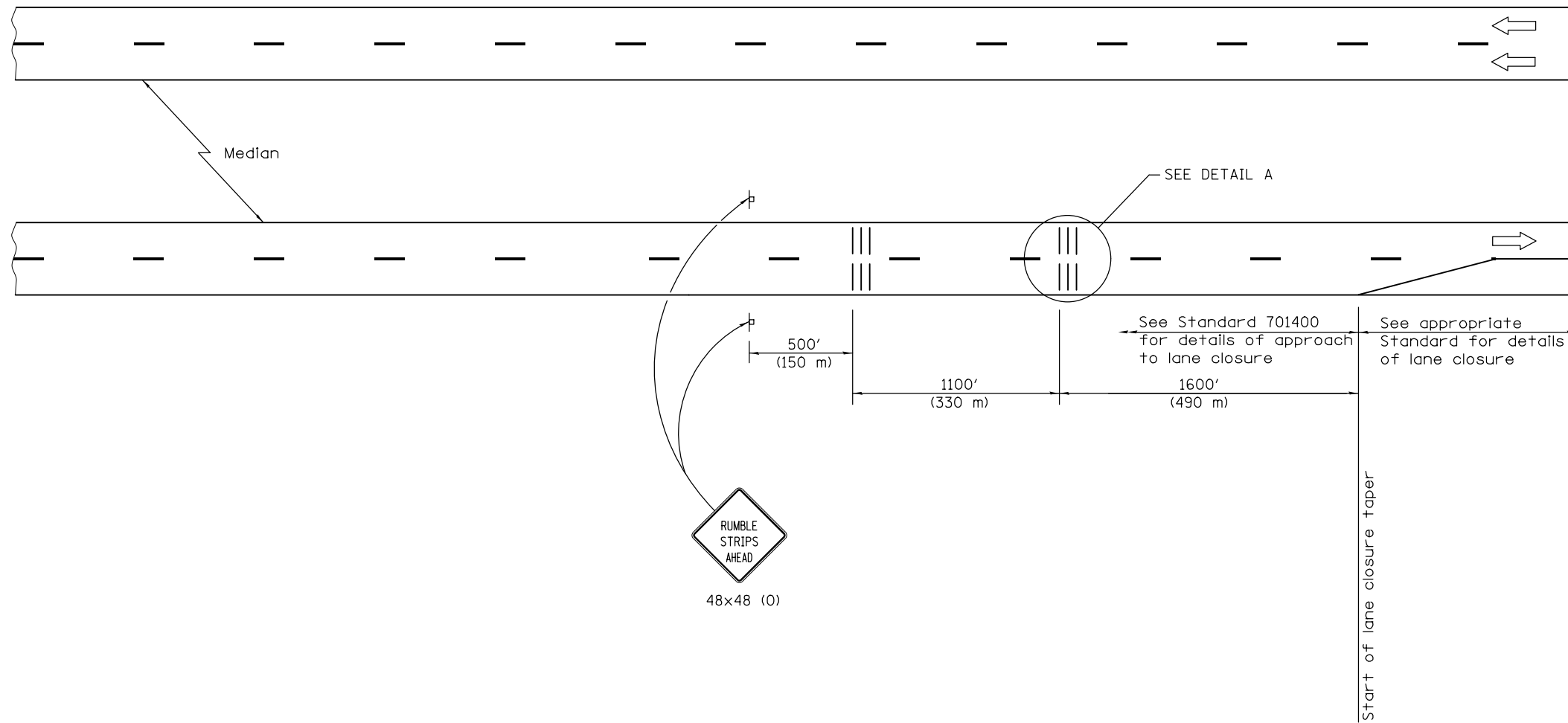

SYMBOLS

- ┆ Sign
- ||| Temporary Portable Rumble Strips

GENERAL NOTES

Remove the Temporary Portable Rumble Strips prior to the removal of the advanced warning signs.

All dimensions are in inches (millimeters) unless otherwise shown.

FILE NAME =	USER NAME = BakerCR	DESIGNED - JWS	REVISED -	STATE OF ILLINOIS DEPARTMENT OF TRANSPORTATION	DETAIL FOR TEMPORARY PORTABLE RUMBLE STRIPS	F.A.I. RTE.	SECTION	COUNTY	TOTAL SHEETS	SHEET NO.	
pw:\planroom.dot.illinois.gov\PIDOT\Documents\IDOT Offices\District 5\Projects\05700\BROADWAY\Design\BB098-shr-cadd details	DRAWN -	CHECKED -	REVISED -			74	14 MICRO 2020-1	CHAMPAIGN	21	21	
MODELNAME	PLOT DATE = 3/21/2019	DATE - 12/14/16	REVISED -			CONTRACT NO. 70D98			ILLINOIS FED. AID PROJECT		
					SCALE: NONE	SHEET 1 OF 1 SHEETS		STA.	TO STA.		