

P.I. Station	100+19.01	P.I. Station	100+60.51	P.I. Station	101+49.55	P.I. Station	103+19.64	P.I. Station	104+46.11	P.I. Station	106+42.47
Delta	2° 07' 22" (LT)	Delta	2° 25' 10" (LT)	Delta	26° 36' 14" (LT)	Delta	11° 37' 21" (LT)	Delta	15° 27' 14" (RT)	Delta	69° 44' 26" (LT)
Radius	200'	Radius	100'	Radius	200'	Radius	400'	Radius	300'	Radius	85'
Tangent	3.71'	Tangent	2.11'	Tangent	47.29'	Tangent	40.71'	Tangent	40.71'	Tangent	59.23'
Length	7.41'	Length	4.22'	Length	92.87'	Length	81.14'	Length	80.92'	Length	103.46'
External	0.03'	External	0.02'	External	5.51'	External	2.07'	External	2.75'	External	18.60'
Long Chord	7.41'	Long Chord	4.22'	Long Chord	92.03'	Long Chord	81.00'	Long Chord	80.67'	Long Chord	97.19'
P.C. Station	100+15.31	P.C. Station	100+58.40	P.C. Station	101+02.26	P.C. Station	102+78.93	P.C. Station	104+05.41	P.C. Station	105+83.24
P.T. Station	100+22.72	P.T. Station	100+62.62	P.T. Station	101+95.13	P.T. Station	103+60.07	P.T. Station	104+86.32	P.T. Station	106+86.71
Back	N 41° 08' 37" W	Back	N 43° 15' 59" W	Back	N 45° 41' 09" W	Back	N 72° 17' 24" W	Back	N 83° 54' 45" W	Back	N 68° 27' 31" W
Ahead	N 43° 15' 59" W	Ahead	N 45° 41' 09" W	Ahead	N 72° 17' 24" W	Ahead	N 83° 54' 45" W	Ahead	N 68° 27' 31" W	Ahead	S 41° 48' 03" W

F.A. RTE.	SECTION	COUNTY	TOTAL SHEETS	SHEET NO.
		ST. CLAIR	18	6
STA. 100+00		TO STA. 106+00		
FED. ROAD DIST. NO.		ILLINOIS FED. AID PROJECT		CONTRACT NO. 44966

PLAN	DATE
BY	
REVISIONS	
NO.	DESCRIPTION
1	AS SHOWN

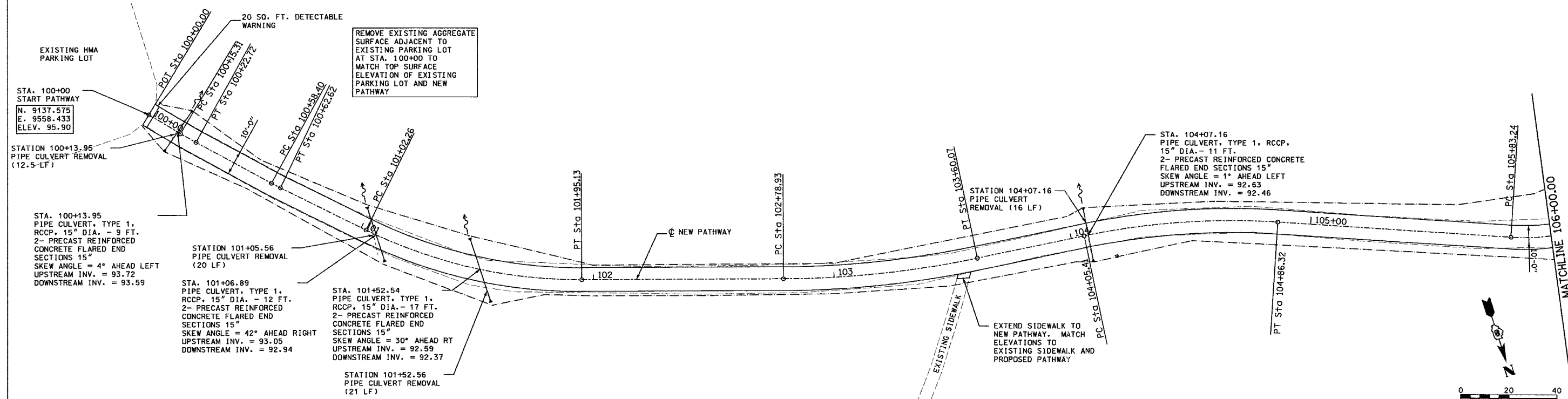

PROFILE	DATE
BY	
REVISIONS	
NO.	DESCRIPTION
1	AS SHOWN

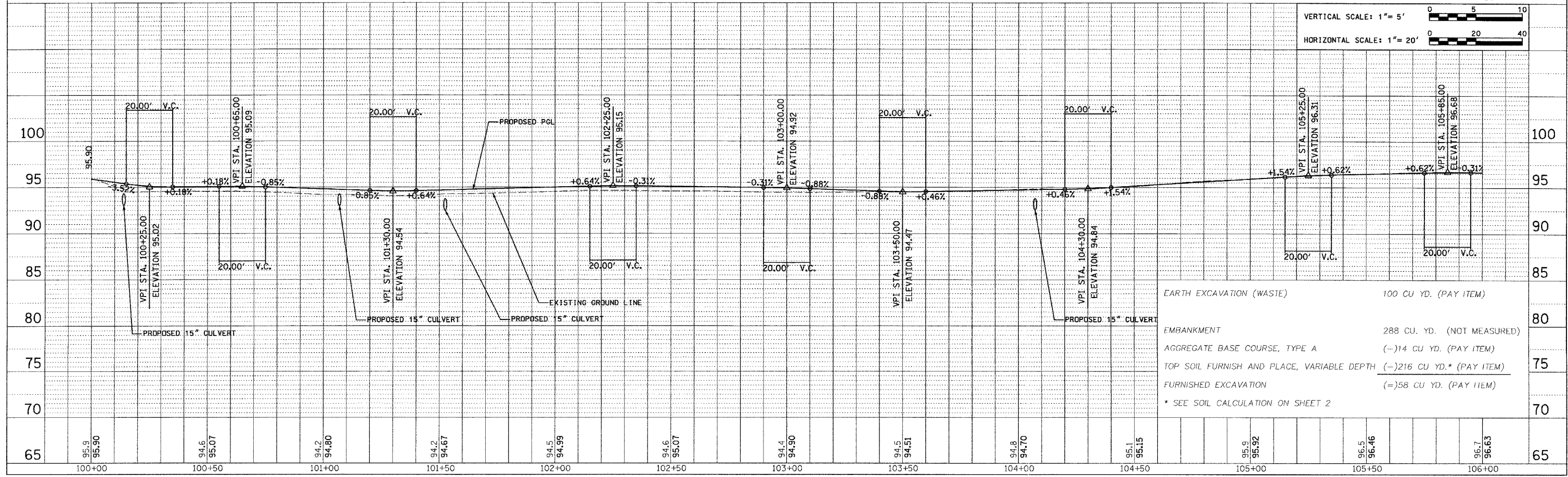

2/27/2007 8:54:40 AM