

CONTRACT NO.				
F.A.P. RTE.	SECTION	COUNTY	TOTAL SHEETS	SHEET NO.
350	42RS	COOK	31	9
STA. 402+00		TO STA. 431+60		
FED. ROAD DIST. NO.		ILLINOIS FED. AID PROJECT		

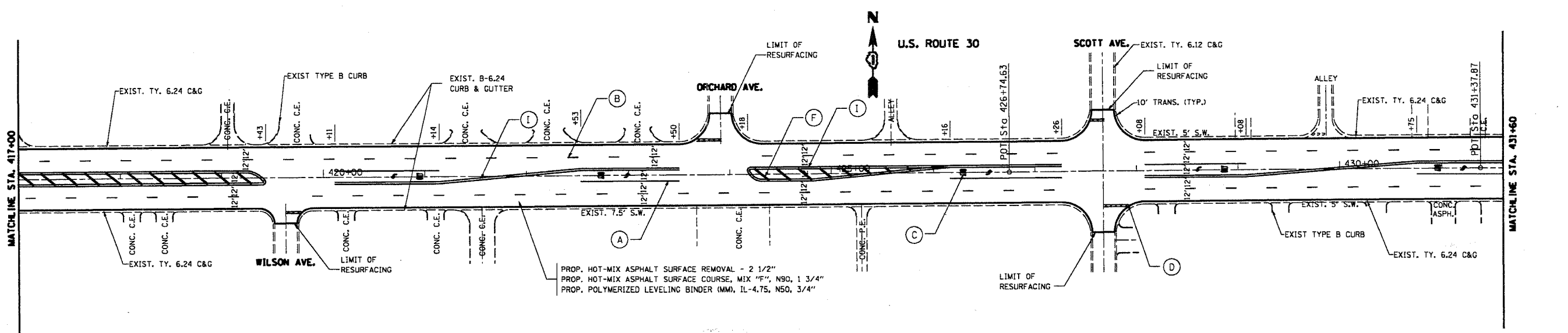
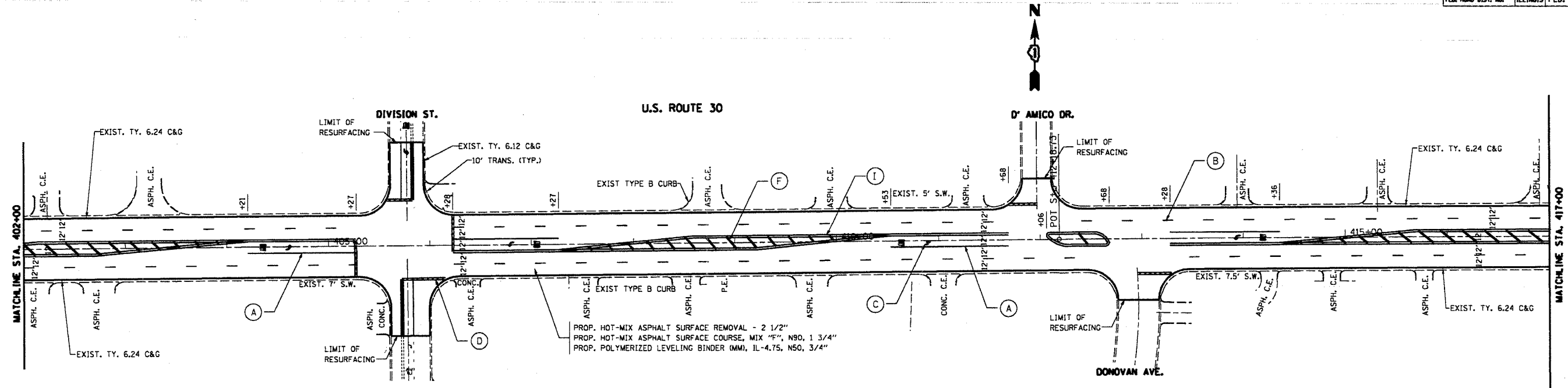

- (A) 6" WHITE - TURN LANE LINE (TYP.)
- (B) 4" WHITE - SKIP-DASH CENTERLINE (TYP.) (10' LINE/30' SPACE)
- (C) 8" WHITE - LETTERS & SYMBOLS (TYP.) (LEFT TURN ONLY, RIGHT TURN ONLY)
- (D) 24" SOLID WHITE - STOP & TRANSVERSE LINES (TYP.)
- (E) 6" WHITE - CROSSWALK LINE (TYP.) (2 @ 6' C-C)
- (F) 12" YELLOW - 45° DIAGONAL (75' C-C OR MINIMUM OF 5')
- (G) 4" YELLOW - MEDIAN EDGE LINE (TYP.)
- (H) 24" TRANSVERSE LINE - RAILROAD CROSSING (TYP.) 6' LETTERS FOR "RR"; 16" LINE FOR "X"
- (I) 4" YELLOW - DOUBLE YELLOW PAINTED MEDIAN (TYP.) (2 @ 11" C-C)
- (J) 6" WHITE - DOTTED LINE (TYP.) (2' LINE/6' SPACE)
- (K) 8" WHITE - SOLID LINE
- (L) 12" WHITE - CHEVRON LINE
- (M) 6" WHITE - DOTTED LINE (TYP.) (3' LINE/12' SPACE)
- (N) 4" YELLOW - TRANSVERSE MARKING

REVISIONS	
NAME	DATE

ILLINOIS DEPARTMENT OF TRANSPORTATION

ROADWAY PLAN
U.S. ROUTE 30
(WESTERN AVE. TO 0.5 MI EAST OF ILL 1)

SCALE: VERT. 1"=50'
HORIZ. DATE 12/28/2006

DRAWN BY
CHECKED BY

PLOT DATE 12/28/2006
 FILE NAME C:\Users\msh111806\Documents\111806\42rs\42rs.dgn
 PLOT SCALE 1/8"=1'-0"
 USER NAME msh111806