

F.A.I. RTE.	SECTION	COUNTY	TOTAL SHEETS	SHEET NO.
55	99 (1&2) WRS-3	WILL	305	14
STA. 905+68.87 TO STA. 921+36.43		ILLINOIS FED. AID PROJECT		
		TYP 04 OF 11		

EXISTING

- (A) BITUMINOUS CONCRETE SHOULDER REMOVAL
- (B) HOT-MIX ASPHALT SURFACE REMOVAL, 3 1/2"
- (C) HOT-MIX ASPHALT SURFACE REMOVAL, VARIABLE DEPTH
- (D) POLYMERIZED BITUMINOUS CONCRETE PAVEMENT
- (E) PAVEMENT REMOVAL
- (F) P.C.C. PAVEMENT
- (G) SUB-BASE GRANULAR MATERIAL
- (H) HOT-MIX ASPHALT BASE COURSE
- (I) BITUMINOUS CONCRETE SHOULDER
- (J) AGGREGATE SHOULDER
- (K) GUARDRAIL
- (L) AGGREGATE SUBGRADE
- (M) HOT-MIX ASPHALT BINDER COURSE
- (N) CONCRETE BARRIER

PROPOSED

- (1) POLYMERIZED HOT-MIX ASPHALT SURF. CSE, STONE MATRIX ASPH., N80, 1-3/4"
- (2) POLYMERIZED HOT-MIX ASPHALT BIND. CSE, STONE MATRIX ASPH., N80, 1-3/4"
- (3) HOT-MIX ASPHALT BASE COURSE, 8"
- (4) HOT-MIX ASPHALT BINDER COURSE, IL-19, N70, 8"
- (5) P.C.C. CONCRETE BASE COURSE, 10-1/2"
- (6) CONCRETE BARRIER, DOUBLE FACE, 42" HEIGHT
- (7) AGGREGATE SUBGRADE, 12"
- (8) SUB-BASE GRANULAR MATERIAL, TYPE B, 6"
- (9) SHOULDER RUMBLE STRIP
- (10) CONCRETE BARRIER BASE
- (11) LONGITUDINAL CONSTRUCTION JOINT AND NO. 25 EPOXY COATED DEFORMED TIE BARS (DRILL AND GROUT)
- (12) AGGREGATE SHOULDERS, TYPE B 8"
- (13) CLASS D PATCHES, 10" (SEE NOTE 1)
- (14) HOT-MIX ASPHALT BASE COURSE, 2-1/2"
- (15) HOT-MIX ASPHALT SURFACE COURSE, MIX "D", N70, 1-3/4"
- (16) HOT-MIX ASPHALT SURFACE COURSE, MIX "D", N70, 1-1/2"
- (17) AGGREGATE SHOULDERS, TYPE B (SPECIAL)
- (18) STRIP REFLECTIVE CRACK CONTROL TREATMENT
- (19) SAWED LONGITUDINAL JOINT NO. 25 EPOXY COATED DEFORMED TIE BARS
- (20) POROUS GRANULAR EMBANKMENT, SUBGRADE 12"
- (21) GEOTECHNICAL FABRIC FOR GROUND STABILIZATION

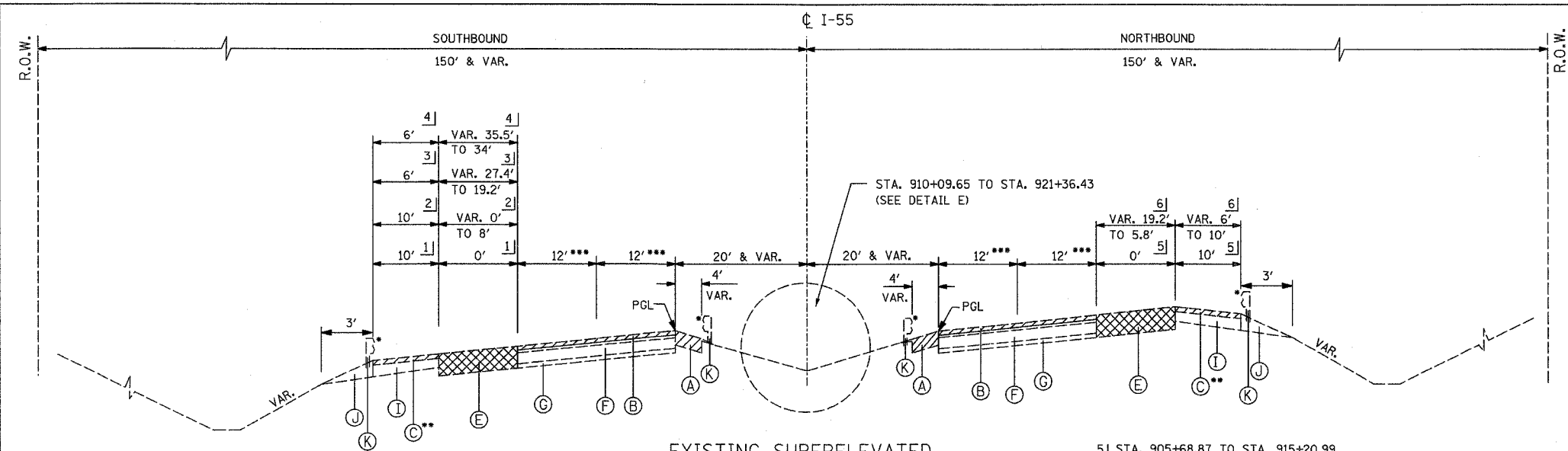

EXISTING SUPERELEVATED TYPICAL SECTION
STA. 905+68.87 TO STA. 921+36.43

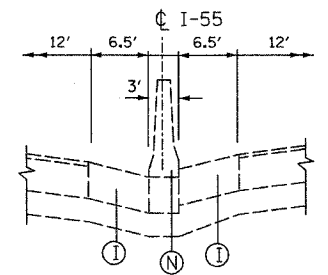

DETAIL E
STA. 910+09.65 TO STA. 921+36.43

- 1] STA. 905+68.87 TO STA. 913+98.71
- 2] STA. 913+98.71 TO STA. 919+14.77
- 3] STA. 919+14.77 TO STA. 921+10.94
- 4] STA. 921+10.94 TO STA. 921+36.43

- * FOR GUARDRAIL LOCATIONS SEE ROADWAY PLANS.
- ** SOUTHBOUND OUTSIDE BIT. CONCRETE SHOULDER REMOVAL FROM STA. 912+16.22 TO STA. 921+36.43
- *** SEE ROADWAY PLANS FOR HOT-MIX ASPHALT SURFACE REMOVAL, 3-1/2" LIMITS

- 5] STA. 905+68.87 TO STA. 915+20.99
- 6] STA. 915+20.99 TO STA. 921+36.43

- ** NORTHBOUND OUTSIDE BIT. CONCRETE SHOULDER REMOVAL FROM STA. 912+30.12 TO STA. 921+36.43
- *** SEE ROADWAY PLANS FOR HOT-MIX ASPHALT SURFACE REMOVAL, 3-1/2" LIMITS

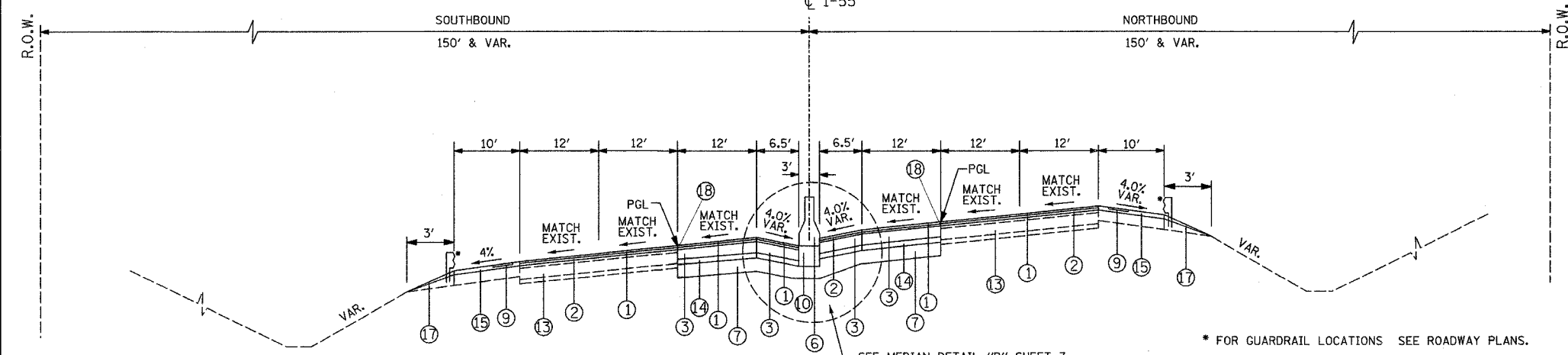

PROPOSED SUPERELEVATED TYPICAL SECTION
STA. 905+68.87 TO STA. 910+09.65

NOTES:

* FOR GUARDRAIL LOCATIONS SEE ROADWAY PLANS.

SEE MEDIAN DETAIL "B" SHEET 7

REVISIONS	
NAME	DATE

ILLINOIS DEPARTMENT OF TRANSPORTATION
FAI ROUTE 55
143RD STREET TO WEBER ROAD

TYPICAL SECTIONS

SCALE: NONE
DATE: 02-23-07

DRAWN BY: DM
CHECKED BY: DVS

