

F.A.I. RTE.	SECTION	COUNTY	TOTAL SHEETS	SHEET NO.
55	99 (1&2) WRS-3	WILL	305	91
STA.	907+00	TO STA.	937+00	
FED. ROAD DIST. NO.	ILLINOIS FED. AID PROJECT		MOTIIA-05 OF 05	

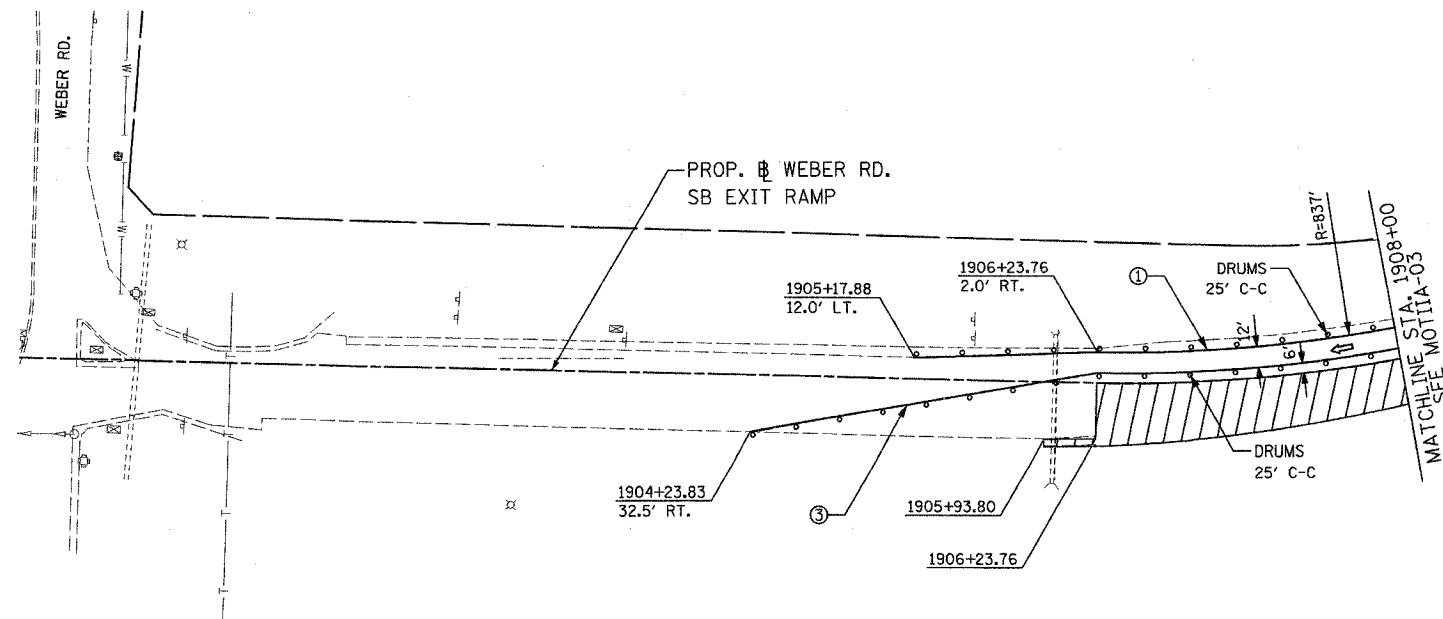

- LEGEND**
- WORK ZONE
 - DIRECTION OF TRAVEL
 - TEMP CONCRETE BARRIER
 - DRUMS W/ STEADY BURN LIGHTS
•See Drawing For Spacing
 - BARRICADE, TYPE III WITH TWO FLASHING LIGHTS
 - PVMT MARKING TAPE, TYPE III 4" (WHITE)
 - PVMT MARKING TAPE, TYPE III 5" SKIP-DASH (WHITE-30 FT/10 FT)
 - PVMT MARKING TAPE, TYPE III 4" (YELLOW)
 - PVMT MARKING TAPE, TYPE III 4" SKIP-DASH (WHITE-6 FT/2 FT)

*STATIONS AND OFFSETS ARE DESCRIBED FROM RAMP # TO WHICH CALL OUTS ORIGINATE UNLESS NOTED OTHERWISE.

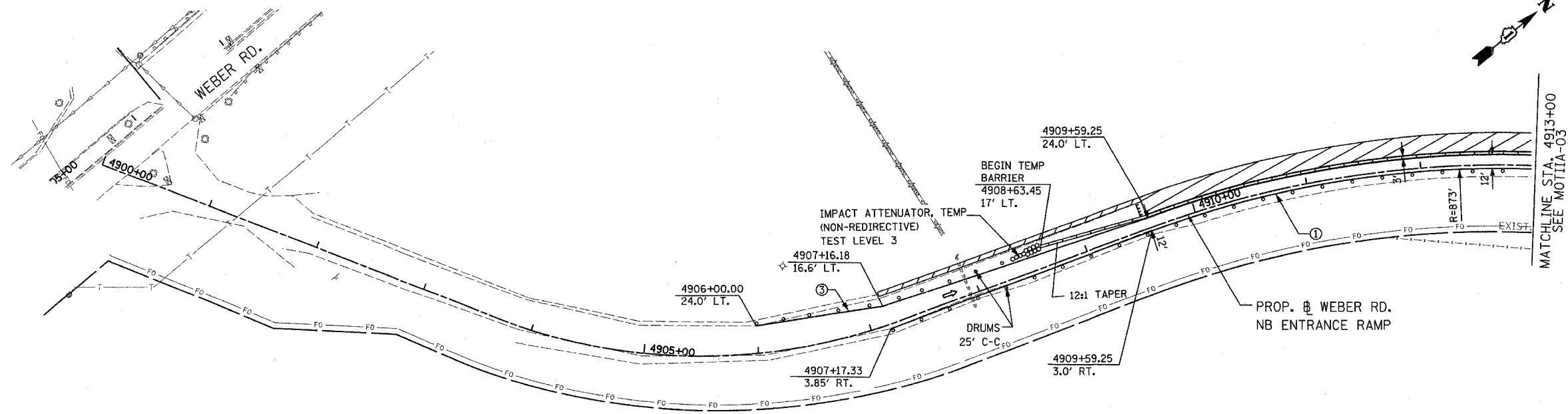

*STATIONS AND OFFSETS ARE DESCRIBED FROM RAMP # TO WHICH CALL OUTS ORIGINATE UNLESS NOTED OTHERWISE. **STAGE IIA**

REVISIONS	
NAME	DATE

ILLINOIS DEPARTMENT OF TRANSPORTATION
 FAI ROUTE 55
 143RD STREET TO WEBER ROAD
 SUGGESTED STAGES OF CONSTRUCTION
 AND TRAFFIC CONTROL

SCALE: 1" = 50'
 DATE: 02-23-07

DRAWN BY: TJR
 CHECKED BY: DM

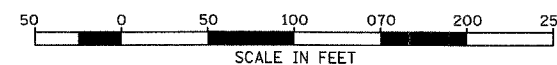

FINAL