

CONTRACT NO. 60B47				
F.A.P. RTE.	SECTION	COUNTY	TOTAL SHEETS	SHEET NO.
55	99 (I&2) WRS-3	WILL	305	101
STA. 907+00		TO STA. 922+00		
FED. ROAD DIST. NO.	ILLINOIS	FED. AID PROJECT		
EC-03 OF 07				

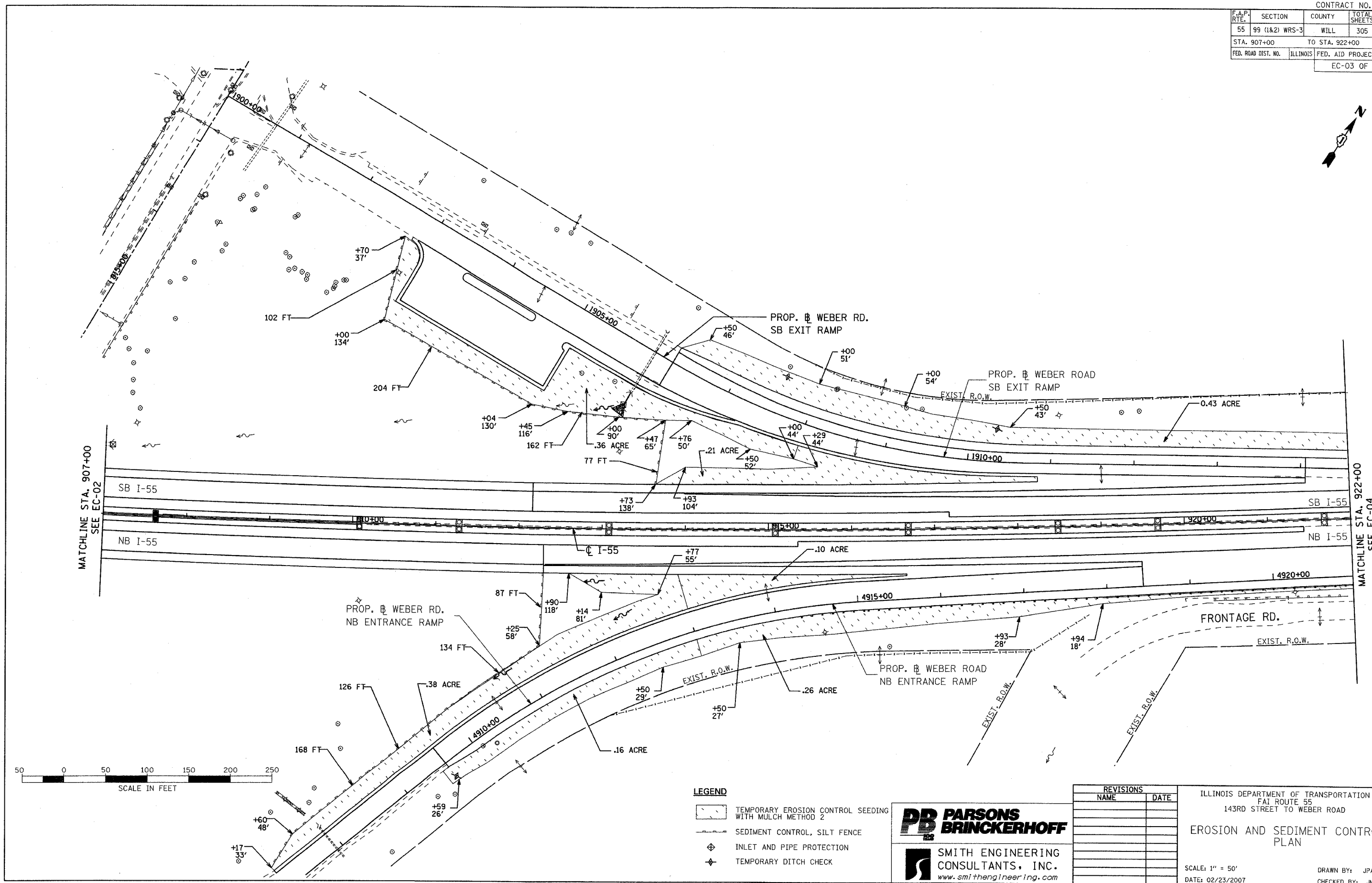

MATCHLINE STA. 907+00  
SEE EC-02

MATCHLINE STA. 922+00  
SEE EC-04

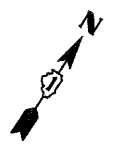
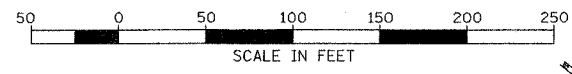

- LEGEND**
- TEMPORARY EROSION CONTROL SEEDING WITH MULCH METHOD 2
  - SEDIMENT CONTROL, SILT FENCE
  - INLET AND PIPE PROTECTION
  - TEMPORARY DITCH CHECK

**PARSONS BRINCKERHOFF**

**SMITH ENGINEERING CONSULTANTS, INC.**  
www.smithengineering.com

REVISIONS	
NAME	DATE

ILLINOIS DEPARTMENT OF TRANSPORTATION  
FAI ROUTE 55  
143RD STREET TO WEBER ROAD

**EROSION AND SEDIMENT CONTROL PLAN**

SCALE: 1" = 50'  
DATE: 02/23/2007

DRAWN BY: JPA  
CHECKED BY: JM

**FINAL**