

W:\P\9500132\10_18\9500132_29.dwg 11/17/06 11:35:04 AM

F.A. RTE.	SECTION	COUNTY	TOTAL SHEETS	SHEET NO.
99 (I&2) WRS-1	WIL	WI	305	132A
STA.	TO STA.			
FED. ROAD DIST. NO.	ILLINOIS FED. AID PROJECT			

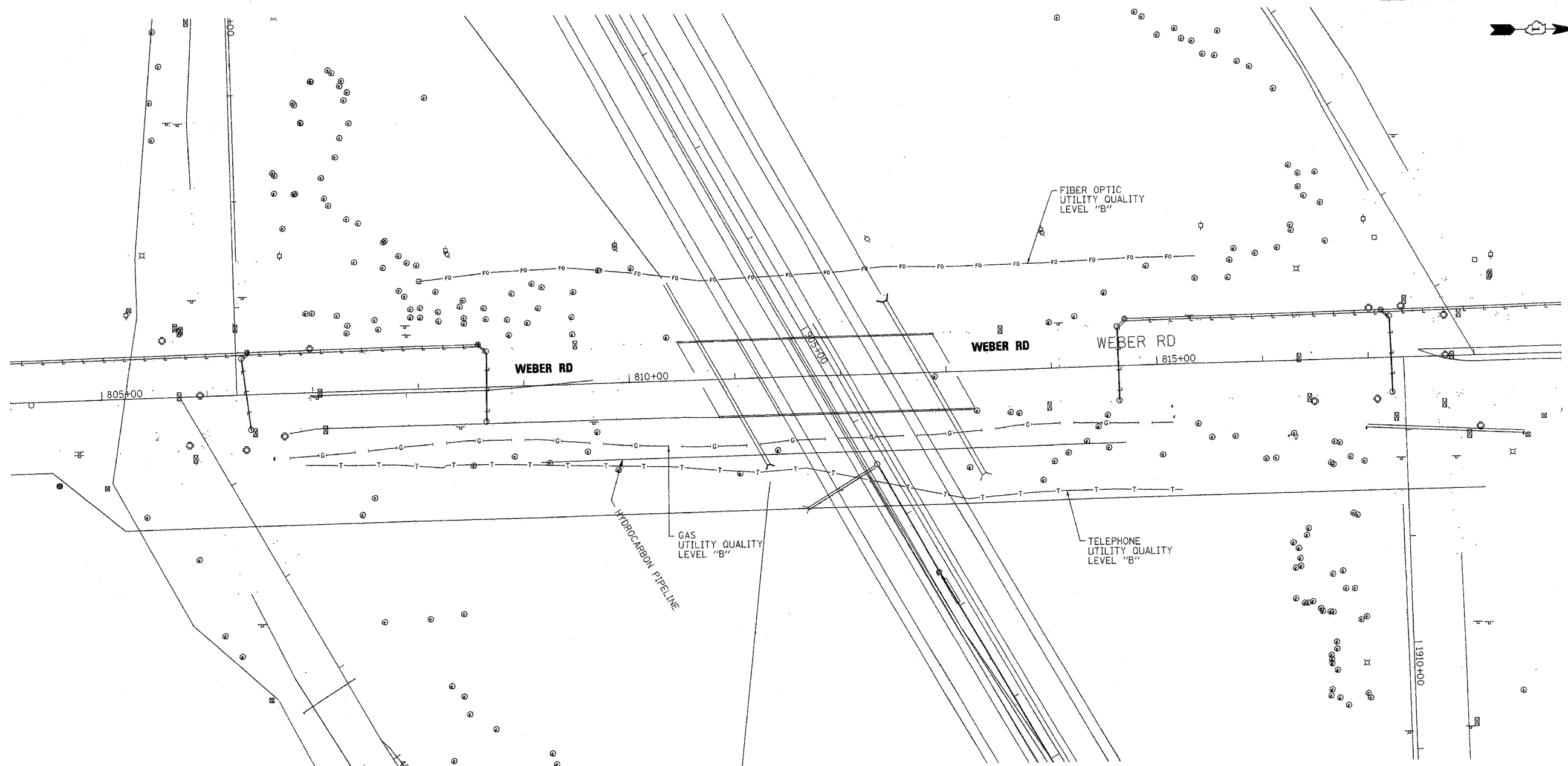

The SBC locations depicted have been obtained through the application of geophysical methods to determine the existence and approximate horizontal position of these facilities. However, SBC will not provide TBE Group, Inc. with utility records nor allow access to their field closures (pedestals/manholes etc.), to help verify the locations of their existing underground facilities. Therefore, TBE is unable to verify the completeness of the SBC locations depicted in accordance with the CI/ASCE Standard 38-02.

Utilities shown on these plans as depicted in the legend have been investigated by TBE Group, Inc in accordance with SUE Industry Standards. All other information shown has been provided to TBE Group, Inc by others. Changes to utilities after dates shown may have been made and therefore may result in variances from this plan. Consideration should be given to updating this plan if deemed advisable prior to final design and construction.



TBE GROUP, INC.
 CIVIL ENGINEERING * TRANSPORTATION * ENVIRONMENTAL
 * PLANNING * UTILITY ENGINEERING/LOCATING

IL09500132, 142, 158, 229, 245
 TBE SUE PAGE NO: 29 of 29

Checked by: *[Signature]*
 Utility Quality Level "A" : Test Holes
 Utility Quality Level "B" : Designating

	FORCE MAIN
	TELEPHONE
	WATER
	GAS
	CABLE TELEVISION
	FIBER OPTIC
	ELECTRIC
	TEST HOLE

205 W. WACKER DRIVE
 SUITE 1020
 CHICAGO, IL 60606
 (312) 704-1970

REVISIONS	
NAME	DATE

ILLINOIS DEPARTMENT OF TRANSPORTATION
 SUE Investigation of Underground Utilities
 I-55/I-80 from US RT. 30 to Weber Road
 Section No. 99 (I&2) WRS-1
 Contract No. 62895 and 62896
 Will County
 SOL "B" DATE : 1/17/06
 DRAWN BY : KLC
 SCALE : 1" = 50'