

CONTRACT NO. 60847			
F.A.P. RTE.	SECTION	COUNTY	TOTAL SHEETS
55	100 (1&2) I-9	WILL	305
STA.	907+00	TO STA.	922+00
FED. ROAD DIST. NO.	ILLINOIS FED. AID PROJECT		
	PVMRK- 9		OF 30

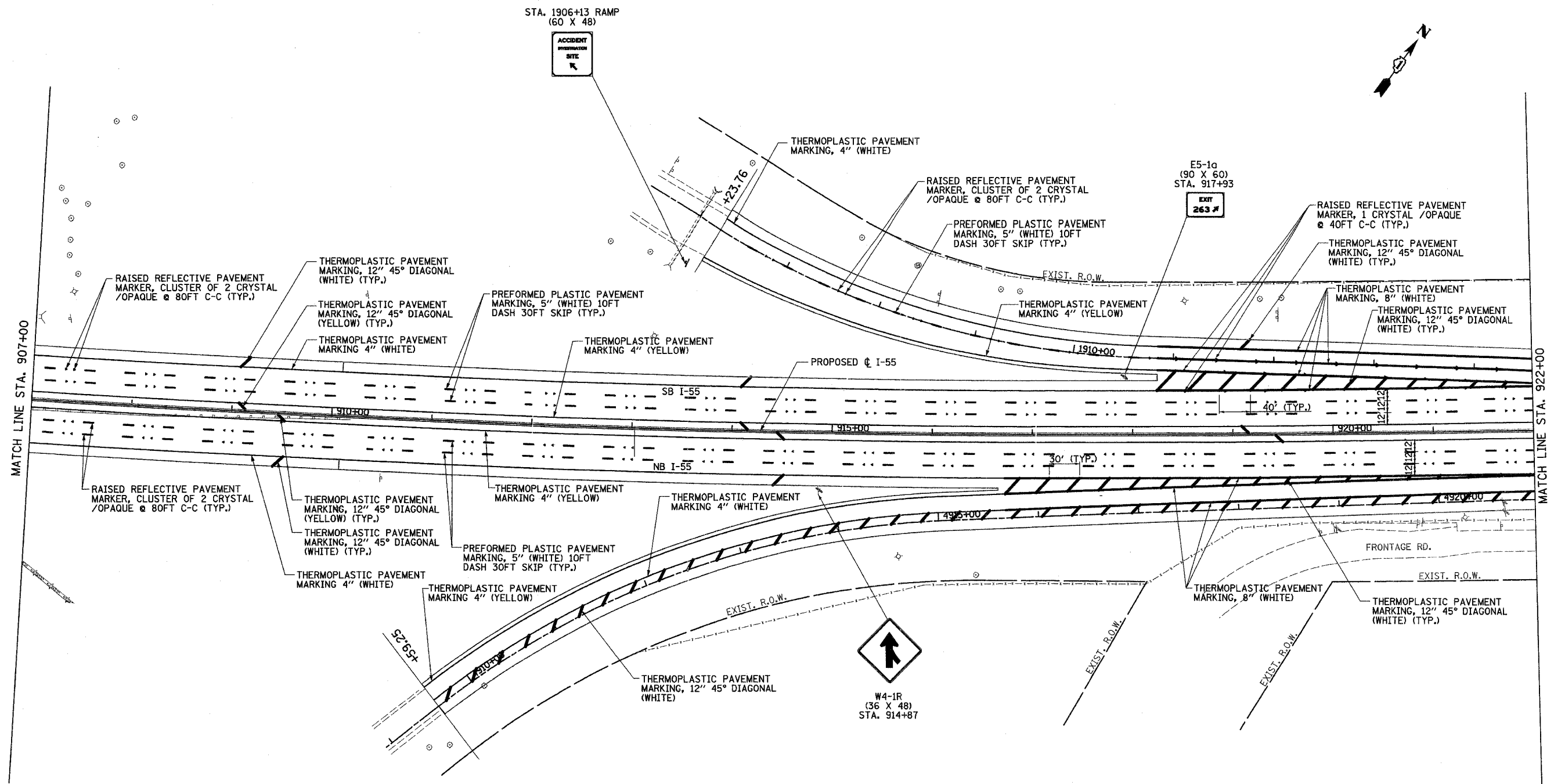

MATCH LINE STA. 907+00

MATCH LINE STA. 922+00

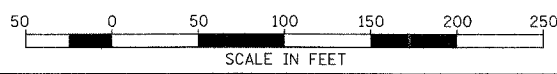

DAVID MASON & ASSOCIATES
 Civil Engineering
 Structural Engineering
 Surveying
 445 E. Illinois, Suite 640
 Chicago, IL 60611
 (312) 942-8900

PB PARSONS BRINCKERHOFF

REVISIONS	
NAME	DATE

ILLINOIS DEPARTMENT OF TRANSPORTATION
 F.A.I. I-55
 143rd STREET TO WEBER ROAD

PAVEMENT MARKING
 AND SIGNING PLANS

SCALE: 1" = 50'
 DATE: FEBRUARY 23, 2007

DRAWN BY: JPS
 CHECKED BY: SE