

B.M. 3287 -
 Square cut SW corner of a 4'x6' conc. base for an IDOT traffic signal control box at the NW corner of Weber Rd. and SE Frontage Rd. (Norman Town Rd.).
 El. 642.98

STATE OF ILLINOIS
 DEPARTMENT OF TRANSPORTATION

| | | | | |
|-----------------------|----------|-------------------|-------|-----------|
| ROUTE NO. | SECTION | COUNTY | SHEET | SHEET NO. |
| FAI 55 | ** | WILL | 305 | 182 |
| FED. ROAD DIST. NO. 7 | ILLINOIS | FED. AID PROJECT- | | 7 SHEETS |

** SECTION 99 (18.2) WRS-3
 CONTRACT NO. 60B47

Existing Structure -
 Structure No. 099-0281 was constructed in 1991 under Section No. 99-IHB-I(K&R)88. This structure carries Weber Road over I-55 and is 242'-10 1/2" Bk. to Bk. of Abutments consisting of a 73'-2" wide reinforced concrete deck supported on a 48" PPC I-beam superstructure. The substructure consists of Vaulted Abutments supported on a piles and a Median Pier supported on a spread footing foundation.

Salvage -
 None

SCOPE OF WORK

1. Repair substructure defects at Vaulted Abutments and Median Pier with Epoxy Crack Sealing.
2. The Median Pier Crashwall will be extended to a height equal to 42" from edge of pavement to match the proposed I-55 mainline median barrier configuration.
3. Remove 16'-0" Raised Median and replace with a 2'-0" Raised Median to accommodate dual left turn lanes on the bridge.
4. Reconstruct the Neoprene Expansion Joint at each end of the bridge in the footprint of the existing median.

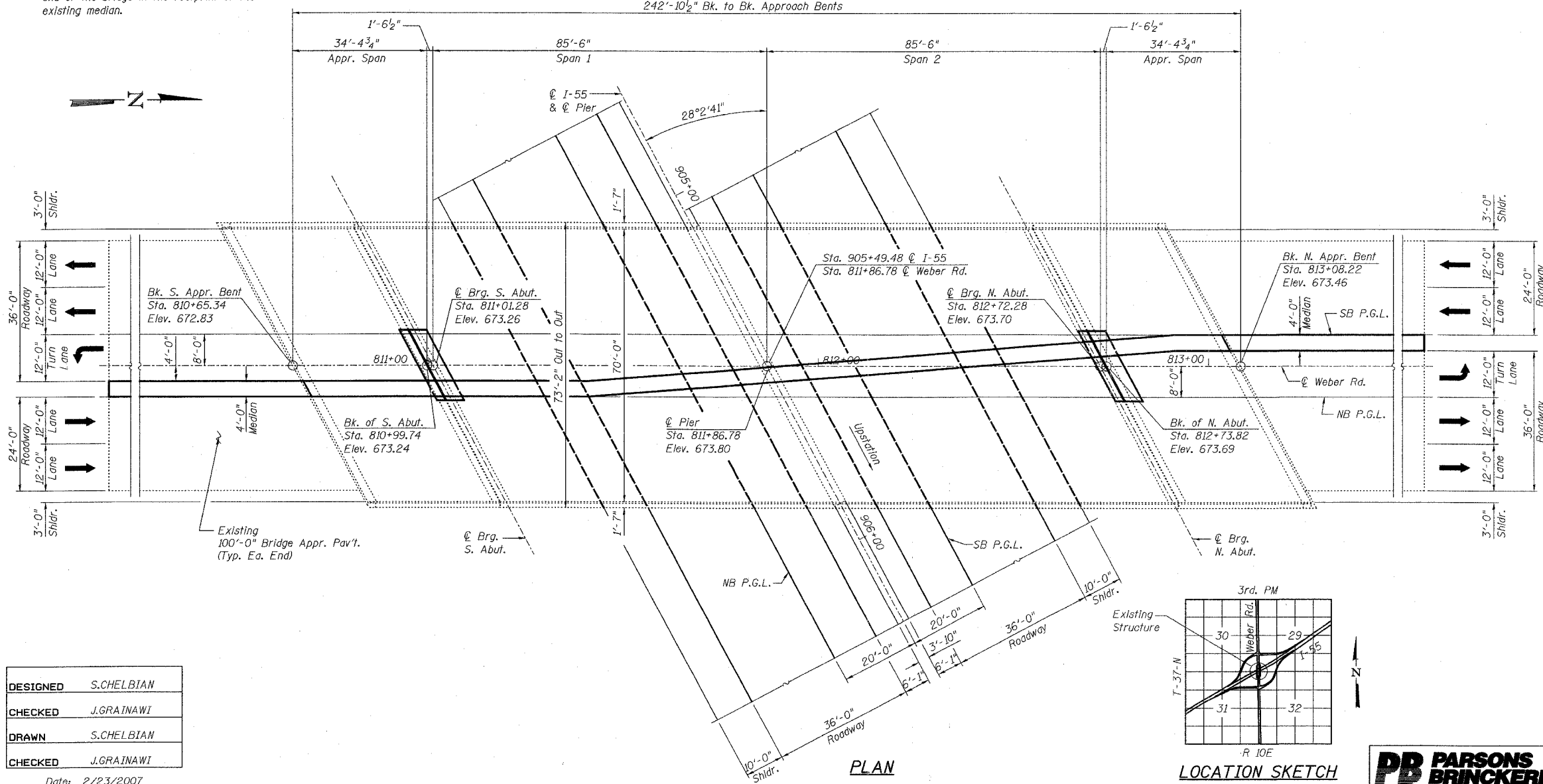
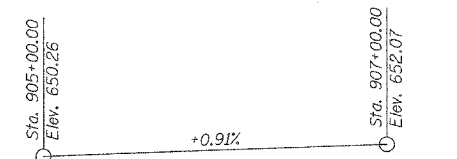
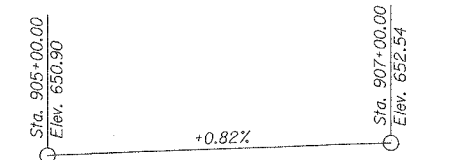
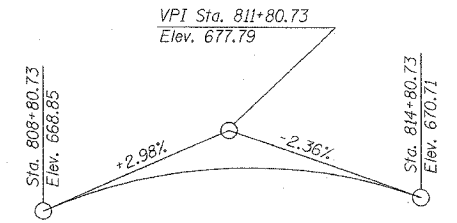
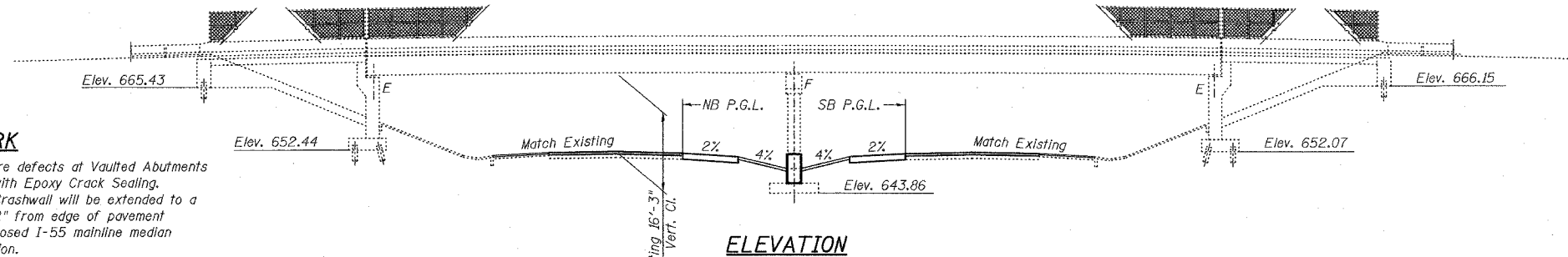

DESIGN SPECIFICATIONS

AASHTO 2002
 LOADING HS20-44
 Allow 25#/sq. ft. for future wearing surface.

DESIGN STRESSES

FIELD UNITS
 f'c = 3,500 psi (Proposed)
 f'c = 4,000 psi (Existing)
 fy = 60,000 psi (reinforcement)



Signed *Jamal I. Grainawi*
 Jamal I. Grainawi, S.E. IL. Lic. No. 081-005361
 Expires 11-30-2009
 Date 2/23/07

GENERAL PLAN AND ELEVATION
 WEBER ROAD OVER I-55
 SECTION 99 (18.2) WRS-3
 WILL COUNTY
 STA. 811+86.78
 STRUCTURE NO. 099-0281

| | |
|----------|------------|
| DESIGNED | S.CHELBIAN |
| CHECKED | J.GRAINAWI |
| DRAWN | S.CHELBIAN |
| CHECKED | J.GRAINAWI |

Date: 2/23/2007

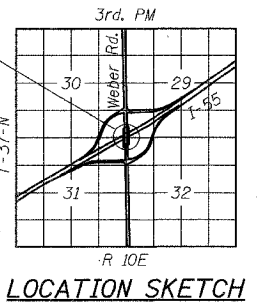

2/16/2007 9:46:48 AM C:\16617\AS\StructCadd\Pre-Final\WEBER\Final Submittal to IDOT\BO_022307\692226-09B47-000-000-001.dgn